

**Summary** Lead Appr: \_\_\_\_\_ Clerk: \_\_\_\_\_ Lead Clerk: \_\_\_\_\_ Appr: SH 5/13/26 Print Date: \_\_\_\_\_

2/27/2026

Acct ID: 126999 MTL: 072W07BC00800P1 Date: 4/16/26 Appr: SH Prop Class: 019 RMV Prop Class: 019

Situs: 4155 LANCASTER DR NE # 3 SALEM, OR 97305 MaSaNh: 14 05 001 Unit: 140883 Year: 2026

Last Date Appraised: 08/23/2010 Appraiser: THERESA SWEARINGEN Tag: Y N Tag info:

Owner: CANDELARIA, JUAN & Last Sales Date: Roll Type: MS

Cycle Tag Sales Verification Other: \_\_\_\_\_ Inspection level: 1 2 3 4 LCB TTO INSP AV: 21190

RMV Land: 0 RMV Imp: 38050 RMV Total: 38050 MAV: 21190 MSAV: 0 SAV: 0

Comment: 23-24 Uncoded Accessory Project

N/C

**Improvements - Residence / Manufactured Structures**

Bldg: 1 Code Area: 24620 Stat Class: 456 Year Blt: 1976 Eff Year Blt: 1977 Sq.Ft: 1344 % Complete: 100.00

Desc: MANUF STRUCT, CLASS 5, 24' WIDE DOUBLE Dimensions: 56x24 RMV: 38050

Func Obsc: 100 Econ %: 100 Other %: 100 Exception: 0 Adjust: Adjust RMV: 0 Subtype: P

**Floors**

Type	Class	Display Group	Floor Size	Beds	Baths	Yr Blt	Eff Yr Blt	Inventory	Exception: Y N
First Floor	5	Finished	1344	3	FB-2	1976	1977	HVAC+, SKIRT, KIT-, BATH - 2, ROOF+	Y N

**Accessories**

Description	Class	Size SqFt	Eff Yr Blt	RMV	Quantity	Exception: Y N
ROOF EXTENSION OR PATIO COVER	5	80	1977	696	0	Y N



wood skirt  
V win  
Clean  
good paint

M126999

# BUILDING DIAGRAM AND OUTBUILDINGS

ACCT NO: X122144

MAP NO:

TAX LOT:

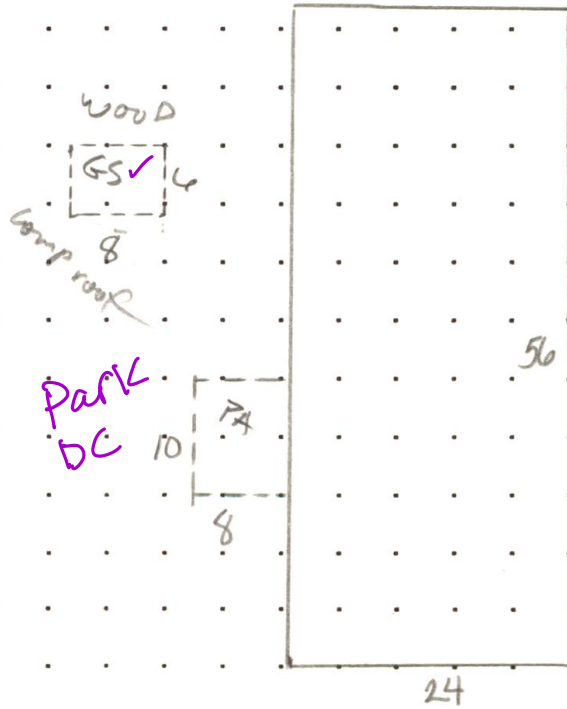

CALCULATIONS:  $24 \times 56 = 1344$

SCALE: 1" = 20'

MEASUREMENT VERIFIED		YR BLT: 76	ADDRESS: Chemeleta Mol Village #3	SALES	
DATE	BY	REMARKS:	BUILDER: Gibraltar by moduline	Date	Amt.
1/2/85	65				
4-18-95	79	NV			
8-23-10	DT4	NV			