

Acct ID: 125976 MTL: 072W07BC00800P1 Date: 4/30/26 Appr: SAH Prop Class: 019 RMV Prop Class: 019

Situs: 4155 LANCASTER DR NE # 71 SALEM, OR 97305 MaSaNh: 14 05 001 Unit: 140551 Year: 2026

Last Date Appraised: 08/26/2010 Appraiser: THERESA SWEARINGEN Tag: Y N Tag info:

Owner: JIMENEZ ZAVALA, ANA V Last Sales Date: Roll Type: MS

Cycle Tag Sales Verification Other: _____ Inspection level: 1 2 3 4 LCB TTO INSP AV: 6250

RMV Land: 0 RMV Imp: 27040 RMV Total: 27040 MAV: 6250 MSAV: 0 SAV: 0

Comment: CHEMEKETA MOBILE VILLAGE, SPACE #71, MS SERIAL # 60F2K0A11805524, X # X00108907, PERSONAL MS

update Inventory

Improvements - Residence / Manufactured Structures

1993

Bldg: 1 Code Area: 24620 Stat Class: 454 Year Blt: 1974 Eff Year Blt: 1972 Sq.Ft: 784 % Complete: 100.00

Desc: MANUF STRUCT, CLASS 5, 14' WIDE SINGLE Dimensions: 56x14 RMV: 27040

Func Obsc: 100 Econ %: 100 Other %: 100 Exception: 0 Adjust: Adjust RMV: 0 Subtype: P

Floors

| Type | Class | Display Group | Floor Size | Beds | Baths | Yr Blt | Eff Yr Blt | Inventory | Exception: Y N |
|-------------|-------|---------------|------------|------|-----------|--------|------------|--|----------------|
| First Floor | 5 | Finished | 784 952 | 3 | ✓ FB-1 | 1974 | 1972 | BATH - 1, HVAC+, ROOF+, SKIRT, KIT- ✓ | Exception: Y N |

Accessories

| Description | Class | Size SqFt | Eff Yr Blt | RMV | Quantity | Exception: Y N |
|-------------------------------|-------|-----------|------------|------|----------|----------------|
| DECK | 5 | 240 | 1972 | 1478 | 0 | Exception: Y N |
| ROOF EXTENSION OR PATIO COVER | 5 | 240 | 1972 | 1949 | 0 | Exception: Y N |



New flooring
 Newer paint - int/ext.
 newer cloth roof
 v win
 12x14 Added 2021

BUILDING DIAGRAM AND OUTBUILDINGS

ACCT NO: M125976

MAP NO:

TAX LOT:

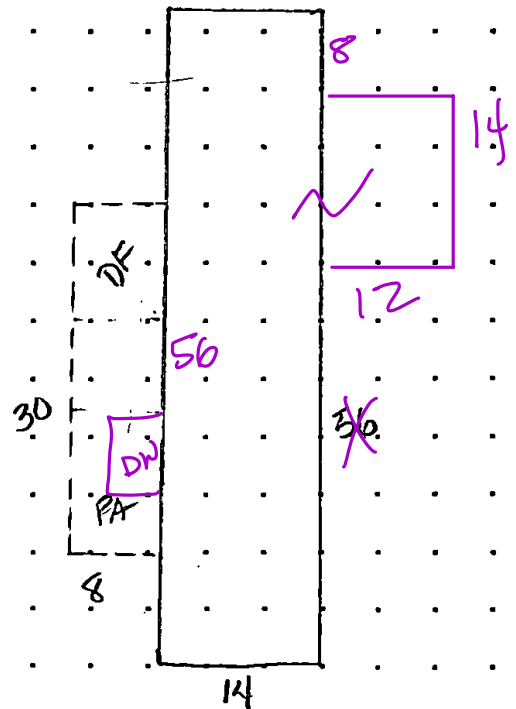

CALCULATIONS:

$$14 \times 56 = 784$$

$$12 \times 14 = 168$$

$$952$$

SCALE: 1" = 20'

| MEASUREMENT VERIFIED | | YR BLT: 74 | ADDRESS: <u>Chomoketa Mbl Village # 71</u> | SALES | | |
|----------------------|-----|------------|--|-------|------|--|
| DATE | BY | REMARKS: | BUILDER: <u>Kirkwood (Redman)</u> | Date | Amt. | |
| 8/6/86 | 65 | | | | | |
| 4-24-95 | 79 | | NV | | | |
| 5-17-04 | DTU | | NV | | | |
| 8-26-10 | DTU | NV | | | | |



072W07BC00800

M125976

019 03BU

T54C

92400213

JIMENEZ ZAVALA, PATRICIA G

0 Acres

4155 LANCASTER DR NE, #71

8/6/02

Chemeketa Mobile Village

M125976 072W07BC00800 Appr #:DTU Date 10-30-13 Prop Class 019 Prop Code T54
 Situs Address 4155 LANCASTER DR NE, #71 Franchise Code 04 Year For: 2014-2015
 Owner ANGUIANO, GUSTAVO &

Notes: Tags Cycle Sales Verification Other:
Same house - no chg SINCE 2010

RMV Imp: 4,720 RMV Total: 4,720 M50 Total: 4,430

Seg.Type MA Seg. # 1.1 Method M04 Class 5S Area 784 Eff Area 784 Length 56 Width 14
 Make: REDMAN Model: KIRKLAND Intfinish: PANEL Roof Cover METAL
 Plumbing BATH1 Heat: FA Fireplace: Inter. Comp: Bedrooms 2
 Year Built 1974 Eff. Year Built 1972 Cond. P F A G E
 Adj Code MSLCMS Qty _____ % Comp _____ Func _____ Econ _____ RMV 3,850
 Lump Sum _____ Except Code/Year _____ Comments _____

Accessory Improvements

Seg.Type PA Seg. # 1.3 Method: R05 Class Area 240 Eff Area 240
 Length 30 Width 8 Foundation Ex. Wall Roof Cover
 Roof Style Floor Plumbing
 Year Built Eff. Year Built: 1974 Cond. P F A G E % Comp _____ Econ _____ RMV: 470
 Lump Sum _____ Except Code/Year _____ Comments _____

Seg.Type DF Seg. # 1.4 Method: R05 Class Area 240 Eff Area 240
 Length 30 Width 8 Foundation Ex. Wall Roof Cover
 Roof Style Floor Plumbing
 Year Built Eff. Year Built: 1974 Cond. P F A G E % Comp _____ Econ _____ RMV: 320
 Lump Sum _____ Except Code/Year _____ Comments _____

Out Buildings and Skirting

Seg.Type MHSK Seg. # 1.2 Method: M04 Class Area 140 Eff Area 140
 Length Width Foundation Ex. Wall METAL Roof Cover
 Roof Style Floor Plumbing
 Heat Int. Comp Elect. Yr. Bilt. 1974 Eff. Yr. Bilt: 1974
 Cond. P F A G E Adj. Codes % Comp _____ Func _____ Econ _____ RMV: 80
 Lump Sum _____ Except Code/Year _____ Comments _____

M125976 072W07BC00800 Appr #: _____ Date _____ Prop Class 019 Prop Code T54
 Situs Address 4155 LANCASTER DR NE, #71 Franchise Code 04 Year For: 2014-2015
 Owner ANGUIANO,GUSTAVO &
 Tags Cycle Sales Verification Other: _____

Notes: _____
 RMV Imp: 4,720 RMV Total: 4,720 M50 Total: 4,430

| | | | | | | | |
|--------------|--|--|--|--|--|--|------|
| Segment | | | | | | | Land |
| Class | | | | | | | |
| Dim/Size | | | | | | | |
| Foundation | | | | | | | |
| Exter Wall | | | | | | | |
| Wall Height | | | | | | | |
| Inter Finish | | | | | | | |
| Roof Cover | | | | | | | |
| Roof Style | | | | | | | |
| Flooring | | | | | | | |
| Plumbing | | | | | | | |
| Electric | | | | | | | |
| Misc. | | | | | | | |
| Yr Blt | | | | | | | |
| Eff Yr | | | | | | | |
| Cond. | | | | | | | |
| % Good | | | | | | | |
| % Comp | | | | | | | |
| Lump Sum | | | | | | | |
| Except.Code | | | | | | | |

Land Segments

Seg. No Description Schedule Acres Adjustment Codes Exception Code

Eff Acres Companion Accounts

ROUTING SLIP

Date _____ Clerk _____

Work Needed: (Please make necessary comments, sign and pass to the next appropriate person.)

Data entry reviewed by/comments _____

Appraiser response _____

RECEIVED FEB 16 1979

STICKER NO.

OREGON MOBILE HOME TITLE TRANSFER REPORT MARION
INTRA COUNTY MOVEMENT

| | | | | | | | | |
|----------------|-------|--------------|-------------------------------|--------------|--------------|-----------------|--------|------------|
| LICENSE NUMBER | | TITLE NUMBER | | LICENSE DATE | PROCESS DATE | EXPIRATION DATE | | FEE PAID |
| X108907 | | 7903134913 | | 011579 | 013179 | PERM | | 8.00 |
| YEAR | MAKE | STYLE | VEHICLE IDENTIFICATION NUMBER | | | WEIGHT | LENGTH | EQUIP. NO. |
| 1974 | KIRKW | HT | 60F2K0A11805524 | | | | | |

HILLIS, RONNIE
4155 LANCASTER NE
SALEM

OREGON 97303

COUNTY OF
RESIDENCE

COUNTY OF
USE

MARION

MARION

NEW
ADDRESS

SECURITY INTEREST OWNER/LESSOR IF NOT SHOWN ABOVE

OREGON TRAIL SAVINGS/LOAN ASSN
236 NE ROBERTS
GRESHAM

OREGON 97030

*not on index
on numerical*

