

Summary

Lead Appr: SR 4/20/26

Clerk: lak 4.21.26

Lead Clerk:

Appr: ZH 4/22/26

Print Date:

3/10/2026

Acct ID: 125590

MTL: 082W060001800P1

Date: 4/13/26 Appr: ZH

Prop Class: 019

RMV Prop Class: 019

Situs: 3100 TURNER RD SE # 626 SALEM, OR 97302

MaSaNh: 17 05 005

Unit: 140436

Year: 2026

Last Date Appraised: 07/13/2016

Appraiser: THERESA SWEARINGEN

Tag: Y N

Tag info:

Owner: MATHIS, VICTORIA

Last Sales Date: 11/18/2025

Roll Type: MS

Cycle Tag Sales Verification

Other:

Inspection level: 1 2 3 4

LCB INSP

AV: 38510

RMV Land: 0

RMV Imp: 52270

RMV Total: 52270

MAV: 38510

MSAV: 0

SAV: 0

Comment: PARADISE ISLAND M.P., SPACE #626, MS SERIAL # 2052CK25CGDS0918, X # X00101775, PERSONAL MS

UPDATE EYB AS GOMAR

Improvements - Residence / Manufactured Structures

1988 = GOMAR

Bldg: 1 Code Area: 24010 Stat Class: 455 Year Blt: 1974 Eff Year Blt: 1974 Sq.Ft: 960 % Complete: 100.00

Desc: MANUF STRUCT, CLASS 5, 20' WIDE DOUBLE

Dimensions: 48x20

RMV: 52270

Func Obsc: 100

Econ %: 154

Other %: 100

Exception: 0

Adjust:

Adjust RMV: 0

Subtype: P

Floors

Type	Class	Display Group	Floor Size	Beds	Baths	Yr Blt	Eff Yr Blt	Inventory	Exception
First Floor	5	Finished	960	2	FB-1/ HB-1	1974	1974	SKIRT, BATH - 1, ROOF+, HVAC+, KIT, BTH - 1	Y

Accessories

Description	Class	Size SqFt	Eff Yr Blt	RMV	Quantity	Exception
DECK	5	200	1974	1980	0	Y N
ROOF EXTENSION OR PATIO COVER	5	400	1974	5220	0	Y N

- CERT. VALUE: \$74,040
- ORIGINAL SIDING / WINDOWS
- OLDER METAL ROOF
- NEWER CARPET / LVP
- ORIGINAL KIT. & BATH CABS (PAINTED)
- MINIMAL INT. UPDATES
- EXTERIOR PAINT HOLDING UP WELL





Marion County
OREGON
ASSESSOR'S OFFICE

Appraiser Sales Verification From

Primary Acct: 125590
MTL: 082W060001800
MaSaNh/P.Class: 1705005/019
Appraiser: ZACK HARROLD
MS Acct: 125590

Date Printed: 3/10/2026

Situs: 3100 TURNER RD SE # 626 SALEM, OR 97302

Grantor:
DEBATES, SUSAN GAY

Grantee:
MATHIS, VICTORIA

Sale ID: Tax Statement RMV
Deed: Land & OSD: 0
Accts In Sale: Imp: 74040
Sale Date: 11/18/2025 Total: 74040
Sale Price: 105000 Ratio (Cert. Total RMV/Sale Price): 71
Condition Code: ~~00~~ 30

Attempt	Date/Time	Reason
1 st	4/13/26 10:45	TTD
2 nd		

Contact: VICTORIA Phone/email: _____

- Was the property listed on the open market? Days: 407 MLS: 822188 Y N
- Was property other than real estate included in the sale? Y N
Describe: _____ Est. \$: _____
- Did the seller pay closing costs or make other concessions? \$ NONE - CASH SALE Y N
- Was the sale between related parties? (business or family) Y N
- Was this a distressed sale? E.g. foreclosure, short, court order, etc... Y N
- Condition at time of sale: | Poor | Fair | Avg. | Good | Exc. | Y N
Describe: _____

- Have any improvements been made since the time of sale? Y N
If yes, describe: INT. PAINT & OTHER MINOR COSMETIC ITEMS

Comments:

Appraiser: ZH Date: 4/13/26

M125590

BUILDING DIAGRAM AND OUTBUILDINGS

ACCT NO: M125590

MAP NO:

TAX LOT:

GS
NV

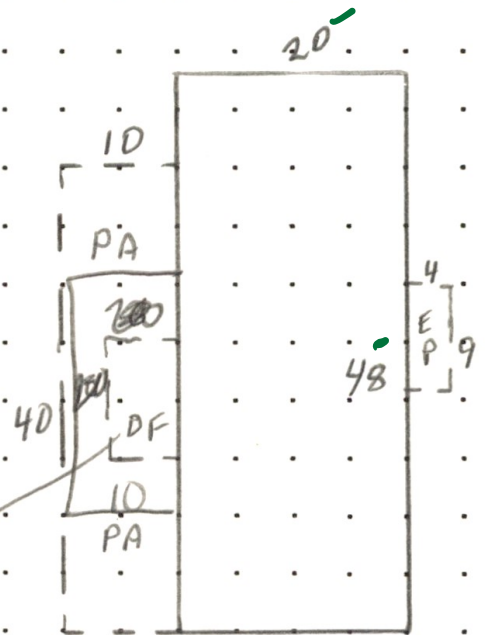

dl
now
10x20

CALCULATIONS: $20 \times 48 = 960$ SF

SCALE: 1" = 20'

MEASUREMENT VERIFIED		YR BLT: 74	ADDRESS: PARADISE ISLD #626	SALES	
DATE	BY	REMARKS:	BUILDER: BROOKWOOD (REX)	Date	Amt.
9-25-85	KKB				
1-5-94	DT/4				
7-13-16	DT/4	N.V. cycle			