

Acct ID: 125546 MTL: 072W07BC00800P1 Date: 4/16/26 Appr: SH Prop Class: 019 RMV Prop Class: 019

Situs: 4155 LANCASTER DR NE # 5 SALEM, OR 97305 MaSaNh: 14 05 001 Unit: 125546 Year: 2026

Last Date Appraised: 08/23/2010 Appraiser: THERESA SWEARINGEN Tag: Y N Tag info:

Owner: WICKE, ALLEN R Last Sales Date: Roll Type: MS

Cycle Tag Sales Verification Other: Inspection level: 1 2 3 4 LCB TTO INSP AV: 13670

RMV Land: 0 RMV Imp: 32890 RMV Total: 32890 MAV: 13670 MSAV: 0 SAV: 0

Comment: CHEMEKETA MOBILE VILLAGE, SPACE #5, MS SERIAL # GDF3DST511805193, X # X00100779, PERSONAL MS

update inventory

1984 WM

Improvements - Residence / Manufactured Structures

Bldg: 1 Code Area: 24620 Stat Class: 454 Year Blt: 1973 Eff Year Blt: 1975 Sq.Ft: 938 % Complete: 100.00

Desc: MANUF STRUCT, CLASS 5, 14' WIDE SINGLE Dimensions: 67x14 RMV: 32890

Func Obsc: 100 Econ %: 100 Other %: 100 Exception: 0 Adjust: Adjust RMV: 0 Subtype: P

Floors

Type	Class	Display Group	Floor Size	Beds	Baths	Yr Blt	Eff Yr Blt	Inventory	Exception: Y N
First Floor	5	Finished	938	2	FB-1	1973	1975	KIT-, SKIRT, ROOF+, HVAC+, BATH - 1	Y N

Accessories

Description	Class	Size SqFt	Eff Yr Blt	RMV	Quantity	Exception: Y N
ROOF EXTENSION OR PATIO COVER	5	410	1975 1984	3567	0	Y N



Vwin
Metal siding
nice, clean yard
& exterior

Different roof style
than previous photo.

BUILDING DIAGRAM AND OUTBUILDINGS

ACCT NO: M125546 MAP NO:

TAX LOT:

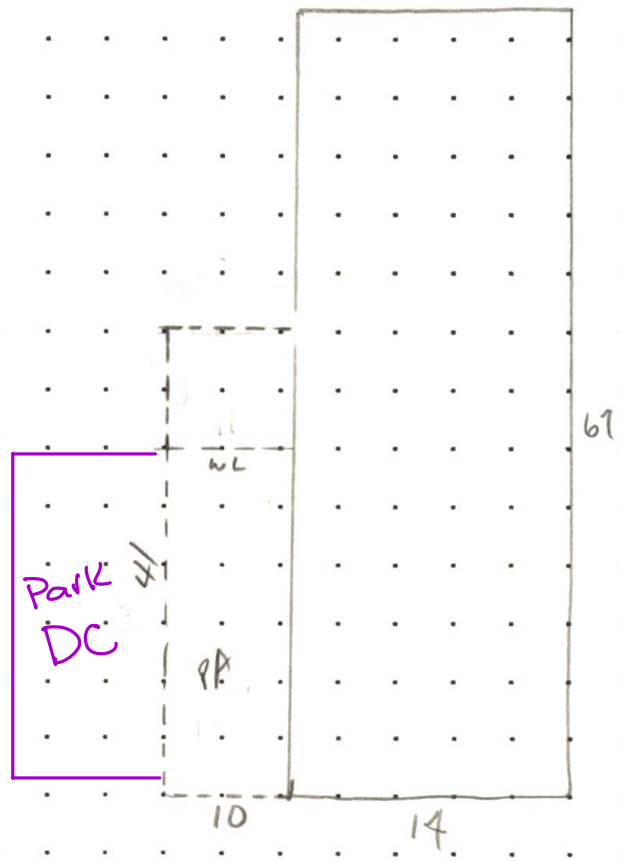

CALCULATIONS:

SCALE: 1" = 20'

MEASUREMENT VERIFIED		YR BLT: <u>73</u>	ADDRESS: <u>Chemeketa Mobile Village #5</u>	SALES	
DATE	BY	REMARKS:	BUILDER: <u>New Moon (Redman)</u>	Date	Amt.
<u>7/28/86</u>	<u>65</u>				
<u>4-18-95</u>	<u>29</u>			<u>NV</u>	
<u>8-23-10</u>	<u>DT4</u>	<u>NV</u>			