

Summary Lead Appr: SR 5/1/26 Clerk: LAK 5.4.26 Lead Clerk: \_\_\_\_\_ Appr: SA 5/8/26 Print Date:

2/27/2026

Acct ID: 600044 MTL: 072W07BC00800P3 Date: 4/16/26 Appr: SA Prop Class: 019 RMV Prop Class: 019

Situs: 4155 LANCASTER DR NE # 8A SALEM, OR 97305 MaSaNh: 14 05 001 Unit: 143984 Year: 2026

Last Date Appraised: 10/28/2021 Appraiser: THERESA SWEARINGEN Tag: Y N Tag info: 2022 - MAINTENANCE (MS - OTHER)

Owner: CHEMEKETA MV Last Sales Date: 11/20/2020 Roll Type: MS

Cycle Tag Sales Verification Other: \_\_\_\_\_ Inspection level: 1 2 3 4 LCB TTO INSP AV: 22500

RMV Land: 0 RMV Imp: 47050 RMV Total: 47050 MAV: 22500 MSAV: 0 SAV: 0

Comment: 22-23: MS was 90%, now 100%, EYB now 1991, TS02, L1, 10-28-21

## Update inventory

*1976 AVER COND*

### Improvements - Residence / Manufactured Structures

Bldg: 4 Code Area: 24620 Stat Class: 456 - Year Blt: 1976 Eff Year Blt: ~~1991~~ Sq.Ft: 1435 % Complete: 100.00

Desc: MANUF STRUCT, CLASS 5, 24' WIDE DOUBLE Dimensions: RMV: 47050

Func Obsc: 100 Econ %: 100 Other %: 100 Exception: 0 Adjust: Adjust RMV: 0 Subtype: P

### Floors

Type	Class	Display Group	Floor Size	Beds	Baths	Yr Blt	Eff Yr Blt	Inventory	Exception: Y <input type="checkbox"/>
First Floor	5 -	Finished	1435	3	FB-2	1976	<del>1991</del>	SKIRT, ROOF, HVAC <del>X</del> KIT-, BATH - 2	<input type="checkbox"/>

### Accessories

Description	Class	Size SqFt	Eff Yr Blt	RMV	Quantity
No accessory data available					



*worn paint  
dry rot in many places  
mildew on roof  
vwin*





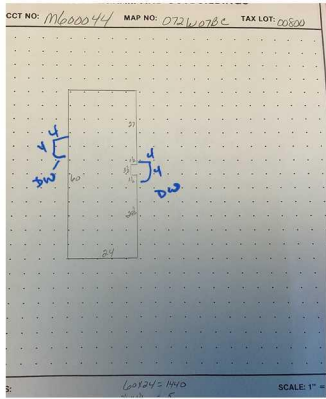

v. windows  
Fresh Paint  
w/n,





1/14/2021



1/14/2021

This insignia remains the property of the  
**STATE OF IDAHO**  
 Mobile Home and Recreational Vehicle Section

ID.	<b>36439</b>	S	<b>2482 U</b>
P.A.	<b>18726</b>	Plb	<input checked="" type="checkbox"/>
		Htg	<input checked="" type="checkbox"/>
		El	<input checked="" type="checkbox"/>
		Str	<input checked="" type="checkbox"/>

This manufacturer certifies that this unit is constructed  
 in accordance with applicable Idaho Statutes covering  
**PLUMBING, HEATING, ELECTRICAL, and STRUCTURAL**  
**INSTALLATIONS** in mobile homes.

MH	<b>50036</b>	R
----	--------------	---

<b>F-8</b>	<b>2482-U</b>
<b>7628</b>	<input checked="" type="checkbox"/>
	<input checked="" type="checkbox"/>
	<input checked="" type="checkbox"/>

**FLEETWOOD HOMES OF IDAHO, INC**  
 COMPANY ADDRESS  
 AND SERIAL NO. **2482U**  
 MODEL DESIGNATION **3 B**  
 DATE OF MANUFACTURE **11 - 75**

1/14/2021



8  
A

10/28/21



LINE BOX

8  
A

10/28/21