

Acct ID: 528112 MTL: 071W310000900 Date: 1.20.26 Appr: JJS Prop Class: 581 RMV Prop Class: 451
 Situs: 9683 EDMUNSON DR SE SALEM OR 97317 MaSaNh: 01 06 000 Unit: 149833 Year: 2026

Last Date Appraised: 12/12/2024 Appraiser: CLINT LUKE Tag: 0 N Tag info: 2025 - Tags/Permit (TAGS/PERMIT)
 Owner: SPROUL, DOUGLAS W Last Sales Date: 11/10/2022 Roll Type: R
 Cycle Tag Sales Verification Other: _____ Inspection level: 1 2 3 4 LCB TTO INSP AV: 1504971
 RMV Land: 231380 RMV Imp: 1577330 RMV Total: 1808710 MAV: 1494170 MSAV: 10801 SAV: 13788
 Comment: 25-26 L4 12/12/24 CLUKE
 24-25 L4 5/15/24 CLUKE
 23-24 L4 05.09.23 MLH

NO Access, NO thing started on Aerial, SCAN AL, R/T

Notations

RP/MS	Code	Description
RP	STF	SMALL TRACT FORESTLAND
RP	ZONED	FARM EFU ZONED

OSDs

Count	Code	Description	RMV	Code Area	Exception
1	SAE	SA OSD - EXCELLENT	75000	92410	0

Land

Site: 1 Code Area: 92410 Size: 2.55 Acres Use Code: 005 Zone: REST SAV Use: 011 Exception: 0
 Class: 4HD Value Source: Forest Homesite Description: FOUR HILL DRY RMV: 131040 Exception: Y N
 Adjustment(s): H2OGR, WASTE Fire Patrol: Description:
 Comments: Liability year - 2009, 2024 (1.55 acres were 1974)
 22-23 CHANGED WATER ADJUSTMENT TO GOOD
 99-2000: NEW HOMESITE 07-08: #31, ADD WATER ADJ

Site: 2 Code Area: 92410 Size: 4.83 Acres Use Code: 005 Zone: REST SAV Use: 011 Exception: 0
 Class: STFX Value Source: Small Tract Forest land Description: SMALL TRACT FORESTLAND X RMV: 910 Exception: Y N
 Adjustment(s): H2OGR, WASTE Fire Patrol: Description:
 Comments: Liability year - 1978, STF - 2004
 Pond

Site: 5 Code Area: 92410 Size: 1.39 Acres Use Code: 005 Zone: REST SAV Use: 011 Exception: 0
 Class: 4HD Value Source: Farm Use - EFU Description: FOUR HILL DRY RMV: 8740 Exception: Y N
 Adjustment(s): H2OGR, WASTE Fire Patrol: Description:
 Comments: Liability year - 1978

Site: 6 Code Area: 92410 Size: 2.09 Acres Use Code: 005 Zone: REST SAV Use: 011 Exception: 0
 Class: WST Value Source: Water Description: Rural WASTELAND RMV: 400 Exception: Y N
 Adjustment(s): H2OGR, WASTE Fire Patrol: Description:
 Comments: Liability year - 1978
 Pond

Site: 7 Code Area: 92410 Size: 2.43 Acres Use Code: 005 Zone: REST SAV Use: 011 Exception: 0
 Class: STFC Value Source: Small Tract Forest land Description: SMALL TRACT FORESTLAND C RMV: 15290 Exception: Y N
 Adjustment(s): H2OGR, WASTE Fire Patrol: Description:
 Comments: Liability year - 1978, STF - 2004
 Pond

Improvements - Residence / Manufactured Structures

Bldg: 1 Code Area: 92410 Stat Class: 164 + Year Blt: 1976 Eff Year Blt: 1980 Sq.Ft: 5868 % Complete: 100.00
 Desc: Multi Story above grade with basement Dimensions: RMV: 1106920
 Func Obsc: 100 Econ %: 100 Other %: 100 Exception: 0 Adjust: Adjust RMV: 0

Floors

Type	Class	Display Group	Floor Size	Beds	Baths	Yr Blt	Eff Yr Blt	Inventory	Exception:
First Floor	6 +	Finished	3206	2	FB-1/ HB-1	1976	1980	ROOF, HVAC, KIT-, BTH - 1, BATH - 1, FP - 4	Y N
Second Floor	6 +	Finished	2030	3	FB-2	1976	1980	BATH - 2, HVAC	Y N
Basement	6 +	Finished	632	2	0	1976	1980	HVAC	Y N
Basement	6 +	Unfinished	1430	0	0	1976	1980		Y N
Carpport Detached	6	Unfinished	1210	0	0	1976	1976	ROOF	Y N

Accessories

Description	Class	Size SqFt	Eff Yr Blt	RMV	Quantity	
YARD IMPROVEMENTS EXCELLENT	6	0	1980	54405	1	Exception: Y N

Bldg: 8 Code Area: 92410 Stat Class: 141 Year Blt: 2007 Eff Year Blt: 2007 Sq.Ft: 593 % Complete: 100.00
 Desc: One Story Only Dimensions: RMV: 120980
 Func Obsc: 100 Econ %: 100 Other %: 100 Exception: 0 Adjust: Adjust RMV: 0

Floors

Type	Class	Display Group	Floor Size	Beds	Baths	Yr Blt	Eff Yr Blt	Inventory	
First Floor	4	Finished	593	0	FB-1	2007	2007	HVAC, ROOF, KIT-, BATH - 1	Exception: Y N

Accessories

Description	Class	Size SqFt	Eff Yr Blt	RMV	Quantity	
YARD IMPROVEMENTS FAIR	4	0	2007	14824	1	Exception: Y N

Bldg: 10 Code Area: 92410 Stat Class: 107 Year Blt: 2008 Eff Year Blt: 2008 Sq.Ft: 0 % Complete: 100.00
 Desc: Yard Improvements Dimensions: RMV: 26480
 Func Obsc: 100 Econ %: 100 Other %: 100 Exception: 0 Adjust: Adjust RMV: 0

Floors

Type	Class	Display Group	Floor Size	Beds	Baths	Yr Blt	Eff Yr Blt	Inventory	
No floor data available									

Accessories

Description	Class	Size SqFt	Eff Yr Blt	RMV	Quantity	
PATIO	1	5234	2008	26484	1	Exception: Y N

Bldg: 11 Code Area: 92410 Stat Class: 107 Year Blt: 2008 Eff Year Blt: 2008 Sq.Ft: 0 % Complete: 100.00
 Desc: Yard Improvements Dimensions: RMV: 34160
 Func Obsc: 50 Econ %: 100 Other %: 100 Exception: 0 Adjust: Adjust RMV: 0

Floors

Type	Class	Display Group	Floor Size	Beds	Baths	Yr Blt	Eff Yr Blt	Inventory	
No floor data available									

Accessories

Description	Class	Size SqFt	Eff Yr Blt	RMV	Quantity	
HOT TUB / SPA	1	120	2008	1380	1	Exception: Y N
SWIMMING POOL	1	1140	2008	32775	1	Exception: Y N

Bldg: 12 Code Area: 92410 Stat Class: 107 Year Blt: 2008 Eff Year Blt: 2008 Sq.Ft: 0 % Complete: 100.00
 Desc: Yard Improvements Dimensions: RMV: 26450
 Func Obsc: 100 Econ %: 100 Other %: 100 Exception: 0 Adjust: Adjust RMV: 0

Floors

Type	Class	Display Group	Floor Size	Beds	Baths	Yr Blt	Eff Yr Blt	Inventory	
No floor data available									

Accessories

Description	Class	Size SqFt	Eff Yr Blt	RMV	Quantity	
SPORT COURT	1	8215	2008	26452	0	Exception: Y N

Bldg: 13 Code Area: 92410 Stat Class: 108 Year Blt: 2008 Eff Year Blt: 2008 Sq.Ft: 0 % Complete: 100.00
 Desc: Residential Other Improvements Dimensions: RMV: 11760
 Func Obsc: 100 Econ %: 100 Other %: 100 Exception: 0 Adjust: Adjust RMV: 0

Floors

Type	Class	Display Group	Floor Size	Beds	Baths	Yr Blt	Eff Yr Blt	Inventory	
No floor data available									

Accessories

Description	Class	Size SqFt	Eff Yr Blt	RMV	Quantity	
MISCELLANEOUS	0	0	2008	11760	1	Exception: Y N

Bldg: 15 Code Area: 92410 Stat Class: 158 Year Blt: 2018 Eff Year Blt: 2018 Sq.Ft: 0 % Complete: 100.00
 Desc: Res other improvements Dimensions: RMV: 202130
 Func Obsc: 100 Econ %: 100 Other %: 100 Exception: 0 Adjust: Adjust RMV: 0

Floors

Type	Class	Display Group	Floor Size	Beds	Baths	Yr Blt	Eff Yr Blt	Inventory	
Garage Oversized Detached	5	Finished	2505	0	HB-1	2018	2018	ROOF, BTH - 1	Exception: Y N

Accessories

Description	Class	Size SqFt	Eff Yr Blt	RMV	Quantity			
No accessory data available								
Bldg: 16 Code Area: 92410 Stat Class: 108 Year Blt: Eff Year Blt: 2007 Sq.Ft: 0 % Complete: 100.00								
Desc: Residential Other Improvements	Dimensions: RMV: 18370							
Func Obsc: 100 Econ %: 100 Other %: 100 Exception: 0	Adjust: Adjust RMV: 0							
Floors								
Type	Class	Display Group	Floor Size	Beds	Baths	Yr Blt	Eff Yr Blt	Inventory
No floor data available								
Accessories								
Description	Class	Size SqFt	Eff Yr Blt	RMV	Quantity			
ROOF EXTENSION OR PATIO COVER	1	696	2007	18367	0	Exception: Y N		

Improvements - Accessory Buildings

Bldg: 3 Code Area: 92410 Stat Class: 341 Year Blt: 1995 Eff Year Blt: 1995 Sq.Ft: 64 % Complete: 100.00								
Desc: Multi Purpose Shed (MP)	Dimensions: 8x8 RMV: 0							
Func Obsc: 100 Econ %: 100 Other %: 100 Exception: 0	Adjust: Adjust RMV: 0							
Floors								
Type	Class	Display Group	Floor Size	Beds	Baths	Yr Blt	Eff Yr Blt	Inventory
Multi-Purpose Bldg	6	Finished	64	0	0	1995	1995	Exception: Y N

Description	Class	Size SqFt	Eff Yr Blt	RMV	Quantity
No accessory data available					

Bldg: 5 Code Area: 92410 Stat Class: 341 Year Blt: 1995 Eff Year Blt: 1995 Sq.Ft: 308 % Complete: 100.00								
Desc: Multi Purpose Shed (MP)	Dimensions: 28x11 RMV: 3280							
Func Obsc: 100 Econ %: 100 Other %: 100 Exception: 0	Adjust: Adjust RMV: 0							
Floors								
Type	Class	Display Group	Floor Size	Beds	Baths	Yr Blt	Eff Yr Blt	Inventory
Multi-Purpose Bldg	5	Finished	308	0	0	1995	1995	FAIR Exception: Y N

Description	Class	Size SqFt	Eff Yr Blt	RMV	Quantity
No accessory data available					

Bldg: 6 Code Area: 92410 Stat Class: 341 Year Blt: 1995 Eff Year Blt: 1995 Sq.Ft: 420 % Complete: 100.00								
Desc: Multi Purpose Shed (MP)	Dimensions: 21x20 RMV: 4230							
Func Obsc: 100 Econ %: 100 Other %: 100 Exception: 0	Adjust: Adjust RMV: 0							
Floors								
Type	Class	Display Group	Floor Size	Beds	Baths	Yr Blt	Eff Yr Blt	Inventory
Multi-Purpose Bldg	5	Finished	420	0	0	1995	1995	FAIR Exception: Y N

Description	Class	Size SqFt	Eff Yr Blt	RMV	Quantity
No accessory data available					

Bldg: 9 Code Area: 92410 Stat Class: 351 Year Blt: 2007 Eff Year Blt: 2007 Sq.Ft: 696 % Complete: 100.00								
Desc: General Purpose Building (GB)	Dimensions: RMV: 22570							
Func Obsc: 100 Econ %: 100 Other %: 100 Exception: 0	Adjust: Adjust RMV: 0							
Floors								
Type	Class	Display Group	Floor Size	Beds	Baths	Yr Blt	Eff Yr Blt	Inventory
General Purpose Bldg	6	Finished	696	0	0	2007	2007	GOOD Exception: Y N

Description	Class	Size SqFt	Eff Yr Blt	RMV	Quantity		
ROOF EXTENSION OR PATIO COVER	6	696	2007	4550	1	Exception: Y N	

Permit Number	Permit ID	Origin	Category	Type	Estimate Value	% Complete	Roll Type	Description
24-009857	85514	MARION COUNTY	NEW CONSTRUCTION	ADDITION	4183665	0	R	RESIDENTIAL SPORTS COMPLEX ATTACHED TO EXISTING POOL HOUSE AND ENLARGING POOL HOUSE

Farm Notes

not started - RA

2023FARM

1/9/23: New owner letter sent, no response. Check farm use 5/1/24./cwo

2024FARM

24-25: Per CWO 8-29-24 forest and farm use ok - livestock



SKETCH/AREA TABLE ADDENDUM

SUBJECT INFO

File No.: 528112 Parcel No.: 071W31 00900
 Property Address: 9683 EDMUNSON DR SE
 City: Salem County: Marion State: OR ZipCode: 97317
 Owner:
 Client: Client Address:
 Appraiser Name: Inspection Date:

SKETCH

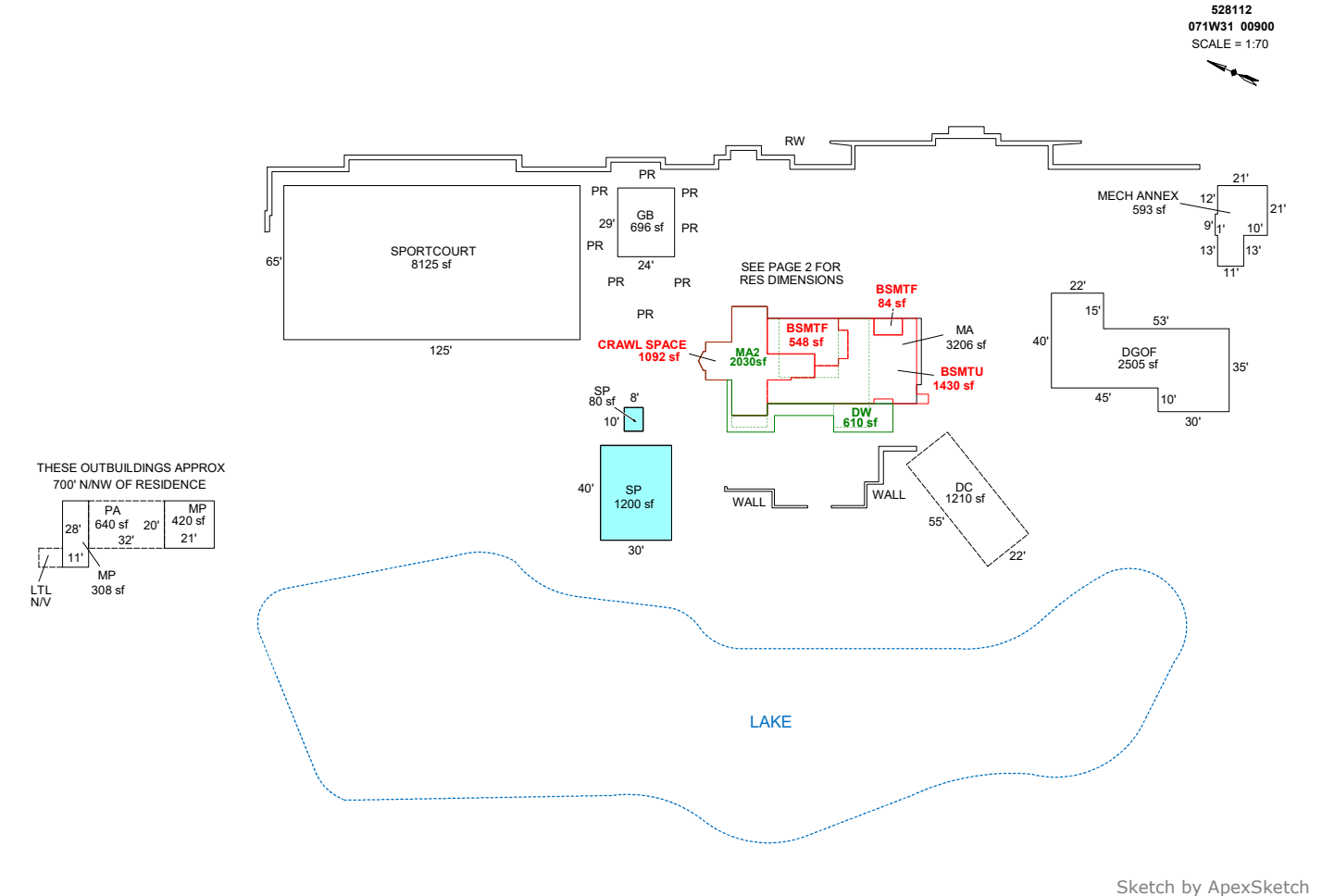

Sketch by ApexSketch

AREA CALCULATIONS SUMMARY

Code	Description	Factor	Net Size	Perimeter	Net Totals
GBA1	MP	1.0	308.0	78.0	
	MP	1.0	420.0	82.0	728.0
GBA2	GB	1.0	696.0	106.0	696.0
GLA0	BSMTF	1.0	548.0	108.0	
	BSMTF	1.0	84.0	38.0	632.0
GLA1	MECH ANNEX	1.0	593.0	112.0	
	MA	1.0	3206.0	276.9	3799.0
GLA2	MA2	1.0	2030.0	312.9	2030.0
BSMT	BSMTU	1.0	1430.0	234.0	1430.0
GAR	DGOF	1.0	2505.0	250.0	
	DC	1.0	1210.0	154.0	3715.0
OTH	SP	1.0	1200.0	140.0	
	SP	1.0	80.0	36.0	
P/P	SPORTCOURT	1.0	8125.0	380.0	9405.0
	DW	1.0	610.0	208.0	
	PA	1.0	640.0	104.0	1250.0
	Net LIVABLE	cnt	3	(rounded)	6,461
	Net BUILDING	cnt	3	(rounded)	1,424

COMMENT TABLE 1

APEX BY JH FROM PLANS 1-4-08
 EDITED BY NRC 11/30/09 (PERMITS CANCELLED)
 UPDATED BY JRONDEMA 3/8/16
 UPDATED BY JRONDEMA 2/3/17
 UPDATED BY JRONDEMA 4/2/19
 UPDATED BY CJURAN 05/09/2023
 UPDATED BY CLOBERG 09/13/24 24-004748 REV MA2

COMMENT TABLE 2

3.28.19 SR #94 TAGS
 MLH 05/09/2023

JSS
1.20.26

COMMENT TABLE 3

SV L4

Tays L3

