

Acct ID: 511257 MTL: 041W27DB00300 Date: 11.23.25 Appr: JJS Prop Class: 409 RMV Prop Class: 409  
 Situs: 18837 HIGHWAY 99E NE HUBBARD OR 97032 MaSaNh: 02 06 000 Unit: 94292 Year: 2025

Last Date Appraised: 01/09/2025 Appraiser: JORDAN SCHULTZ Tag: Y N Tag info: 2026 - NEW CONSTRUCTION (Residence)  
 Owner: ARELLANO, RAYMUNDA Last Sales Date: 07/11/2014 Roll Type: R  
 Cycle: Tag Sales Verification Other: \_\_\_\_\_ Inspection level: 1 2 3 4 LCB TTO INSP AV: 124810  
 RMV Land: 148390 RMV Imp: 105570 RMV Total: 253960 MAV: 98990 MSAV: 0 SAV: 0  
 Comment: 25-26: L3 1.9.25 JJS  
 24-25: L2 1.26.24 JJS

**MA to 35% - H/T 1/1/27**

**OSDs**

Count	Code	Description	RMV	Code Area	Exception
1	MKTF	OSD - FAIR	40000	15519	0

**Land**

Site: 1 Code Area: 15519 Size: 9583 Sqft Use Code: 004 Zone: NREST SAV Use: Exception: 0  
 Class: 2BD Value Source: Rural at MKT Description: TWO BENCH DRY RMV: 108390 Exception: Y N  
 Adjustment(s): GSOIL Fire Patrol: Description:  
 Comments: 24-25: Update land class  
 07-08: RECALC SETUP; #10 9/06/06

**Improvements - Residence / Manufactured Structures**

Bldg: 1 Code Area: 15519 Stat Class: 443 Year Blt: 1972 Eff Year Blt: 1972 Sq.Ft: 792 % Complete: 100.00  
 Desc: MANUF STRUCT, CLASS 4, 12' WIDE SINGLE Dimensions: RMV: 25950  
 Func Obsc: 100 Econ %: 100 Other %: 100 Exception: 0 Adjust: Adjust RMV: 0 Subtype: R

**Floors**

Type	Class	Display Group	Floor Size	Beds	Baths	Yr Blt	Eff Yr Blt	Inventory	Exception
First Floor	4	Finished	792	2	FB-1	1972	1972	SKIRT, ROOF+, KIT-, FP - 1, BATH - 1, HVAC+	Y N

**Accessories**

Description	Class	Size SqFt	Eff Yr Blt	RMV	Quantity
No accessory data available					

Bldg: 1 Code Area: 15519 Stat Class: 107 Year Blt: Eff Year Blt: 1972 Sq.Ft: 0 % Complete: 100.00  
 Desc: Yard Improvements Dimensions: RMV: 15110  
 Func Obsc: 100 Econ %: 100 Other %: 100 Exception: 0 Adjust: Adjust RMV: 0

**Floors**

Type	Class	Display Group	Floor Size	Beds	Baths	Yr Blt	Eff Yr Blt	Inventory
No floor data available								

**Accessories**

Description	Class	Size SqFt	Eff Yr Blt	RMV	Quantity
YARD IMPROVEMENTS AVERAGE	3	1	1972	14252	1

Bldg: 4 Code Area: 15519 Stat Class: 108 Year Blt: Eff Year Blt: 1972 Sq.Ft: 0 % Complete: 100.00  
 Desc: Residential Other Improvements Dimensions: RMV: 640  
 Func Obsc: 100 Econ %: 100 Other %: 100 Exception: 0 Adjust: Adjust RMV: 0

**Floors**

Type	Class	Display Group	Floor Size	Beds	Baths	Yr Blt	Eff Yr Blt	Inventory
No floor data available								

**Accessories**

Description	Class	Size SqFt	Eff Yr Blt	RMV	Quantity
GARDEN SHED	1	48	1972	604	0

Bldg: 5 Code Area: 15519 Stat Class: 131 Year Blt: 2024 Eff Year Blt: 2024 Sq.Ft: 1789 % Complete: 200.00  
 Desc: One Story Only Dimensions: RMV: 54120  
 Func Obsc: 100 Econ %: 100 Other %: 100 Exception: 25820 Adjust: Adjust RMV: 0

**Floors**

Type	Class	Display Group	Floor Size	Beds	Baths	Yr Blt	Eff Yr Blt	Inventory	Exception
First Floor	3	Finished	1789	3	FB-2	2024	2024	BATH - 2, KIT, ROOF, HVAC	Y N
Garage Attached	3	Low Cost	460	0	0	2024	2024	ROOF	Y N

**Accessories**

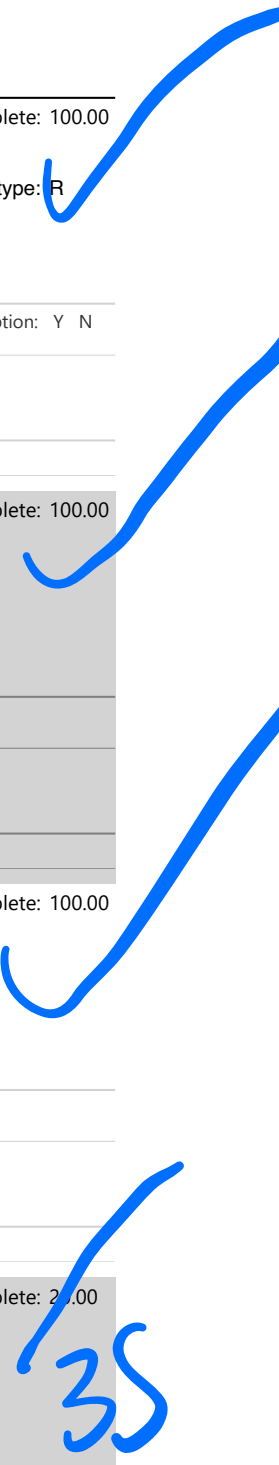

Description	Class	Size SqFt	Eff Yr Blt	RMV	Quantity
No accessory data available					

**Improvements - Accessory Buildings**

Bldg: 3	Code Area: 15519	Stat Class: 321	Year Blt: 1992	Eff Year Blt: 1992	Sq.Ft: 1680	% Complete: 100.00
Desc: Hay Cover (HC)			Dimensions: 60x28		RMV: 9750	
Func Obsc: 100	Econ %: 100	Other %: 100	Exception: 0	Adjust:	Adjust RMV: 0	

**Floors**

Type	Class	Display Group	Floor Size	Beds	Baths	Yr Blt	Eff Yr Blt	Inventory	Exception: Y N
Hay Cover	6	Finished	1680	0	0	1992	1992	FAIR	

**Accessories**

Description	Class	Size SqFt	Eff Yr Blt	RMV	Quantity
No accessory data available					



MA  
to  
35!



MFB to  
right

# SKETCH/AREA TABLE ADDENDUM

## SUBJECT INFO

File No.: 511257 Parcel No.: 041W27DB00300  
 Property Address: 18837 HIGHWAY 99E NE  
 City: HUBBARD County: MARION State: OR ZipCode: 97032  
 Owner:  
 Client: Client Address:  
 Appraiser Name: Inspection Date:

## SKETCH

351.

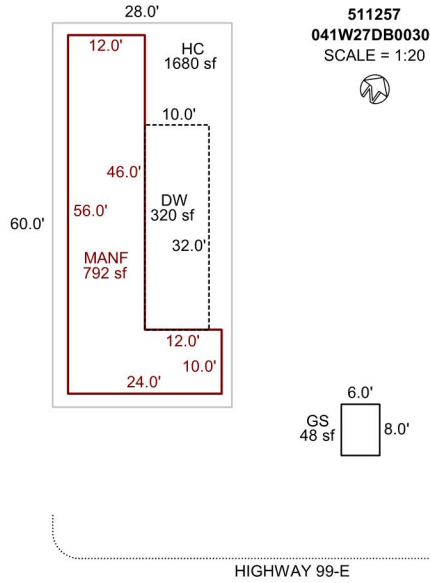
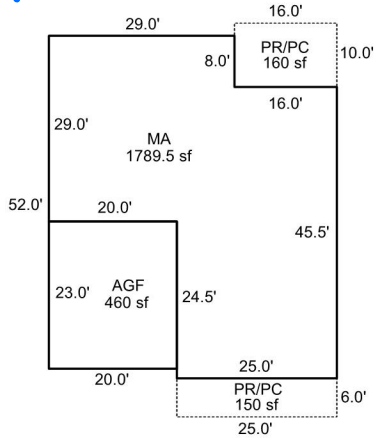

Sketch by Apex Sketch

### AREA CALCULATIONS SUMMARY

Code	Description	Factor	Net Size	Perimeter	Net Totals
GBA1	HC	1.0	1680.0	176.0	
	GS	1.0	48.0	28.0	1728.0
GLA	MANF	1.0	792.0	160.0	792.0
GLA1	MA	1.0	1789.5	197.0	1789.5
GAR	AGF	1.0	460.0	86.0	460.0
P/P	DW	1.0	320.0	84.0	
	PR/PC	1.0	160.0	52.0	
	PR/PC	1.0	150.0	62.0	630.0

### COMMENT TABLE 1

APEXED BY NRC 10/05/2009  
 UPDATED BY CJURAN 08/14/2023 555-22-011648

### COMMENT TABLE 2

### COMMENT TABLE 3

555 1.9.25 Tags LB  
 JSS 12.23.25 Tags L3

Net LIVABLE cnt 2 (rounded) 2,582  
 Net BUILDING cnt 2 (rounded) 1,728

Percent Complete Form

Account # 511257

Additions

New Homes

		New Homes			
		No Basement		Basement	
% Item	% Sum	% Item	% Sum	% Item	% Sum
3%	0%	Plans/Survey	3%	3%	0%
2%		Excavation	2%	4%	
3%		Foundation	3%	10%	
35%	45%	Framing	14%	20%	35%
8%	50%	Trusses	7%	30%	40%
7%	60%	Roofing	7%	35%	45%
7%	65%	Windows/Ext Doors	7%	45%	55%
5%	70%	Siding	5%	50%	60%
4%	75%	Plumbing Rough-In	4%	55%	65%
3%		Electrical Rough-In	3%		
2%	80%	Heating Rough-In	2%	60%	65%
		Heating Unit	1%		
3%		Insulation	3%		
5%	85%	Drywall (Finished)	5%	65%	70%
2%	90%	Paint Interior	2%	70%	75%
2%		Paint Exterior	2%		
	95%	Cabinets	6%	85%	85%
2%		Electrical Fixtures	3%		
2%		Plumbing Fixtures	4%		
3%	100%	Floor Coverings & Countertops	7%	90%	90%
2%		Interior Trim Carpentry	7%		
		Porch/Entry/Stoop	2%		
		Finish Grade	1%	100%	100%

APPR 535  
 APPR 335  
 APPR \_\_\_\_\_  
 APPR \_\_\_\_\_

Date 1/9/25 YR For 25/26  
 Date 12.23.25 YR For 26/27  
 Date \_\_\_\_\_ YR For \_\_\_\_\_  
 Date \_\_\_\_\_ YR For \_\_\_\_\_

% COMP 20  
 % COMP 35  
 % COMP \_\_\_\_\_  
 % COMP \_\_\_\_\_

ACCOUNT # 511257 DATE: 1/9/25 RMV CLASS \_\_\_\_\_ PROP CLASS \_\_\_\_\_  
 MTL \_\_\_\_\_ APPR JSS TAG Y N \_\_\_\_\_  
 COMMENTS: \_\_\_\_\_

RESIDENCE / MANUFACTURED STRUCTURES

ACCESSORY IMPROVEMENTS / OUTBUILDINGS

STAT 131 QLTY + - FLOOR 1st  
 AREA 1789 EFF AREA 1789 BED 3  
 ROOF + HVAC +  
 BATH PKG: \_\_\_\_\_ BATH 2 BATH + \_\_\_\_\_ 1/2 BTH  
 FIREPLACE: \_\_\_\_\_  
 KITCHEN - +  
 YR BLT 2024 EFF YR 2024 ECON \_\_\_\_\_  
 % COMP 20 % GOOD \_\_\_\_\_ FUNC \_\_\_\_\_  
 EXCEPT (Y) N LUMP SUM: \_\_\_\_\_  
 MISC: \_\_\_\_\_  
 YI CLASS \_\_\_\_\_ F G A E  
 SKIRT + LIN FT \_\_\_\_\_  
 COMMENT: R/T - only at 20'.

STAT \_\_\_\_\_ QLTY + - FLOOR \_\_\_\_\_  
 AREA \_\_\_\_\_ EFF AREA \_\_\_\_\_ BED \_\_\_\_\_  
 ROOF + HVAC +  
 BATH PKG: \_\_\_\_\_ BATH \_\_\_\_\_ BATH + \_\_\_\_\_ 1/2 BTH  
 FIREPLACE: \_\_\_\_\_  
 KITCHEN - +  
 YR BLT \_\_\_\_\_ EFF YR \_\_\_\_\_ ECON \_\_\_\_\_  
 % COMP \_\_\_\_\_ % GOOD \_\_\_\_\_ FUNC \_\_\_\_\_  
 EXCEPT Y N LUMP SUM: \_\_\_\_\_  
 MISC: \_\_\_\_\_  
 YI CLASS \_\_\_\_\_ F G A E  
 SKIRT + LIN FT \_\_\_\_\_  
 COMMENT: \_\_\_\_\_

STAT \_\_\_\_\_ QLTY + - FLOOR \_\_\_\_\_  
 AREA \_\_\_\_\_ EFF AREA \_\_\_\_\_ BED \_\_\_\_\_  
 ROOF + HVAC +  
 BATH PKG: \_\_\_\_\_ BATH \_\_\_\_\_ BATH + \_\_\_\_\_ 1/2 BTH  
 FIREPLACE: \_\_\_\_\_  
 KITCHEN - +  
 YR BLT \_\_\_\_\_ EFF YR \_\_\_\_\_ ECON \_\_\_\_\_  
 % COMP \_\_\_\_\_ % GOOD \_\_\_\_\_ FUNC \_\_\_\_\_  
 EXCEPT Y N LUMP SUM: \_\_\_\_\_  
 MISC: \_\_\_\_\_  
 YI CLASS \_\_\_\_\_ F G A E  
 SKIRT + LIN FT \_\_\_\_\_  
 COMMENT: \_\_\_\_\_

TYPE AGL  
 STAT / CLASS \_\_\_\_\_  
 SIZE 460 SF  
 FAIR  
AVERAGE  
 GOOD  
 EXCELLENT  
 BATH \_\_\_\_\_  
 YR BLT 2024  
 EFF YR 2024  
 % COMP 20  
 EXCEPT (Y) N  
 MISC: \_\_\_\_\_  
 COMMENT: \_\_\_\_\_

TYPE \_\_\_\_\_  
 STAT / CLASS \_\_\_\_\_  
 SIZE \_\_\_\_\_  
 FAIR  
 AVERAGE  
 GOOD  
 EXCELLENT  
 BATH \_\_\_\_\_  
 YR BLT \_\_\_\_\_  
 EFF YR \_\_\_\_\_  
 % COMP \_\_\_\_\_  
 EXCEPT Y N  
 MISC: \_\_\_\_\_  
 COMMENT: \_\_\_\_\_

TYPE \_\_\_\_\_  
 STAT / CLASS \_\_\_\_\_  
 SIZE \_\_\_\_\_  
 FAIR  
 AVERAGE  
 GOOD  
 EXCELLENT  
 BATH \_\_\_\_\_  
 YR BLT \_\_\_\_\_  
 EFF YR \_\_\_\_\_  
 % COMP \_\_\_\_\_  
 EXCEPT Y N  
 MISC: \_\_\_\_\_  
 COMMENT: \_\_\_\_\_

TYPE \_\_\_\_\_  
 STAT / CLASS \_\_\_\_\_  
 SIZE \_\_\_\_\_  
 FAIR  
 AVERAGE  
 GOOD  
 EXCELLENT  
 BATH \_\_\_\_\_  
 YR BLT \_\_\_\_\_  
 EFF YR \_\_\_\_\_  
 % COMP \_\_\_\_\_  
 EXCEPT Y N  
 MISC: \_\_\_\_\_  
 COMMENT: \_\_\_\_\_

# Assessor Monthly Issued Permit Report

For 7/1/2023 to 7/31/2023

PERMIT#: 555-22-011648-DWL STATUS: Permit Issued  
 PERMIT TYPE: Residential APPLIED: 12/27/2022  
 SUB-TYPE: 1 & 2 Fam Dwelling (New Only) ISSUED: 7/18/2023  
 CATEGORY: Comprehensive EXPIRES: 1/14/2024

OFFICE: MC  
 PARCEL#: 041W27DB00300 R11257  
 ACRES: 0.22  
 SUBDIV:  
 LOT/BLOCK: /  
 ADDRESS: 18837 HIGHWAY 99E NE HUBBARD, OR 97032

RELATIONSHIP	NAME	ADDRESS	PHONE
APPLICANT	ARELLANO, RAYMUNDA	18837 HIGHWAY 99E NE HUBBARD, OR 97032	503-969-2565
OWNER	ARELLANO, RAYMUNDA	18837 HIGHWAY 99E NE HUBBARD, OR 97032	
OWNER (PROPERTY)	SEE PROPERTY OWNER INFORMATION	OR	
SITE CONTACT	ARELLANO, RAYMUNDA	18837 HIGHWAY 99E NE HUBBARD, OR 97032	503-969-2565

CONST CAT: Single Family Dwelling

WORK TYPE: New

WORK DESC: NSFD 3 BDRM TO REPL 2 BDRM

VALUATION: \$305,714.03

STORIES: 1

BATHS: 2

KITCHENS: 1

## SQUARE FEET

HABITABLE: 990

EXISTING:

NEW:

**TOTAL SQ. FT.: 2253**

OCCUPANCY	CONSTRUCTION TYPE	SQ FT or # OF SPACES
R-3 1 & 2 family	VB	1782 Sq Ft
U Utility, misc.	VB	471 Sq Ft
U Utility, misc. - half rate	VB	278 Sq Ft