

SKETCH/AREA TABLE ADDENDUM

SUBJECT INFO

File No.: 608721 Parcel No.: 083W22CA08100
 Property Address: 760 Emily Grace Ln SE
 City: Salem County: Marion State: OR ZipCode: 97306
 Owner:
 Client: Client Address:
 Appraiser Name: Inspection Date:

SKETCH

608721
083W22CA08100

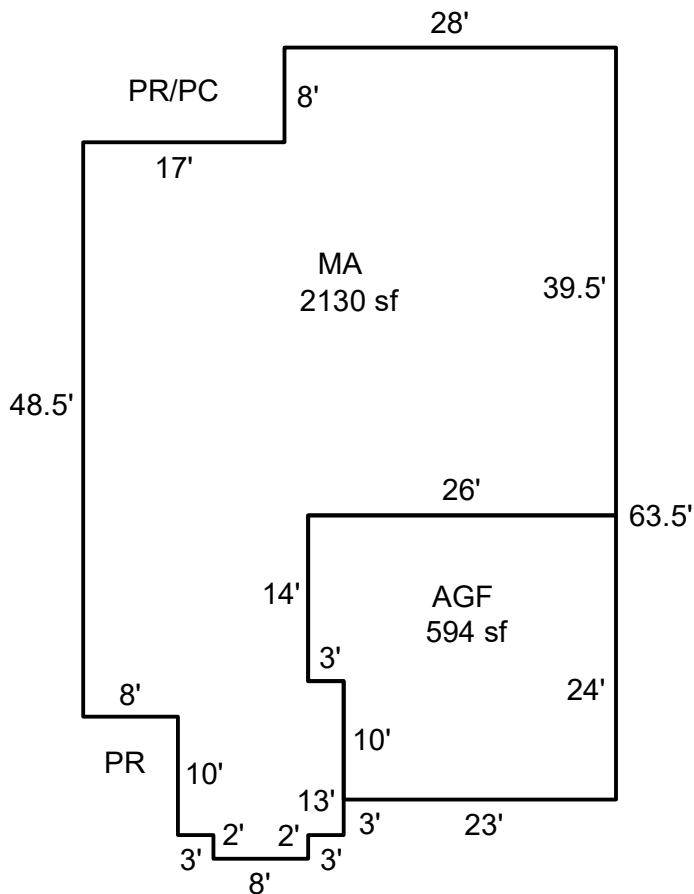

Sketch by ApexSketch

AREA CALCULATIONS SUMMARY

Code	Description	Factor	Net Size	Perimeter	Net Totals
GLA	MA	1.0	2129.5	233.0	2129.5
GAR	AGF	1.0	594.0	100.0	594.0

COMMENT TABLE 1

Drawn by AE 3.27.26

COMMENT TABLE 2

COMMENT TABLE 3

Net LIVABLE cnt 1 (rounded) 2,130