

Summary

INPUT WW 4/8/26

Lead Appr: Clerk: Lead Clerk: Appr:

Print Date:

3/9/2026

Acct ID: 553500 MTL: 082W15D003100 Date: 3/12/26 Appr: WW Prop Class: 401 RMV Prop Class: 401  
Situs: 7471 LOFTY LOOP SE SALEM OR 97317 MaSaNh: 07 06 000 Unit: 98076 Year: 2026

Last Date Appraised: 09/22/2023 Appraiser: MATT LORD Tag: Y N Tag info: 2024 - Tags/Permit (Completion)  
Owner: FOWLER, LADD Last Sales Date: 01/20/2026 Roll Type: R  
Cycle Tag: Sales Verification Other: Inspection level: 1 2 3 4 LCB TTO INSP AV: 771760  
RMV Land: 384500 RMV Imp: 774940 RMV Total: 1159440 MAV: 771760 MSAV: 0 SAV: 0  
Comment: 24-25: L3 09.22.23 GRH  
23-24: L2 01.06.23 MLH//22-23: L2 09.10.21 GRH

OSDs

Count	Code	Description	RMV	Code Area	Exception
1	MKTG	OSD - GOOD	65000	05550	0

MCS 827671  
DOM 281  
COM 554

Land

Site: 1 Code Area: 05550 Size: 3.07 Acres Use Code: 004 Zone: NREST SAV Use: Exception: 0  
Class: 2BDSS Value Source: Rural at MKT Description: TWO BENCH DRY SOUTH SPECIAL RMV: 319500 Exception: Y N  
Adjustment(s): VWAR, GSOIL Fire Patrol: Description:  
Comments: 2002-03 REAPPRAISAL. //04-05: LAND SCHEDULE CHANGE FOR RECALCULATION BY #29\_

Improvements - Residence / Manufactured Structures

Bldg: 1 Code Area: 05550 Stat Class: 142+ Year Blt: 1981 Eff Year Blt: 1987 Sq.Ft: 4400 % Complete: 100.00  
Desc: Multi Story above grade Dimensions: RMV: 548500  
Func Obsc: 100 Econ %: 100 Other %: 100 Exception: 0 Adjust: Adjust RMV: 0

Floors

Type	Class	Display Group	Floor Size	Beds	Baths	Yr Blt	Eff Yr Blt	Inventory	Exception
First Floor	4 +	Finished	3004	1	FB-2/ HB-1	1981	1987	HVAC, ROOF, KIT, BTH - 1, BATH - 2 FP	Y N
Second Floor	4 +	Finished	1108	5	FB-2	1981	1987	HVAC, BATH - 2	Y N
Attic	4 +	Finished	288	0	0	1981	1987	HVAC	Y N
Garage Attached	4	Finished	686	0	0	1996	1996	ROOF	Y N

Accessories

Description	Class	Size SqFt	Eff Yr Blt	RMV	Quantity	Exception
YARD IMPROVEMENTS GOOD	5	0	1987	37868	1	Y N

Improvements - Accessory Buildings

Bldg: 2 Code Area: 05550 Stat Class: 351 Year Blt: 1989 Eff Year Blt: 2007 Sq.Ft: 3078 % Complete: 100.00  
Desc: General Purpose Building (GB) Dimensions: 38x81 RMV: 51160  
Func Obsc: 100 Econ %: 100 Other %: 100 Exception: 0 Adjust: Adjust RMV: 0

Floors

Type	Class	Display Group	Floor Size	Beds	Baths	Yr Blt	Eff Yr Blt	Inventory	Exception
General Purpose Bldg	6	Finished	3078	0	0	1989	2007	FAIR	Y N

Accessories

Description	Class	Size SqFt	Eff Yr Blt	RMV	Quantity	Exception
No accessory data available						

Bldg: 3 Code Area: 05550 Stat Class: 351 Year Blt: 1996 Eff Year Blt: 2007 Sq.Ft: 3056 % Complete: 100.00  
Desc: General Purpose Building (GB) Dimensions: RMV: 100530  
Func Obsc: 100 Econ %: 100 Other %: 100 Exception: 0 Adjust: Adjust RMV: 0

Floors

Type	Class	Display Group	Floor Size	Beds	Baths	Yr Blt	Eff Yr Blt	Inventory	Exception
General Purpose Bldg	6	Finished	3056	0	FB-1	1996	2007	AVG, EXCLT, BATH - 1	Y N

Accessories

Description	Class	Size SqFt	Eff Yr Blt	RMV	Quantity	Exception
FINISHED OFFICE IN A FARM BUILDING	6	1088	2007	25938	0	Y N

Bldg: 4 Code Area: 05550 Stat Class: 905 Year Blt: 2021 Eff Year Blt: 2021 Sq.Ft: 0 % Complete: 100.00  
Desc: Rural Solar Panel/Array Dimensions: RMV: 36000  
Func Obsc: 100 Econ %: 100 Other %: 100 Exception: 0 Adjust: Adjust RMV: 0

Floors

Type	Class	Display Group	Floor Size	Beds	Baths	Yr Blt	Eff Yr Blt	Inventory
------	-------	---------------	------------	------	-------	--------	------------	-----------

No floor data available

**Accessories**

Description	Class	Size SqFt	Eff Yr Blt	RMV	Quantity
-------------	-------	-----------	------------	-----	----------

No accessory data available

Bldg: 5    Code Area: 05550    Stat Class: 351    Year Blt: 2022    Eff Year Blt: 2022    Sq.Ft: 1344    % Complete: 100.00  
 Desc: General Purpose Building (GB)    Dimensions: 24x56    RMV: 36800  
 Func Obsc: 100    Econ %: 100    Other %: 100    Exception: 0    Adjust:    Adjust RMV: 0

**Floors**

Type	Class	Display Group	Floor Size	Beds	Baths	Yr Blt	Eff Yr Blt	Inventory
------	-------	---------------	------------	------	-------	--------	------------	-----------

General Purpose Bldg	6	Finished	1344	0	0	2022	2022	FAIR / <i>good</i> Exception: <input checked="" type="checkbox"/> Y <input type="checkbox"/> N
----------------------	---	----------	------	---	---	------	------	--

**Accessories**

Description	Class	Size SqFt	Eff Yr Blt	RMV	Quantity
-------------	-------	-----------	------------	-----	----------

No accessory data available

Bldg: 6    Code Area: 05550    Stat Class: 355    Year Blt:    Eff Year Blt: 2007    Sq.Ft: 408    % Complete: 100.00  
 Desc: Lean-to Heavy (LTH)    Dimensions: 12x34    RMV: 1950  
 Func Obsc: 100    Econ %: 100    Other %: 100    Exception: 0    Adjust:    Adjust RMV: 0

**Floors**

Type	Class	Display Group	Floor Size	Beds	Baths	Yr Blt	Eff Yr Blt	Inventory
------	-------	---------------	------------	------	-------	--------	------------	-----------

Lean-to Heavy Duty	4	Finished	408	0	0	0	2007	Exception: Y <input type="checkbox"/> N <input type="checkbox"/>
--------------------	---	----------	-----	---	---	---	------	--

**Accessories**

Description	Class	Size SqFt	Eff Yr Blt	RMV	Quantity
-------------	-------	-----------	------------	-----	----------

No accessory data available

# SKETCH/AREA TABLE ADDENDUM

## SUBJECT INFO

File No.: 553500 Parcel No.: 082W15D 03100  
 Property Address: 7471 LOFTY LOOP SE  
 City: SALEM County: MARION State: OR ZipCode: 97317  
 Owner:  
 Client: Client Address:  
 Appraiser Name: Inspection Date:

## SKETCH

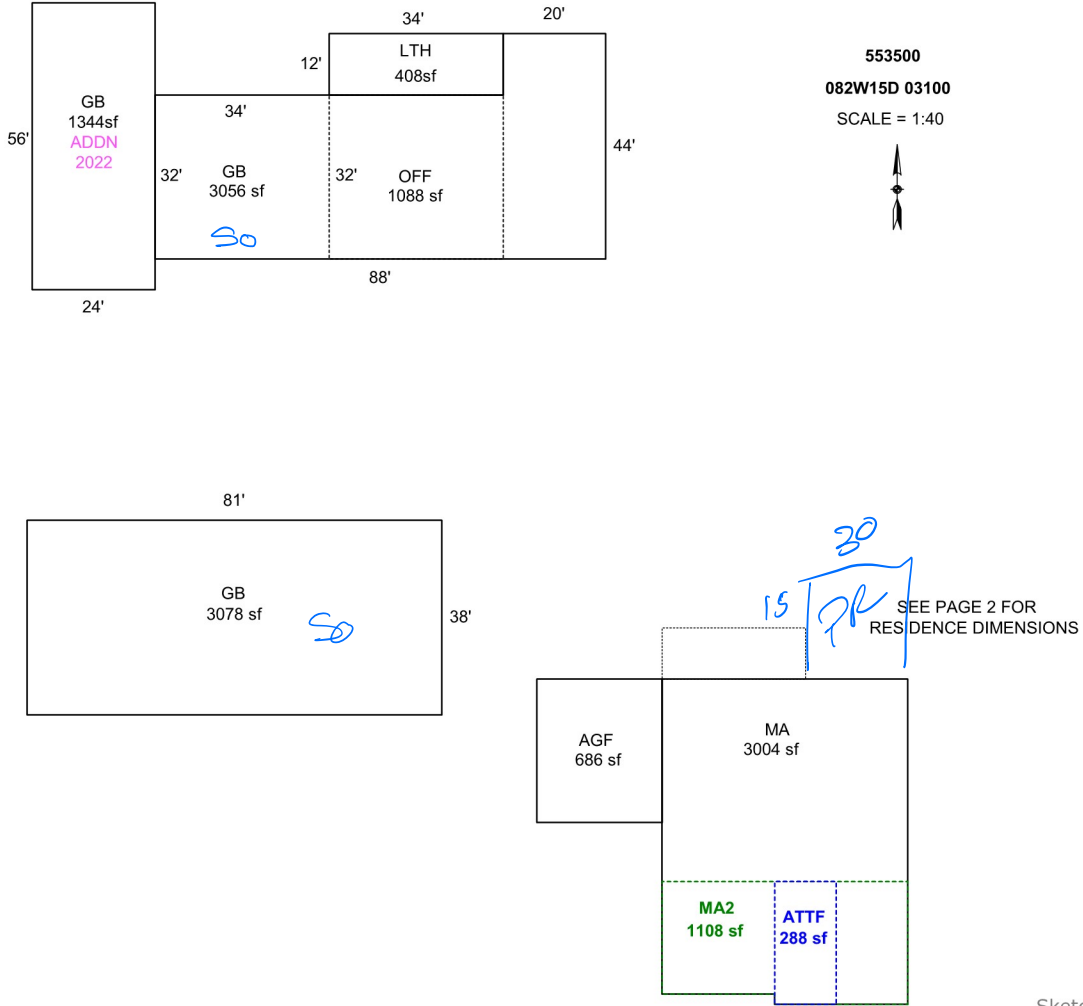

Sketch by Apex Sketch

### AREA CALCULATIONS SUMMARY

Code	Description	Factor	Net Size	Perimeter	Net Totals
GBA1	ATTF	1.0	288.0	72.0	
	GB	1.0	3056.0	264.0	
	GB	1.0	3078.0	238.0	
	GB	1.0	1344.0	160.0	
	LTH	1.0	408.0	92.0	8174.0
GLA1	MA	1.0	3004.0	223.0	3004.0
GLA2	MA2	1.0	1108.0	144.0	1108.0
GAR	AGF	1.0	686.0	105.0	686.0
OTH	OFF	1.0	1088.0	132.0	1088.0
P/P	DW	1.0	280.0	76.0	280.0
	Net LIVABLE	cnt	2 (rounded)		4,112
	Net BUILDING	cnt	5 (rounded)		8,174

### COMMENT TABLE 1

3/10/17 BY CW  
 UPDATED BY CJURAN 08/11/2022 555-22-004542  
 UPDATED BY CJURAN 03/14/2023

### COMMENT TABLE 2

MLH 01/06/2023

### COMMENT TABLE 3

TAGS L2

# SKETCH/AREA TABLE ADDENDUM

## SUBJECT INFO

File No.: 553500 Parcel No.: 082W15D 03100  
 Property Address: 7471 LOFTY LOOP SE  
 City: SALEM County: MARION State: OR ZipCode: 97317  
 Owner:  
 Client: Client Address:  
 Appraiser Name: Inspection Date:

## SKETCH

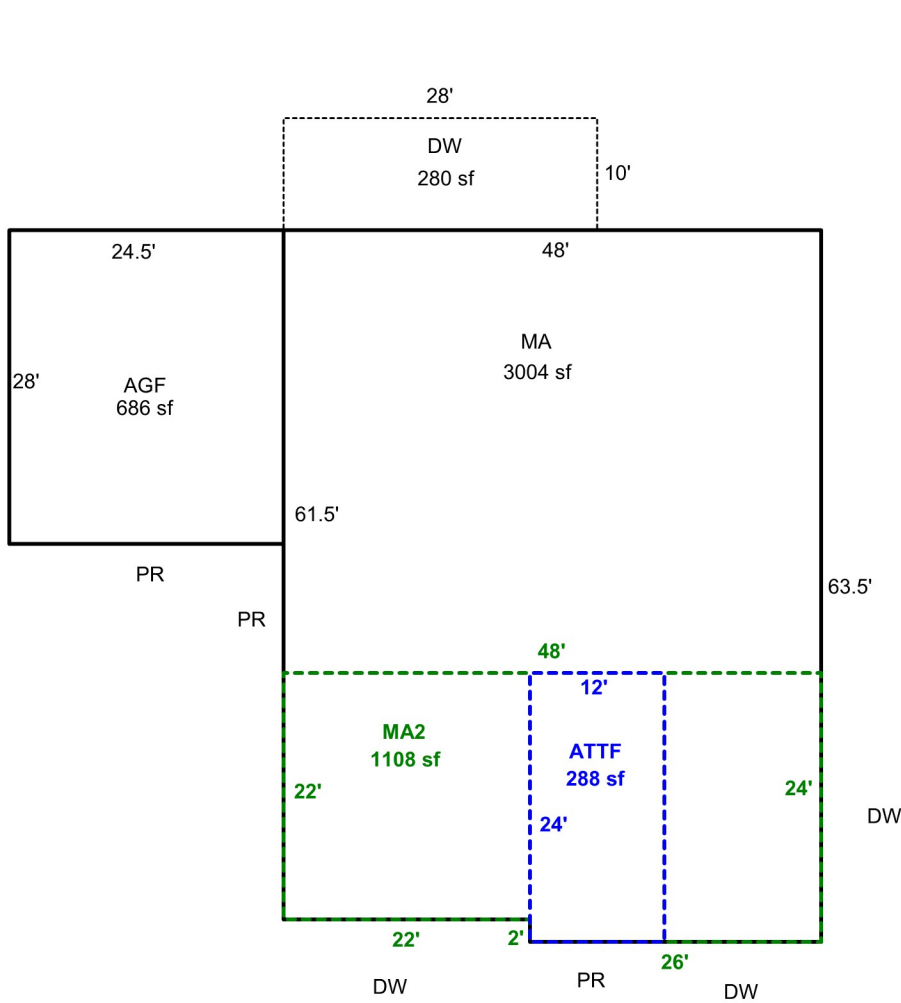

**553500**  
**082W15D 03100**  
 SCALE = 1:20  
 SEE PAGE 1 FOR ALL BLDGS



Sketch by Apex Sketch

### AREA CALCULATIONS SUMMARY

Code	Description	Factor	Net Size	Perimeter	Net Totals
GBA1	ATTF	1.0	288.0	72.0	288.0
GLA1	MA	1.0	3004.0	223.0	3004.0
GLA2	MA2	1.0	1108.0	144.0	1108.0
GAR	AGF	1.0	686.0	105.0	686.0
P/P	DW	1.0	280.0	76.0	280.0

### COMMENT TABLE 1

3/10/17 BY CW  
 UPDATED BY CJURAN 08/11/2022 555-22-004542  
 UPDATED BY CJURAN 03/14/2023

### COMMENT TABLE 2

MLH 01/06/2023

### COMMENT TABLE 3

TAGS L2

Net LIVABLE	cnt	2	(rounded)	4,112
Net BUILDING	cnt	1	(rounded)	288

## Value Comparison MARION County

**Account ID** 553500      **Map** 082W15D003100      **RMV Class** 401      **Property Class** 401      **Situs** 7471 LOFTY LOOP SE SALEM OR 97317  
**Workflow ID** 7608881      **Last** williams      **Status** Open      **Operation** Sales Verification  
**Year** 2026      **Changed** 08-Apr-2026      **Comments** UPD INV

	Value Source	RMV	M5	Exception	MAV	MSAV	Taxable
Prev	Rural at MKT 3.07 Acres	\$319,500	\$319,500	\$0	\$217,730	\$0	\$217,730
New	Rural at MKT 3.07 Acres	\$319,500	\$319,500	\$0	\$217,730	\$0	\$217,730
		\$0	\$0	\$0	\$0	\$0	\$0
Prev	OSD - GOOD	\$65,000	\$65,000	\$0	\$61,560	\$0	\$61,560
New	OSD - EXCELLENT	\$75,000	\$75,000	\$0	\$61,560	\$0	\$61,560
		\$10,000	\$10,000	\$0	\$0	\$0	\$0
Prev	142 RESIDENCE 4400 Sqft	\$548,500	\$548,500	\$0	\$402,860	\$0	\$402,860
New	142 RESIDENCE 4400 Sqft	\$548,500	\$548,500	\$0	\$402,860	\$0	\$402,860
		\$0	\$0	\$0	\$0	\$0	\$0
Prev	351 FARM BLDG 3078 Sqft	\$51,160	\$51,160	\$0	\$25,340	\$0	\$25,340
New	351 FARM BLDG 3078 Sqft	\$51,160	\$51,160	\$0	\$25,340	\$0	\$25,340
		\$0	\$0	\$0	\$0	\$0	\$0
Prev	351 FARM BLDG 3056 Sqft	\$100,530	\$100,530	\$0	\$46,410	\$0	\$46,410
New	351 FARM BLDG 3056 Sqft	\$100,530	\$100,530	\$0	\$46,410	\$0	\$46,410
		\$0	\$0	\$0	\$0	\$0	\$0
Prev	905 FARM BLDG 0 Sqft	\$36,000	\$0	\$0	\$0	\$0	\$0
New	905 FARM BLDG 0 Sqft	\$36,000	\$0	\$0	\$0	\$0	\$0
		\$0	\$0	\$0	\$0	\$0	\$0
Prev	351 FARM BLDG 1344 Sqft	\$36,800	\$36,800	\$0	\$17,860	\$0	\$17,860
New	351 FARM BLDG 1344 Sqft	\$36,800	\$36,800	\$0	\$17,860	\$0	\$17,860
		\$0	\$0	\$0	\$0	\$0	\$0
Prev	355 FARM BLDG 408 Sqft	\$1,950	\$1,950	\$0	\$0	\$0	\$0
New	355 FARM BLDG 408 Sqft	\$1,950	\$1,950	\$0	\$0	\$0	\$0
		\$0	\$0	\$0	\$0	\$0	\$0
	<b>Total Prev</b>	<b>\$1,159,440</b>	<b>\$1,123,440</b>	<b>\$0</b>	<b>\$771,760</b>	<b>\$0</b>	<b>\$771,760</b>
	<b>Total New</b>	<b>\$1,169,440</b>	<b>\$1,133,440</b>	<b>\$0</b>	<b>\$771,760</b>	<b>\$0</b>	<b>\$771,760</b>
	<b>Total Change</b>	<b>\$10,000</b>	<b>\$10,000</b>	<b>\$0</b>	<b>\$0</b>	<b>\$0</b>	<b>\$0</b>

## Value Comparison MARION County

**Account ID** 553500      **Map** 082W15D003100      **RMV Class** 401      **Property Class** 401      **Situs** 7471 LOFTY LOOP SE SALEM OR 97317  
**Workflow ID** 7608881      **Last** williams      **Status** Open      **Operation** Sales Verification  
**Year** 2026      **Changed** 08-Apr-2026      **Comments** UPD INV

	Value Source	RMV	M5	Exception	MAV	MSAV	Taxable
Prev	Rural at MKT 3.07 Acres	\$319,500	\$319,500	\$0	\$217,730	\$0	\$217,730
New	Rural at MKT 3.07 Acres	\$319,500	\$319,500	\$0	\$217,730	\$0	\$217,730
		\$0	\$0	\$0	\$0	\$0	\$0
Prev	OSD - GOOD	\$65,000	\$65,000	\$0	\$61,560	\$0	\$61,560
New	OSD - EXCELLENT	\$75,000	\$75,000	\$0	\$61,560	\$0	\$61,560
		\$10,000	\$10,000	\$0	\$0	\$0	\$0
Prev	142 RESIDENCE 4400 Sqft	\$548,500	\$548,500	\$0	\$402,860	\$0	\$402,860
New	152 RESIDENCE 4400 Sqft	\$727,450	\$727,450	\$177,670	\$402,860	\$0	\$580,530
		\$178,950	\$178,950	\$177,670	\$0	\$0	\$177,670
Prev	351 FARM BLDG 3078 Sqft	\$51,160	\$51,160	\$0	\$25,340	\$0	\$25,340
New	351 FARM BLDG 3078 Sqft	\$57,030	\$57,030	\$0	\$25,340	\$0	\$25,340
		\$5,870	\$5,870	\$0	\$0	\$0	\$0
Prev	351 FARM BLDG 3056 Sqft	\$100,530	\$100,530	\$0	\$46,410	\$0	\$46,410
New	351 FARM BLDG 3056 Sqft	\$74,590	\$74,590	\$0	\$46,410	\$0	\$46,410
		(\$25,940)	(\$25,940)	\$0	\$0	\$0	\$0
Prev	905 FARM BLDG 0 Sqft	\$36,000	\$0	\$0	\$0	\$0	\$0
New	905 FARM BLDG 0 Sqft	\$36,000	\$0	\$0	\$0	\$0	\$0
		\$0	\$0	\$0	\$0	\$0	\$0
Prev	351 FARM BLDG 1344 Sqft	\$36,800	\$36,800	\$0	\$17,860	\$0	\$17,860
New	351 FARM BLDG 1344 Sqft	\$48,100	\$48,100	\$19,800	\$17,860	\$0	\$37,660
		\$11,300	\$11,300	\$19,800	\$0	\$0	\$19,800
Prev	355 FARM BLDG 408 Sqft	\$1,950	\$1,950	\$0	\$0	\$0	\$0
New	355 FARM BLDG 408 Sqft	\$1,950	\$1,950	\$0	\$0	\$0	\$0
		\$0	\$0	\$0	\$0	\$0	\$0
	<b>Total Prev</b>	<b>\$1,159,440</b>	<b>\$1,123,440</b>	<b>\$0</b>	<b>\$771,760</b>	<b>\$0</b>	<b>\$771,760</b>
	<b>Total New</b>	<b>\$1,339,620</b>	<b>\$1,303,620</b>	<b>\$197,470</b>	<b>\$771,760</b>	<b>\$0</b>	<b>\$969,230</b>
	<b>Total Change</b>	<b>\$180,180</b>	<b>\$180,180</b>	<b>\$197,470</b>	<b>\$0</b>	<b>\$0</b>	<b>\$197,470</b>