

Acct ID: 522796 MTL: 072W11C000800 Date: 1/7/26 Appr: MLH Prop Class: 551 RMV Prop Class: 451
 Situs: 7620 HERON ST NE SALEM OR 97305 MaSaNh: 03 06 000 Unit: 61313 Year: 2026

Last Date Appraised: 07/27/2020 Appraiser: MATTHEW HAMILTON Tag: Y N Tag info:
 Owner: KIRSCH, KYLE & KIRSCH, ELISHA Last Sales Date: 09/28/2018 Roll Type: R
 Cycle Tag Sales Verification Other: _____ Inspection level: 1 2 3 4 LCB TTO INSP AV: 390420
 RMV Land: 92710 RMV Imp: 487730 RMV Total: 580440 MAV: 373110 MSAV: 17310 SAV: 42680
 Comment:

*NEW Solar on 522786
 Update Inventory*

*Input as LH 3/20/26
 Form ?*

Notations

RP/MS	Code	Description
RP	ZONED	FARM EFU ZONED

OSDs

Count	Code	Description	RMV	Code Area	Exception
1	SAA	SA OSD - AVERAGE	55000	04410	0

Land

Site: 1 Code Area: 04410 Size: 0.90 Acres Use Code: 005 Zone: REST SAV Use: 011 Exception: 0
 Class: 1 Value Source: Farm Homesite Description: RMV: 37710 Exception: Y N
 Adjustment(s): Fire Patrol: Description:
 Comments: 21-22: APPROVED FOR SA HOMESITE AND OSD// 17-18: DISQ HOMESITE AND OSD, OWNS NO OTHER FARM LAND.//06-07: RECALC SETUP;#19 06-09-05

Improvements - Residence / Manufactured Structures

Bldg: 1 Code Area: 04410 Stat Class: 144 Year Blt: 1970 Eff Year Blt: 1989 Sq.Ft: 4037 % Complete: 100.00
 Desc: Multi Story above grade with basement Dimensions: RMV: 487730
 Func Obsc: 100 Econ %: 100 Other %: 100 Exception: 0 Adjust: Adjust RMV: 0 *F/O*

Floors

Type	Class	Display Group	Floor Size	Beds	Baths	Yr Blt	Eff Yr Blt	Inventory	Exception
First Floor	4	Finished	2223	2	FB-2	1970	1989	FB-2, HVAC+, ROOF, KIT+, BATH - 2	Exception: Y N
Second Floor	4	Finished	1566	1	FB-1	1970	1989	BATH - 1, HVAC+	Exception: Y N
Basement	4	Finished	242	0	FB-1	1970	1989	HVAC+, BATH - 1	Exception: Y N
Garage Attached	4	Finished	742	0	0	1970	1989	ROOF	Exception: Y N

Accessories

Description	Class	Size SqFt	Eff Yr Blt	RMV	Quantity	Exception
ENCLOSED PORCH	4	400	1989	11152	1	Exception: Y N
YARD IMPROVEMENTS AVERAGE	4	1	1989	22263	1	Exception: Y N

Permits

Permit Number	Permit ID	Origin	Category	Type	Estimate Value	% Complete	Roll Type	Description
25-007126	85509	MARION COUNTY	TAGS/PERMITS	ALT ENERGY SYSTEM	30750	0	R	SOLAR ARRAY 24.6kW ON ROOF @ \$30,750



SKETCH/AREA TABLE ADDENDUM

Parcel No 072W11C 00800

File No R22796

SUBJECT	Property Address 7620	City SALEM	State OR	Zip 97305
	Owner			
	Client			
	Appraiser Name			

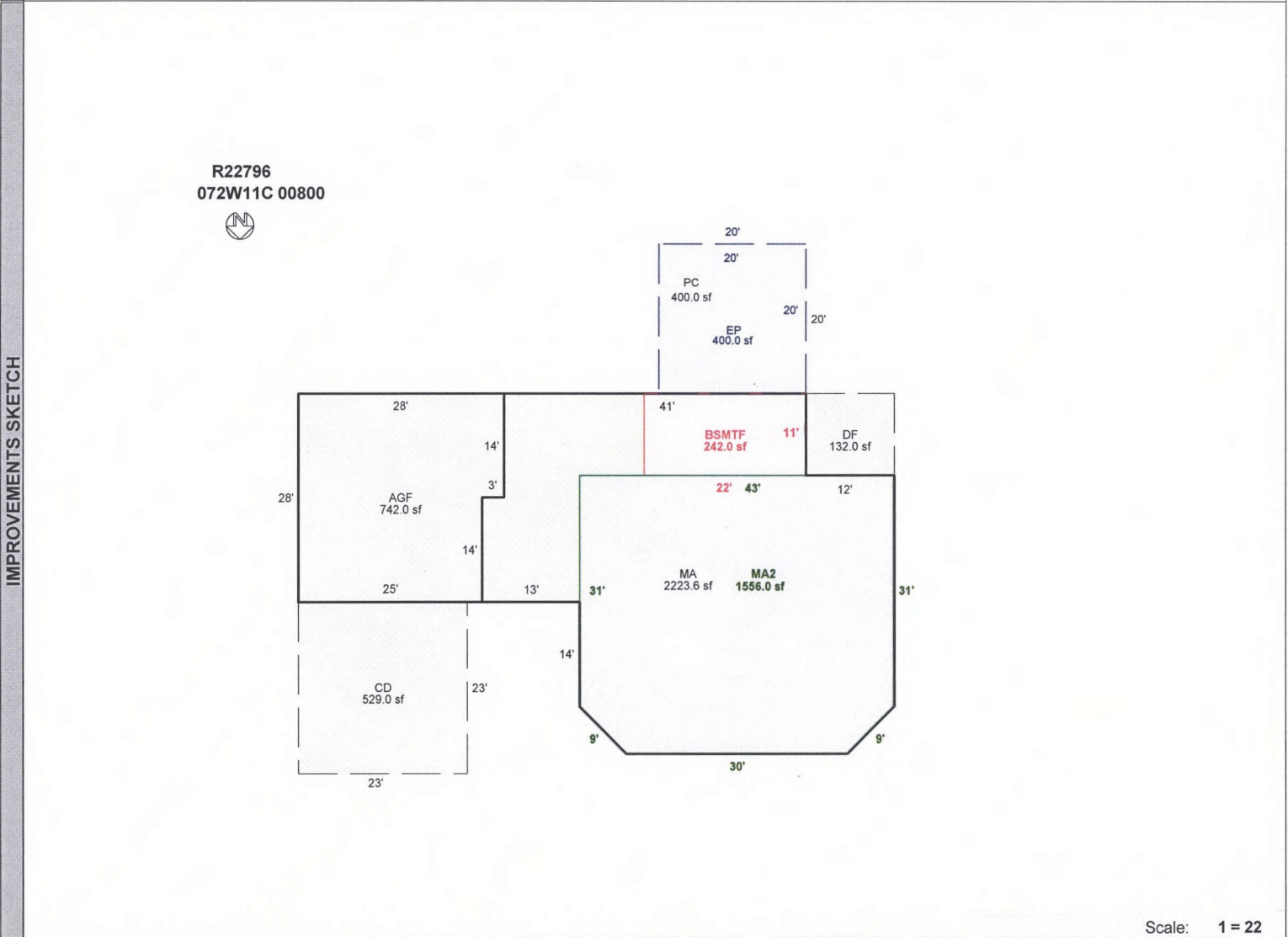

Scale: 1 = 22

AREA CALCULATIONS	AREA CALCULATIONS SUMMARY					
	Code	Description	Factor	Net Size	Perimeter	Net Totals
	GLA1	MA	1.00	2223.6	201.3	2223.6
	GLA0	BSMTF	1.00	242.0	66.0	242.0
	GBA1	MA2	1.00	1556.0	152.7	1556.0
	GAR	AGF	1.00	742.0	112.0	742.0
	P/P	DF	1.00	132.0	46.0	
		PC	1.00	400.0	80.0	
		CD	1.00	529.0	92.0	
		EP	1.00	400.0	80.0	1461.0
Net LIVABLE Area		(rounded w/ factors)		2466		
Net BUILDING Area		(rounded w/ factors)		1556		
APEXED BY NRC 08/21/09 Updated 8/1/12 to add EP - Jane						
MLH 1/7/26			Tags L2			