

Summary Lead Appr: WW 4.15.25 Clerk: Lead Clerk: Appr: GRH Print Date: 1/25/2024

Acct ID: 519577 MTL: 063W150000400 Date: 04.08.25 Appr: GRH Prop Class: 581 RMV Prop Class: 581
Situs: 791 SALMON ST N SALEM OR 97303 MaSaNh: 04 06 000 Unit: 25030 Year: 2024

Last Date Appraised: 04/22/2020 Appraiser: GERARDO RAMIREZ Retag: Y N Tag info: 2025
HERNANDEZ

Owner: CHAPIN AG LANDS #1 LLC Roll Type: R
Cycle Tag Sales Verification Other: Inspection level: 1 2 3 4 TTO INSP AV: 100269
RMV Land: 170260 RMV Imp: 102680 RMV Total: 272940 MAV: 57040 MSAV: 43229 SAV: 115667
Comment: LEVEL 4 C19 05.12.20 JS29//
09.10.24 L2 LCB

Update inv

Notations

RP/MS	Code	Description
RP	DFL	DESIGNATED FORESTLAND
RP	ZONED	FARM EFU ZONED

FARM USE ORCHARD,
DFL OK

OSDs

Count	Code	Description	RMV	Code Area	Exception
1	SAA	SA OSD - AVERAGE	40000	92410	0

Land

Site: 2	Code Area: 92410	Size: 1.00 Acres	Use Code: 005	Zone: REST	SAV Use: 011	Exception: 0
Class: 2BI	Value Source: Farm Homesite	Description: TWO BENCH IRR	RMV: 5180	Exception: Y N		
Adjustment(s):	GSOIL, IRR	Fire Patrol:	Description:			
Comments:	Liability year - 2009 / 2400210					
Site: 3	Code Area: 92410	Size: 19.50 Acres	Use Code: 005	Zone: REST	SAV Use: 011	Exception: 0
Class: 2BI	Value Source: Farm Use - EFU	Description: TWO BENCH IRR	RMV: 100910	Exception: Y N		
Adjustment(s):	GSOIL, IRR	Fire Patrol:	Description:			
Comments:	Liability year - 1976 / 2400210					
Site: 4	Code Area: 92410	Size: 5.37 Acres	Use Code: 005	Zone: REST	SAV Use: 011	Exception: 0
Class: FTLB	Value Source: Designated Forest Land	Description: DFL Class B	RMV: 24170	Exception: Y N		
Adjustment(s):	GSOIL, IRR	Fire Patrol:	Description:			
Comments:	Liability year - 1974 / 2400210					

Improvements - Residence / Manufactured Structures

Bldg: 1	Code Area: 92410	Stat Class: 132	Year Blt: 1910	Eff Year Blt: 1922	Sq.Ft: 1554	% Complete: 100
Desc:	Multi Story above grade	Dimensions:	RMV: 99930			
Func Obsc: 100	Econ %: 100	Other %: 100	Exception: 0	Adjust:	Adjust RMV: 0	

Floors

Type	Class	Display Group	Floor Size	Beds	Baths	Yr Blt	Eff Yr Blt	Inventory	Exception
First Floor	3	Finished	840	0	FB-1	1910	1922	KIT-, HVAC, FP - 2, ROOF, BATH - 1	Y N
Attic	3	Finished	714	2	0	1910	1922	HVAC	Y N

Accessories

Description	Class	Size SqFt	Eff Yr Blt	RMV	Quantity	Exception
DECK	3	192	1948	2788	1	Y N

Improvements - Accessory Buildings

Bldg: 2	Code Area: 92410	Stat Class: 341	Year Blt: 1982	Eff Year Blt: 1982	Sq.Ft: 344	% Complete: 100
Desc:	Multi Purpose Shed (MP)	Dimensions:	RMV: 2750			
Func Obsc: 100	Econ %: 100	Other %: 100	Exception: 0	Adjust:	Adjust RMV: 0	

Floors

Type	Class	Display Group	Floor Size	Beds	Baths	Yr Blt	Eff Yr Blt	Inventory	Exception
Multi-Purpose Bldg	6	Finished	344	0	0	1982	1982	FAIR	Y N

Accessories

Description	Class	Size SqFt	Eff Yr Blt	RMV	Quantity
No accessory data available					

SKETCH/AREA TABLE ADDENDUM

Parcel No 063W15 00400

File No R19577

SUBJECT

Property Address 721 Salmon St N

City Salem

State OR

Zip 97303

Owner

Client

Appraiser Name

IMPROVEMENTS SKETCH

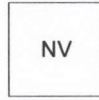
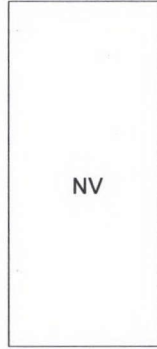

R19577
063W15 00400
1=25'

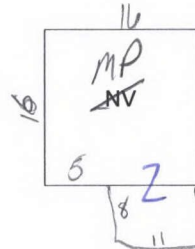
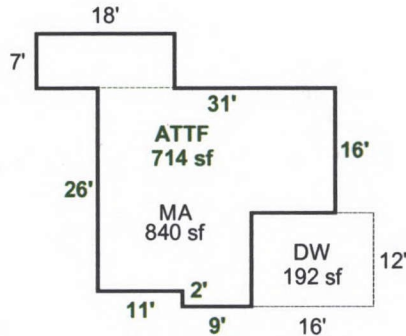

AREA CALCULATIONS

AREA CALCULATIONS SUMMARY

Code	Description	Factor	Net Size	Perimeter	Net Totals
GLA1	MA	1.00	840	148	840
GLA2	ATTFF	1.00	714	118	714
P/P	DW	1.00	192	56	192

Net LIVABLE Area (Rounded w/ Factors) 1554

Comment Table 1

Apex by RW 07/09/08

Comment Table 2

GPH 9/10/04

Comment Table 3

Cycle 13

