

Summary

Lead Appr: WW Clerk: _____ Lead Clerk: _____ Appr: MLH 3/13/26

Print Date:

9/26/2025

2.3.26

Acct ID: 537915

MTL: 061E30A001700

Date: 1/13/26

Appr: MLH

Prop Class: 640/1

RMV Prop Class: 400

Situs:

MaSaNh: 03 06 002

Unit: 74958

Year: 2025

1/13/2026

Last Date Appraised: 04/22/2020 Appraiser: MATTHEW HAMILTON Tag: Y N Tag info: 2026 - NEW CONSTRUCTION (Residence)

Owner: IVANOV, ULIANA

Last Sales Date: 06/09/2022

Roll Type: R

Cycle Tag Sales Verification Other: _____ Inspection level: 1 2 3 4 LCB no reply TTO INSP

AV: 822

RMV Land: 267650

RMV Imp: 0

RMV Total: 267650

MAV: 0

MSAV: 822

SAV: 1594

Comment: LEVEL 4 C19 4-22-20 SR94

Land OSD A M/M NEW MA @100 close Tag create Market Homesite Input MLH 1/29/26

Site: 1 Code Area: 04500 Size: 2.54 Acres Use Code: 004 Zone: NREST SAV Use: 011 Exception: 0

Class: FTLE Value Source: Designated Forest Land Description: DFL Class E RMV: 267650 Exception: Y N

Adjustment(s): Water A

Fire Patrol: SA004 Description: FIRE PATROL

Comments: Liability year - 1979 / 22-23 REMOVED WATER ADJUSTMENT

21-22: #94 CYCLE C19, NO CHG //03-04: EXPIRATION OF STO PROGRAM. CONVERSION BY DOR TO DESIGNATED FOREST LAND AT 100% PROGRAM. // 04-05: CHANGING STO LAND FROM >5000 TO DESIGNATED 06-07: RECALC SETUP;#10, 07-18-05 07-08: PER #31 ON WATER FRONTAGE PROJECT, ADD WATER ADJ

CWO 3/5/26 send intent letter for DFL, less than 2.0 acres of forestland

Permits

Permit Number	Permit ID	Origin	Category	Type	Estimate Value	% Complete	Roll Type	Description
24-005981	83761	MARION COUNTY	NEW CONSTRUCTION	RESIDENCE	610494	0	R	NSFD 3bd/3ba w/ Sewing room, Sauna, Attached Carport & Attached Garage



ACCOUNT # _____ DATE: _____ RMV CLASS _____ PROP CLASS _____
 MTL _____ APPR _____ TAG Y N _____
 COMMENTS: _____

RESIDENCE / MANUFACTURED STRUCTURES

ACCESSORY IMPROVEMENTS / OUTBUILDINGS

STAT 152 QLTY + 2 FLOOR MA
 AREA 2216 EFF AREA _____ BED 1
 ROOF + HVAC +
 BATH PKG: 1 BATH 2 BATH + 1 1/2 BTH
 FIREPLACE: 1
 KITCHEN - +
 YR BLT 2025 EFF YR 2025 ECON _____
 % COMP 100 % GOOD _____ FUNC _____
 EXCEPT Y N LUMP SUM: _____
 MISC: AC 540
 YI CLASS 5 F G A E
 SKIRT + LIN FT _____
 COMMENT: _____

TYPE _____
 STAT / CLASS _____
 SIZE _____
 FAIR
 AVERAGE
 GOOD
 EXCELLENT
 BATH _____
 YR BLT _____
 EFF YR _____
 % COMP _____
 EXCEPT Y N

TYPE _____
 STAT / CLASS _____
 SIZE _____
 FAIR
 AVERAGE
 GOOD
 EXCELLENT
 BATH _____
 YR BLT _____
 EFF YR _____
 % COMP _____
 EXCEPT Y N

STAT _____ QLTY + - FLOOR ATTIC
 AREA 863 EFF AREA _____ BED 2
 ROOF + HVAC +
 BATH PKG: 1 BATH _____ BATH + _____ 1/2 BTH
 FIREPLACE: _____
 KITCHEN - +
 YR BLT 2025 EFF YR 2025 ECON _____
 % COMP 100 % GOOD _____ FUNC _____
 EXCEPT Y N LUMP SUM: _____
 MISC: _____
 YI CLASS _____ F G A E
 SKIRT + LIN FT _____
 COMMENT: _____

MISC: _____
 COMMENT: _____

MISC: _____
 COMMENT: _____

STAT _____ QLTY + - FLOOR AGF
 AREA 1130 EFF AREA _____ BED _____
 ROOF + HVAC +
 BATH PKG: _____ BATH _____ BATH + _____ 1/2 BTH
 FIREPLACE: _____
 KITCHEN - +
 YR BLT _____ EFF YR _____ ECON _____
 % COMP _____ % GOOD _____ FUNC _____
 EXCEPT Y N LUMP SUM: _____
 MISC: _____
 YI CLASS _____ F G A E
 SKIRT + LIN FT _____
 COMMENT: _____

TYPE _____
 STAT / CLASS _____
 SIZE _____
 FAIR
 AVERAGE
 GOOD
 EXCELLENT
 BATH _____
 YR BLT _____
 EFF YR _____
 % COMP _____
 EXCEPT Y N
 MISC: _____
 COMMENT: _____

TYPE _____
 STAT / CLASS _____
 SIZE _____
 FAIR
 AVERAGE
 GOOD
 EXCELLENT
 BATH _____
 YR BLT _____
 EFF YR _____
 % COMP _____
 EXCEPT Y N
 MISC: _____
 COMMENT: _____

SKETCH/AREA TABLE ADDENDUM

SUBJECT INFO

File No.: 537915 Parcel No.: 061E30A001700
 Property Address: 6790 CREEK LANE NE
 City: SILVERTON County: Marion State: OR ZipCode:
 Owner:
 Client:
 Appraiser Name: Client Address: Inspection Date:

SKETCH

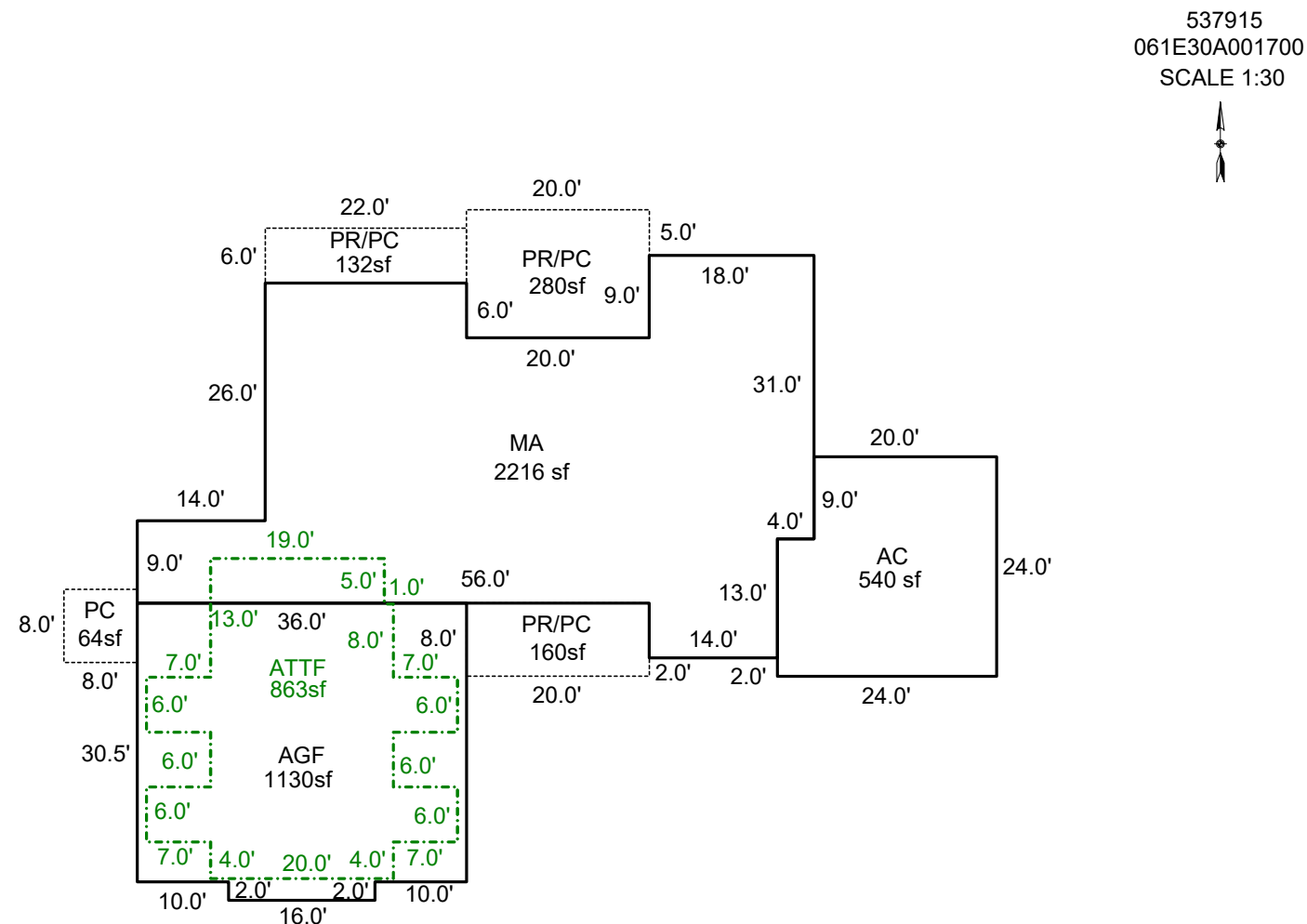

Sketch by ApexSketch

AREA CALCULATIONS SUMMARY						COMMENT TABLE 1	
Code	Description	Factor	Net Size	Perimeter	Net Totals		
MA2	ATTF	1.0	863.0	166.0	863.0	APEX BY CLOBERG 05/19/25 24-005981 MA UPDATED BY CLOBERG 03/17/26	
GAR	AC	1.0	539.9	96.0			
	AGF	1.0	1130.0	137.0	1669.9		
MA	MA	1.0	2215.9	248.0	2215.9		
P/P	PR/PC	1.0	132.0	56.0			
	PR/PC	1.0	280.0	68.0			
	PR/PC	1.0	160.0	56.0			
	PC	1.0	64.0	32.0	636.0		
						COMMENT TABLE 2	COMMENT TABLE 3
						MLH 01/13/26	TAGS L2
Net LIVABLE		cnt	3 (rounded)		3,886		

SKETCH/AREA TABLE ADDENDUM

SUBJECT INFO

File No.: 537915 Parcel No.: 061E30A001700
 Property Address: 6790 CREEK LANE NE
 City: SILVERTON County: Marion State: OR ZipCode:
 Owner:
 Client: Client Address:
 Appraiser Name: Inspection Date:

SKETCH

537915
061E30A001700
SCALE 1:30

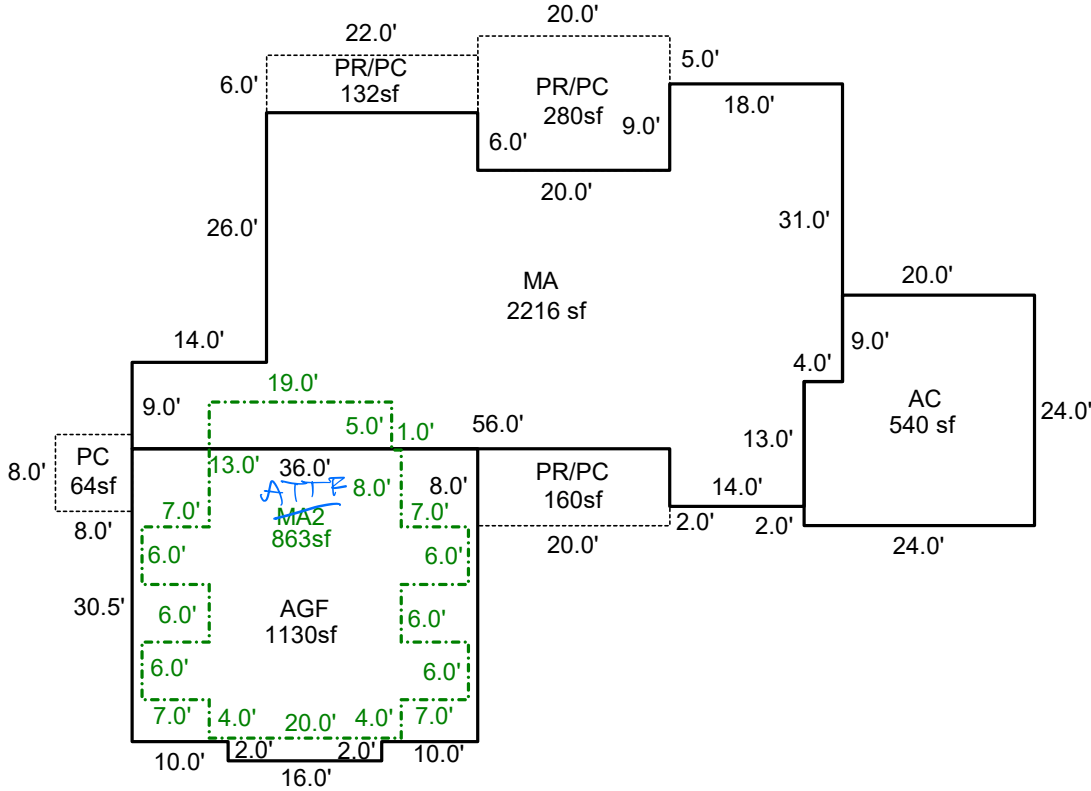

Sketch by ApexSketch

AREA CALCULATIONS SUMMARY

Code	Description	Factor	Net Size	Perimeter	Net Totals
MA2	MA2	1.0	863.0	166.0	863.0
GAR	AC	1.0	539.9	96.0	
	AGF	1.0	1130.0	137.0	1669.9
MA	MA	1.0	2215.9	248.0	2215.9
P/P	PR/PC	1.0	132.0	56.0	
	PR/PC	1.0	280.0	68.0	
	PR/PC	1.0	160.0	56.0	
	PC	1.0	64.0	32.0	636.0
Net LIVABLE		cnt	2 (rounded)		3,079

COMMENT TABLE 1

APEX BY CLOBERG 05/19/25 24-005981 MA

COMMENT TABLE 2

1/3/26 MLT

COMMENT TABLE 3

Tags L2