

Summary Lead Appr: WW Clerk: _____ Lead Clerk: _____ Appr: **JJS 3.25.26** Print Date:

3/9/2026

Acct ID: 558777 MTL: 082W03B001800 Date: **3.19.26** Appr: **JJS** Prop Class: 401 RMV Prop Class: 401
 Situs: 6553 RIPPLING BROOK DR SE SALEM OR 97317 MaSaNh: 01 06 000 Unit: 118901 Year: 2026

Last Date Appraised: 06/06/2016 Appraiser: CLINT LUKE Tag: Y **(N)** Tag info:
 Owner: PENA MOSQUEDA MARIA G Last Sales Date: 12/09/2025 Roll Type: R
 Cycle Tag **Sales Verification** Other: _____ Inspection level: 1 2 3 **(4)** LCB TTO INSP AV: 330110
 RMV Land: 283980 RMV Imp: 345670 RMV Total: 629650 MAV: 330110 MSAV: 0 SAV: 0
 Comment:

RMLS: 245510989
DOM: 89
COLI: 33- Sales letter

OSDs

Vet DQ

Count	Code	Description	RMV	Code Area	Exception
1	MKTA	OSD - AVERAGE	55000	92410	0

Land

Site: 1 Code Area: 92410 Size: 1.57 Acres Use Code: 004 Zone: NREST SAV Use: Exception: 0
 Class: Value Source: Rural at MKT Description: RMV: 228980 Exception: Y N
 Adjustment(s): Fire Patrol: Description:
 Comments: 2002-03 REAPPRAISAL; 2003-04 MODIFIED LAND TABLE KKB65 10/02 04-05: LAND ADJUSTMENTS

Improvements - Residence / Manufactured Structures

Bldg: 1 Code Area: 92410 Stat Class: 141 + Year Blt: 1990 Eff Year Blt: 1990 Sq.Ft: 2177 % Complete: 100.00
 Desc: One Story Only Dimensions: RMV: 330400
 Func Obsc: 100 Econ %: 100 Other %: 100 Exception: 0 Adjust: Adjust RMV: 0

Floors

Type	Class	Display Group	Floor Size	Beds	Baths	Yr Blt	Eff Yr Blt	Inventory	Exception
First Floor	4 +	Finished	2177	3	FB-2/ HB-1	1990	1990	ROOF, BTH - 1, FP - 1, HVAC+, KIT, BATH - 2	Y N
Garage Attached	4	Finished	537	0	0	1990	1990	ROOF	Y N

Accessories

Description	Class	Size SqFt	Eff Yr Blt	RMV	Quantity	Exception
YARD IMPROVEMENTS GOOD	4	1	1990	30046	1	Y N

Improvements - Accessory Buildings

Bldg: 2 Code Area: 92410 Stat Class: 351 Year Blt: 1996 Eff Year Blt: 1996 Sq.Ft: 1248 % Complete: 100.00
 Desc: General Purpose Building (GB) Dimensions: 48x26 RMV: 15270
 Func Obsc: 100 Econ %: 100 Other %: 100 Exception: 0 Adjust: Adjust RMV: 0

Floors

Type	Class	Display Group	Floor Size	Beds	Baths	Yr Blt	Eff Yr Blt	Inventory	Exception
General Purpose Bldg	6	Finished	1248	0	0	1996	1996	FAIR	Y N

Accessories

Description	Class	Size SqFt	Eff Yr Blt	RMV	Quantity
No accessory data available					

SKETCH/AREA TABLE ADDENDUM

Parcel No 082W03B 01800

File No R58777

SUBJECT

Property Address 6553 RIPPLING BROOK DR SE

City SALEM

State OR

Zip 97317

Owner

Client

Appraiser Name

IMPROVEMENTS SKETCH

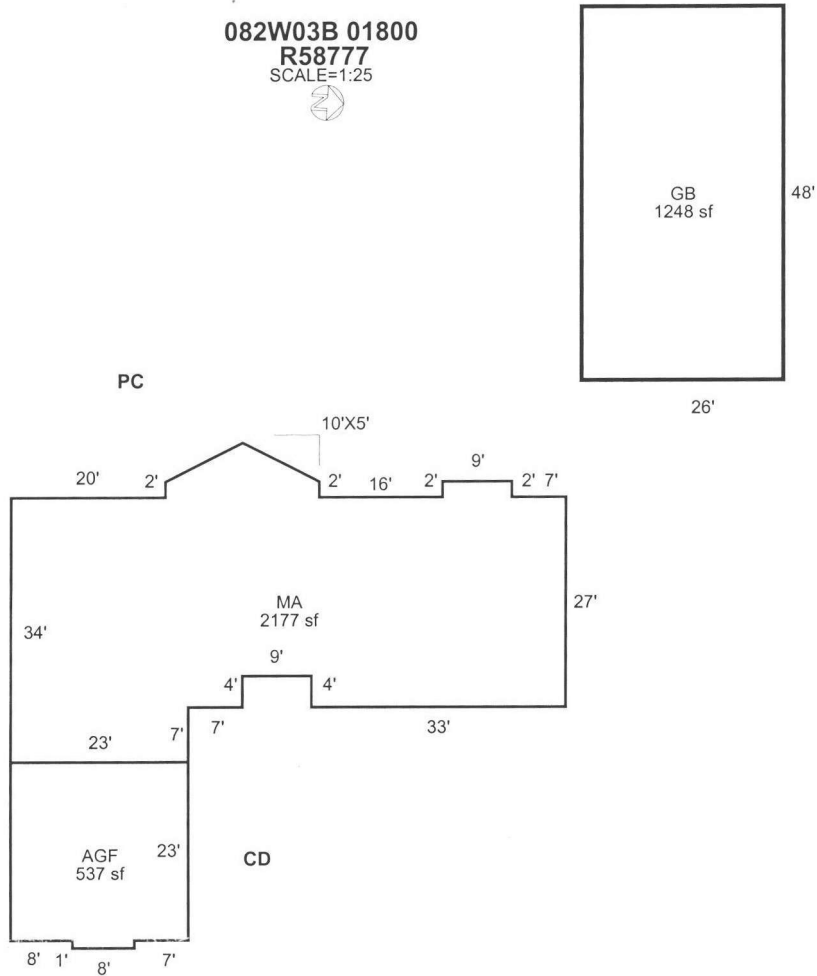

AREA CALCULATIONS

AREA CALCULATIONS SUMMARY

Code	Description	Factor	Net Size	Perimeter	Net Totals
GLA1	MA	1.00	2177	230	2177
GBA1	GB	1.00	1248	148	1248
GAR	AGF	1.00	537	94	537

Comment Table 1

APEXED BY NRC 06/29/2009

Comment Table 2

JJS
3.10.26

Comment Table 3

SV L4

Net LIVABLE Area (Rounded w/ Factors) 2177
 Net BUILDING Area (Rounded w/ Factors) 1248