

# SKETCH/AREA TABLE ADDENDUM

## SUBJECT INFO

File No.: 101327 Parcel No.: 061E26 03900  
 Property Address: 6055 PEAKS VIEW RD NE  
 City: SCOTTS MILLS County: MARION State: OR ZipCode: 97375  
 Owner:  
 Client: Client Address:  
 Appraiser Name: Inspection Date:

## SKETCH

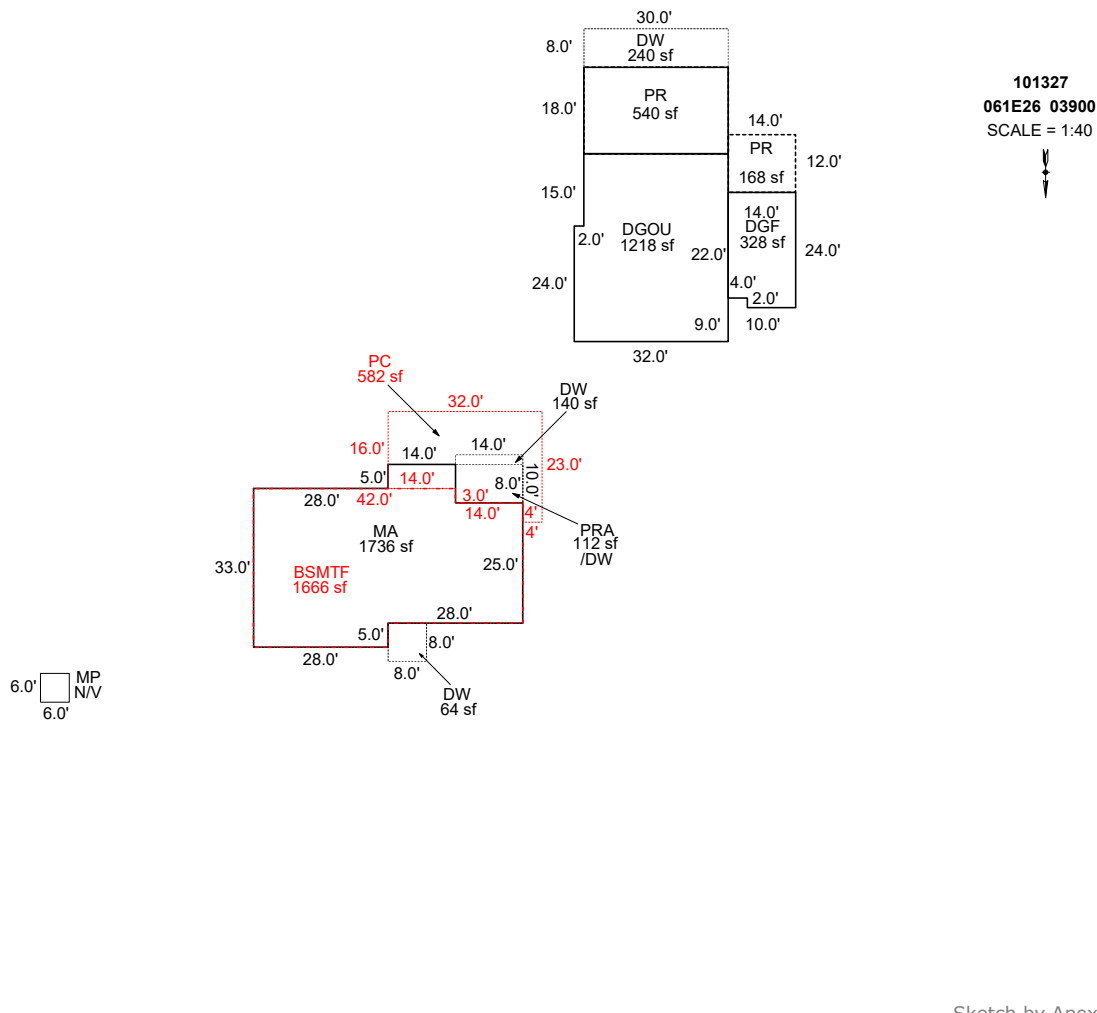

Sketch by ApexSketch

| AREA CALCULATIONS SUMMARY |              |        |             |           |            | COMMENT TABLE 1                               |  |
|---------------------------|--------------|--------|-------------|-----------|------------|---|--|
| Code                      | Description  | Factor | Net Size    | Perimeter | Net Totals |   |  |
| GBA1                      | LTH          | 1.0    | 540.0       | 96.0      |            | 12/17/12 Jane                                 |  |
|                           | MP           | 1.0    | 200.0       | 60.0      | 740.0      | Updated by JRONDEMA 9/18/18                   |  |
| GLA1                      | MA           | 1.0    | 1736.0      | 188.0     | 1736.0     | Updated by JRONDEMA 1/8/19                    |  |
| BSMT                      | BSMTF        | 1.0    | 1666.0      | 178.0     | 1666.0     | UPD BY PH 11.19.19                            |  |
| GAR                       | DGOU         | 1.0    | 1218.0      | 142.0     |            | UPDATED BY CJURAN 08/30/2021                  |  |
|                           | DGF          | 1.0    | 328.0       | 76.0      | 1546.0     | UPDATED BY CJURAN 04/17/2023 555-22-002787    |  |
| P/P                       | DW           | 1.0    | 240.0       | 76.0      |            | UPDATED BY CJURAN 12/06/2023                  |  |
|                           | PRA          | 1.0    | 112.0       | 44.0      |            | UPDATED BY CLOBERG 03/14/25                   |  |
|                           | DW           | 1.0    | 140.0       | 48.0      |            | UPDATED BY CLOBERG 03/16/26                   |  |
|                           | DW           | 1.0    | 64.0        | 32.0      |            |   |  |
| PR                        | PC           | 1.0    | 582.0       | 110.0     | 1138.0     | <b>COMMENT TABLE 2</b>                        |  |
|                           | PR           | 1.0    | 168.0       | 52.0      |            | CL #10 05/26/2021 SV L4                       |  |
|                           | PR           | 1.0    | 540.0       | 96.0      | 708.0      | CL 12/05/2023 TAGS L2<br>MLH 11/07/24 TAGS L4 |  |
|                           | Net LIVABLE  | cnt    | 2 (rounded) |           | 3,282      |   |  |
|                           | Net BUILDING | cnt    | 0 (rounded) |           | 740        |   |  |
|                           |              |        |             |           |            | <b>COMMENT TABLE 3</b>                        |  |
|                           |              |        |             |           |            | MLH 02/26/26 TAGS L3                          |  |