

Summary

Lead Appr: ww 10/22 Clerk: _____ Lead Clerk: _____ Appr: MLH 12/24/25

Print Date:

9/26/2025

Acct ID: 609685 MTL: 071E07A001402 Date: 10/15/25 Appr: MLH Prop Class: 4001 RMV Prop Class: 4001
Situs: 3817 STARLIGHT DR NE SILVERTON OR 97381 MaSaNh: 03 06 000 Unit: 107846 Year: 2025

Last Date Appraised: _____ Appraiser: MATTHEW HAMILTON Tag: Y N Tag info: 2026 - NEW CONSTRUCTION (Residence)

Owner: BEREKOFF, GABRIEL 503 302 6650 Last Sales Date: _____ Roll Type: R

Cycle Tag Sales Verification Other: _____ Inspection level: 1 2 3 4 LCB TTO INSP AV: 107720

RMV Land: 225770 RMV Imp: 0 RMV Total: 225770 MAV: 0 MSAV: 0 SAV: 0

Comment: NEW MA @ 100% close Tag

Land DS7 A

Site: 0 Code Area: 04500 Size: 1.25 Acres Use Code: 004 Zone: NREST SAV Use: _____ Exception: 107720

Class: 4BDSS Value Source: Rural at MKT Description: FOUR BENCH DRY SPECIAL SOUTH RMV: 225770 Exception: Y N

Adjustment(s): _____ Fire Patrol: _____ Description: _____

Comments: _____

Permits

Permit Number	Permit ID	Origin	Category	Type	Estimate Value	% Complete	Roll Type	Description
25-000510	83755	MARION COUNTY	NEW CONSTRUCTION	RESIDENCE	482593	0	R	NSFD 4bd 3 bath w/ attached garage



ACCOUNT # _____ DATE: _____ RMV CLASS _____ PROP CLASS _____
 MTL _____ APPR _____ TAG Y N _____
 COMMENTS: _____

RESIDENCE / MANUFACTURED STRUCTURES

ACCESSORY IMPROVEMENTS / OUTBUILDINGS

STAT 141 QLTY + - FLOOR MA
 AREA 2616 EFF AREA _____ BED 4
 ROOF + HVAC +
 BATH PKG: 2.5 BATH 1 BATH + _____ 1/2 BTH
 FIREPLACE: _____
 KITCHEN - +
 YR BLT 2025 EFF YR _____ ECON _____
 % COMP 100 % GOOD _____ FUNC _____
 EXCEPT Y N LUMP SUM: _____
 MISC: _____
 YI CLASS 4 F G A E
 SKIRT + LIN FT _____
 COMMENT: _____

TYPE _____
 STAT / CLASS _____
 SIZE _____
 FAIR
 AVERAGE
 GOOD
 EXCELLENT
 BATH _____
 YR BLT _____
 EFF YR _____
 % COMP _____
 EXCEPT Y N

TYPE _____
 STAT / CLASS _____
 SIZE _____
 FAIR
 AVERAGE
 GOOD
 EXCELLENT
 BATH _____
 YR BLT _____
 EFF YR _____
 % COMP _____
 EXCEPT Y N

STAT _____ QLTY + - FLOOR AGE
 AREA 576 EFF AREA _____ BED _____
 ROOF + HVAC +
 BATH PKG: _____ BATH _____ BATH + _____ 1/2 BTH
 FIREPLACE: _____
 KITCHEN - +
 YR BLT 2025 EFF YR _____ ECON _____
 % COMP 100 % GOOD _____ FUNC _____
 EXCEPT Y N LUMP SUM: _____
 MISC: _____
 YI CLASS _____ F G A E
 SKIRT + LIN FT _____
 COMMENT: _____

MISC: _____
 COMMENT: _____

MISC: _____
 COMMENT: _____

STAT _____ QLTY + - FLOOR _____
 AREA _____ EFF AREA _____ BED _____
 ROOF + HVAC +
 BATH PKG: _____ BATH _____ BATH + _____ 1/2 BTH
 FIREPLACE: _____
 KITCHEN - +
 YR BLT _____ EFF YR _____ ECON _____
 % COMP _____ % GOOD _____ FUNC _____
 EXCEPT Y N LUMP SUM: _____
 MISC: _____
 YI CLASS _____ F G A E
 SKIRT + LIN FT _____
 COMMENT: _____

TYPE _____
 STAT / CLASS _____
 SIZE _____
 FAIR
 AVERAGE
 GOOD
 EXCELLENT
 BATH _____
 YR BLT _____
 EFF YR _____
 % COMP _____
 EXCEPT Y N
 MISC: _____
 COMMENT: _____

TYPE _____
 STAT / CLASS _____
 SIZE _____
 FAIR
 AVERAGE
 GOOD
 EXCELLENT
 BATH _____
 YR BLT _____
 EFF YR _____
 % COMP _____
 EXCEPT Y N
 MISC: _____
 COMMENT: _____

SKETCH/AREA TABLE ADDENDUM

SUBJECT INFO

File No.: 609685 Parcel No.: 071E07A001402
 Property Address: 3817 NE STARLIGHT DRIVE
 City: SILVERTON County: Marion State: OR ZipCode:
 Owner:
 Client: Client Address:
 Appraiser Name: Inspection Date:

SKETCH

609685
071E07A001402
SCALE 1:30

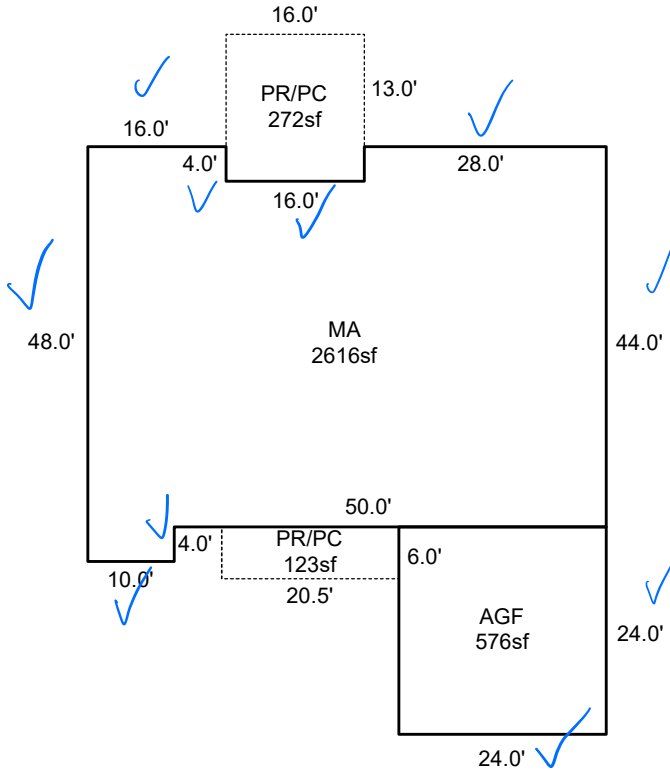

Sketch by ApexSketch

AREA CALCULATIONS SUMMARY

Code	Description	Factor	Net Size	Perimeter	Net Totals
GAR	AGF	1.0	576.0	96.0	576.0
MA	MA	1.0	2616.0	224.0	2616.0
P/P	PR/PC	1.0	123.0	53.0	
	PR/PC	1.0	272.0	66.0	395.0

COMMENT TABLE 1

APEX BY CLOBERG 03/05/25 25-000510 MA

COMMENT TABLE 2

10/15/25 MCH

COMMENT TABLE 3

TAGS L1

Net LIVABLE cnt 1 (rounded) 2,616