

Acct ID: 541392 MTL: 093E11AB01400 Date: 10-10-25 Appr: Luca Prop Class: 401 RMV Prop Class: 401  
 Situs: 10255 NORTH FORK LN SE LYONS OR 97358 MaSaNh: 01 06 005 Unit: 46463 Year: 2025  
 Last Date Appraised: 09/19/2024 Appraiser: CLINT LUKE Tag: Y 0 Tag info: 2026 - Tag/Permit (L2 - ON-SITE REVIEW EXTERIOR)  
 Owner: FOREST, MICHAEL W Last Sales Date: 06/30/2022 Roll Type: R  
 Cycle Tag Sales Verification Other: \_\_\_\_\_ Inspection level: 1 2 3 0 LCB TTO INSP AV: 171210  
 RMV Land: 216860 RMV Imp: 57250 RMV Total: 274110 MAV: 171210 MSAV: 0 SAV: 0  
 Comment: 25-26 L4 9/19/24 CLUKE  
 23-24 L4 4/4/23 CLUKE  
 LEVEL 4 12.22.20 WV06//

**Land** ADD OSD N. Ave now  
 Site: 1 Code Area: 56540 Size: 1.24 Acres Use Code: 004 Zone: NREST SAV Use: Exception: 0  
 Class: 4BDSS Value Source: Rural at MKT Description: FOUR BENCH DRY SPECIAL SOUTH RMV: 216860 Exception: Y N  
 Adjustment(s): Fire Patrol: SA004 Description: FIRE PATROL  
 Comments: 25-26 SOIL VERIFIED 23-24 SV N/C PER CL//22-23 REMOVED WATER ADJUSTMENT  
 21-22: PER #06 DEL RES, OSD// 09-10: CYCLE WORK BY #36- CHG WATERG TO WATERF AND OSDA TO OSDF// 2003-04 REAPPRAISAL.

**Improvements - Residence / Manufactured Structures**

Bldg: 1 Code Area: 56540 Stat Class: 138 Year Blt: 1991 Eff Year Blt: 1991 Sq.Ft: 0 % Complete: 100.00  
 Desc: Res other improvements Dimensions: RMV: 56810  
 Func Obsc: 100 Econ %: 100 Other %: 100 Exception: 0 Adjust: Adjust RMV: 0

**Floors**

Type	Class	Display Group	Floor Size	Beds	Baths	Yr Blt	Eff Yr Blt	Inventory	Exception: Y N
Garage Detached	3	Unfinished	720	0	0	1991	1991	ROOF	Y N

**Accessories**

Description	Class	Size SqFt	Eff Yr Blt	RMV	Quantity	Exception: Y N
ROOF EXTENSION OR PATIO COVER	3	240	1991	5846	0	Y N

**Improvements - Accessory Buildings**

Bldg: 2 Code Area: 56540 Stat Class: 354 Year Blt: 1982 Eff Year Blt: 1982 Sq.Ft: 168 % Complete: 100.00  
 Desc: Lean-to Light (LTL) Dimensions: 24x7 RMV: 140  
 Func Obsc: 100 Econ %: 100 Other %: 100 Exception: 0 Adjust: Adjust RMV: 0

**Floors**

Type	Class	Display Group	Floor Size	Beds	Baths	Yr Blt	Eff Yr Blt	Inventory	Exception: Y N
Lean-to Light Duty	4	Finished	168	0	0	1982	1982		Y N

**Accessories**

No accessory data available

Bldg: 3 Code Area: 56540 Stat Class: 354 Year Blt: 2007 Eff Year Blt: 2007 Sq.Ft: 112 % Complete: 100.00  
 Desc: Lean-to Light (LTL) Dimensions: 8x14 RMV: 300  
 Func Obsc: 100 Econ %: 100 Other %: 100 Exception: 0 Adjust: Adjust RMV: 0

**Floors**

Type	Class	Display Group	Floor Size	Beds	Baths	Yr Blt	Eff Yr Blt	Inventory	Exception: Y N
Lean-to Light Duty	4	Finished	112	0	0	2007	2007		Y N

**Accessories**

No accessory data available

# SKETCH/AREA TABLE ADDENDUM

## SUBJECT INFO

File No.: 541392 Parcel No.: 093E11AB01400  
 Property Address: 10255 NORTH FORK LN SE  
 City: LYONS County: Marion State: OR ZipCode: 97358  
 Owner:  
 Client: Client Address:  
 Appraiser Name: Inspection Date:

## SKETCH

Little North Fork River

541392  
093E11AB01400  
SCALE=1:30

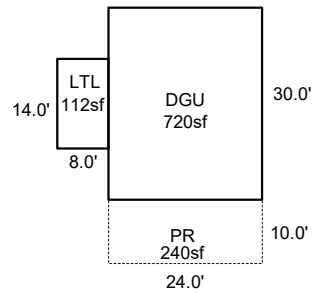

NV-NI

Private Lane

Sketch by ApexSketch

### AREA CALCULATIONS SUMMARY

Code	Description	Factor	Net Size	Perimeter	Net Totals
GAR	DGU	1.0	720.0	108.0	720.0
OTH	LTL	1.0	112.0	44.0	112.0
P/P	PR	1.0	240.0	68.0	240.0

### COMMENT TABLE 1

Apex by JA 4/07/09  
 UPDATED BY JRONDEMA 8/4/16  
 UPDATED BY CJURAN 12/23/2020  
 UPDATED BY CJURAN 01/28/2021  
 UPDATED BY CLOBERG 09/27/24

### COMMENT TABLE 2

WV 12/22/2020 AOG  
 CLUKE 09/19/24

### COMMENT TABLE 3

CYCLE L4