

Acct ID: 562730 MTL: 082W13D000100 Date: 9-15-25 Appr: End Prop Class: 409 RMV Prop Class: 409  
 Situs: 5671 VILLAGE VIEW CT SE AUMSVILLE OR 97325 MaSaNh: 01 06 000 Unit: 103036 Year: 2025  
 Last Date Appraised: 05/31/2019 Appraiser: CLINT LUKE Retag: Y  Tag info: \_\_\_\_\_  
 Owner: ANDERSON, ROBERTA A Roll Type: R  
 Cycle Tag Sales Verification Other: \_\_\_\_\_ Inspection level: 1 2 3  LCB TTO INSP AV: 88430  
 RMV Land: 248710 RMV Imp: 100860 RMV Total: 349570 MAV: 88430 MSAV: 0 SAV: 0  
 Comment: \_\_\_\_\_

INPUT  
 11-19-25  
 End

**Notations**  
 No notation data available.

**OSDs**

Count	Code	Description	RMV	Code Area	Exception
1	MKTN	OSD - NO LANDSCAPE	35000	05558	0

**Land**

Site: 1 Code Area: 05558 Size: 1.48 Acres Use Code: 004 Zone: NREST SAV Use: Exception: 0  
 Class: Value Source: Rural at MKT Description: RMV: 213710 Exception: Y N  
 Adjustment(s): Fire Patrol: Description:  
 Comments: 19-20: CYCLE WORK #10 UPDATE OSDA TO N //2002-03 REAPPRAISAL; 2003-04 MODIFIED LAND TABLE KKB65 10/02

**Improvements - Residence / Manufactured Structures**

Bldg: 1 Code Area: 05558 Stat Class: 454 Year Blt: 1977 Eff Year Blt: Sq.Ft: 924 % Complete: 100  
 Desc: MANUF STRUCT, CLASS 5, 14' WIDE SINGLE Dimensions: 66x14 RMV: 97770  
 Func Obsc: 100 Econ %: 100 Other %: 100 Exception: 0 Adjust: Adjust RMV: 0

**Floors**

Type	Class	Display Group	Floor Size	Beds	Baths	Yr Blt	Eff Yr Blt	Inventory	Exception
First Floor	5	Finished	924	3	FB-1	1977	0	ROOF SKIRT, HVAC+, KIT, BATH - 1	Y N

**Accessories**

Description	Class	Size SqFt	Eff Yr Blt	RMV	Quantity
No accessory data available					

**Improvements - Accessory Buildings**

Bldg: 1 Code Area: 05558 Stat Class: 341 Year Blt: 1988 Eff Year Blt: 1988 Sq.Ft: 416 % Complete: 100  
 Desc: Multi Purpose Shed (MP) Dimensions: 26x16 RMV: 1830  
 Func Obsc: 100 Econ %: 100 Other %: 100 Exception: 0 Adjust: Adjust RMV: 0

**Floors**

Type	Class	Display Group	Floor Size	Beds	Baths	Yr Blt	Eff Yr Blt	Inventory	Exception
Multi-Purpose Bldg	4	Finished	416	0	0	1988	1988	Fmr	Y N

**Accessories**

Description	Class	Size SqFt	Eff Yr Blt	RMV	Quantity
No accessory data available					

Bldg: 2 Code Area: 05558 Stat Class: 341 Year Blt: 1988 Eff Year Blt: 1988 Sq.Ft: 256 % Complete: 100  
 Desc: Multi Purpose Shed (MP) Dimensions: 16x16 RMV: 1260  
 Func Obsc: 100 Econ %: 100 Other %: 100 Exception: 0 Adjust: Adjust RMV: 0

**Floors**

Type	Class	Display Group	Floor Size	Beds	Baths	Yr Blt	Eff Yr Blt	Inventory	Exception
Multi-Purpose Bldg	4	Finished	256	0	0	1988	1988	Fmr	Y N

**Accessories**

Description	Class	Size SqFt	Eff Yr Blt	RMV	Quantity
No accessory data available					

# SKETCH/AREA TABLE ADDENDUM

## SUBJECT INFO

File No.: 562730 Parcel No.: 082W13D 00100  
 Property Address:  
 City: SALEM County: State: OR ZipCode:  
 Owner:  
 Client: Client Address:  
 Appraiser Name: Inspection Date:

## SKETCH

562730  
082W13D 00100

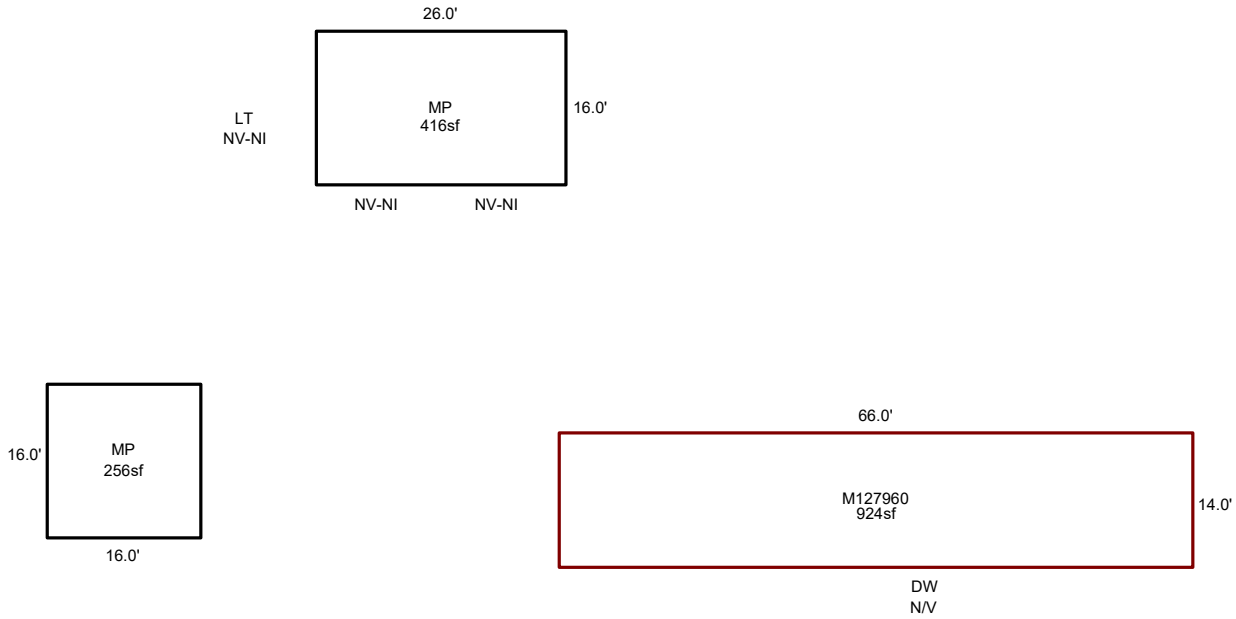

Sketch by ApexSketch

### AREA CALCULATIONS SUMMARY

Code	Description	Factor	Net Size	Perimeter	Net Totals
GBA1	MP	1.0	416.0	84.0	
	MP	1.0	256.0	64.0	672.0
GLA1	M127960	1.0	924.0	160.0	924.0

### COMMENT TABLE 1

APEXED BY NRC 07/16/2009  
 UPDATED BY CLOBERG 10/23/25

### COMMENT TABLE 2

CL10 05/31/19  
 CLUKE 09/15/25

### COMMENT TABLE 3

CYCLE L3  
 CYCLE L4

Net LIVABLE	cnt	0	(rounded)		924
Net BUILDING	cnt	2	(rounded)		672