

Summary Lead Appr: WWV Clerk: _____ Lead Clerk: _____ Appr: GRH Print Date: 1/25/2024
 Acct ID: 519853 MTL: 063W24D000200 Date: 6/3/25 Appr: GRH Prop Class: 559 RMV Prop Class: 559 459
 Situs: 3060 QUINABY RD NE SALEM OR 97303 MaSaNh: 04 06 000 Unit: 52702 Year: 2024 2025

Last Date Appraised: 06/11/2020 Appraiser: GERARDO RAMIREZ HERNANDEZ Retag: Y Tag info:
 Owner: MOUNTAIN VIEW PROPERTIES LLC Roll Type: R
 Cycle Tag Sales Verification Other: _____ Inspection level: 1 2 3 4 LCB TTO INSP AV: 59707
 RMV Land: 125890 RMV Imp: 54090 RMV Total: 179980 MAV: 47270 MSAV: 19617 SAV: 44251
 Comment: L2

Update inv

Notations

RP/MS	Code	Description
MS	ZONED	FARM EFU ZONED

OSDs

Farm OK - Seed

Count	Code	Description	RMV	Code Area	Exception
1	SAA	SA OSD - AVERAGE	45000	01410	0

Land

Site: 2	Code Area: 01410	Size: 1.00 Acres	Use Code: 005	Zone: REST	SAV Use: 011	Exception: 0
Class:	Value Source: Farm Homesite	Description:			RMV: 12170	Exception: Y N
Adjustment(s):	GSOIL, IRR		Fire Patrol:	Description:		
Comments:	Liability year - 2009 / 100210					
Site: 3	Code Area: 01410	Size: 4.91 Acres	Use Code: 005	Zone: REST	SAV Use: 011	Exception: 0
Class: 2B1	Value Source: Farm Use - EFU	Description: TWO BENCH IRR			RMV: 68720	Exception: Y N
Adjustment(s):	GSOIL, IRR		Fire Patrol:	Description:		
Comments:	Liability year - 1976 / 100210					

Improvements - Residence / Manufactured Structures

1987 - updated Roof

Bldg: 1	Code Area: 01410	Stat Class: 466	Year Blt: 1978	Eff Year Blt: 1978	Sq.Ft: 1536	% Complete: 100
Desc:	MANUF STRUCT, CLASS 6, 24' WIDE DOUBLE		Dimensions: 64x24	RMV: 31570		
Func Obsc: 100	Econ %: 100	Other %: 100	Exception: 0	Adjust:	Adjust RMV: 0	

Floors

Type	Class	Display Group	Floor Size	Beds	Baths	Yr Blt	Eff Yr Blt	Inventory	Exception
First Floor	6	Finished	1536	3	FB-2	1978	1978	ROOF, SKIRT, HVAC+, KIT-, BATH - 2	Y N

Accessories

Description	Class	Size SqFt	Eff Yr Blt	RMV	Quantity
No accessory data available					

Bldg: 1	Code Area: 01410	Stat Class: 107	Year Blt:	Eff Year Blt: 1978	Sq.Ft: 0	% Complete: 100
Desc:	Yard Improvements		Dimensions:	RMV: 21760		
Func Obsc: 100	Econ %: 100	Other %: 100	Exception: 0	Adjust:	Adjust RMV: 0	

Floors

Type	Class	Display Group	Floor Size	Beds	Baths	Yr Blt	Eff Yr Blt	Inventory
No floor data available								

Accessories

Description	Class	Size SqFt	Eff Yr Blt	RMV	Quantity
YARD IMPROVEMENTS GOOD	3	1	1978	21762	1
Exception: Y N					

Improvements - Accessory Buildings

Bldg: 2	Code Area: 01410	Stat Class: 341	Year Blt: 1975	Eff Year Blt: 1975	Sq.Ft: 160	% Complete: 100
Desc:	Multi Purpose Shed (MP)		Dimensions: 16x10	RMV: 760		
Func Obsc: 100	Econ %: 100	Other %: 100	Exception: 0	Adjust:	Adjust RMV: 0	

Floors

Type	Class	Display Group	Floor Size	Beds	Baths	Yr Blt	Eff Yr Blt	Inventory	Exception
Multi-Purpose Bldg	4	Finished	160	0	0	1975	1975	FAIR	Y N

Accessories

Description	Class	Size SqFt	Eff Yr Blt	RMV	Quantity
No accessory data available					

Bldg: 3	Code Area: 01410	Stat Class: 301	Year Blt:	Eff Year Blt:	Sq.Ft: 100	% Complete: 100
---------	------------------	-----------------	-----------	---------------	------------	-----------------

Desc: Accessory Improvements & Misc.

Dimensions: 10x10

RMV: 0

Func Obsc: 100

Econ %: 100

Other %: 100

Exception: 0

Adjust:

Adjust RMV: 0

~~Floors~~ delete

Type	Class	Display Group	Floor Size	Beds	Baths	Yr Blt	Eff Yr Blt	Inventory	Exception: Y N
Pump House	0	Finished	100	0	0	0	0		

Accessories

Description	Class	Size SqFt	Eff Yr Blt	RMV	Quantity
No accessory data available					

SKETCH/AREA TABLE ADDENDUM

Parcel No 063W24D 00200

File No R19853

SUBJECT	Property Address 3060 Quinaby Rd NE	
	City Salem	State OR Zip 97303
	Owner	
	Client	
	Appraiser Name	

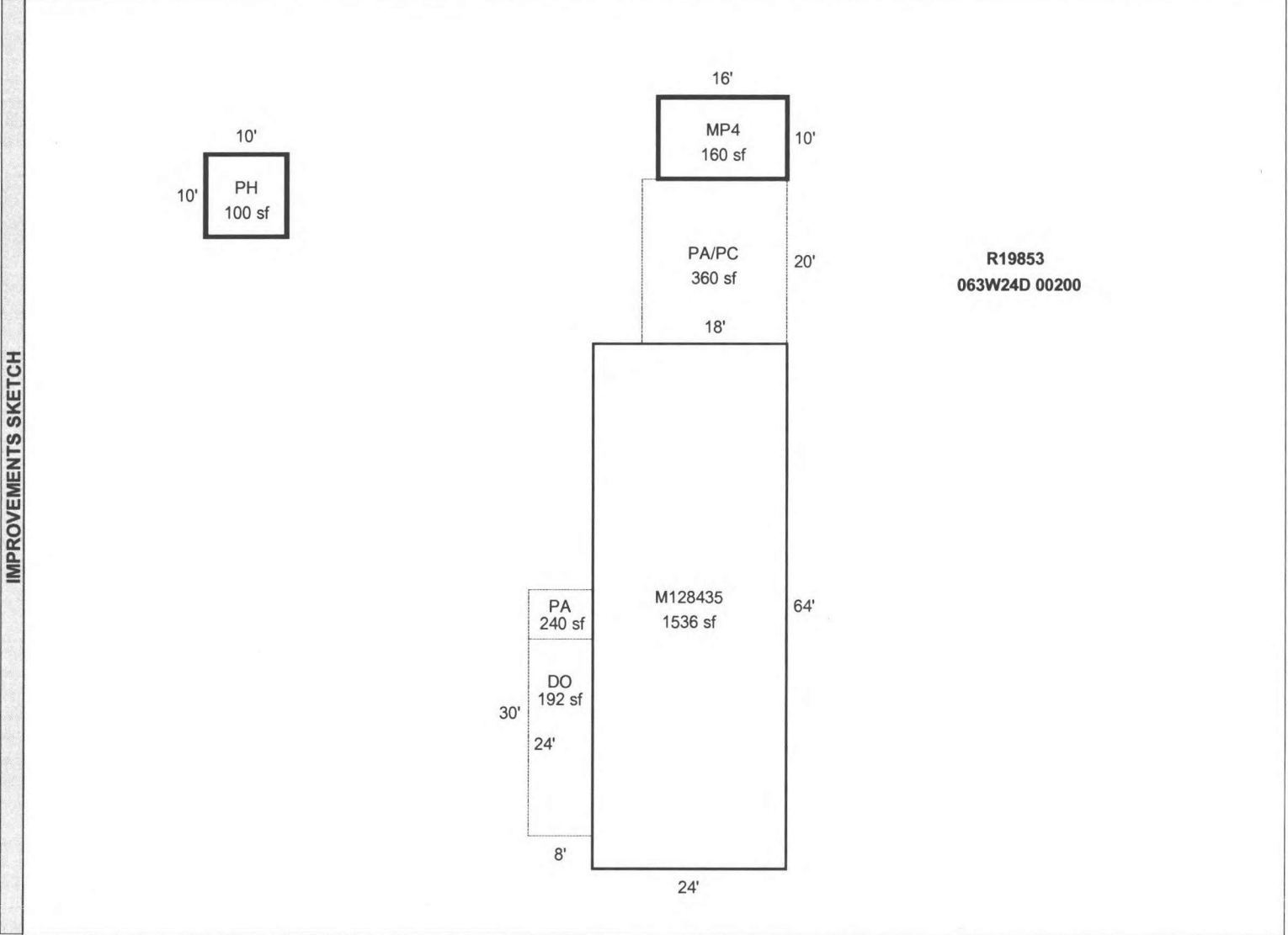

AREA CALCULATIONS	AREA CALCULATIONS SUMMARY						Comment Table 1	
	Code	Description	Factor	Net Size	Perimeter	Net Totals	Apex by RW 07/02/08	
	GBA1	MP4	1.00	160	52	260		
		PH	1.00	100	40			
	P/P	PA/PC	1.00	360	76			
	PA	1.00	240	76				
	DO	1.00	192	64	792			
OTH	M128435	1.00	1536	176	1536	Comment Table 2	Comment Table 3	
Net BUILDING Area (Rounded w/ Factors)						260	GPH 6/3/25	Cycle 13