

Acct ID: 519301 MTL: 062W320000100 Date: **4/22/25** Appr: **GRH** Prop Class: 501 RMV Prop Class: 501
 Situs: 6345 55TH AVE NE SALEM OR 97305 MaSaNh: 04 06 000 Unit: 84629 Year: 2024

Last Date Appraised: 09/13/2011 Appraiser: GERARDO RAMIREZ HERNANDEZ Retag: Y N Tag info:

Owner: POVERUD, LINDA L Roll Type: R
 Cycle Tag Sales Verification Other: _____ Inspection level: 1 2 3 4 LCB TTO INSP AV: 144340
 RMV Land: 185780 RMV Imp: 200400 RMV Total: 386180 MAV: 144340 MSAV: 0 SAV: 0
 Comment:

No changes

Notations
 No notation data available.

OSDs

Count	Code	Description	RMV	Code Area	Exception
1	MKTA	OSD - AVERAGE	45000	92410	0

Land

Site: 1	Code Area: 92410	Size: 0.74 Acres	Use Code: 005	Zone: REST	SAV Use:	Exception: 0
Class:	Value Source: Rural Restrictive	Description: ZBI			RMV: 110010	Exception: Y N
Adjustment(s):	GSOIL, IRR	0.92 AC	Fire Patrol:	Description:		
Comments:						
Site: 3	Code Area: 92410	Size: 0.18 Acres	Use Code: 005	Zone: REST	SAV Use:	Exception: 0
Class:	Value Source: Rural Restrictive	Description:			RMV: 30770	Exception: Y N
Adjustment(s):	GSOIL, IRR		Fire Patrol:	Description:		
Comments:						

Improvements - Residence / Manufactured Structures

Bldg: 1 Code Area: 92410 Stat Class: 134 Year Blt: 1929 Eff Year Blt: 1940 Sq.Ft: 1540 % Complete: 100
 Desc: Multi Story above grade with basement Dimensions: RMV: 176790 **CONFIRMED RECORDS**
 Func Obsc: 100 Econ %: 100 Other %: 100 Exception: 0 Adjust: Adjust RMV: 0

Floors

Type	Class	Display Group	Floor Size	Beds	Baths	Yr Blt	Eff Yr Blt	Inventory	Exception
First Floor	3	Finished	992	1	FB-1	1929	1940	KIT, ROOF, FP - 1, HVAC+, BATH - 1	Y N
Attic	3	Finished	548	2	0	1929	1940	HVAC+	Y N
Basement	3	Unfinished	896	0	0	1929	1940		Y N
Carport Attached	3	Unfinished	484	0	0	1970	1970	ROOF	Y N

Accessories

Description	Class	Size SqFt	Eff Yr Blt	RMV	Quantity
YARD IMPROVEMENTS AVERAGE	3	1	1940	10546	1

Bldg: 2 Code Area: 92410 Stat Class: 138 Year Blt: 1930 Eff Year Blt: 1940 Sq.Ft: 0 % Complete: 100
 Desc: Res other improvements Dimensions: RMV: 22200
 Func Obsc: 100 Econ %: 100 Other %: 100 Exception: 0 Adjust: Adjust RMV: 0

Floors

Type	Class	Display Group	Floor Size	Beds	Baths	Yr Blt	Eff Yr Blt	Inventory	Exception
Garage Detached	3	Unfinished	468	0	0	1930	1940	ROOF	Y N

Accessories

Description	Class	Size SqFt	Eff Yr Blt	RMV	Quantity
No accessory data available					

Improvements - Accessory Buildings

Bldg: 3 Code Area: 92410 Stat Class: 341 Year Blt: 1930 Eff Year Blt: 1940 Sq.Ft: 140 % Complete: 100
 Desc: Multi Purpose Shed (MP) Dimensions: 10x14 RMV: 1410
 Func Obsc: 100 Econ %: 100 Other %: 100 Exception: 0 Adjust: Adjust RMV: 0

Floors

Type	Class	Display Group	Floor Size	Beds	Baths	Yr Blt	Eff Yr Blt	Inventory	Exception
Multi-Purpose Bldg	6	Finished	140	0	0	1930	1940	FAIR	Y N

Accessories

Description	Class	Size SqFt	Eff Yr Blt	RMV	Quantity
No accessory data available					



SKETCH/AREA TABLE ADDENDUM

Parcel No 062W32 00100

File No R19301

Property Address 6345 55TH AV NE

City SALEM

County MARION

State OR

Zip 97305

Owner

Client

Appraiser Name

SUBJECT

IMPROVEMENTS SKETCH

R19301
062W32 00100
SCALE=1:20

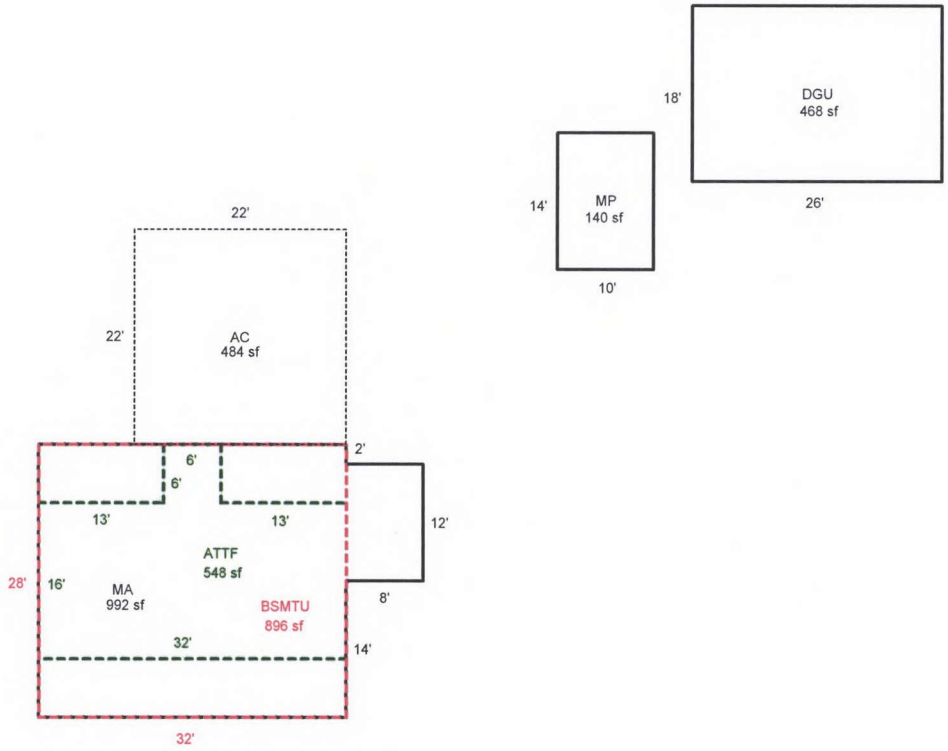

Scale: 1" = 20'

AREA CALCULATIONS

AREA CALCULATIONS SUMMARY

Code	Description	Factor	Net Size	Perimeter	Net Totals
GLA1	MA	1.00	992	136	992
GLA2	ATTF	1.00	548	108	548
GBA1	MP	1.00	140	48	140
BSMT	BSMTU	1.00	896	120	896
GAR	AC	1.00	484	88	88
	DGU	1.00	468	88	952

Net LIVABLE Area (rounded w/ factors) 1540
 Net BUILDING Area (rounded w/ factors) 140

Comment Table 1

DRAWN BY JRONDEMA 10/13/17

Comment Table 2

GRH 4/22/25

Comment Table 3

Cycle 12