

Acct ID: 562663 MTL: 081W12A001600 Date: 4/24/25 Appr: MLH Prop Class: 551 RMV Prop Class: 451  
 Situs: 3995 VICTOR POINT RD SE SUBLIMITY OR 97385 MaSaNh: 01 06 000 Unit: 101193 Year: 2025

Last Date Appraised: 08/23/2016 Appraiser: CLINT LUKE Retag: Y N Tag info:  
 Owner: SIMAS, DENNIS M & SIMAS, JULIA KAY Roll Type: R  
 Cycle Tag Sales Verification Other: Clean up Inspection level: 1 2 3 4 LCB TTO INSP AV: 216254  
 RMV Land: 387380 RMV Imp: 312590 RMV Total: 699970 MAV: 177200 MSAV: 39054 SAV: 81964  
 Comment:

**Notations** Update Inventory Input MLH 4/24/25

RP/MS	Code	Description
RP	ZONED	FARM EFU ZONED

**OSDs**

Count	Code	Description	RMV	Code Area	Exception
1	SAA	SA OSD - AVERAGE	50000	04580	0

**Land**

Site: 2 Code Area: 04580 Size: 1.00 Acres Use Code: 005 Zone: REST SAV Use: 011 Exception: 0  
 Class: 2HD Value Source: Farm Homesite Description: RMV: 71720 Exception: Y N  
 Adjustment(s): GSOIL Fire Patrol: Description:  
 Comments: Liability year - 2009 / 04200188

Site: 3 Code Area: 04580 Size: 0.64 Acres Use Code: 005 Zone: REST SAV Use: 011 Exception: 0  
 Class: 2HD Value Source: Farm Use - EFU Description: TWO HILL DRY RMV: 50490 Exception: Y N  
 Adjustment(s): GSOIL Fire Patrol: Description:  
 Comments: Liability year - 1974 / 04200188

Site: 4 Code Area: 04580 Size: 3.00 Acres Use Code: 005 Zone: REST SAV Use: 011 Exception: 0  
 Class: 4HD Value Source: Farm Use - EFU Description: FOUR HILL DRY RMV: 215170 Exception: Y N  
 Adjustment(s): GSOIL Fire Patrol: Description:  
 Comments: Liability year - 1974 / 04200188 /01-02; CHANGED SOIL CLASS FROM 3 HILL DRY TO 4 HILL DRY.

**Improvements - Residence / Manufactured Structures** EYB Roof Paint 2002

Bldg: 1 Code Area: 04580 Stat Class: 141 Year Blt: 1992 Eff Year Blt: 1992 Sq.Ft: 1036 % Complete: 100  
 Desc: One Story Only Dimensions: RMV: 215660  
 Func Obsc: 100 Econ %: 100 Other %: 100 Exception: 0 Adjust: Adjust RMV: 0 I/O

**Floors**

Type	Class	Display Group	Floor Size	Beds	Baths	Yr Blt	Eff Yr Blt	Inventory	Exception
First Floor	4	Finished	1036	3	FB-2	1992	1992	FP - 1, HVAC, KIT-, BATH - 2, ROOF	Y N

**Accessories**

Description	Class	Size SqFt	Eff Yr Blt	RMV	Quantity	Exception
ENCLOSED PORCH	4	128	1992	3656	1	Y N
YARD IMPROVEMENTS GOOD	5	1	1992	46830	1	Y N

**Improvements - Accessory Buildings**

Bldg: 2 Code Area: 04580 Stat Class: 301 Year Blt: Eff Year Blt: Sq.Ft: 30 % Complete: 100  
 Desc: Accessory Improvements & Misc. Dimensions: 6x5 RMV: 0  
 Func Obsc: 100 Econ %: 100 Other %: 100 Exception: 0 Adjust: Adjust RMV: 0 NC

**Floors**

Type	Class	Display Group	Floor Size	Beds	Baths	Yr Blt	Eff Yr Blt	Inventory	Exception
Pump House	0	Finished	30	0	0	0	0		Y N

**Accessories**

Description	Class	Size SqFt	Eff Yr Blt	RMV	Quantity
No accessory data available					

Bldg: 3 Code Area: 04580 Stat Class: 351 Year Blt: 1990 Eff Year Blt: 1999 Sq.Ft: 1015 % Complete: 100  
 Desc: General Purpose Building (GB) Dimensions: 35x29 RMV: 7000  
 Func Obsc: 100 Econ %: 100 Other %: 100 Exception: 0 Adjust: Adjust RMV: 0 I/O

**Floors**

Type	Class	Display Group	Floor Size	Beds	Baths	Yr Blt	Eff Yr Blt	Inventory	Exception
General Purpose Bldg	5	Finished	1015	0	0	1990	1990	FAIR	Y N

**Accessories**

Description	Class	Size SqFt	Eff Yr Blt	RMV	Quantity
No accessory data available				1999	

Bldg: 4 Code Area: 04580 Stat Class: 351 Year Blt: 1985 Eff Year Blt: ~~1985~~ Sq.Ft: 2640 % Complete: 100  
 Desc: General Purpose Building (GB) Dimensions: 60x44 RMV: 11600  
 Func Obsc: 100 Econ %: 100 Other %: 100 Exception: 0 Adjust: Adjust RMV: 0 I/O

**Floors**

Type	Class	Display Group	Floor Size	Beds	Baths	Yr Blt	Eff Yr Blt	Inventory	Exception: Y N
General Purpose Bldg	5	Finished	2640	0	0	1985	1985	FAIR	

**Accessories**

Description	Class	Size SqFt	Eff Yr Blt	RMV	Quantity
No accessory data available					

Bldg: 5 Code Area: 04580 Stat Class: 353 Year Blt: 2004 Eff Year Blt: 2004 Sq.Ft: 3440 % Complete: 100  
 Desc: Machine Shed (MS) Dimensions: 40x60 RMV: 41820  
 Func Obsc: 100 Econ %: 100 Other %: 100 Exception: 0 Adjust: Adjust RMV: 0 I/O

**Floors**

Type	Class	Display Group	Floor Size	Beds	Baths	Yr Blt	Eff Yr Blt	Inventory	Exception: Y N
Machine Shed	5	Finished	2400	0	0	2004	2004	FAIR	
Finished Office	5	Finished	1040	0	0	2004	2004		

**Accessories**

Description	Class	Size SqFt	Eff Yr Blt	RMV	Quantity
No accessory data available					

Bldg: 6 Code Area: 04580 Stat Class: 301 Year Blt: 2015 Eff Year Blt: 2015 Sq.Ft: 324 % Complete: 100  
 Desc: Accessory Improvements & Misc. Dimensions: 18x18 RMV: 11340  
 Func Obsc: 100 Econ %: 100 Other %: 100 Exception: 0 Adjust: Adjust RMV: 0

**Floors** Gazebo, Part of YI Move MAV

Type	Class	Display Group	Floor Size	Beds	Baths	Yr Blt	Eff Yr Blt	Inventory	Exception: Y N
Building Structure	0	Finished	324	0	0	2015	2015		

**Accessories**

Description	Class	Size SqFt	Eff Yr Blt	RMV	Quantity
No accessory data available					

Bldg: 7 Code Area: 04580 Stat Class: 351 Year Blt: 2004 Eff Year Blt: 2004 Sq.Ft: 1920 % Complete: 100  
 Desc: General Purpose Building (GB) Dimensions: RMV: 25170  
 Func Obsc: 100 Econ %: 100 Other %: 100 Exception: 0 Adjust: Adjust RMV: 0 I/O

**Floors**

Type	Class	Display Group	Floor Size	Beds	Baths	Yr Blt	Eff Yr Blt	Inventory	Exception: Y N
General Purpose Bldg	5	Finished	1920	0	FB-1	2004	2004	FAIR, BATH - 1	

880 AVE 1040 G

**Accessories**

Description	Class	Size SqFt	Eff Yr Blt	RMV	Quantity
No accessory data available					

R62663  
081W12A 01600  
SCALE=1:40

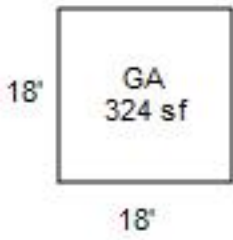
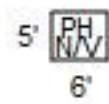
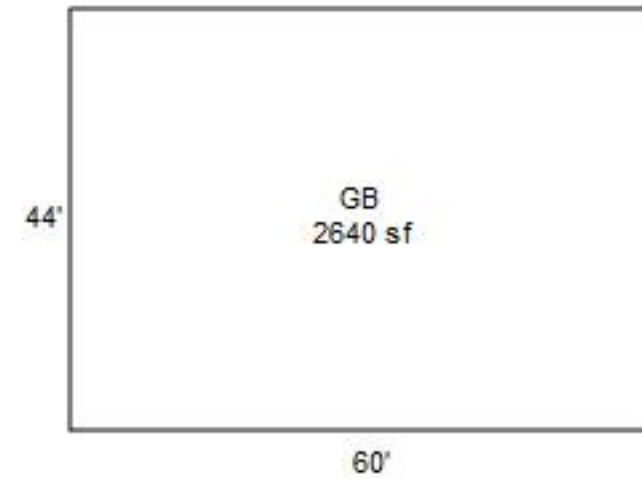
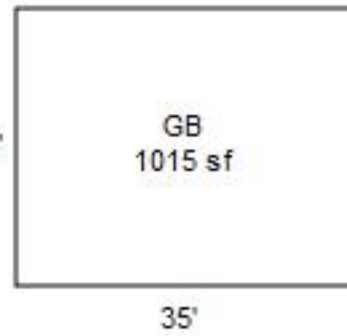
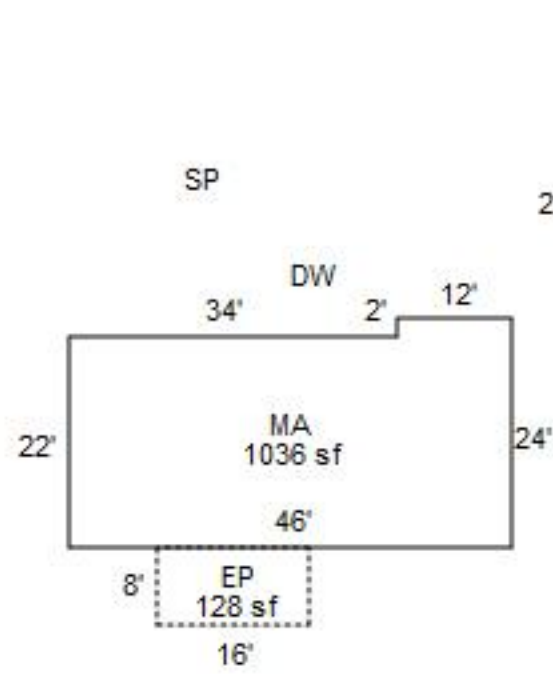
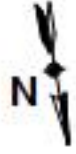



R62663

GB 35X29

N.SIDE

8/23/16

A photograph showing a white shed with a gabled roof in the foreground, partially obscured by a large tree on the left. In the background, a larger white building with a gabled roof and two windows is visible. The scene is set outdoors with green grass and a clear blue sky. Red text is overlaid on the bottom left and bottom right of the image.

R62663  
PH 6X5 N/V

8/23/16



R62663

GB 60X44

E.SIDE

8/23/16



R62663

GB 40X48 & OFF 40X26

8/23/16



R62653

MS 40X60

8/23/16





R62663  
GA 18X18

8/23/16



R62663

MA S.SIDE

8/23/16