

Acct ID: 330318 MTL: 062W090002800P1 Date: **4/9/25** Appr: **02** Prop Class: 019 RMV Prop Class: 019

Situs: 5812 TUMBLEWEED CIR NE SALEM, OR 97305 MaSaNh: 13 05 000 Unit: 330318 Year: 2025

Last Date Appraised: 04/05/2021 Appraiser: THERESA SWEARINGEN Retag: Y N Tag info:

Owner: DEHAVEN, KIM ELAINE Roll Type: MS

Cycle Tag Sales Verification Other: _____ Inspection level: 1 2 **3** 4 LCB TTO INSP AV: 67110

RMV Land: 0 RMV Imp: 108820 RMV Total: 108820 MAV: 67110 MSAV: 0 SAV: 0

Comment: CHAPARRAL MOBILE RANCH, MS SERIAL # GWOR23N25958AB, X # X00255254, PERSONAL MS

Notations
No notation data available. **N/C**

OSDs
No OSD data available.

Land
No land data available.

Improvements - Residence / Manufactured Structures

Bldg: 1 Code Area: 02410 Stat Class: 457 + Year Blt: 2002 Eff Year Blt: 2002 Sq.Ft: 1539 % Complete: 100
 Desc: MANUF STRUCT, CLASS 5, 26' THROUGH 28' WIDE DOUBLE Dimensions: 57x27 RMV: 108820
 Func Obsc: 100 Econ %: 100 Other %: 100 Exception: 0 Adjust: Adjust RMV: 0

Floors

Type	Class	Display Group	Floor Size	Beds	Baths	Yr Blt	Eff Yr Blt	Inventory	Exception: Y N
First Floor	5 +	Finished	1539	3	FB-2	2002	2002	SKIRT, ROOF, HVAC+, KIT, BATH - 2	Y N

Accessories

Description	Class	Size SqFt	Eff Yr Blt	RMV	Quantity	Exception: Y N
DECK	5	162	2002	2495	1	Y N
ROOF EXTENSION OR PATIO COVER	5	162	2002	3289	0	Y N

Improvements - Accessory Buildings

No improvement data available for all other stat class types.

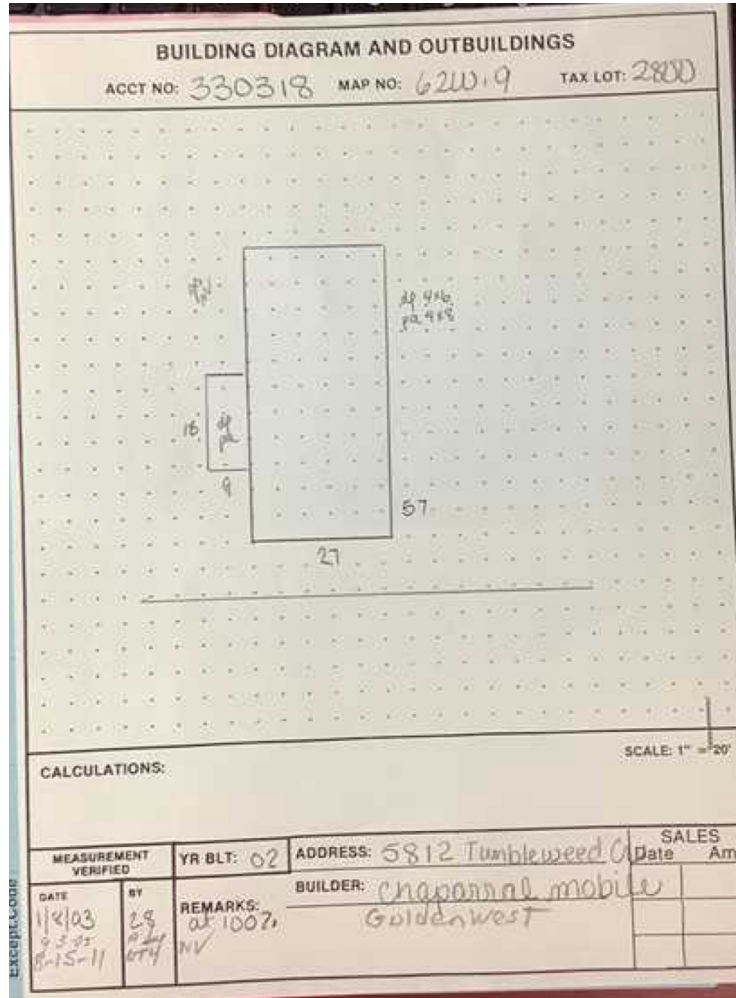

Failed Photo