

Acct ID: 542452 MTL: 106E18AA00100 Date: **1-29-25** Appr: **Gene** Prop Class: 641 RMV Prop Class: 401
 Situs: 1487 NORTH SANTIAM HWY SE IDANHA OR 97350 MaSaNh: 01 06 000 Unit: 117137 Year: 2024

**INPUT
2-7-25
Gene**

Last Date Appraised: 01/21/2016 Appraiser: CLINT LUKE Retag: **Y** Tag info: _____
 Owner: HIEBERT, DONALD Roll Type: R
 Cycle Tag Sales Verification Other: _____ Inspection level: **1** 2 3 4 LCB **TTG** INSP AV: 133359
 RMV Land: 493260 RMV Imp: 201300 RMV Total: 694560 MAV: 126510 MSAV: 6849 SAV: 12041
 Comment: 07-08: INSIDE CITY LIMITS, NO FP CHARGES OR SURCHARGE

Notations

RP/MS	Code	Description
RP	DFL	DESIGNATED FORESTLAND

OSDs

Count	Code	Description	RMV	Code Area	Exception
1	MKTF	OSD - FAIR	35000	56120	0

Land

Timber OK WW

Site: 1 Code Area: 56120 Size: 1.00 Acres Use Code: 004 Zone: NREST SAV Use: _____ Exception: 0
 Class: Value Source: Market Homesite Description: _____ RMV: 29570 Exception: Y N

Adjustment(s): _____ Fire Patrol: _____ Description: _____
 Comments: 12912120//09-10: HOMESITE NOT SPEC ASS'D DUE TO UNZONED FOREST DEFERRAL//03-04: REAPPRAISAL

Site: 3 Code Area: 56120 Size: 14.50 Acres Use Code: 004 Zone: NREST SAV Use: 011 Exception: 0
 Class: FTLD Value Source: Designated Forest Land Description: DFL Class D RMV: 428690 Exception: Y N

Adjustment(s): _____ Fire Patrol: _____ Description: _____
 Comments: Liability year - 1986 / 12912120

Improvements - Residence / Manufactured Structures

Bldg: 1 Code Area: 56120 Stat Class: 132 Year Blt: 1972 Eff Year Blt: 1987 Sq.Ft: 2304 % Complete: 100
 Desc: Multi Story above grade Dimensions: _____ RMV: 176740
 Func Obsc: 80 Econ %: 100 Other %: 100 Exception: 0 Adjust: _____ Adjust RMV: 0

Floors

Type	Class	Display Group	Floor Size	Beds	Baths	Yr Blt	Eff Yr Blt	Inventory	Exception
First Floor	3	Finished	1632	1	FB-1	1972	1987	ROOF, FP - 1, HVAC, KITCH, BATH	Y N
Second Floor	3	Finished	672	0	0	2013	1987	HVAC, ROOF	Y N

Accessories

Description	Class	Size SqFt	Eff Yr Blt	RMV	Quantity	Exception
YARD IMPROVEMENTS GOOD	3	1	1987	18414	1	Y N

Improvements - Accessory Buildings

Bldg: 2 Code Area: 56120 Stat Class: 341 Year Blt: 1992 Eff Year Blt: 1992 Sq.Ft: 280 % Complete: 100
 Desc: Multi Purpose Shed (MP) Dimensions: 20x14 RMV: 1880
 Func Obsc: 100 Econ %: 100 Other %: 100 Exception: 0 Adjust: _____ Adjust RMV: 0

Floors

Type	Class	Display Group	Floor Size	Beds	Baths	Yr Blt	Eff Yr Blt	Inventory	Exception
Multi-Purpose Bldg	6	Finished	280	0	0	1992	1992	AVS	Y N

Accessories

Description	Class	Size SqFt	Eff Yr Blt	RMV	Quantity
No accessory data available					

Bldg: 3 Code Area: 56120 Stat Class: 351 Year Blt: 2002 Eff Year Blt: 2002 Sq.Ft: 1008 % Complete: 100
 Desc: General Purpose Building (GB) Dimensions: 28x36 RMV: 15430
 Func Obsc: 100 Econ %: 100 Other %: 100 Exception: 0 Adjust: _____ Adjust RMV: 0

Floors

Type	Class	Display Group	Floor Size	Beds	Baths	Yr Blt	Eff Yr Blt	Inventory	Exception
General Purpose Bldg	6	Finished	1008	0	0	2002	2002	FMR AVS	Y N

Accessories

Description	Class	Size SqFt	Eff Yr Blt	RMV	Quantity
No accessory data available					

Bldg: 4 Code Area: 56120 Stat Class: 341 Year Blt: 2000 Eff Year Blt: 2000 Sq.Ft: 190 ¹⁶⁰ % Complete: 100
 Desc: Multi Purpose Shed (MP) Dimensions: 10x16 ¹⁶ RMV: 2010
 Func Obsc: 100 Econ %: 100 Other %: 100 Exception: 0 Adjust: Adjust RMV: 0

Floors

Type	Class	Display Group	Floor Size	Beds	Baths	Yr Blt	Eff Yr Blt	Inventory	Exception: Y N
Multi-Purpose Bldg	4	Finished	190 ¹⁶⁰	0	0	2000	2000	2014 Avg	Y N

Accessories

Description	Class	Size SqFt	Eff Yr Blt	RMV	Quantity
No accessory data available					

Bldg: 5 Code Area: 56120 Stat Class: 341 Year Blt: 2006 Eff Year Blt: 2006 Sq.Ft: 112 ¹²⁰ % Complete: 100
 Desc: Multi Purpose Shed (MP) Dimensions: 8x14 ^{10x12} RMV: 3420
 Func Obsc: 100 Econ %: 100 Other %: 100 Exception: 0 Adjust: Adjust RMV: 0

Floors

Type	Class	Display Group	Floor Size	Beds	Baths	Yr Blt	Eff Yr Blt	Inventory	Exception: Y N
Multi-Purpose Bldg	6	Finished	112	0	0	2006	2006	Avg	Y N

Accessories

Description	Class	Size SqFt	Eff Yr Blt	RMV	Quantity
No accessory data available					

Bldg: 6 Code Area: 56120 Stat Class: 354 Year Blt: 2000 Eff Year Blt: 2000 Sq.Ft: 150 ¹⁶⁰ % Complete: 100
 Desc: Lean-to Light (LTL) Dimensions: 10x16 ¹⁶ RMV: 330
 Func Obsc: 100 Econ %: 100 Other %: 100 Exception: 0 Adjust: Adjust RMV: 0

Floors

Type	Class	Display Group	Floor Size	Beds	Baths	Yr Blt	Eff Yr Blt	Inventory	Exception: Y N
Lean-to Light Duty	4	Finished	150 ¹⁶⁰	0	0	2000	2000		Y N

Accessories

Description	Class	Size SqFt	Eff Yr Blt	RMV	Quantity
No accessory data available					

Bldg: 7 Code Area: 56120 Stat Class: 354 Year Blt: 2005 Eff Year Blt: 2005 Sq.Ft: 576 % Complete: 100
 Desc: Lean-to Light (LTL) Dimensions: 16x36 ¹⁶ RMV: 1490
 Func Obsc: 100 Econ %: 100 Other %: 100 Exception: 0 Adjust: Adjust RMV: 0

Floors

Type	Class	Display Group	Floor Size	Beds	Baths	Yr Blt	Eff Yr Blt	Inventory	Exception: Y N
Lean-to Light Duty	6	Finished	576	0	0	2005	2005	NC	Y N

Accessories

Description	Class	Size SqFt	Eff Yr Blt	RMV	Quantity
No accessory data available					

HTC 5 20x30 600 Fmr 60% Yo
 (was not valued in pass)

SKETCH/AREA TABLE ADDENDUM

SUBJECT INFO

File No.: 542452 Parcel No.: 106E18AA00100
 Property Address: 1487 NORTH SANTIAM HY SE
 City: IDANHA County: MARION State: OR ZipCode: 97350
 Owner:
 Client: Client Address:
 Appraiser Name: Inspection Date:

SKETCH

542452
106E18AA00100
SCALE=1:30

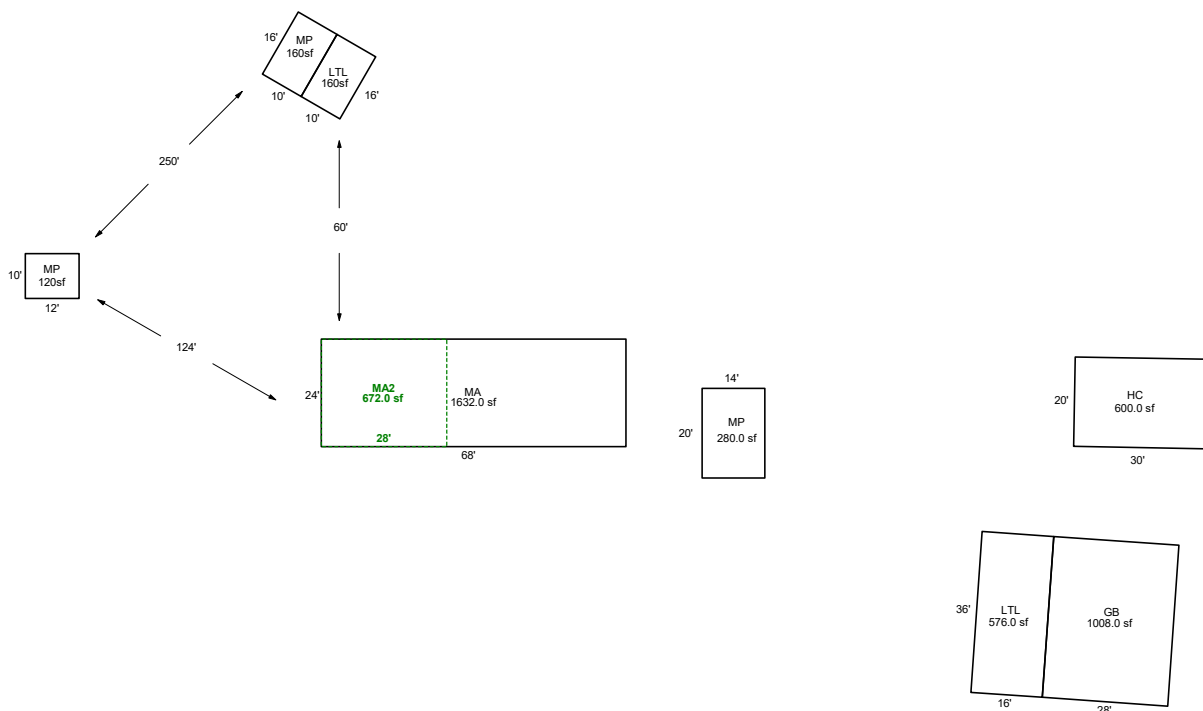

Sketch by ApexSketch

AREA CALCULATIONS SUMMARY						COMMENT TABLE 1	
Code	Description	Factor	Net Size	Perimeter	Net Totals		
GBA1	MP	1.0	280.0	68.0		DRAWN BY JRONDEMA 5/20/15 UPDATED BY CLOBERG 02/07/25	
	MP	1.0	160.0	52.0			
	LTL	1.0	160.0	52.0			
	LTL	1.0	576.0	104.0			
	MP	1.0	120.0	44.0	1296.0		
GBA2	GB	1.0	1008.0	128.0	1008.0		
GLA1	MA	1.0	1632.0	184.0	1632.0		
GLA2	MA2	1.0	672.0	104.0	672.0		
OTH	HC	1.0	600.0	100.0	600.0		
						COMMENT TABLE 2	COMMENT TABLE 3
						CLUKE 01/29/25	CYCLE L2
		Net LIVABLE	cnt	0 (rounded)	2,304		
		Net BUILDING	cnt	6 (rounded)	2,304		



1/29/25



1/29/25



1/29/25



1/29/25



1/29/25



1/29/25



1/29/25



1/29/25