

Summary Lead Appr: WW 3.12.25 Clerk: \_\_\_\_\_ Lead Clerk: \_\_\_\_\_ Appr: MDL Input Print Date: 12/20/2024

Acct ID: 536032 MTL: 093W01C000400 Date: 3/7/25 Appr: MDL Prop Class: 401 RMV Prop Class: 401  
 Situs: 9795 DEEP LN SE TURNER OR 97392 MaSaNh: 07 06 000 Unit: 147658 Year: 2025

Last Date Appraised: 10/19/2021 Appraiser: MATT LORD Retag: Y N Tag info: \_\_\_\_\_  
 Owner: ALDERIN, SETH P Roll Type: R  
 Cycle Tag Sales Verification Other: \_\_\_\_\_ Inspection level: 1 2 3 4 LCB TTO INSP AV: 333810  
 RMV Land: 288260 RMV Imp: 383410 RMV Total: 671670 MAV: 333810 MSAV: 0 SAV: 0  
 Comment: 22-23 L2 10/19/21 MLORD

MHS 819168  
Dom 56

Notations 25-26: SV

No notation data available.

OSDs

Count	Code	Description	RMV	Code Area	Exception
1	MKTA	OSD - AVERAGE	50000	92590	0

Land

Site: 1	Code Area: 92590	Size: 1.05 Acres	Use Code: 004	Zone: NREST	SAV Use:	Exception: 0
Class: 2HD	Value Source: Rural at MKT	Description: TWO HILL DRY	RMV: 119910	Exception: Y N		
Adjustment(s):	GSOIL	Fire Patrol:	Description:			
Comments:	20-21: PER #35 DEL OSD AS MH IS GONE.// 00-01: REAPPRAISAL					
Site: 2	Code Area: 92590	Size: 1.14 Acres	Use Code: 004	Zone: NREST	SAV Use:	Exception: 0
Class: 4HD	Value Source: Rural at MKT	Description: FOUR HILL DRY	RMV: 118350	Exception: Y N		
Adjustment(s):	GSOIL	Fire Patrol:	Description:			
Comments:						

Improvements - Residence / Manufactured Structures

Bldg: 2	Code Area: 92590	Stat Class: 141	Year Blt: 2021	Eff Year Blt: 2021	Sq.Ft: 1945	% Complete: 100
Desc: One Story Only	Dimensions:	RMV: 381280				
Func Obsc: 100	Econ %: 100	Other %: 100	Exception: 0	Adjust:	Adjust RMV: 0	

Floors

Type	Class	Display Group	Floor Size	Beds	Baths	Yr Blt	Eff Yr Blt	Inventory	Exception
First Floor	4	Finished	1945	3	FB-2	2021	2021	ROOF, HVAC+, BATH - 2, KIT	Y N
Garage Attached	4	Finished	616	0	0	2021	2021	ROOF	Y N

Accessories

Description	Class	Size SqFt	Eff Yr Blt	RMV	Quantity	Exception
ASPHALT DRIVEWAY	4	3700	2021	10989	0	Y N
PATIO	4	1355	2021	7377	0	Y N
ROOF EXTENSION OR PATIO COVER	4	156	2021	4479	0	Y N

Improvements - Accessory Buildings

Bldg: 1	Code Area: 92590	Stat Class: 341	Year Blt: 2019	Eff Year Blt: 2019	Sq.Ft: <del>112</del> <u>154</u>	% Complete: 100
Desc: Multi Purpose Shed (MP)	Dimensions: <u>11x14</u>	RMV: 2130				
Func Obsc: 100	Econ %: 100	Other %: 100	Exception: 0	Adjust:	Adjust RMV: 0	

Floors

Type	Class	Display Group	Floor Size	Beds	Baths	Yr Blt	Eff Yr Blt	Inventory	Exception
Multi-Purpose Bldg	4	Finished	112	0	0	2019	2019		Y N

Accessories

Description	Class	Size SqFt	Eff Yr Blt	RMV	Quantity
No accessory data available					

# SKETCH/AREA TABLE ADDENDUM

## SUBJECT INFO

File No.: R36032 Parcel No.: 093W01C 00400  
 Property Address: 2995 RIDGEWAY DR SE  
 City: TURNER County: MARION State: OR ZipCode: 97392  
 Owner:  
 Client: Client Address:  
 Appraiser Name: Inspection Date:

## SKETCH

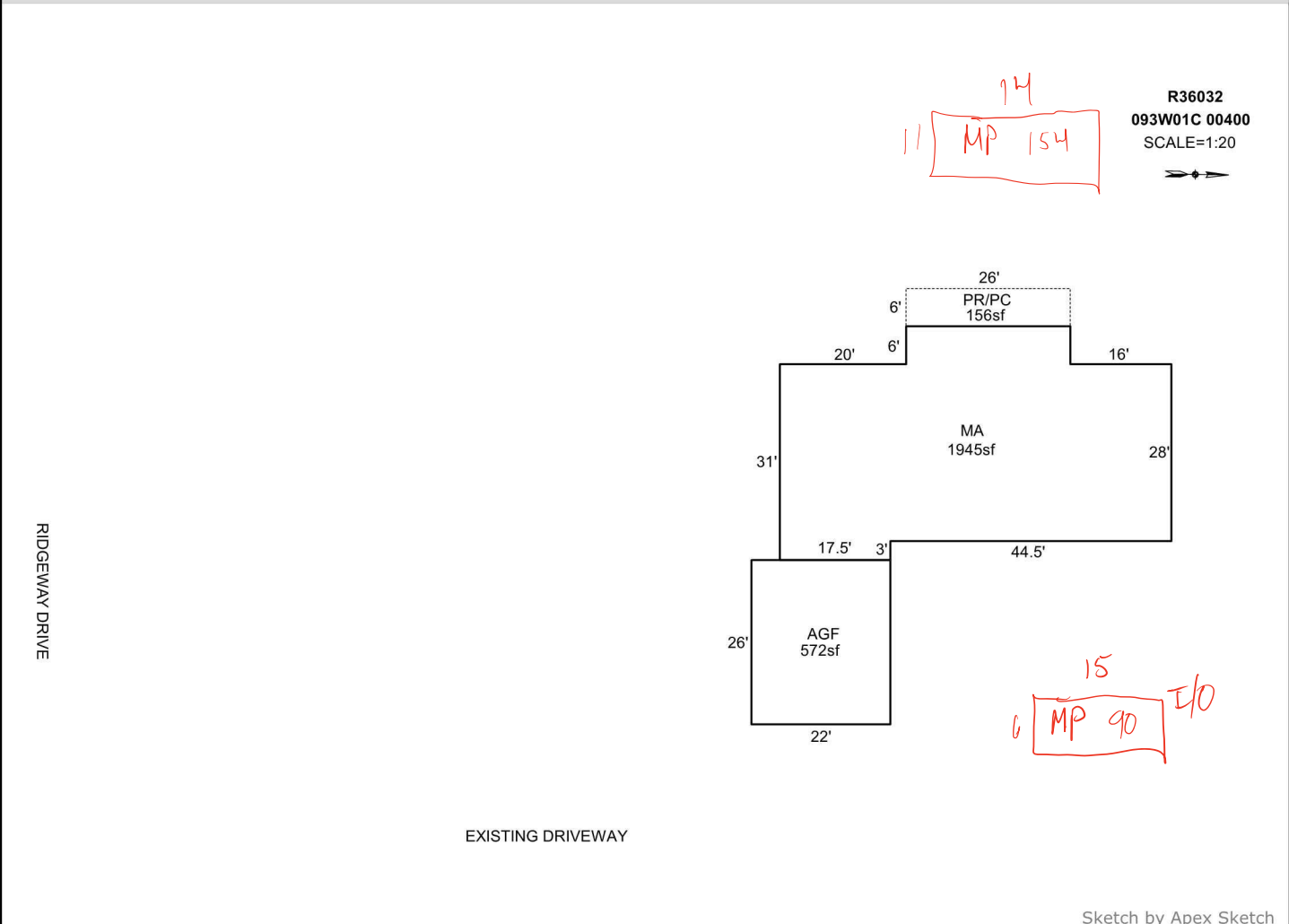

AREA CALCULATIONS SUMMARY					
Code	Description	Factor	Net Size	Perimeter	Net Totals
GLA1	MA	1.0	1944.5	198.0	1944.5
GAR	AGF	1.0	572.0	96.0	572.0
P/P	PR/PC	1.0	156.0	64.0	156.0
Net LIVABLE		cnt	1 (rounded)		1,945

COMMENT TABLE 1	
DRAWN BY JRONDEMA 6/22/18 UPD BY PH 03.05.20  UPDATED BY CJURAN 02/08/2021 555-20-008815  3.7.25 L4 MDL SV	
COMMENT TABLE 2	COMMENT TABLE 3
12.16.19 NM #35	TAGS&S.V.



