

Acct ID: 542455 MTL: 106E22AA00600 Date: **1-24-25** Appr: **Conce** Prop Class: 451 RMV Prop Class: 451  
 Situs: 49985 NORTH SANTIAM HWY SE IDANHA OR 97350 MaSaNh: 01 06 000 Unit: 117140 Year: 2024  
 Last Date Appraised: 08/27/2015 Appraiser: CLINT LUKE Retag: Y **N** Tag info: **IMPAS 2/7/25 Conce**  
 Owner: WOODRING, CHARLES & WOODRING, JUDITH Roll Type: R  
 Cycle: Tag Sales Verification Other: \_\_\_\_\_ Inspection level: 1 **2** 3 4 LCB **TO** INSP AV: 149250  
 RMV Land: 193870 RMV Imp: 154870 RMV Total: 348740 MAV: 149250 MSAV: 0 SAV: 0  
 Comment:

**Notations**

No notation data available.

**OSDs**

Count	Code	Description	RMV	Code Area	Exception
1	MKTA	OSD - AVERAGE	45000	56520	0

**Land**

Site: 1 Code Area: 56520 Size: 0.59 Acres Use Code: 005 Zone: REST SAV Use: Exception: 0  
 Class: Value Source: **Rural Restrictive** Description: RMV: 148870 Exception: Y N  
 Adjustment(s): Fire Patrol: SA004 Description: FIRE PATROL  
 Comments: 2003-04 REAPPRAISAL.

**Improvements - Residence / Manufactured Structures**

Bldg: 1 Code Area: 56520 Stat Class: 132 Year Blt: 1966 Eff Year Blt: 1966 Sq.Ft: 1440 % Complete: 100  
 Desc: Multi Story above grade Dimensions: RMV: 148330  
 Func Obsc: 100 Econ %: 100 Other %: 100 Exception: 0 Adjust: Adjust RMV: 0

**Floors**

Type	Class	Display Group	Floor Size	Beds	Baths	Yr Blt	Eff Yr Blt	Inventory	Exception
First Floor	3	Finished	1320	2	FB-1	1966	1966	ROOF, FP - 1, HALL, KIT, BATH #1	Y N
Attic	3	Finished	120	2	0	1966	1966	HVAC	Y N
Carport Attached	3	Unfinished	348	0	0	1985	1985	ROOF	Y N

**Accessories**

Description	Class	Size SqFt	Eff Yr Blt	RMV	Quantity	Exception
YARD IMPROVEMENTS AVERAGE	3	1	1966	12053	1	Y N

**Improvements - Accessory Buildings**

Bldg: 2 Code Area: 56520 Stat Class: 351 Year Blt: 1995 Eff Year Blt: 1995 Sq.Ft: 576 % Complete: 100  
 Desc: General Purpose Building (GB) Dimensions: 24x24 RMV: 5830  
 Func Obsc: 100 Econ %: 100 Other %: 100 Exception: 0 Adjust: Adjust RMV: 0

**Floors**

Type	Class	Display Group	Floor Size	Beds	Baths	Yr Blt	Eff Yr Blt	Inventory	Exception
General Purpose Bldg	5	Finished	576	0	0	1995	1995	PAIR	Y N

**Accessories**

Description	Class	Size SqFt	Eff Yr Blt	RMV	Quantity	Exception
No accessory data available						

Bldg: 3 Code Area: 56520 Stat Class: 355 Year Blt: 1995 Eff Year Blt: 1995 Sq.Ft: 240 % Complete: 100  
 Desc: Lean-to Heavy (LTH) Dimensions: 24x10 RMV: 710  
 Func Obsc: 100 Econ %: 100 Other %: 100 Exception: 0 Adjust: Adjust RMV: 0

**Floors**

Type	Class	Display Group	Floor Size	Beds	Baths	Yr Blt	Eff Yr Blt	Inventory	Exception
Lean-to Heavy Duty	4	Finished	240	0	0	1995	1995		Y N

**Accessories**

Description	Class	Size SqFt	Eff Yr Blt	RMV	Quantity	Exception
No accessory data available						

HC 6 20x20 2017 **FAIL** **NSW**  
 HC 5 16x24 2022 **FAIL** **NSW**

# SKETCH/AREA TABLE ADDENDUM

## SUBJECT INFO

File No.: 542455 Parcel No.: 106E22AA00600  
 Property Address: 49985 NORTH SANTIAM HY SE  
 City: IDANHA County: MARION State: OR ZipCode: 97350  
 Owner:  
 Client: Client Address:  
 Appraiser Name: Inspection Date:

## SKETCH

542455  
106E22AA00600  
SCALE=1:20

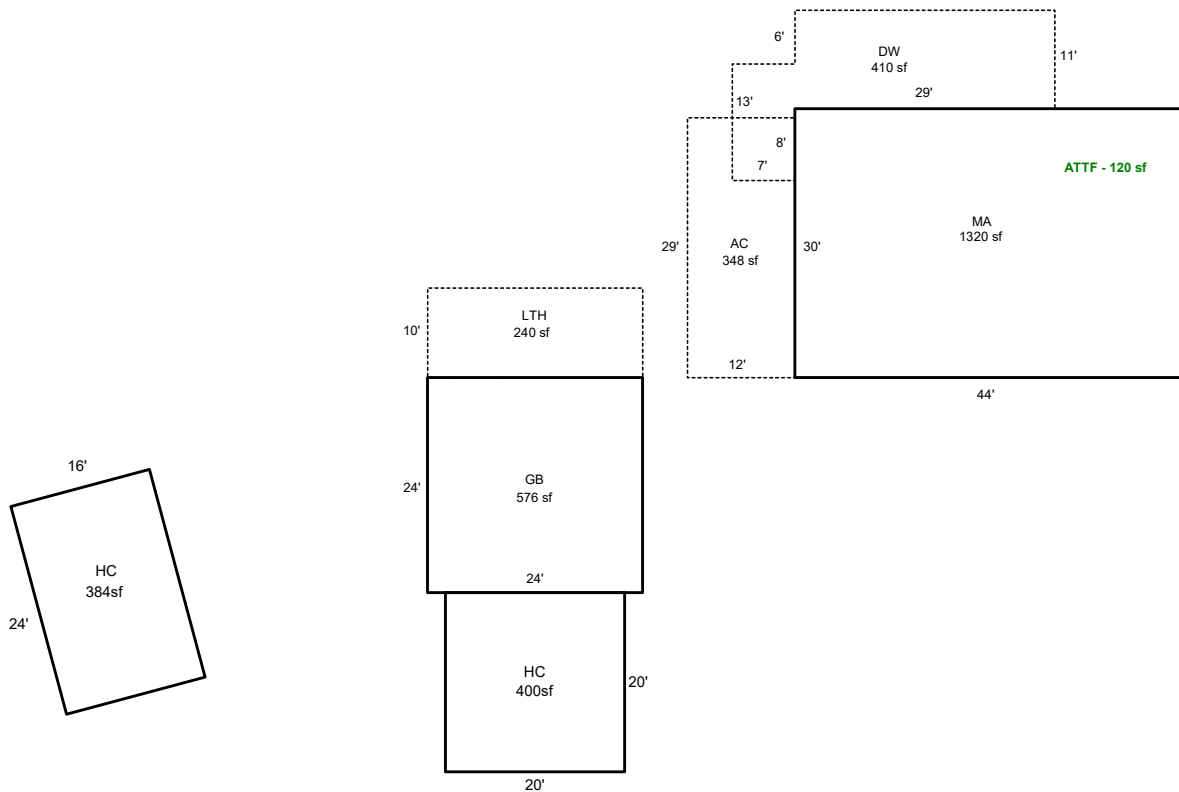

Sketch by ApexSketch

### AREA CALCULATIONS SUMMARY

Code	Description	Factor	Net Size	Perimeter	Net Totals
GBA1	GB	1.0	576.0	96.0	
	LTH	1.0	240.0	68.0	
	HC	1.0	400.0	80.0	
	HC	1.0	384.0	80.0	1600.0
GLA1	MA	1.0	1320.0	148.0	1320.0
GAR	AC	1.0	348.0	82.0	348.0
P/P	DW	1.0	410.0	110.0	410.0
	Net LIVABLE	cnt	0 (rounded)		1,320
	Net BUILDING	cnt	4 (rounded)		1,600

### COMMENT TABLE 1

DRAWN BY JRONDEMA 9/6/18  
 UPDATED BY CLOBERG 02/06/25

### COMMENT TABLE 2

CLUKE 01/29/25

### COMMENT TABLE 3

CYCLE L2



1/29/24



1/29/24