

Acct ID: 538928 MTL: 071E26C000400 Date: 10/29/24 Appr: MLH Prop Class: 641 RMV Prop Class: 401  
 Situs: 182 SILVER FALLS DR SE SILVERTON OR 97381 MaSaNh: 03 06 000 Unit: 68867 Year: 2024  
 Last Date Appraised: 05/21/2020 Appraiser: MATTHEW HAMILTON Retag: Y Tag info: \_\_\_\_\_

Owner: PRINCE, NICHOLAS ANDREW Roll Type: R  
 Cycle Tag Sales Verification Other: \_\_\_\_\_ Inspection level: 1 2 3 4 LCB TTO INSP AV: 640501  
 RMV Land: 467070 RMV Imp: 803420 RMV Total: 1270490 MAV: 636470 MSAV: 4031 SAV: 7065

*NEW ML @ 100% Update inventory*

Notations *MA Addn not started Retag for 26 use Tag*

RP/MS	Code	Description
RP	DFL	DESIGNATED FORESTLAND

Input MLH 1/28/25

OSDs

Count	Code	Description	RMV	Code Area	Exception
2	MKTA	OSD - AVERAGE	45000	04480	0

Land

Site: 1 Code Area: 04480 Size: 1.00 Acres Use Code: 005 Zone: REST SAV Use: \_\_\_\_\_ Exception: 0  
 Class: 1 Value Source: Market Homesite Description: \_\_\_\_\_ RMV: 55090 Exception: Y N  
 Adjustment(s): H2OAR, GSOIL, IRR Fire Patrol: SA004 Description: FIRE PATROL  
 Comments: 19-20: APPROVED FOR DFL //18-19: DISQ FARM USE// 17-18: UPDATE PART TOTALS / 12-13: PER #31, ADD WATER ADJ FOR POND / 05-06: RECALC SETUP;#17 5-10-04/ 00-01; UPDATED MARKET VALUE/03- 04: UPDATED PART TOTAL INFO

Site: 3 Code Area: 04480 Size: 4.56 Acres Use Code: 005 Zone: REST SAV Use: \_\_\_\_\_ Exception: 0  
 Class: 3 Value Source: Rural Restrictive Description: \_\_\_\_\_ RMV: 131550 Exception: Y N  
 Adjustment(s): H2OAR, GSOIL, IRR Fire Patrol: SA004 Description: FIRE PATROL  
 Comments: \_\_\_\_\_

Site: 4 Code Area: 04480 Size: 1.70 Acres Use Code: 005 Zone: REST SAV Use: \_\_\_\_\_ Exception: 0  
 Class: 4 Value Source: Rural Restrictive Description: \_\_\_\_\_ RMV: 44780 Exception: Y N  
 Adjustment(s): H2OAR, GSOIL, IRR Fire Patrol: SA004 Description: FIRE PATROL  
 Comments: \_\_\_\_\_

Site: 5 Code Area: 04480 Size: 0.35 Acres Use Code: 005 Zone: REST SAV Use: \_\_\_\_\_ Exception: 0  
 Class: 5 Value Source: Rural Restrictive Description: \_\_\_\_\_ RMV: 8780 Exception: Y N  
 Adjustment(s): H2OAR, GSOIL, IRR Fire Patrol: SA004 Description: FIRE PATROL  
 Comments: \_\_\_\_\_

Site: 6 Code Area: 04480 Size: 7.25 Acres Use Code: 005 Zone: REST SAV Use: 011 Exception: 0  
 Class: FTLC Value Source: Designated Forest Land Description: DFL Class C RMV: 181870 Exception: Y N  
 Adjustment(s): H2OAR, GSOIL, IRR Fire Patrol: SA004 Description: FIRE PATROL  
 Comments: Liability year - 2019 / 19-20: APPROVED 7.25 ACRES DFL

Improvements - Residence / Manufactured Structures

Bldg: 1 Code Area: 04480 Stat Class: 154 + Year Blt: 1989 Eff Year Blt: 1998 Sq.Ft: 3537 % Complete: 100  
 Desc: Multi Story above grade with basement *EVB Roof siding Paint* Dimensions: \_\_\_\_\_ RMV: 800270  
 Func Obsc: 100 Econ %: 100 Other %: 100 Exception: 0 Adjust: \_\_\_\_\_ Adjust RMV: 0 *I/O*

Floors

Type	Class	Display Group	Floor Size	Beds	Baths	Yr Blt	Eff Yr Blt	Inventory	Exception
First Floor	5 +	Finished	2267	1	FB-1	1989	1989	BATH - 1, HVAC+, FP - 2, ROOF, KIT	Exception: Y N
Second Floor	5 +	Finished	1270	2	<u>FB-2</u>	1989	1989	BATH <u>1</u> , HVAC+	Exception: Y N
Basement	5 +	Unfinished	1606	0	FB-1	1989	1989	BATH - 1	Exception: Y N
Garage Attached	5	Finished	1148	0	0	1989	1989	ROOF <u>1</u>	Exception: Y N

Accessories

Description	Class	Size SqFt	Eff Yr Blt	RMV	Quantity	Exception
CONCRETE DRIVEWAY <i>part of YI</i>	5	1361	1999	3892	1	Exception: Y N
DECK	5	1770	1999	31152	1	Exception: Y N
YARD IMPROVEMENTS GOOD	5	1	1989	39218	1	Exception: Y N

Improvements - Accessory Buildings

Bldg: 2 Code Area: 04480 Stat Class: 353 Year Blt: 1994 Eff Year Blt: 1994 Sq.Ft: 750 % Complete: 100  
 Desc: Machine Shed (MS) Dimensions: \_\_\_\_\_ RMV: 3150  
 Func Obsc: 100 Econ %: 100 Other %: 100 Exception: 0 Adjust: \_\_\_\_\_ Adjust RMV: 0 *I/O*

Floors

Type	Class	Display Group	Floor Size	Beds	Baths	Yr Blt	Eff Yr Blt	Inventory	Exception: Y N
Machine Shed	4	Finished	750	0	0	1994	1994	Fair ply	

**Accessories**

Description	Class	Size SqFt	Eff Yr Blt	RMV	Quantity
No accessory data available					

357 FL 4 24x48 200%<sup>9</sup> Exempt  
 ML 5 75x50 2024 AVE good 1 Bath NEW  
 3510 240



# SKETCH/AREA TABLE ADDENDUM

## SUBJECT INFO

File No.: 538928 Parcel No.: 071E26C 00400  
 Property Address: 182 Silver Falls Dr SE  
 City: Silverton County: State: OR ZipCode: 97381  
 Owner:  
 Client: Client Address:  
 Appraiser Name: Inspection Date:

## SKETCH

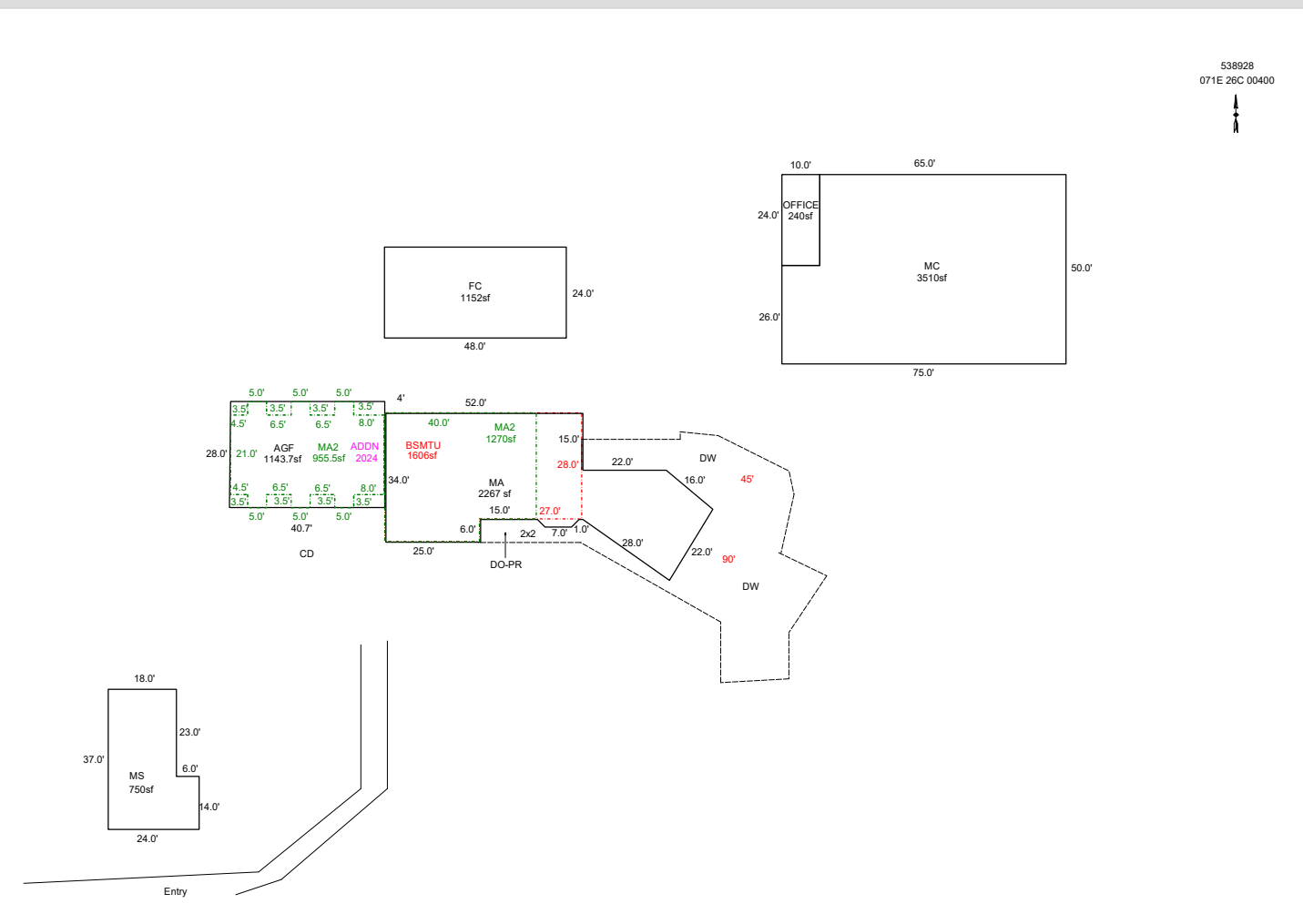

Sketch by ApexSketch

AREA CALCULATIONS SUMMARY						COMMENT TABLE 1					
Code	Description	Factor	Net Size	Perimeter	Net Totals						
GBA1	MS	1.0	750.0	122.0		Apex 3/05/2012 Jane UPDATED BY CLOBERG 11/12/24 24-007323 MA ADDN UPDATED BY CLOBERG 12/30/24					
	FC	1.0	1152.0	144.0	1902.0						
GLA1	MA	1.0	2267.3	248.7	2267.3						
GLA2	MA2	1.0	1270.0	148.0	1270.0						
	MA2	1.0	955.5	165.0	955.5						
BSMT	BSMTU	1.0	1606.0	172.0	1606.0						
GAR	AGF	1.0	1143.7	137.7	1143.7						
MA	MC	1.0	3510.0	250.0							
	OFFICE	1.0	240.0	68.0	3750.0						
	Net LIVABLE	cnt	3 (rounded)		8,243			<table border="1" style="width: 100%; border-collapse: collapse;"> <thead> <tr> <th style="width: 50%;">COMMENT TABLE 2</th> <th style="width: 50%;">COMMENT TABLE 3</th> </tr> </thead> <tbody> <tr> <td>MLH 10/29/24</td> <td>TAGS L1</td> </tr> </tbody> </table>		COMMENT TABLE 2	COMMENT TABLE 3
COMMENT TABLE 2	COMMENT TABLE 3										
MLH 10/29/24	TAGS L1										
	Net BUILDING	cnt	2 (rounded)		1,902						

R38928  
071E 26C 00400

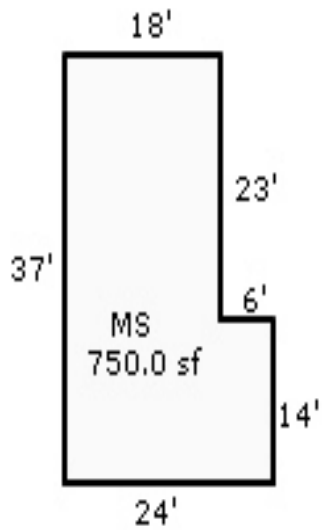
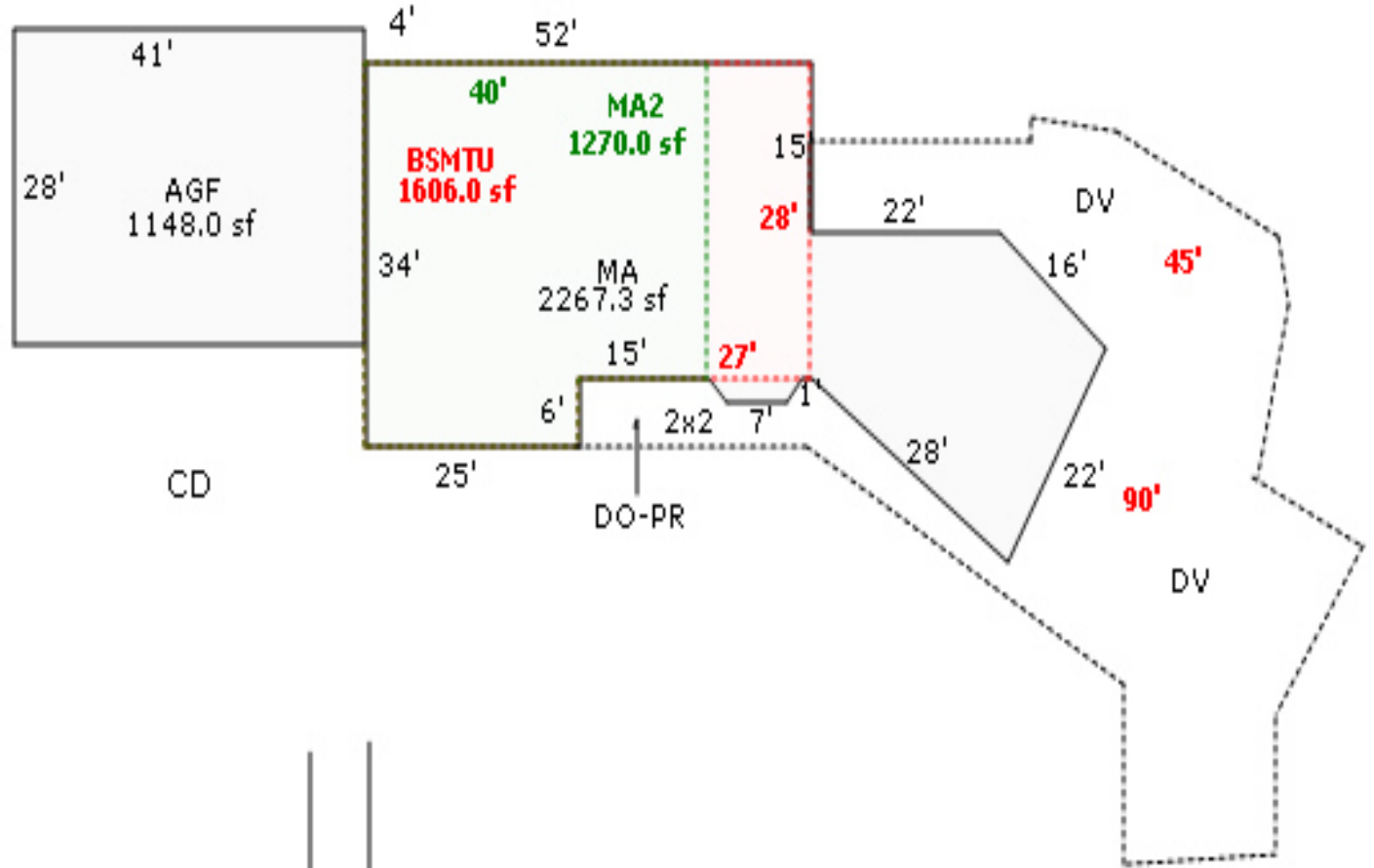
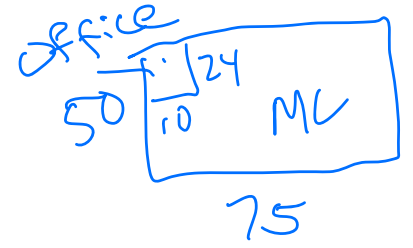

10/29/24 MLH TABS L1

Entry



