

Summary Lead Appr: \_\_\_\_\_ Clerk: \_\_\_\_\_ Lead Clerk: MBH 1/31/25 Appr: \_\_\_\_\_ Print Date: 12/11/2024

lak 1.22.25

MBH 1/31/25

ts 2-11-25

Acct ID: 124306 MTL: 051W04C002500P1 Date: 1/0/25 Appr: 02 Prop Class: 019 RMV Prop Class: 019

Situs: 16688 HIGHWAY 99E NE # 39 WOODBURN, OR 97071 MaSaNh: 12 05 000 Unit: 140029 Year: 2025

Last Date Appraised: 12/12/2022 Appraiser: THERESA SWEARINGEN Retag: Y N Tag info:

Owner: GARCIA JINES, ANAHI R

Roll Type: MS

Cycle Tag Sales Verification Other: \_\_\_\_\_ Inspection level: 1 2 4 LCB TTO INSP

AV: 8460

RMV Land: 0 RMV Imp: 39480 RMV Total: 39480 MAV: 8460 MSAV: 0

SAV: 0

Comment: 23-24: L2 12.12.22 TS

Notations

No notation data available.

OSDs

No OSD data available.

get exception on

Land

No land data available.

DW & EP & EPB - new

Improvements - Residence / Manufactured Structures

Bldg: 1 Code Area: 15609 Stat Class: 453 Year Blt: 1969 Eff Year Blt: 1995 Sq.Ft: 672 % Complete: 100

Desc: MANUF STRUCT, CLASS 5, 12' WIDE SINGLE

Dimensions: 56x12 RMV: 39480

Func Obsc: 100 Econ %: 100 Other %: 100 Exception: 0 Adjust: Adjust RMV: 0

Floors

Type	Class	Display Group	Floor Size	Beds	Baths	Yr Blt	Eff Yr Blt	Inventory	Exception: Y N
First Floor	5	Finished	672	2	FB-1	1969	1995	SKIRT, ROOF+, HVAC+, KIT-, BATH - 1	Y N

Accessories

Description	Class	Size SqFt	Eff Yr Blt	RMV	Quantity	Exception: Y N
ENCLOSED PORCH	3	160	1995	2112	0	Exception: Y N
ROOF EXTENSION OR PATIO COVER	5	324	1995	4134	0	Exception: Y N

Improvements - Accessory Buildings

No improvement data available for all other stat class types.

DW 96 / 2000 new  
EP 240 / 2000 new

# BUILDING DIAGRAM AND OUTBUILDINGS

ACCT NO: *M 124306*

MAP NO:

TAX LOT:

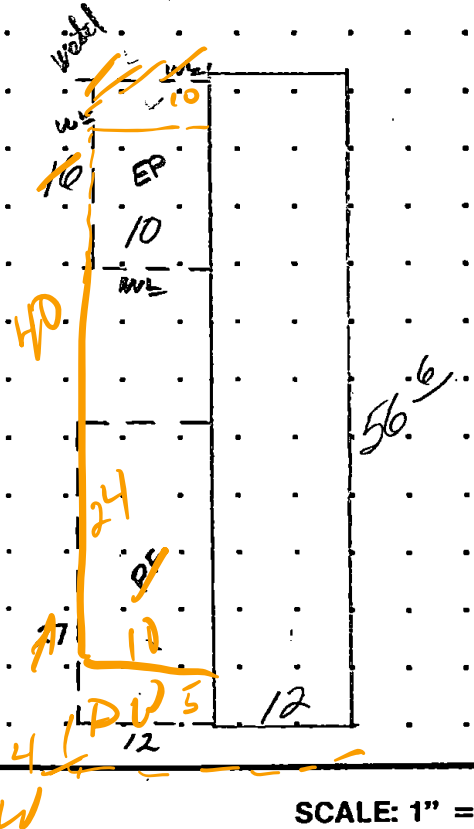

**CALCULATIONS:**

SCALE: 1" = 20'

*16688 Hwy 99E NE #39*

MEASUREMENT VERIFIED		YR BLT:	ADDRESS:	SALES	
DATE	BY			Date	Amt.
<i>3-25-96</i>	<i>WBP79</i>	<i>69</i>	<i>CHATEAU MOBILE VILLAGE</i>		
		REMARKS:	BUILDER:		
		<i>NV</i>	<i>OLYMPIAN</i>		
<i>7-9-13</i>	<i>DT4</i>	<i>NV - cycle</i>			

23-24  
SV

L 2

12-12-22  
#2

LCB

lak

RMUS ✓  
P.ct ✓

# Improvement Detail

MARION County

For Assessment Year 2023

Account ID 124306

Map 051W04C002500P1

Mailing GARCIA JINES, ANAHI R  
16688 HIGHWAY 99E NE #39  
WOODBURN OR 97071

Appraiser THERESA SWEARINGEN

Inspected 01/22/2020

Appraisal Area 02-05-000

Stat Class 453 - MANUF STRUCT, CLASS 5, 12' WIDE SINGLE

Situs 16688 HIGHWAY 99E NE #39 WOODBURN OR 97071

Bldg	Code Area	Year Built	Eff Year	Comp %	% Good	LCM	Value	RMV	Taxable RMV	MAV	Exception	AV	Sqft
1	15609	1969	1995	100	32	100	Tabled	14,160	14,160	7,760	0	7,760	672

Rooms: 2 - BD, 1 - FB

### Floor Segments

Description	Yr Blt	Eff Yr	% Good	Class	Comp %	OR %	Sqft	RCN
First Floor	1969	1995	32	5	100		672	27,596

### Improvement Inventory

F	Description	Qty/Size	RMV	F	Description	Qty/Size	RMV
1st	BATH - FULL	1	480	1st	ROOF COVER - METAL	672	430
1st	FORCED AIR	672	785	1st	SKIRTING - METAL	136	233
1st	WOOD PANELING	0	0				

### Accessories

Description	Eff Yr	Size	Qty	RMV
FIBERGLASS PATIO COVER	1995	324	1	1,866
ENCLOSED PORCH	1995	160	1	1,536

### Totals

Description	RMV
First Floor	\$10,758
Inventory	\$0
Accessories	\$3,402
Trend	100.00 %
<b>Total RMV</b>	<b>\$14,160</b>

### Size Breakdown

Size Breakdown	Sqft
Finished	672

Comments 22-23: Bringing MAV forward from 2009  
mwiltse 4-26-22

20-21:SV, PER #02, UPDATE INV, MA EYB 1969 TO 1995, I/O AJ// 18-19 SET TO CALC// 16-17 LUMP SUM Per 32 // 13-14 CYCLE WORK// 07-08  
RECALC SETUP; #28 6/2/06

M/C





12-12-22