

Acct ID: 320698 MTL: 092E15BB00404 Date: **10-11-24** Appr: **CLUKE** Prop Class: 409 RMV Prop Class: 409
 Situs: 11075 MOBLEY LN SE LYONS OR 97358 MaSaNh: 01 06 003 Unit: 83262 Year: 2024
 Last Date Appraised: 10/26/2023 Appraiser: CLINT LUKE Retag: **0** N Tag info: 2025 - NEW CONSTRUCTION (Garage/Carport)
 Owner: BUSCHE, CHRISTINE M Roll Type: R
 Cycle: **1** Sales Verification Other: _____ Inspection level: 1 2 **3** 4 LCB TTO INSP AV: 276070
 RMV Land: 298880 RMV Imp: 259860 RMV Total: 558740 MAV: 168270 MSAV: 0 SAV: 0
 Comment: 24-25 L2 10/26/23 CLUKE
 23-24 L2 1/13/23 CLUKE
 22-23: L3 1-6-22 CLUKE
 LEVEL 4 4.14.21 WV06//

Notations **24-004465 AG NOT STARTED YET**
 No notation data available.

OSDs

| Count | Code | Description | RMV | Code Area | Exception |
|-------|------|--------------------|-------|-----------|-----------|
| 1 | MKTN | OSD - NO LANDSCAPE | 30000 | 29540 | 0 |

Land

Site: 1 Code Area: 29540 Size: 2.06 Acres Use Code: 004 Zone: NREST SAV Use: Exception: 0
 Class: 4BDS Value Source: Rural at MKT Description: FOUR BENCH DRY SPECIAL SOUTH RMV: 268880 Exception: Y N
 Adjustment(s): H2OGR Fire Patrol: Description:
 Comments: 21-22: PER #06 DEL ALL IMPS, OSD// F99-262 SEG OFF 65866-653 & 65866-654, NEW ACCT FOR THE FP CODE R40949 12 . 99-2000: f99-178 SEPE off r320697 and r320698 from r40949 / 03-04: 02-789 SEPE FROM R320698 TO R331143 AND R320697 ,, REAPP

Improvements - Residence / Manufactured Structures

Bldg: 1 Code Area: 29540 Stat Class: 467 Year Blt: 2023 Eff Year Blt: 2023 Sq.Ft: 1886 % Complete: 100
 Desc: MANUF STRUCT, CLASS 6, 26' THROUGH 28' WIDE DOUBLE Dimensions: RMV: 221710
 Func Obsc: 100 Econ %: 100 Other %: 100 Exception: 107800 Adjust: Adjust RMV: 0

Floors

| Type | Class | Display Group | Floor Size | Beds | Baths | Yr Blt | Eff Yr Blt | Inventory | Exception |
|-------------|-------|---------------|------------|------|-------|--------|------------|----------------------------------|-----------|
| First Floor | 6 | Finished | 1886 | 3 | FB-2 | 2023 | 2023 | HVAC, KIT, ROOF, BATH - 2, SKRT+ | Y N |

Accessories

| Description | Class | Size SqFt | Eff Yr Blt | RMV | Quantity |
|-----------------------------|-------|-----------|------------|-----|----------|
| No accessory data available | | | | | |

Improvements - Accessory Buildings

Bldg: 2 Code Area: 29540 Stat Class: 351 Year Blt: 2021 Eff Year Blt: 2021 Sq.Ft: 1200 % Complete: 100
 Desc: General Purpose Building (GB) Dimensions: 40x30 RMV: 29810
 Func Obsc: 100 Econ %: 100 Other %: 100 Exception: 0 Adjust: Adjust RMV: 0

Floors

| Type | Class | Display Group | Floor Size | Beds | Baths | Yr Blt | Eff Yr Blt | Inventory | Exception |
|----------------------|-------|---------------|------------|------|-------|--------|------------|---------------|-----------|
| General Purpose Bldg | 5 | Finished | 1200 | 0 | FB-1 | 2021 | 2021 | BATH - 1, AVG | Y N |

Accessories

| Description | Class | Size SqFt | Eff Yr Blt | RMV | Quantity |
|-----------------------------|-------|-----------|------------|-----|----------|
| No accessory data available | | | | | |

Bldg: 3 Code Area: 29540 Stat Class: 355 Year Blt: 2021 Eff Year Blt: 2021 Sq.Ft: 360 % Complete: 100
 Desc: Lean-to Heavy (LTH) Dimensions: 30x12 RMV: 2330
 Func Obsc: 100 Econ %: 100 Other %: 100 Exception: 0 Adjust: Adjust RMV: 0

Floors

| Type | Class | Display Group | Floor Size | Beds | Baths | Yr Blt | Eff Yr Blt | Inventory | Exception |
|--------------------|-------|---------------|------------|------|-------|--------|------------|-----------|-----------|
| Lean-to Heavy Duty | 5 | Finished | 360 | 0 | 0 | 2021 | 2021 | | Y N |

Accessories

| Description | Class | Size SqFt | Eff Yr Blt | RMV | Quantity |
|-----------------------------|-------|-----------|------------|-----|----------|
| No accessory data available | | | | | |

Bldg: 4 Code Area: 29540 Stat Class: 341 Year Blt: 2023 Eff Year Blt: 2023 Sq.Ft: 192 % Complete: 100
 Desc: Multi Purpose Shed (MP) Dimensions: 16x12 RMV: 6010
 Func Obsc: 100 Econ %: 100 Other %: 100 Exception: 0 Adjust: Adjust RMV: 0

Floors

| Type | Class | Display Group | Floor Size | Beds | Baths | Yr Blt | Eff Yr Blt | Inventory | Exception: Y N |
|--------------------|-------|---------------|------------|------|-------|--------|------------|-----------|----------------|
| Multi-Purpose Bldg | 5 | Finished | 192 | 0 | 0 | 2023 | 2023 | AVG | |

Accessories

| Description | Class | Size SqFt | Eff Yr Blt | RMV | Quantity |
|-----------------------------|-------|-----------|------------|-----|----------|
| No accessory data available | | | | | |

SKETCH/AREA TABLE ADDENDUM

SUBJECT INFO

File No.: 320698 Parcel No.: 092E15BB00404
 Property Address: 11075 MOBLEY LN SE
 City: Salem County: Marion State: OR ZipCode: 97358
 Owner:
 Client: Client Address:
 Appraiser Name: Inspection Date:

SKETCH

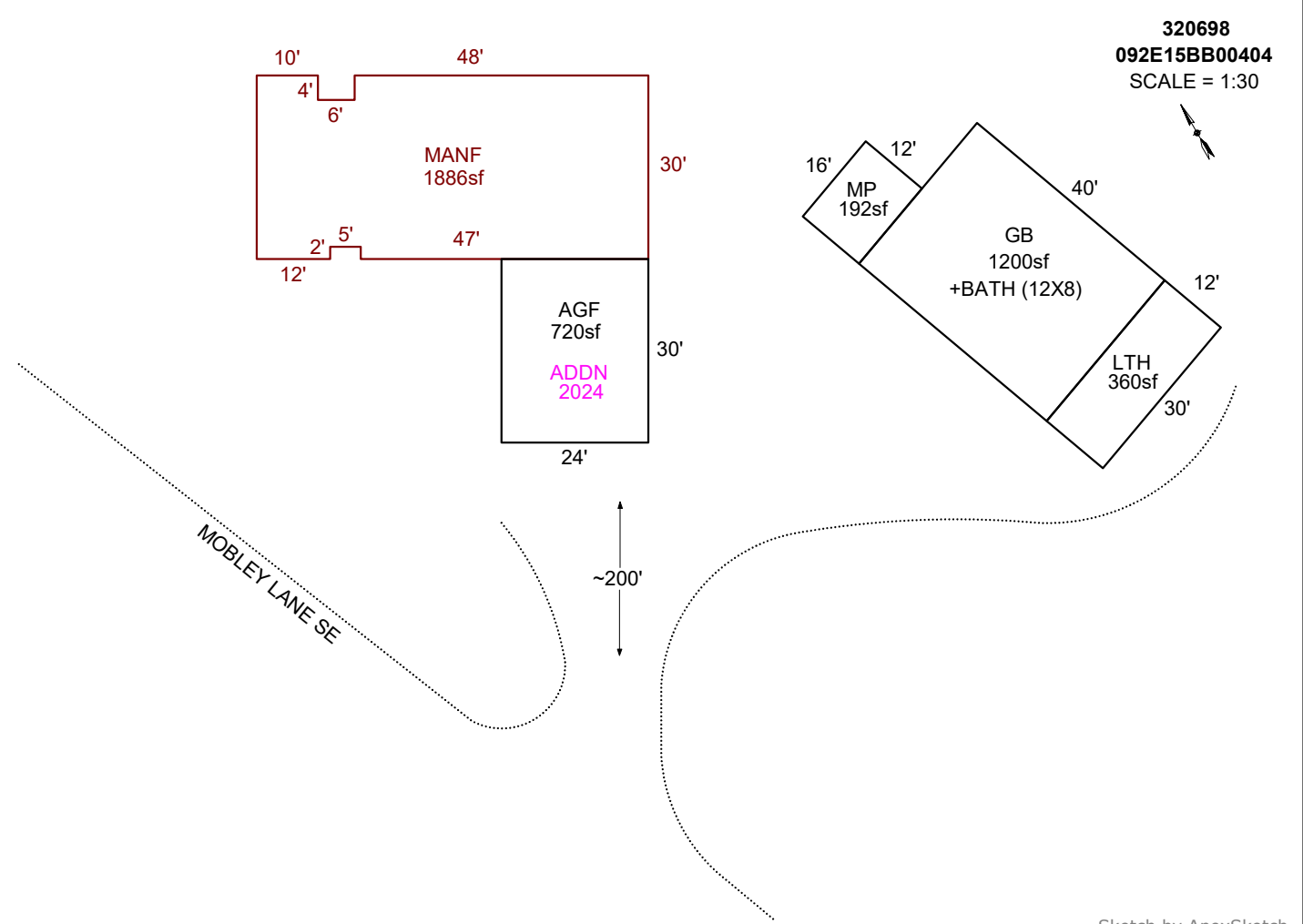

AREA CALCULATIONS SUMMARY

| Code | Description | Factor | Net Size | Perimeter | Net Totals |
|------|--------------|--------|-------------|-----------|------------|
| GBA1 | GB | 1.0 | 1200.0 | 140.0 | |
| | LTH | 1.0 | 360.0 | 84.0 | |
| | MP | 1.0 | 192.0 | 56.0 | 1752.0 |
| GLA | MANF | 1.0 | 1886.0 | 200.0 | 1886.0 |
| GAR | AGF | 1.0 | 720.0 | 108.0 | 720.0 |
| | Net LIVABLE | cnt | 1 (rounded) | | 1,886 |
| | Net BUILDING | cnt | 3 (rounded) | | 1,752 |

COMMENT TABLE 1

DRAWN BY JRONDEMA 5/11/15
 UPDATED BY JRONDEMA 3/29/19
 UPDATED BY CJURAN 06/29/2021
 UPDATED BY CJURAN 12/08/2021 555-21-009623
 UPDATED BY CJURAN 03/08/2022 555-22-000285
 UPDATED BY CJURAN 05/11/2022 555-22-000285 REV1
 UPDATED BY CJURAN 07/17/2023 555-22-000285 REV2
 UPDATED BY CJURAN 11/27/2023
 UPDATED BY CLOBERG 09/13/24 24-004465 ADDN AGF

COMMENT TABLE 2

#36 DB 9.21.17
 WV #06 04/14/2021 AOG
 CL 10/26/2023

*Owner 1-9-25
TAGS L3*

COMMENT TABLE 3

TAGS L2