

Acct ID: 556079 MTL: 083W18A000103 Date: 10.07.24 Appr: WW Prop Class: 401 RMV Prop Class: 401  
 Situs: 3091 MT KUEBLER DR S SALEM OR 97302 MaSaNh: 06 06 004 Unit: 97232 Year: 2024

Last Date Appraised: 12/04/2018 Appraiser: WENDY WILLIAMS Retag: Y N Tag info: 2025 - Tags/Permit (Alt Energy System)

Owner: HMURA, TRINA M & HMURA, MIKE S Roll Type: R

Cycle Tag Sales Verification Other: Inspection level: 1 2 3 4 LCB TTO INSP AV: 555210

RMV Land: 292800 RMV Imp: 943840 RMV Total: 1236640 MAV: 555210 MSAV: 0 SAV: 0

Comment:

ADD SO

Notations

No notation data available.

OSDs

Count	Code	Description	RMV	Code Area	Exception
1	MKTG	OSD - GOOD	55000	92430	0

Land

Site: 1 Code Area: 92430 Size: 2.00 Acres Use Code: 004 Zone: NREST SAV Use: Exception: 0  
 Class: Value Source: Rural at MKT Description: 4HD RMV: 237800 Exception: Y N  
 Adjustment(s): VWFR Fire Patrol: Description:  
 Comments: 01-02; REAPPRAISAL

Improvements - Residence / Manufactured Structures

Bldg: 1 Code Area: 92430 Stat Class: 154 + Year Blt: 1930 Eff Year Blt: 1996 Sq.Ft: 3813 % Complete: 100  
 Desc: Multi Story above grade with basement Dimensions: RMV: 882500  
 Func Obsc: 100 Econ %: 100 Other %: 100 Exception: 0 Adjust: Adjust RMV: 0

Floors

Type	Class	Display Group	Floor Size	Beds	Baths	Yr Blt	Eff Yr Blt	Inventory	Exception: Y N
First Floor	5 +	Finished	2583	4	FB-2/ HB-1	1930	1996	BATH - 2, BTH - 1, KIT, HVAC+, FP - 1, ROOF	Y N
Second Floor	5 +	Finished	992	0	0	2005	1996	HVAC+	Y N
Basement	5 +	Finished	238	0	0	1993	1993	HVAC+	Y N
Basement	5 +	Unfinished	528	0	0	1930	1993		Y N
Garage Attached	5	Finished	288	0	0	1930	1993	ROOF	Y N
Garage Basement	5 +	Finished	441	0	0	1930	1993		Y N

+ DUE TO FULLY SIDED/WINDOWS ETC

Accessories

Description	Class	Size SqFt	Eff Yr Blt	RMV	Quantity
-------------	-------	-----------	------------	-----	----------

No accessory data available

Bldg: 3 Code Area: 92430 Stat Class: 107 Year Blt: Eff Year Blt: 1996 Sq.Ft: 0 % Complete: 100  
 Desc: Yard Improvements Dimensions: RMV: 50150  
 Func Obsc: 100 Econ %: 100 Other %: 100 Exception: 0 Adjust: Adjust RMV: 0

Floors

Type	Class	Display Group	Floor Size	Beds	Baths	Yr Blt	Eff Yr Blt	Inventory	Exception: Y N
------	-------	---------------	------------	------	-------	--------	------------	-----------	----------------

No floor data available

Accessories

Description	Class	Size SqFt	Eff Yr Blt	RMV	Quantity
YARD IMPROVEMENTS GOOD	5	1	1996	41108	1

Exception: Y N

Improvements - Accessory Buildings

Bldg: 2 Code Area: 92430 Stat Class: 301 Year Blt: Eff Year Blt: Sq.Ft: 30 % Complete: 100  
 Desc: Accessory Improvements & Misc. Dimensions: 6x5 RMV: 0 ✓  
 Func Obsc: 100 Econ %: 100 Other %: 100 Exception: 0 Adjust: Adjust RMV: 0

Floors

Type	Class	Display Group	Floor Size	Beds	Baths	Yr Blt	Eff Yr Blt	Inventory	Exception: Y N
Pump House	0	Finished	30	0	0	0	0		Y N

Accessories

Description	Class	Size SqFt	Eff Yr Blt	RMV	Quantity
-------------	-------	-----------	------------	-----	----------

No accessory data available

Bldg: 4 Code Area: 92430 Stat Class: 341 Year Blt: 2007 Eff Year Blt: 2007 Sq.Ft: 115 % Complete: 100  
 Desc: Multi Purpose Shed (MP) Dimensions: RMV: 3930 ✓  
 Func Obsc: 100 Econ %: 100 Other %: 100 Exception: 0 Adjust: Adjust RMV: 0

**Floors**

Type	Class	Display Group	Floor Size	Beds	Baths	Yr Blt	Eff Yr Blt	Inventory	Exception: Y N
Multi-Purpose Bldg	6	Finished	115	0	0	2007	2007	FAIR	

**Accessories**

Description	Class	Size SqFt	Eff Yr Blt	RMV	Quantity
No accessory data available					

Bldg: 5 Code Area: 92430 Stat Class: 341 Year Blt: 2007 Eff Year Blt: 2007 Sq.Ft: 240 % Complete: 100  
 Desc: Multi Purpose Shed (MP) Dimensions: 12x20 RMV: 7260 ✓  
 Func Obsc: 100 Econ %: 100 Other %: 100 Exception: 0 Adjust: Adjust RMV: 0

**Floors**

Type	Class	Display Group	Floor Size	Beds	Baths	Yr Blt	Eff Yr Blt	Inventory	Exception: Y N
Multi-Purpose Bldg	6	Finished	240	0	0	2007	2007	FAIR	

**Accessories**

Description	Class	Size SqFt	Eff Yr Blt	RMV	Quantity
No accessory data available					

905 SO \$3000 2024 EXEMPT

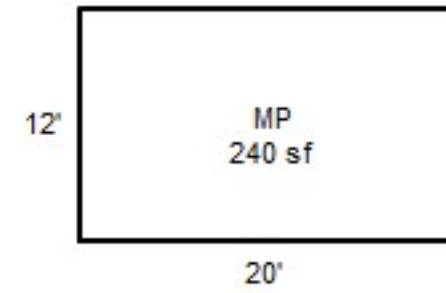
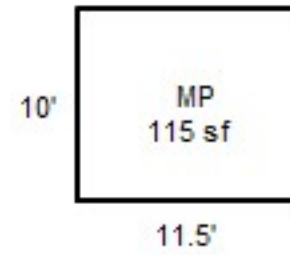
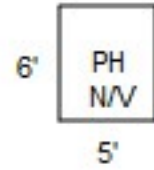

R56079  
083W18A 00103  
SCALE=1:20

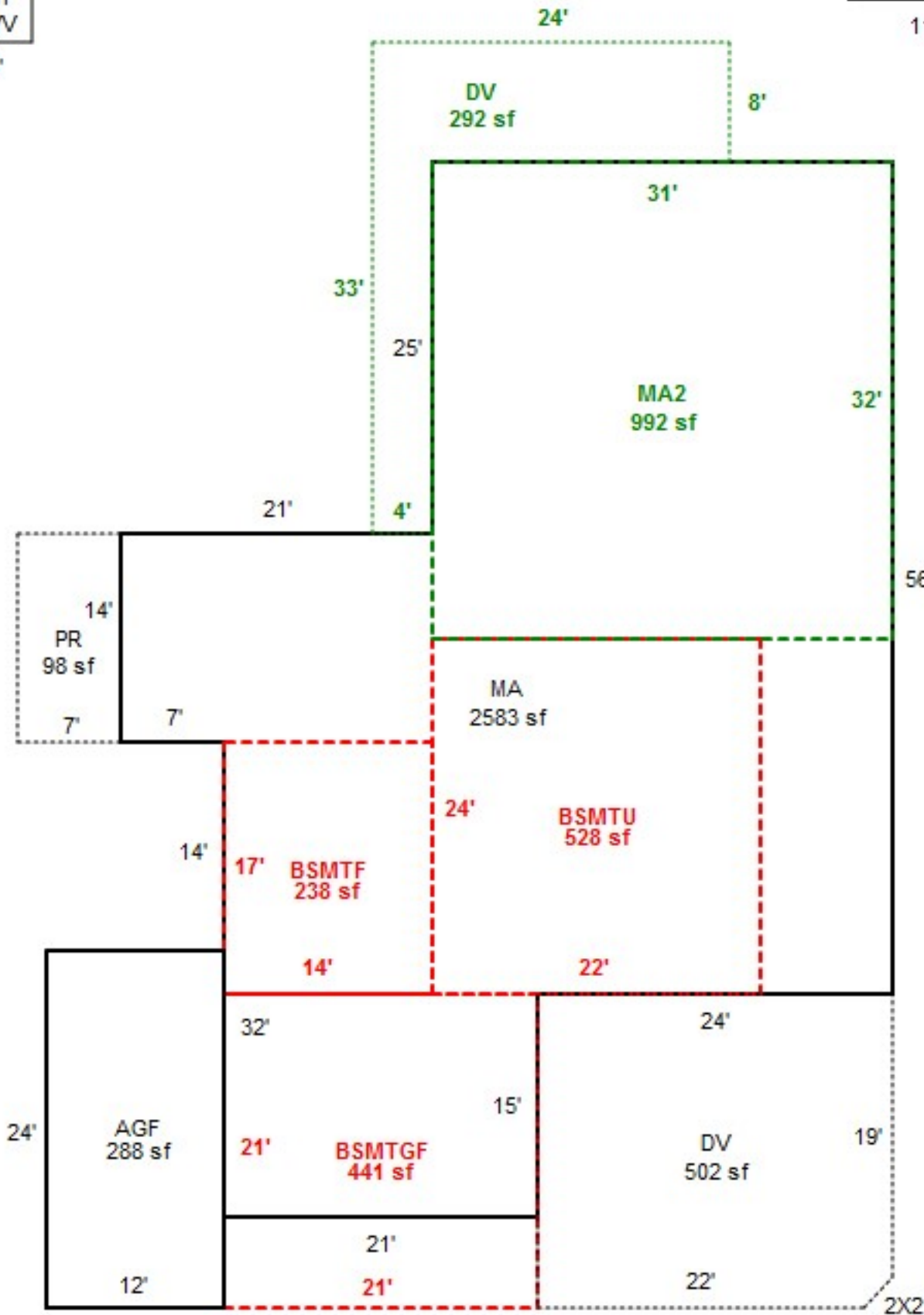

CD 536 sf

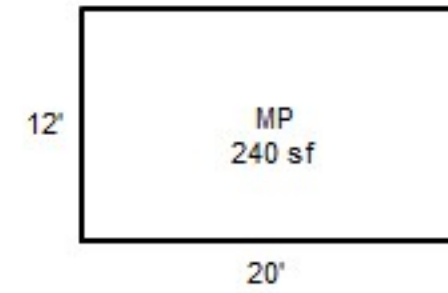
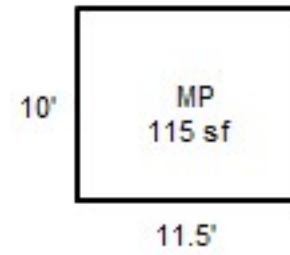
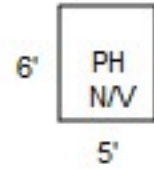

R56079  
083W18A 00103  
SCALE=1:20

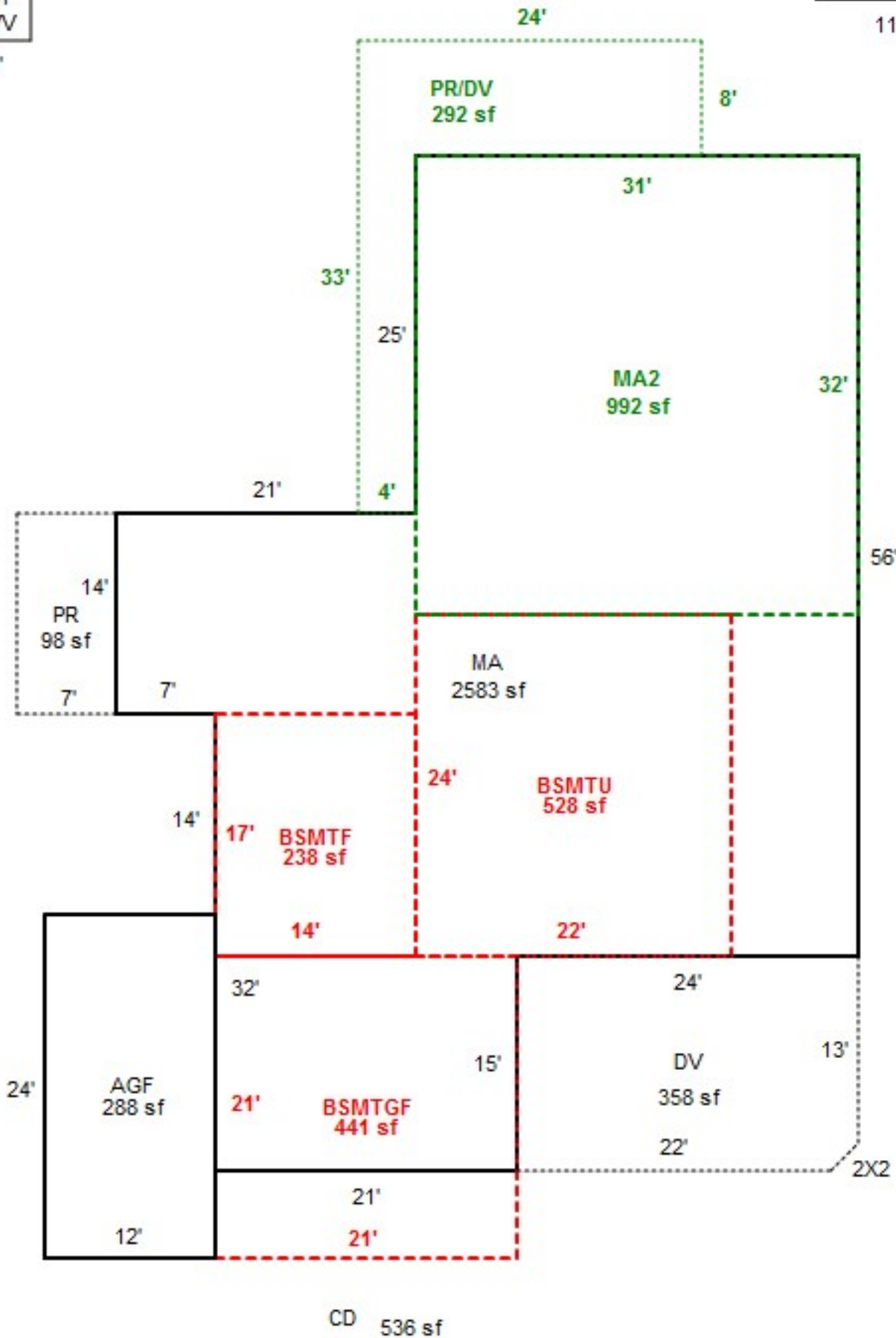

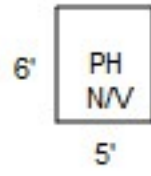

R56079  
 083W18A 00103  
 SCALE=1:20

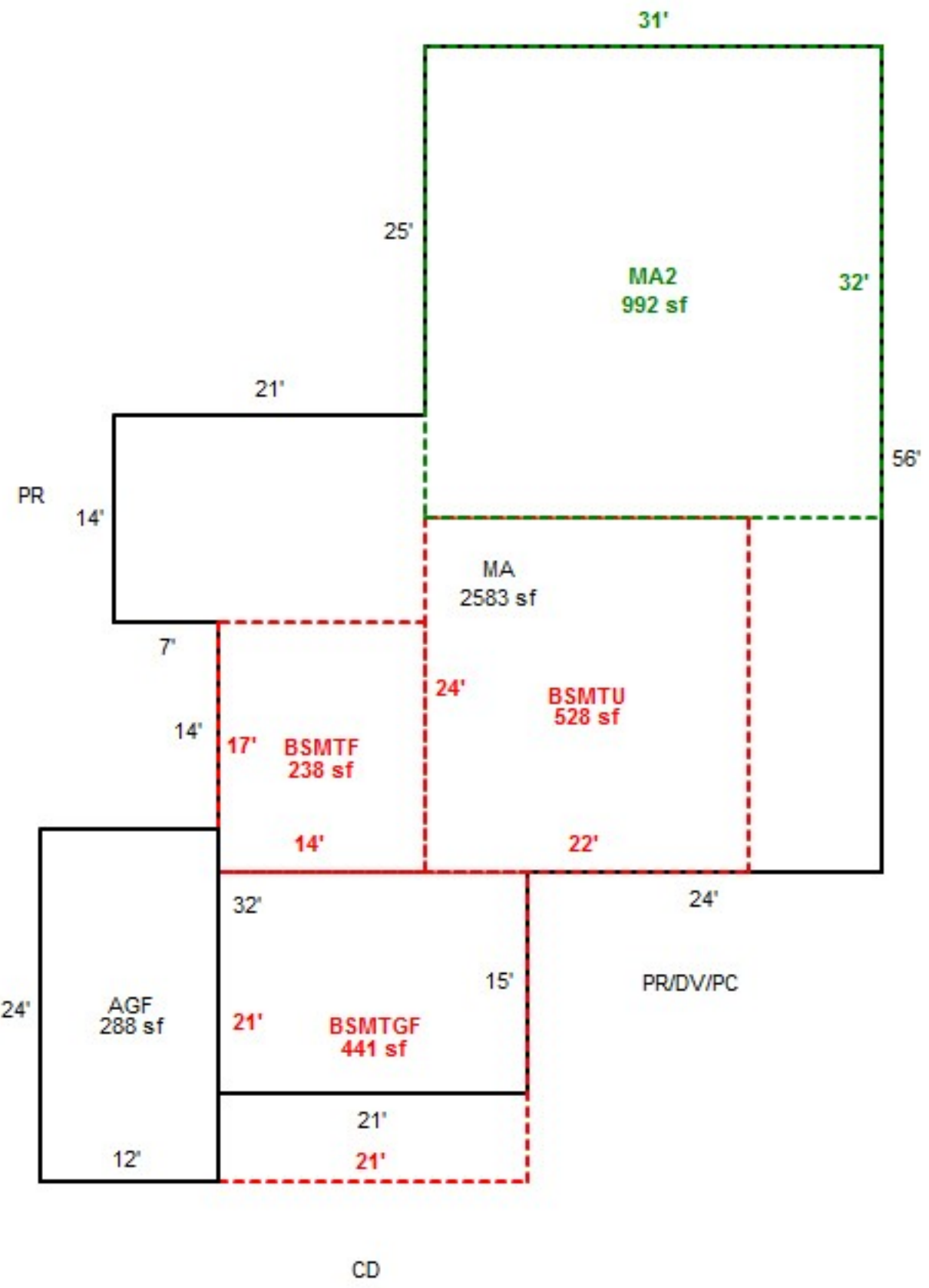

A two-story house with light grey horizontal siding and a dark grey roof. The house features a large gable window on the second floor, divided into four panes. Below the window is a two-car garage with light grey doors. A utility box is mounted on the wall to the left of the garage. A grey trash can is positioned in front of the left garage door, and a purple trash can is in front of the right garage door. A green bag is on the ground near the purple trash can. The house is set on a concrete driveway with a green lawn and trees in the background under a clear blue sky.

R56079 AGF BSMTGF 12.04.18



R56079 DV 12.04.18



R56079 MA DV 12.04.18





R56079 MA ENTRY 12.04.18



R56079 MA FRONT 12.04.18



R56079 MA N SIDE 12.04.18



R56079 MA REAR E SIDE 12.04.18

A photograph showing the rear of a house with a dark grey or black shingled roof and tan horizontal siding. A white-framed window is visible on the left side of the house. To the right, there is a dark door with a small window. The house is partially obscured by bare, brown branches in the foreground. In the background, there are green trees and a clear blue sky. A yellow text overlay is at the bottom of the image.

R56079 MA REAR 12.04.18



R56079 MP 10x11.5 12.04.18



R56079 MP 12x20 (2) 12.04.18



R56079 MP 12x20 12.04.18





R56079 MP 12.04.18

