

Acct ID: 510044 MTL: 031W32CA01004 Date: 10/7/24 Appr: JJS Prop Class: 401 RMV Prop Class: 401  
 Situs: 23765 3RD ST NE AURORA OR 97002 MaSaNh: 02 06 002 Unit: 40848 Year: 2024  
 Last Date Appraised: 12/12/2017 Appraiser: JORDAN SCHULTZ Retag: Y N Tag info: 2025 - Tags/Permit (Alt Energy System)  
 Owner: ALVORD FAM TR Roll Type: R  
 Cycle Tag Sales Verification Other: \_\_\_\_\_ Inspection level: 1 2 3 4 LCP TTO INSP AV: 618870  
 RMV Land: 352160 RMV Imp: 903660 RMV Total: 1255820 MAV: 618870 MSAV: 0 SAV: 0  
 Comment:

**Notations** CORRECT SF TO MATCH APEX

No notation data available.

**OSDs**

| Count | Code | Description | RMV   | Code Area | Exception |
|-------|------|-------------|-------|-----------|-----------|
| 1     | MKTG | OSD - GOOD  | 55000 | 15560     | 0         |

**Land**

Site: 1 Code Area: 15560 Size: 2.42 Acres Use Code: 004 Zone: NREST SAV Use: Exception: 0  
 Class: Value Source: Rural at MKT Description: RMV: 297160 Exception: Y N  
 Adjustment(s): VWAR 1.62 2BI 0.80 4BI Fire Patrol: Description:  
 Comments: 02-03: F02-297 SEPM FROM R10044 TO R330513 /03-04: F02-297 SEPE FROM R10044 TO R330513, CHANGE OF LAND VALUE FROM \$78,260 TO \$121,720 07-08: RECALC SETUP; #29 8/15/06 //08-09 SALES VERIF BY #29: ADD VIEWA.RUR

**Improvements - Residence / Manufactured Structures**

Bldg: 1 Code Area: 15560 Stat Class: 154 Year Blt: 1901 Eff Year Blt: 1993 Sq.Ft: 3988 % Complete: 100  
 Desc: Multi Story above grade with basement Dimensions: RMV: 882050  
 Func Obsc: 100 Econ %: 100 Other %: 100 Exception: 0 Adjust: Adjust RMV: 0

**Floors**

| Type            | Class | Display Group | Floor Size          | Beds | Baths | Yr Blt | Eff Yr Blt | Inventory                   | Exception: |
|-----------------|-------|---------------|---------------------|------|-------|--------|------------|-----------------------------|------------|
| First Floor     | 5     | Finished      | <u>1989</u><br>1996 | 1    | FB-2  | 1901   | 1993       | BATH - 2, KIT-, HVAC+, ROOF | Y N        |
| Attic           | 5     | Finished      | 924                 | 1    | 0     | 1901   | 1998       | HVAC+                       | Y N        |
| Basement        | 5     | Finished      | 1075                | 1    | 0     | 1901   | 1998       | HVAC+                       | Y N        |
| Basement        | 5     | Unfinished    | 456                 | 0    | 0     | 1901   | 1998       |                             | Y N        |
| Garage Attached | 5     | Finished      | 611                 | 0    | 0     | 1996   | 1998       | ROOF                        | Y N        |

**Accessories**

| Description            | Class | Size SqFt | Eff Yr Blt | RMV   | Quantity | Exception: |
|------------------------|-------|-----------|------------|-------|----------|------------|
| ASPHALT DRIVEWAY       | 5     | 3600      | 1998       | 9504  | 1        | Y N        |
| SWIMMING POOL          | 5     | 420       | 2017       | 17699 | 1        | Y N        |
| YARD IMPROVEMENTS GOOD | 5     | 1         | 1993       | 40163 | 1        | Y N        |

**Improvements - Accessory Buildings**

Bldg: 2 Code Area: 15560 Stat Class: 351 Year Blt: 2003 Eff Year Blt: 2003 Sq.Ft: 1728 % Complete: 100  
 Desc: General Purpose Building (GB) Dimensions: 36x48 RMV: 21610  
 Func Obsc: 100 Econ %: 100 Other %: 100 Exception: 0 Adjust: Adjust RMV: 0

**Floors**

| Type                 | Class | Display Group | Floor Size | Beds | Baths | Yr Blt | Eff Yr Blt | Inventory | Exception: |
|----------------------|-------|---------------|------------|------|-------|--------|------------|-----------|------------|
| General Purpose Bldg | 5     | Finished      | 1728       | 0    | 0     | 2003   | 2003       | FAIR      | Y N        |

**Accessories**

| Description | Class | Size SqFt | Eff Yr Blt | RMV | Quantity |
|-------------|-------|-----------|------------|-----|----------|
|-------------|-------|-----------|------------|-----|----------|

No accessory data available

905 Solar 14K New

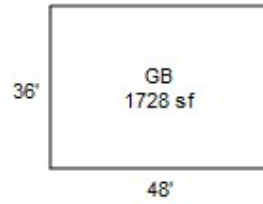

R10044  
031W32CA01004  
SCALE=1:60

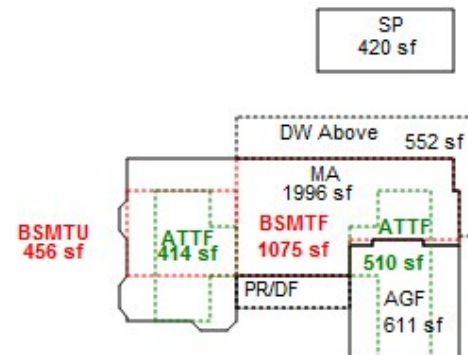

SEE PAGE 2 FOR DIMENSIONS

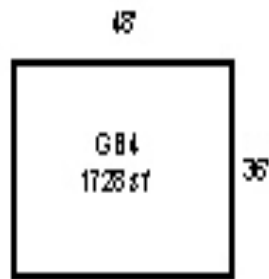

R10044  
MTL 031W32CA01004

SCALE: 1"=60'

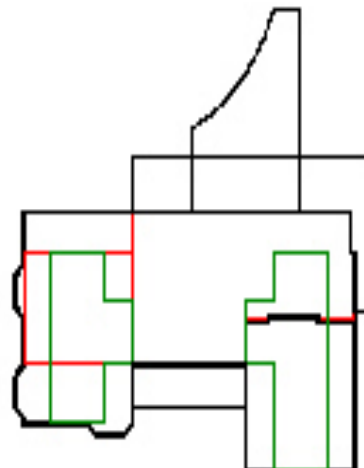

\*\* See Pg 2 for House Dimensions



