

Acct ID: 602227 MTL: 082W04D000602 Date: **10/9/24** Appr: **LUKE** Prop Class: 401 RMV Prop Class: 401  
 Situs: 6451 OAK DELL LN SE SALEM OR 97317 MaSaNh: 01 06 000 Unit: 135503 Year: 2024  
 Last Date Appraised: 01/11/2024 Appraiser: CLINT LUKE Retag: Y **(N)** Tag info: 2025 - Tags/Permit (Completion)  
 Owner: ANDERSON, JASON C Roll Type: R  
 Cycle: **(Tag)** Sales Verification Other: \_\_\_\_\_ Inspection level: 1 **(2)** 3 4 LCB TTO INSP AV: 309150  
 RMV Land: 256570 RMV Imp: 497960 RMV Total: 754530 MAV: 52450 MSAV: 0 SAV: 0  
 Comment: 24-25: L3 01.11.24 GRH

**INPUT 11/5/24 LUKE**

Notations **23-004864 NSFD FINISHED 8-6-24 PUN TAG**  
 No notation data available.

OSDs

Count	Code	Description	RMV	Code Area	Exception
1	MKTN	OSD - NO LANDSCAPE <b>NC</b>	30000	92410	14590

Land

Site: 1 Code Area: 92410 Size: 2.00 Acres Use Code: 004 Zone: NREST SAV Use: Exception: 0  
 Class: 4HD Value Source: Rural at MKT Description: FOUR HILL DRY RMV: 226570 Exception: Y N  
 Adjustment(s): **NC** Fire Patrol: Description:  
 Comments: 21-22: #06 CYCLE C19, NO CHG //16-17: CYCLE WORK #90 PER PICT NO CHG

Improvements - Residence / Manufactured Structures

Bldg: 1 Code Area: 92410 Stat Class: 153 - Year Blt: 2023 Eff Year Blt: 2023 Sq.Ft: 4256 % Complete: **100**  
 Desc: One Story with basement Dimensions: RMV: 497960  
 Func Obsc: 100 Econ %: 100 Other %: 100 Exception: 242110 Adjust: Adjust RMV: 0

Floors

**CHANGE CLASS PRIOR TO EXCEPTION**

Type	Class	Display Group	Floor Size	Beds	Baths	Yr Blt	Eff Yr Blt	Inventory	Exception:
First Floor	5	Finished	2645	2	FB-2/ HB-1	2023	2023	HVAC, ROOF, KIT-, BA, H, 2, BTH - 1 <b>AVG</b>	Y N
Basement	5	Finished	1611	1	FB-1	2023	2023	HVAC, BAT <b>AVG</b>	Y N
Garage Attached	5	Finished	1200	0	0	2023	2023	ROOF	Y N
Garage Basement	5	Finished	1118	0	0	2023	2023		Y N

Accessories

Description	Class	Size SqFt	Eff Yr Blt	RMV	Quantity
No accessory data available					

Improvements - Accessory Buildings

No improvement data available for all other stat class types.



MA 10/9/24



MA 10/9/24

**VISA**

# SKETCH/AREA TABLE ADDENDUM

## SUBJECT INFO

File No.: 602227 Parcel No.: 082W04D000602  
 Property Address: 6451 OAK DELL LANE  
 City: SALEM County: MARION State: OR ZipCode: 97317  
 Owner:  
 Client:  
 Appraiser Name: Client Address: Inspection Date:

## SKETCH

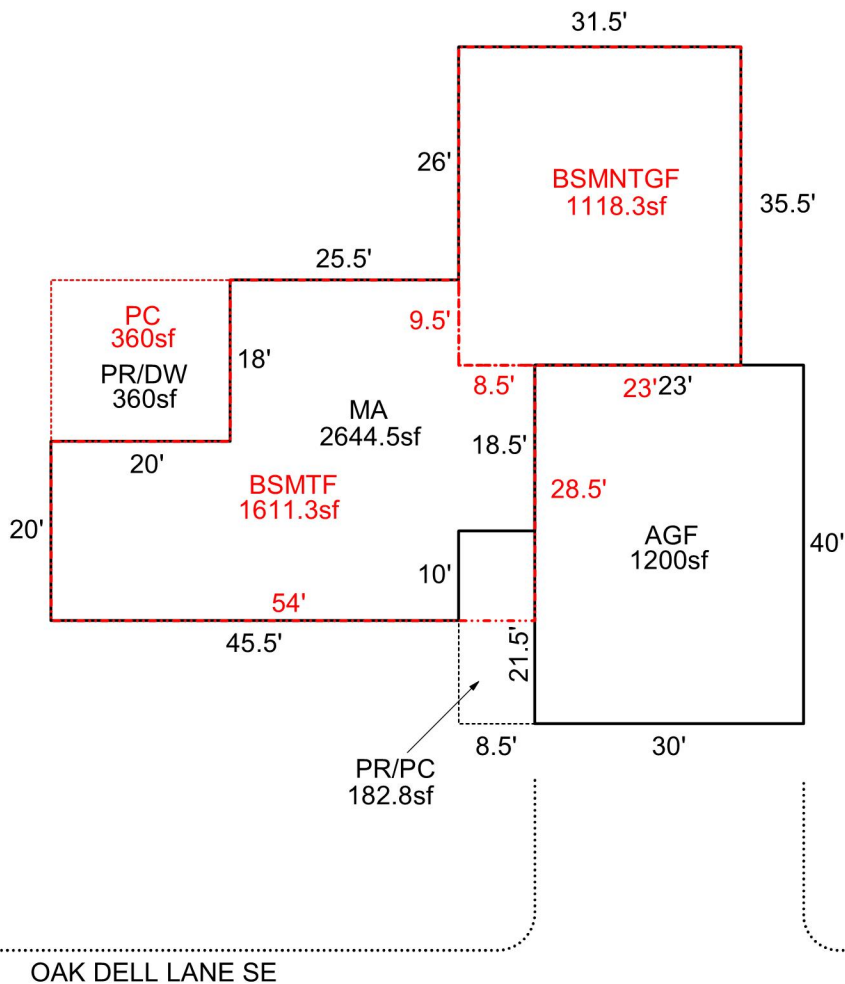

### AREA CALCULATIONS SUMMARY

Code	Description	Factor	Net Size	Perimeter	Net Totals
GLA1	MA	1.0	2644.5	282.0	2644.5
BSMT	BSMTF	1.0	1611.3	184.0	1611.3
GAR	AGF	1.0	1200.0	140.0	
	BSMNTGF	1.0	1118.3	134.0	2318.3
P/P	PR/PC	1.0	182.8	60.0	
	PR/DW	1.0	360.0	76.0	
	PC	1.0	360.0	76.0	902.8

### COMMENT TABLE 1

APEX BY CJURAN 08/15/2023 555-23-004864  
 UPDATED BY WWILLIAMS 2/27/24  
 UPD BY WW 4.25.24

### COMMENT TABLE 2

GRH 1.11.24

### COMMENT TABLE 3

TAGS L2

EVAL 10-9-24 TAGS L2

Net LIVABLE                      cnt                      1                      (rounded)                      2,645