

Summary Lead Appr: WW 12.4.24 Clerk: Lead Clerk: Appr: Print Date: 9/24/2024

Acct ID: 561940 MTL: 092E17AD01900 Date: 10-4-24 Appr: Luke Prop Class: 017 RMV Prop Class: 401
Situs: 23757 SANTIAM WAY SE LYONS OR 97358 MaSaNh: 01 06 007 Unit: 134583 Year: 2024
Last Date Appraised: 10/13/2021 Appraiser: CLINT LUKE Retag: Y N Tag info: 2025 - Tags/Permit (Addition)
Owner: WILLER, DENNIS W Roll Type: R ADD MP
Cycle: Tag Sales Verification Other: Inspection level: 1 2 3 LCB TTO INSP AV: 323970
RMV Land: 242110 RMV Imp: 708360 RMV Total: 950470 MAV: 165970 MSAV: 158000 SAV: 200890
Comment: 10-13-21 L2 CLUKE LEVEL 4 9.30.20 WV06//

INPUT 11/20/24 Luke

Notations 22-002433 DECK ADDED TO Y1 1/0
No notation data available.

OSDs

Count	Code	Description	RMV	Code Area	Exception
1	MKTA	OSD - AVERAGE	45000	29540	0

Land

Site: 1 Code Area: 29540 Size: 0.69 Acres Use Code: 004 Zone: NREST SAV Use: Exception: 0
Class: Value Source: Rural at MKT Description: 4BDSS RMV: 197110 Exception: Y N
Adjustment(s): H2OGR Fire Patrol: Description:
Comments: 21-22: PER #06 DEL ALL IMPS, OSD// 03-04: REAPPRAISAL

Improvements - Residence / Manufactured Structures

Bldg: 1 Code Area: 29540 Stat Class: 152 Year Blt: 2021 Eff Year Blt: 2021 Sq.Ft: 2801 % Complete: 100
Desc: Multi Story above grade Dimensions: RMV: 708360
Func Obsc: 100 Econ %: 100 Other %: 100 Exception: 0 Adjust: Adjust RMV: 0

Floors

Type	Class	Display Group	Floor Size	Beds	Baths	Yr Blt	Eff Yr Blt	Inventory	Exception
First Floor	5	Finished	2004	3	FB-2	2021	2021	BATH - 2, KIT+, BATH+, HVAC, ROOF	Y N
Attic	5	Finished	797	1	FB-1	2021	2021	BATH - 1, HVAC	Y N
Garage Attached	5	Finished	873	0	0	2021	2021	ROOF	Y N

Accessories

Description	Class	Size SqFt	Eff Yr Blt	RMV	Quantity	Exception
CONCRETE DRIVEWAY	5	741	2021	2384	0	Y N
DECK	5	877	2021	17365	0	Y N
PATIO	5	108	2021	588	0	Y N
ROOF EXTENSION OR PATIO COVER	5	54	2021	1550	0	Y N
ROOF EXTENSION OR PATIO COVER	5	273	2021	7838	0	Y N

Y15G

1/0

Bldg: 2 Code Area: 29540 Stat Class: RBH Year Blt: Eff Year Blt: Sq.Ft: 0 % Complete: 100
Desc: Rebuilt Homestead Residence Dimensions: RMV: 0
Func Obsc: 100 Econ %: 100 Other %: 100 Exception: 0 Adjust: Adjust RMV: 0

Floors

Type	Class	Display Group	Floor Size	Beds	Baths	Yr Blt	Eff Yr Blt	Inventory
No floor data available								

Accessories

Description	Class	Size SqFt	Eff Yr Blt	RMV	Quantity
No accessory data available					

Improvements - Accessory Buildings

No improvement data available for all other stat class types.

MP6 12x16 2024 NBW

SKETCH/AREA TABLE ADDENDUM

SUBJECT INFO

File No.: 561940 Parcel No.: 092E17AD01900
 Property Address: 23757 SANTIAM WAY SE
 City: Salem County: Marion State: OR ZipCode: 97358
 Owner:
 Client: Client Address:
 Appraiser Name: Inspection Date:

SKETCH

561940
092E17AD01900
SCALE = 1:20

16
4.1 X
MP
12
NW
N1
P1/DW

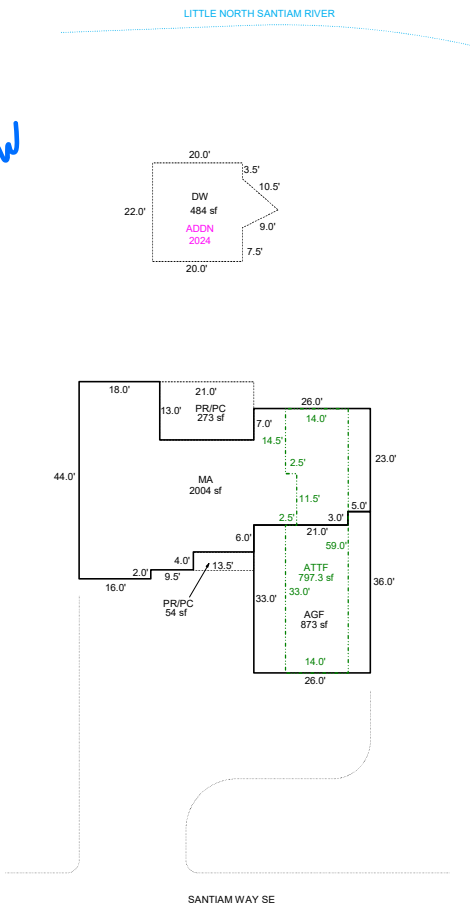

Sketch by ApexSketch

AREA CALCULATIONS SUMMARY

Code	Description	Factor	Net Size	Perimeter	Net Totals
GLA1	MA	1.0	2004.0	232.0	2004.0
GLA2	ATTF	1.0	797.3	151.0	797.3
GAR	AGF	1.0	873.0	124.0	873.0
P/P	PR/PC	1.0	273.0	68.0	
	PR/PC	1.0	54.0	35.0	
	DW	1.0	484.0	92.6	811.0

COMMENT TABLE 1

APEX BY CE 8/5/09
 UPDATED BY CJURAN 03/19/2021 555-20-009482
 UPDATED BY CLOBERG 08/23/24 22-002433 ADDN

COMMENT TABLE 2

Math error for MA2
 AOG - 2020 Wildfire

COMMENT TABLE 3

10.4.24 CL L4 TAG

Net LIVABLE cnt 2 (rounded) 2,801