

Summary Lead Appr: **WW 11.26.24** Clerk: _____ Lead Clerk: _____ Appr: _____ Print Date: 9/24/2024

Acct ID: 111295 MTL: 092E15AB00900 Date: **10-11-24** Appr: **CLINT** Prop Class: 409 RMV Prop Class: 409
Situs: 25778 TAYLOR PARK RD SE LYONS OR 97358 MaSaNh: 01 06 003 Unit: 108189 Year: 2024

INPUT 11-20-24 CLINT

Last Date Appraised: 11/03/2021 Appraiser: CLINT LUKE Retag: **Y N** Tag info: 2025 - NEW CONSTRUCTION (Outbuilding)

Owner: RONALD A PETSCH TR Roll Type: R

Cycle: **Tag** Sales Verification Other: _____ Inspection level: 1 **2** 3 4 LCB TTO INSP AV: 172430

RMV Land: 248080 RMV Imp: 201280 RMV Total: 449360 MAV: 172430 MSAV: 0 SAV: 0

Comment: 22-23 New MS 100%, CL#10, L2, 11-3-21// LEVEL 4 10.23.20 WV06//

Notations **24x003738 30x36**

No notation data available.

FINISHED 8/13/24

OSDs

Count	Code	Description	RMV	Code Area	Exception
1	MKTN	OSD - NO LANDSCAPE	30000	29540	0

Land

Site: 1 Code Area: 29540 Size: 1.79 Acres Use Code: 004 Zone: NREST SAV Use: Exception: 0
 Class: Value Source: Rural at MKT Description: RMV: 218080 Exception: Y N
 Adjustment(s): **CLASS 7 WASTE** Fire Patrol: SA004 Description: FIRE PATROL
 Comments: 21-22: PER #06 DEL ALL IMPS, OSD// 17-18: PER #36 CHG OSD / . 03-04 REAPPRAISAL.

Improvements - Residence / Manufactured Structures

Bldg: 7 Code Area: 29540 Stat Class: 467 Year Blt: 2018 Eff Year Blt: 2018 Sq.Ft: 1544 % Complete: 100
 Desc: MANUF STRUCT, CLASS 6, 26' THROUGH 28' WIDE DOUBLE Dimensions: RMV: 201280
 Func Obsc: 100 Econ %: 100 Other %: 100 Exception: 0 Adjust: Adjust RMV: 0

Floors

Type	Class	Display Group	Floor Size	Beds	Baths	Yr Blt	Eff Yr Blt	Inventory	Exception
First Floor	6	Finished	1544	2	FB-2	2018	2018	BATH - 2, BATH+, KIT, HVAC+, ROOF+, SKRT+	Y N

Accessories

Description	Class	Size SqFt	Eff Yr Blt	RMV	Quantity	Exception
DECK	6	185	2021	3989	0	Y N
ROOF EXTENSION OR PATIO COVER	6	185	2021	5258	0	Y N

Improvements - Accessory Buildings

No improvement data available for all other stat class types.

Brown



**GB 5
30x36 AVE
2025 NEW**

2024

GB 10/11/24

SKETCH/AREA TABLE ADDENDUM

SUBJECT INFO

File No.: 111295 Parcel No.: 092E15AB00900
 Property Address: 25778 TAYLOR PARK RD SE
 City: Aumsville County: Marion State: OR ZipCode: 97358
 Owner:
 Client: Client Address:
 Appraiser Name: Inspection Date:

SKETCH

111295
092E15AB00900
SCALE=1:30

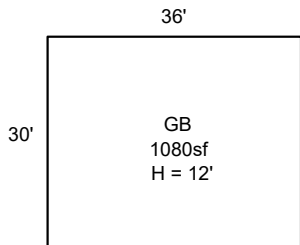
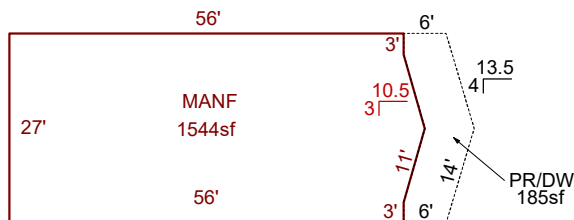

DRIVEWAY

TAYLOR PARK RD

Sketch by ApexSketch

AREA CALCULATIONS SUMMARY

Code	Description	Factor	Net Size	Perimeter	Net Totals
GBA1	GB	1.0	1080.0	132.0	1080.0
GLA	MANF	1.0	1543.5	166.8	1543.5
P/P	PR/DW	1.0	184.5	68.0	184.5

COMMENT TABLE 1

DRAWN BY JRONDEMA 8/20/18
 UPDATED BY CJURAN 01/14/2021
 UPDATED BY CJURAN 04/23/2021 555-21-001038
 UPDATED BY CLOBERG 07/15/24 24-003738 GB

COMMENT TABLE 2

WV #06 10/23/2020 AOG

COMMENT TABLE 3

Net LIVABLE	cnt	1	(rounded)		1,544
Net BUILDING	cnt	1	(rounded)		1,080