

Acct ID: 101405 MTL: 061E23C000700 Date: **11/7/24** Appr: **MLH** Prop Class: 559 RMV Prop Class: 459
 Situs: 7474 CROOKED FINGER RD NE SCOTTS MILLS OR 97375 MaSaNh: 03 06 000 Unit: 59225 Year: **2024**
 Last Date Appraised: 12/05/2023 Appraiser: MATTHEW HAMILTON Retag: **(Y) N** Tag info: 2025 - Tags/Permit (Completion)
 Owner: ISAKSEN, ANDREW & ISAKSEN, MICHELLE R Roll Type: R
 Cycle **(Tag)** Sales Verification Other: _____ Inspection level: **(1) 2 3 4** LCB **(TTC)** INSP AV: 174971
 RMV Land: 397570 RMV Imp: 191100 RMV Total: 588670 MAV: 114490 MSAV: 31441 SAV: 60306
 Comment: 24-25: L3 12.05.23 CLUKE
 23-24: L3 10.19.22 CL

*NEW GB @ 80%
 update inventory Retag for '26 Farm livestock*

Notations

RP/MS	Code	Description
MS	ZONED	FARM EFU ZONED
MS	ZONED	FARM EFU ZONED

Input MLH 11/27/24

Chris 12/19/24

OSDs

Count	Code	Description	RMV	Code Area	Exception
1	SAA	SA OSD - AVERAGE	45000	04500	0

Land

Site: 1	Code Area: 04500	Size: 5.16 Acres	Use Code: 005	Zone: REST	SAV Use: 011	Exception: 0
Class: 4HD	Value Source: Farm Use - EFU	Description: FOUR HILL DRY	RMV: 246970	Exception: Y	N	
Adjustment(s): FSOIL	Fire Patrol:	Description:				
Comments: Liability year - 2012 / 06-07: RECALC SETUP;#36 7-20-05 //PASTURE/WASTELAND						
Site: 3	Code Area: 04500	Size: 1.00 Acres	Use Code: 005	Zone: REST	SAV Use: 011	Exception: 0
Class: 4HD	Value Source: Farm Homesite	Description: FOUR HILL DRY	RMV: 47860	Exception: Y	N	
Adjustment(s): FSOIL	Fire Patrol:	Description:				
Comments: Liability year - 2012 / 06-07: RECALC SETUP;#36 7-20-05 //PASTURE/WASTELAND						
Site: 4	Code Area: 04500	Size: 1.27 Acres	Use Code: 005	Zone: REST	SAV Use: 011	Exception: 0
Class: 6H	Value Source: Farm Use - EFU	Description: SIX HILL	RMV: 57740	Exception: Y	N	
Adjustment(s): FSOIL	Fire Patrol:	Description:				
Comments: Liability year - 2012 / 06-07: RECALC SETUP;#36 7-20-05 //PASTURE/WASTELAND						

Improvements - Residence / Manufactured Structures

Bldg: 1	Code Area: 04500	Stat Class: 478	Year Blt: 1997	Eff Year Blt: 2001	Sq.Ft: 2518	% Complete: 100
Desc: MANUF STRUCT, CLASS 7, 36' WIDE TRIPLE/QUAD	<i>EJB Roof/Paint</i>		Dimensions: 70x27	RMV: 132140		
Func Obsc: 100	Econ %: 100	Other %: 100	Exception: 0	Adjust:	Adjust RMV: 0	<i>I/O</i>

Floors

Type	Class	Display Group	Floor Size	Beds	Baths	Yr Blt	Eff Yr Blt	Inventory	Exception
First Floor	7	Finished	2518	4	FB-3	1997	2001	BATH - 2, BTH - 1, KIT-, HVAC+, ROOF, SKIRT	Y N

Accessories

Description	Class	Size SqFt	Eff Yr Blt	RMV	Quantity
No accessory data available					

Bldg: 5	Code Area: 04500	Stat Class: 107	Year Blt:	Eff Year Blt: 2001	Sq.Ft: 0	% Complete: 100
Desc: Yard Improvements			Dimensions:	RMV: 50150		
Func Obsc: 100	Econ %: 100	Other %: 100	Exception: 0	Adjust:	Adjust RMV: 0	<i>I/O</i>

Floors

Type	Class	Display Group	Floor Size	Beds	Baths	Yr Blt	Eff Yr Blt	Inventory	Exception
No floor data available									

Accessories

Description	Class	Size SqFt	Eff Yr Blt	RMV	Quantity
YARD IMPROVEMENTS GOOD	5	1	1997	41108	1
Exception: Y N					

Improvements - Accessory Buildings

Bldg: 1	Code Area: 04500	Stat Class: 351	Year Blt: 1984	Eff Year Blt: 1984	Sq.Ft: 840	% Complete: 100
Desc: General Purpose Building (GB)			Dimensions: 30x28	RMV: 2510		
Func Obsc: 100	Econ %: 100	Other %: 100	Exception: 0	Adjust:	Adjust RMV: 0	<i>I/O</i>

Floors

Type	Class	Display Group	Floor Size	Beds	Baths	Yr Blt	Eff Yr Blt	Inventory	
General Purpose Bldg	4	Finished	840	0	0	1984	1984	Fair	Exception: Y N

Accessories

Description	Class	Size SqFt	Eff Yr Blt	RMV	Quantity
No accessory data available					

Bldg: 2 Code Area: 04500 Stat Class: 341 Year Blt: 1997 Eff Year Blt: 1997 Sq.Ft: 200 % Complete: 100
 Desc: Multi Purpose Shed (MP) Dimensions: 20x10 RMV: 1880
 Func Obsc: 100 Econ %: 100 Other %: 100 Exception: 0 Adjust: Adjust RMV: 0

I/O

Floors

Type	Class	Display Group	Floor Size	Beds	Baths	Yr Blt	Eff Yr Blt	Inventory	
Multi-Purpose Bldg	4	Finished	200	0	0	1997	1997	Fair	Exception: Y N

Accessories

Description	Class	Size SqFt	Eff Yr Blt	RMV	Quantity
No accessory data available					

Bldg: 4 Code Area: 04500 Stat Class: 341 Year Blt: 1999 Eff Year Blt: 1999 Sq.Ft: 182 % Complete: 100
 Desc: Multi Purpose Shed (MP) Dimensions: 13x14 RMV: 4420
 Func Obsc: 100 Econ %: 100 Other %: 100 Exception: 0 Adjust: Adjust RMV: 0

N/C

Floors

Type	Class	Display Group	Floor Size	Beds	Baths	Yr Blt	Eff Yr Blt	Inventory	
Multi-Purpose Bldg	6	Finished	182	0	0	1999	1999	FAIR	Exception: Y N

Accessories

Description	Class	Size SqFt	Eff Yr Blt	RMV	Quantity
No accessory data available					

60
 GB 351 5 36x20 2024 Aoe pkg 80% N/M
 108 AC 16x24 R4B 2001 I/O



SKETCH/AREA TABLE ADDENDUM

SUBJECT INFO

File No.: 101405 Parcel No.: 061E23C 00700
 Property Address: 7474 Crooked Finger Rd NE
 City: Scotts Mills County: State: OR ZipCode: 97381
 Owner:
 Client: Client Address:
 Appraiser Name: Inspection Date:

SKETCH

101405
061E23C 00700

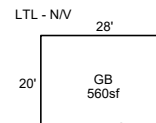
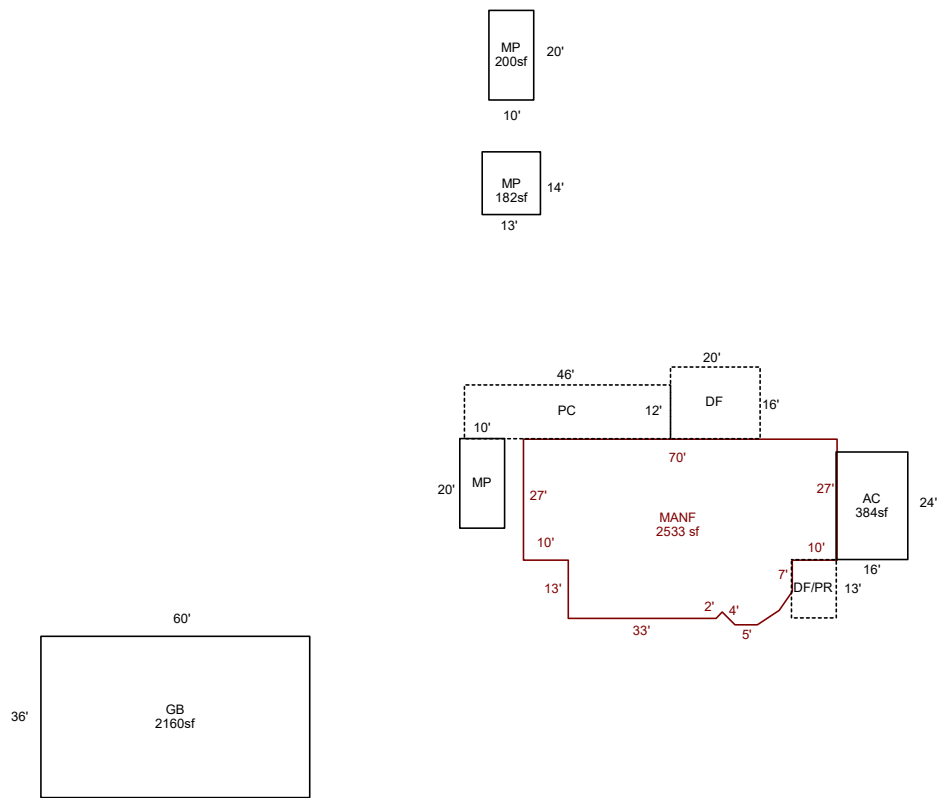

Sketch by ApexSketch

AREA CALCULATIONS SUMMARY						COMMENT TABLE 1	
Code	Description	Factor	Net Size	Perimeter	Net Totals		
GBA1	MP	1.0	200.0	60.0		Apex 10/17/2012 Jane UPDATED BY CLOBERG 11/14/24	
	MP	1.0	182.0	54.0			
	GB	1.0	560.0	96.0			
	MP	1.0	200.0	60.0			
	AC	1.0	384.0	80.0			
	GB	1.0	2160.0	192.0	3686.0		
GLA1 P/P	MANF	1.0	2533.8	218.9	2533.8		
	DF	1.0	320.0	72.0			
	DF/PR	1.0	130.0	46.0			
	PC	1.0	552.0	116.0	1002.0	COMMENT TABLE 2	COMMENT TABLE 3
						MLH 11/07/24	TAGS L1
	Net LIVABLE	cnt	0 (rounded)		2,534		
	Net BUILDING	cnt	6 (rounded)		3,686		

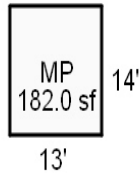
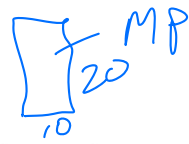

R101405
061E23C 00700
N

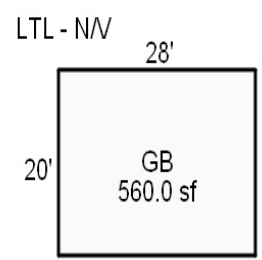
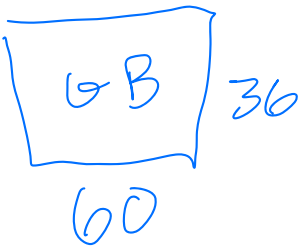
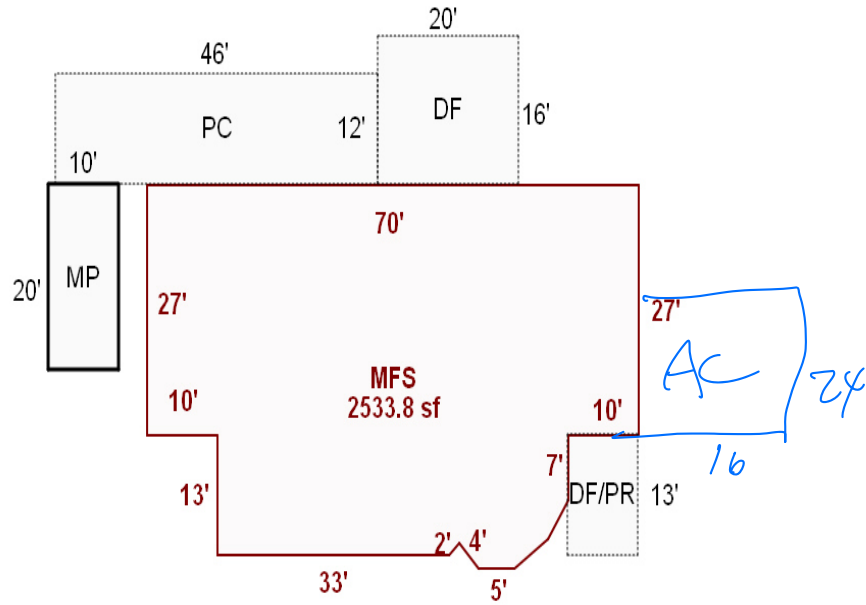

11/7/24 MLH TAGS (1)

Percent Complete Form

Account # _____

Additions

New Homes

<u>Additions</u>		<u>New Homes</u>				
% Item	% Sum	No Basement		Basement		
		% Item	% Sum	% Item	% Sum	
3%	0%	Plans/Survey	3%	0%	3%	
2%		Excavation	2%		4%	
3%		Foundation	3%		10%	
35%	45%	Framing	14%	20%	16%	35%
8%	50%	Trusses	7%	30%	7%	40%
7%	60%	Roofing	7%	35%	7%	45%
7%	65%	Windows/Ext Doors	7%	45%	6%	55%
5%	70%	Siding	5%	50%	5%	60%
4%	75%	Plumbing Rough-In	4%		3%	
3%		Electrical Rough-In	3%	55%	2%	
2%	80%	Heating Rough-In	2%		1%	
		Heating Unit	1%	60%	1%	
3%	Insulation	3%	2%			
5%	85%	Drywall (Finished)	5%	65%	4%	70%
2%	90%	Paint Interior	2%	70%	2%	75%
2%		Paint Exterior	2%		2%	
	95%	Cabinets	6%	75%	5%	80%
2%		Electrical Fixtures	3%	80%	2%	
2%	Plumbing Fixtures	4%	85%	3%	85%	
3%	100%	Floor Coverings & Countertops	7%	90%	6%	90%
2%		Interior Trim Carpentry	7%	95%	6%	95%
		Porch/Entry/Stoop	2%	100%	2%	100%
	Finish Grade	1%	1%			

APPR _____ Date _____ YR For _____ % COMP _____
 APPR _____ Date _____ YR For _____ % COMP _____
 APPR _____ Date _____ YR For _____ % COMP _____
 APPR _____ Date _____ YR For _____ % COMP _____

Percent Complete Form

Account # _____

Gut & Remodels

Interior Trim Carpentry	7%	90%
Floor Coverings & Countertops	7%	85%
Plumbing Fixtures	4%	80%
Electrical Fixtures	3%	80%
Cabinets	6%	75%
Drywall (Finished)	5%	70%
Insulation	3%	65%

APPR _____ Date _____ YR For _____ % COMP _____
 APPR _____ Date _____ YR For _____ % COMP _____
 APPR _____ Date _____ YR For _____ % COMP _____
 APPR _____ Date _____ YR For _____ % COMP _____

Outbuilding Type: _____

	% Item	% Sum
Excavation/Foundation	10%	40%
Floor - Concrete/Wood	30%	
Walls - Framing	10%	65%
Walls - Covering/Siding	15%	
Roof - Framing/Trusses	15%	95%
Roof - Sheathing	5%	
Roof - Cover	10%	
Doors & Windows	5%	100%

APPR M L H Date 11/7 YR For 25-26 % COMP 80
 APPR _____ Date _____ YR For _____ % COMP _____
 APPR _____ Date _____ YR For _____ % COMP _____
 APPR _____ Date _____ YR For _____ % COMP _____



2021.11.17

