

Summary

Lead Appr: \_\_\_\_\_ Clerk: \_\_\_\_\_ Lead Clerk: \_\_\_\_\_ Appr: \_\_\_\_\_

corr 12.9.24 lak 11.20.24 MBH 12/11/24

Print Date:

9/27/2024

Acct ID: 128274 MTL: 041W14B000101P1 Date: 10/3/24 Appr: 02 Prop Class: 019 RMV Prop Class: 019

12-12-224 ts

Situs: 21356 HUBBARD CUTOFF NE # 34 AURORA, OR 97002 MaSaNb: 12 05 000 Unit: 128274 Year: 2024

75.26

Last Date Appraised: 07/12/2024 Appraiser: THERESA SWEARINGEN Retag: Y  N  Tag info: 2025 - Tags/Permit (Miscellaneous)

Owner: RAMIREZ MATIAS, JUAN JESUS

Tag to check 5 year values

Cycle: Tag Sales Verification Other: \_\_\_\_\_ Inspection level: 1 2 3 4 LCB TTO INSP AV: 20310

RMV Land: 0 RMV Imp: 104800 RMV Total: 104800 MAV: 20310 MSAV: 0 SAV: 0

Comment: 24-25: Tag; L2; 07.12.24 TS

added to 3rd tag run for 25-26MBH

24-25: Cycle; L3 08.21.23 TS

Notations

No notation data available.

update EYB - new

OSDs

No OSD data available.

Land

No land data available.

Improvements - Residence / Manufactured Structures

No residence or manufactured structure improvement data available.

Improvements - Accessory Buildings

No improvement data available for all other stat class types.

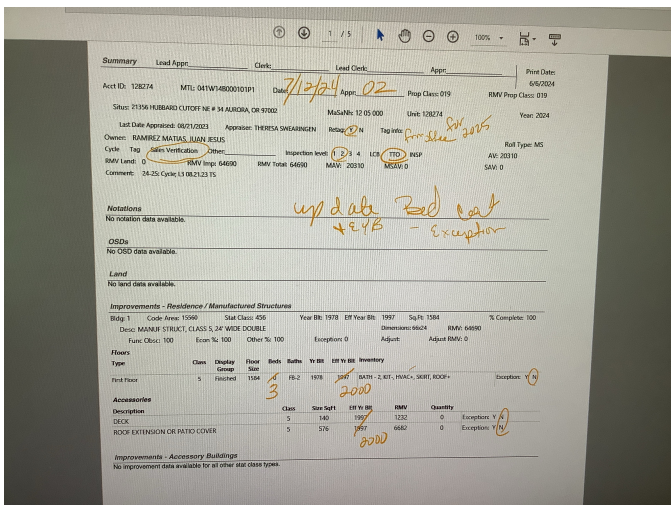

Tag

# Improvement Detail

MARION County

For Assessment Year 2024

Account ID 128274

Map 041W14B000101P1

Appraiser THERESA SWEARINGEN

Inspected 07/12/2024

Mailing RAMIREZ MATIAS, JUAN JESUS  
SANTIAGO MANUEL, EMMA  
21356 HUBBARD CUTOFF RD NE # 34  
AURORA OR 97002

Appraisal Area 12-05-000

Stat Class 456 - MANUF STRUCT, CLASS 5, 24' WIDE DOUBLE

Situs 21356 HUBBARD CUTOFF NE # 34 AURORA OR 97002

Bldg	Code Area	Year Built	Eff Year	Comp %	% Good	LCM	Value	RMV	Taxable RMV	MAV	Exception	AV	Sqft
1	15560	1978	1997	100	40	231	Tabled	104,800	104,800	20,310	0	20,310	1,584

Rooms: 2 - FB

3 Beds 2000

Description	Floor Segments					Sqft	RCN
	Yr Blt	Eff Yr	% Good	Class	Comp %		
First Floor	1978	1997	40	5	100	1,584	125,013

### Improvement Inventory

F	Description	Qty/Size	RMV	F	Description	Qty/Size	RMV
1st	ABOVE CLASS HEATING/COOLING	1,584	878	1st	AVERAGE CLASS SKIRTING	0	1,830
1st	ABOVE CLASS ROOF	1,584	0	1st	BATH - FULL	2	2,772
1st	BELOW CLASS KITCHEN	1	1,294				

### Accessories

Description	Eff Yr	Size	Qty	RMV
ROOF EXTENSION OR PATIO COVER	1997	576		6,682
DECK	1997	140		1,232

### Totals

Description	RMV
First Floor	\$56,779
Inventory	\$0
Accessories	\$7,914
Calculation	Tabled
Trend	162.00 %
<b>Total RMV</b>	<b>\$104,800</b>

### Size Breakdown

Finished 1,584

Comments 24-25: Tag & SV; No change, TS

13-14 CYCLE WORK// 07-08 RECALC SETUP; #28 (10-2-06)

# SKETCH/AREA TABLE ADDENDUM

## SUBJECT INFO

File No.: 128274 Parcel No.: 041W14B000101  
 Property Address: 21356 HUBBARD CUTOFF NE #34  
 City: AURORA County: State: OR ZipCode: 97002  
 Owner:  
 Client: Client Address:  
 Appraiser Name: Inspection Date:

## SKETCH

**128274**  
**041W14B000101**

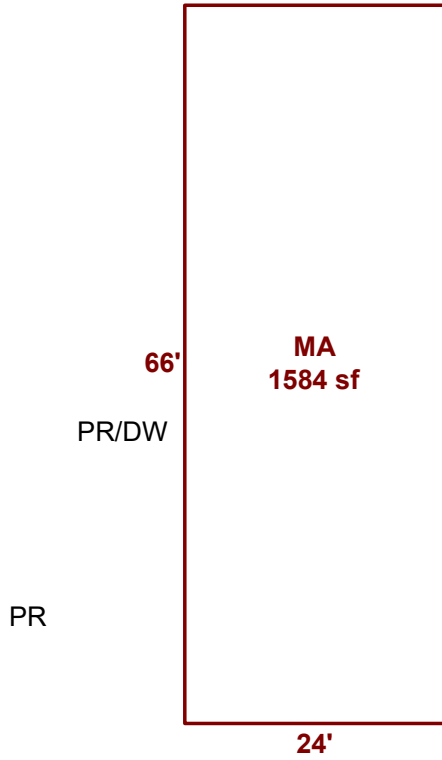

Sketch by ApexSketch

### AREA CALCULATIONS SUMMARY

Code	Description	Factor	Net Size	Perimeter	Net Totals
MFH	MA	1.0	1584.0	180.0	1584.0
	Net LIVABLE	cnt	1 (rounded)		1,584

### COMMENT TABLE 1

APEXED BY LK 8.15.24

### COMMENT TABLE 2

8-21-23 CYCLE TS

### COMMENT TABLE 3

**APEXED BY**  
Summary  
LK 8.15.24

lak

Clerk: \_\_\_\_\_ Lead Clerk: MBH Appr: \_\_\_\_\_

Print Date:  
7/13/2023

Acct ID: 128274 MTL: 041W14B000101P1 Date: 8/21/23 Appr: 02 Prop Class: 019 RMV Prop Class: 019

Situs: 21356 HUBBARD CUTOFF NE # 34 AURORA, OR 97002 MaSaNh: 12 05 000 Unit: 128274 Year: ~~2023~~

24-2

Last Date Appraised: 08/07/2013 Appraiser: THERESA SWEARINGEN Retag: Y N Tag info:

Owner: ARMENTA ARCE, SIULMY NOEMI &

Roll Type: MS

Cycle Tag Sales Verification Other: \_\_\_\_\_ Inspection level: 1 2 3 4 LCB TTO INSP

AV: 19150

RMV Land: 0 RMV Imp: 48150 RMV Total: 48150 MAV: 19150 MSAV: 0

SAV: 0

Comment: WESTERN WAGON VILLAGE, SPACE #34, MS SERIAL # 7587, X # X00148060, PERSONAL MS

**Notations**

No notation data available.

update Roof & EYB - DTD

add to PR - Exception

**OSDs**

No OSD data available.

**Land**

No land data available.

**Improvements - Residence / Manufactured Structures**

Bldg: 1 Code Area: 15560 Stat Class: 456 Year Blt: 1978 Eff Year Blt: 1978 Sq.Ft: 1584 % Complete: 100

Desc: MANUF STRUCT, CLASS 5, 24' WIDE DOUBLE

Dimensions: 66x24 RMV: 48150

Func Obsc: 100 Econ %: 100 Other %: 100

Exception: 0

Adjust: Adjust RMV: 0

**Floors**

Type	Class	Display Group	Floor Size	Beds	Baths	Yr Blt	Eff Yr Blt	Inventory	Exception: Y N
First Floor	5	Finished	1584	0	FB-2	1978	1978	KIT-, SKIRT, ROOF, HVAC+, BATH - 2	Y N

**Accessories**

Description	Class	Size SqFt	Eff Yr Blt	RMV	Quantity	Exception: Y N
DECK	5	140	1978	616	0	Y N
ROOF EXTENSION OR PATIO COVER	5	280	1978	1624	0	Y N

1997  
596  
1997

**Improvements - Accessory Buildings**

No improvement data available for all other stat class types.



V. Wanda  
win.

M128274 041W14B 00101 Appr # DTM Date 8-7-13 Prop Class 019 CAN TRIM 42  
 Biller Address 21356 HUBBARD CUTOFF NE, #34 Franchise Code 04 Year For: 2013-2014  
 Owner: GOEMAN, ROBERT C. WATKINS HOUSE

Notes: Inventary update Sales Verification Other: \_\_\_\_\_

RMV Imp: 14,410 RMV Total: 14,410 MSD Total: 14,410

Seg. Type MA Seg. # 1.1 Method M04 Class 5D Area 1584 Eff Area 1584 Length 66 Width 24  
 Make: GIBBON Model: STALLER Int/Finish: GYPSUM Roof Cover COMP  
 Plumbing BATH Heat: HP Fireplace: Inter. Comp: H&F Bedrooms  
 Year Built 1978 Eff. Year Built 1978 Cond. P F (A) G E  
 Adj Code MSLCMD,MSD,CITY City 5 % Comp \_\_\_ Func \_\_\_ Econ \_\_\_ RMV 12,800  
 Lump Sum \_\_\_ Except Code/Year \_\_\_ Comments Appears original

**Accessory Improvements**

Seg. Type PA Seg. # 1.3 Method: R05 Class Area 280 Eff Area 280  
 Length 40 Width 7 Foundation Ex. Wall Roof Cover  
 Roof Style Floor Plumbing  
 Year Built Eff. Year Built: 1978 Cond. P F (A) G E % Comp \_\_\_ Econ \_\_\_ RMV: 1,960  
 Lump Sum \_\_\_ Except Code/Year \_\_\_ Comments

Seg. Type DF Seg. # 1.4 Method: R05 Class Area 140 Eff Area 140  
 Length 28 Width 5 Foundation Ex. Wall Roof Cover  
 Roof Style Floor Plumbing  
 Year Built Eff. Year Built: 1978 Cond. P F (A) G E % Comp \_\_\_ Econ \_\_\_ RMV: 350  
 Lump Sum \_\_\_ Except Code/Year \_\_\_ Comments

**Out Buildings and Skirting**

Seg. Type MEISK Seg. # 1.2 Method: M04 Class Area 180 Eff Area 180  
 Length Width Foundation Ex. Wall METAL Roof Cover  
 Roof Style Floor Plumbing  
 Heat Int. Comp Elect. Yr. Bilt. 1978 Eff. Yr. Bilt. 1978  
 Cond. P F A G E Adj. Codes % Comp \_\_\_ Func \_\_\_ Econ \_\_\_ RMV: 200  
 Lump Sum \_\_\_ Except Code/Year \_\_\_ Comments

**BUILDING DIAGRAM AND OUTBUILDINGS**

ACCT NO: M128274 MAP NO: \_\_\_\_\_ TAX LOT: \_\_\_\_\_

CALCULATIONS: SCALE: 1" = 20'

MEASUREMENT VERIFIED: \_\_\_\_\_ YR. BILT.: 20 ADDRESS: 21356 Hubbard Cutoff NE #34 SALES Amt: \_\_\_\_\_  
 DATE: 8-7-13 BY: DTM REMARKS: BUILDER: Sorenson (Guerden) Date: \_\_\_\_\_

*Handwritten notes in orange and yellow:*  
 8-15-13  
 NV #2