

lak 11.21.24

Summary

Lead Appr: _____ Clerk: _____ Lead Clerk: _____ Appr: _____

Print Date:

10/2/2024

Acct ID: 131315

MTL: 062W31D001100P1

Date: 10/11/24 Appr: 02

ts12-5-24

Prop Class: 019

RMV Prop Class: 019

Situs: 5036 COPPER CREEK LOOP NE # 42 SALEM, OR 97305

MaSaNh: 13 05 000

Unit: 142648

Year: 2024

25.26

Last Date Appraised: 07/19/2010 Appraiser: THERESA SWEARINGEN Retag: Y N Tag info:

Owner: GOMEZ AISPURO, LINDA

Roll Type: MS

Cycle Tag Sales Verification Other: _____ Inspection level: 1 2 3 4 LCB TTO INSP

AV: 39870

RMV Land: 0 RMV Imp: 94200 RMV Total: 94200 MAV: 39870 MSAV: 0

SAV: 0

Comment: COPPER CREEK ESTATES, SPACE #42, MS SERIAL # 1184443, X # X00204480, PERSONAL MS

update Inv + EFB - DM

Notations

No notation data available.

OSDs

No OSD data available.

Land

No land data available.

Improvements - Residence / Manufactured Structures

Bldg: 1 Code Area: 24010 Stat Class: 457 - Year Blt: 1990 Eff Year Blt: 1999 Sq.Ft: 1431 % Complete: 100

Desc: MANUF STRUCT, CLASS 5, 26' THROUGH 28' WIDE DOUBLE

Dimensions: 53x27 RMV: 94200

Func Obsc: 100

Econ %: 100

Other %: 100

Exception: 0

Adjust:

Adjust RMV: 0

Floors

Type Class Display Group Floor Size Beds Baths Yr Blt Eff Yr Blt Inventory

First Floor 5 - Finished 1431 3 FB-2 1990 1999 BATH - 2, KIT-, HVAC+, ROOF, SKIRT Exception: Y N

1988

Accessories

Description Class Size SqFt Eff Yr Blt RMV Quantity

ROOF EXTENSION OR PATIO COVER 5 48 1999 640 0 Exception: Y N

Improvements - Accessory Buildings

No improvement data available for all other stat class types.

DW 96 1988 ITO



Westside - Sid of Dr
Roof - DM
+ red looking

M131315

BUILDING DIAGRAM AND OUTBUILDINGS

ACCT NO: X 204480

MAP NO:

TAX LOT:

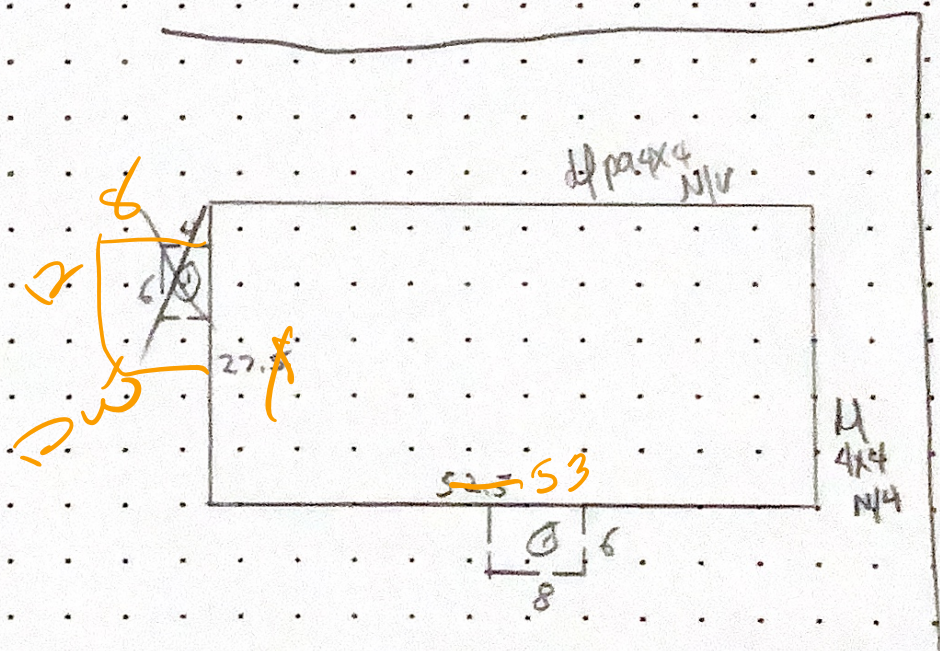

CALCULATIONS:

SCALE: 1" = 20'

COPPER CREEK EST.

MEASUREMENT VERIFIED		YR BLT: 90	ADDRESS: 5036 COPPER CREEK	SALES	
DATE	BY	REMARKS: N/U	BUILDER: REDMAN	Date	Amt.
5-14-91	AKB				
5-4-95	Hou Bvd				





Marion County
OREGON
ASSESSOR'S OFFICE

Appraiser Sales Verification From

Primary Acct: 131315
 MTL: 062W31D001100
 MaSaNh/P.Class: 1305000/019
 Appraiser: THERESA
 MS Acct: SWEARINGEN
 131315

Date Printed: 10/2/2024

Situs: 5036 COPPER CREEK LOOP NE # 42 SALEM, OR 97305

Grantor:
ALLEN, SHAWN

Grantee:
GOMEZ AISPURO, LINDA

Deed: MS
 Accts In Sale: 1
 Sale Date: 6/20/2024
 Sale Price: 8,000
 Code: 00 20
 Ratio: 1,178

Total Sale RMV:
 Land:
 OSD:
 Imp:
 Grand Total: 94200

Attempt	Date/Time	Reason
1 st		
2 nd		

Contact: _____ Phone/email: _____

- Was the property listed on the open market? Days: _____ MLS: _____ Y N
- Was property other than real estate included in the sale? Y N
Describe: _____ Est. \$: _____
- Did the seller pay closing costs or make other concessions? \$ _____ Y N
- Was the sale between related parties? (business or family) Y N
- Was this a distressed sale? E.g. foreclosure, short, court order, etc... Y N
- Condition at time of sale: | Poor | Fair | Avg. | Good | Exc. | Y N
Describe: _____

- Have any improvements been made since the time of sale? Y N
If yes, describe: _____

Comments:

Appraiser: 02 Date: 10/22/24

M131315 062W31D 01201 Appr #: DT4 Date 7-19-10 Prop Class 019 Prop Code ~~T47~~ T57
 Situs Address 5036 COPPER CREEK LP NE, #42 Franchise Code 04 Year For: 2010-2011
 Owner PERRY, RICHARD &

Notes: please recalc AS noted. Tags Cycle Sales Verification Other: _____

RMV Imp: 29,710 RMV Total: 29,710 M50 Total: 29,710

Seg. Type MA Seg. # 1.1 Method M04 Class 5D Area 1431 Eff Area 1431 Length 53 Width 27
 Make: REDMAN Model: Intfinish: GYPSUM Roof Cover COMP
 Plumbing BATH2 Heat FA Fireplace Inter. Comp: DW, H&F Bedrooms 3
 Year Built 1990 Eff. Year Built 1999 Cond. P F A G E
 Adj Code MSLCMD; MSD-OLTY Qty 5+ % Comp ___ Func ___ Econ ___ RMV 28,430
 Lump Sum _____ Except Code/Year M: NOT Comments NO save on one end.

Accessory Improvements

please run as on 2/25/10 form with minor exception value, DT4 8-5-10.

Seg. Type PA Seg. # 1.3 Method: R05 Class Area 48 Eff Area 48
 Length 8 Width 6
 Year Built Eff. Year Built: 1990 Cond. P F A G E % Comp ___ Econ ___ RMV: 320
 Lump Sum _____ Except Code/Year _____ Comments _____

Out Buildings and Skirting

Seg. Type MHSK Seg. # 1.2 Method: M04 Class Area 160 Eff Area 160
 Length Width Foundation Ex. Wall WOOD Roof Cover
 Roof Style Floor Plumbing
 Heat Int. Comp. Elect. Yr. Bilt. 1990 Eff. Yr. Bilt: 1990
 Cond. P F A G E Adj. Codes % Comp ___ Func ___ Econ ___ RMV: 960
 Lump Sum _____ Except Code/Year _____ Comments _____