

Summary

Lead Appr: _____ Clerk: _____ **lak 11.21.24** Lead Clerk: _____ Appr: _____

Print Date:

10/2/2024

Acct ID: 133303

MTL: 081W30C001200P1

Date: **10/24/24** Appr: **02**

Prop Class: 019

RMV Prop Class: 019

Situs: 620 WINDEMERE ST # 11 AUMSVILLE, OR 97325

MaSaNh: 17 05 000

Unit: 143580

Year: 2024

Last Date Appraised: 02/09/2024

Appraiser: THERESA SWEARINGEN

Retag: Y N

Tag info:

Owner: SMITH, SUE MARIE

Roll Type: MS

Cycle Tag **Sales Verification** Other: _____

Inspection level: 1 2 3 **4** LCB TTO INSP

AV: 55660

RMV Land: 0

RMV Imp: 118820

RMV Total: 118820

MAV: 55660

MSAV: 0

SAV: 0

Comment: 24-25: SV; L2 02.09.24 TS

Notations

No notation data available.

M/C

OSDs

No OSD data available.

Land

No land data available.

done on prior sale

Improvements - Residence / Manufactured Structures

Bldg: 1 Code Area: 05058 Stat Class: 457 Year Blt: 1996 Eff Year Blt: 2000 Sq.Ft: 1512 % Complete: 100
 Desc: MANUF STRUCT, CLASS 5, 26' THROUGH 28' WIDE DOUBLE Dimensions: 56x27 RMV: 118820
 Func Obsc: 100 Econ %: 100 Other %: 100 Exception: 0 Adjust: Adjust RMV: 0

Floors

Type	Class	Display Group	Floor Size	Beds	Baths	Yr Blt	Eff Yr Blt	Inventory	Exception: Y N
First Floor	5	Finished	1512	3	FB-2	1996	2000	BATH - 2, KIT-, ROOF, SKIRT, HVAC	Y N

Accessories

Description	Class	Size SqFt	Eff Yr Blt	RMV	Quantity	Exception: Y N
DECK	5	120	2000	1294	0	Exception: Y N
GARDEN SHED	5	80	2000	0	0	Exception: Y N
ROOF EXTENSION OR PATIO COVER	5	420	2000	5968	0	Exception: Y N

Improvements - Accessory Buildings

No improvement data available for all other stat class types.

SKETCH/AREA TABLE ADDENDUM

SUBJECT INFO

File No.: 133303 Parcel No.: 081W30C001200
 Property Address: 620 WINDEMERE ST #11
 City: AUMSVILLE County: State: OR ZipCode: 97325
 Owner:
 Client: Client Address:
 Appraiser Name: Inspection Date:

SKETCH

133303

081W30C001200

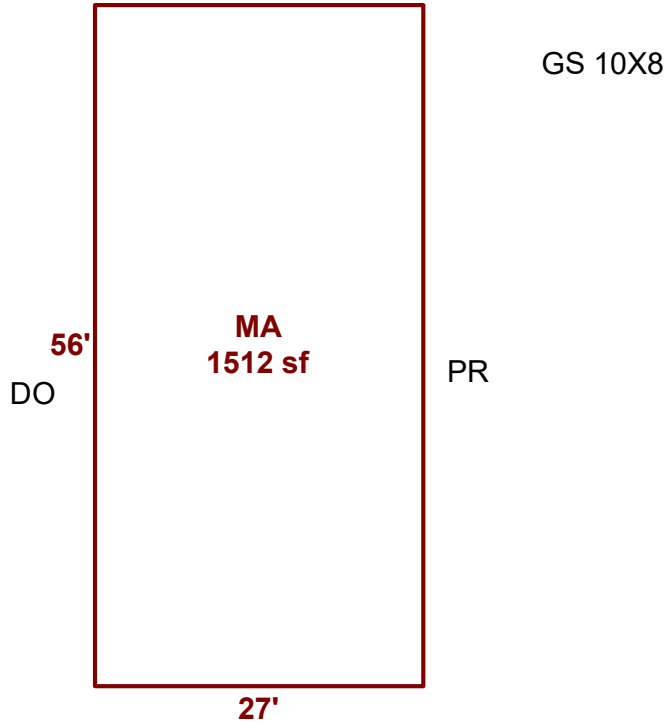

Sketch by ApexSketch

AREA CALCULATIONS SUMMARY

Code	Description	Factor	Net Size	Perimeter	Net Totals
MFH	MA	1.0	1512.0	166.0	1512.0

COMMENT TABLE 1

APEXED BY LK 8-7-24

COMMENT TABLE 2

2-9-24 SV TS

COMMENT TABLE 3

Net LIVABLE	cnt	1	(rounded)	1,512
-------------	-----	---	-----------	-------

APEXED BY

lak

Sum 1/8-7-24 ad Appr:

Clerk:

Lead Clerk:

Appr:

Print Date:

1/3/2024

Acct ID: 133303

MTL: 081W30C001200P1

Date: 2/9/24

Appr: 02

Prop Class: 019

RMV Prop Class: 019

Situs: 620 WINDEMERE ST # 11 AUMSVILLE, OR 97325

MaSaNh: 17 05 000

Unit: 143580

Year: 2024

Last Date Appraised: 07/01/2015

Appraiser: THERESA SWEARINGEN

Retag: Y N

Tag info:

Owner: ROBYN, STEVEN ARTHUR

Roll Type: MS

Cycle Tag Sales Verification Other:

Inspection level: 1 2 3 4 LCB TTO INSP

AV: 55660

RMV Land: 0

RMV Imp: 56390

RMV Total: 56390

MAV: 55660

MSAV: 0

SAV: 0

Comment: WINDEMERE MEADOWS, SPACE #11, MS SERIAL # WAFLS31AB13933WC13, X # X00236383, Home ID 282959, PERSONAL MS

Notations

No notation data available.

update EYB & Inv I/D

OSDs

No OSD data available.

Land

No land data available.

Improvements - Residence / Manufactured Structures

Bldg: 1 Code Area: 05058 Stat Class: 457 Year Blt: 1996 Eff Year Blt: 1996 Sq.Ft: 1512 % Complete: 100
Desc: MANUF STRUCT, CLASS 5, 26' THROUGH 28' WIDE DOUBLE Dimensions: 56x27 RMV: 56390
Func Obsc: 100 Econ %: 100 Other %: 100 Exception: 0 Adjust: Adjust RMV: 0

Floors

Table with columns: Type, Class, Display Group, Floor Size, Beds, Baths, Yr Blt, Eff Yr Blt, Inventory, Exception. Row 1: First Floor, 5, Finished, 1512, 3, FB-2, 1996, 1996, BATH - 2, KIT-, HVAC, ROOF, SKIRT, Exception: Y N

Accessories

Table with columns: Description, Class, Size SqFt, Eff Yr Blt, RMV, Quantity, Exception. Rows: DECK (Class 5, Size 48, RMV 401), MULTI-PURPOSE BUILDING (Class 5, Size 80, RMV 638), ROOF EXTENSION OR PATIO COVER (Class 5, Size 300, RMV 3306)

Improvements - Accessory Buildings

No improvement data available for all other stat class types.



H Sale by owner on line 02/14/24 @ 149,620

Fresh paint w.n.



Marion County
OREGON
ASSESSOR'S OFFICE

Date Printed: 10/2/2024

Appraiser Sales Verification From

Primary Acct: 133303
MTL: 081W30C001200
MaSaNh/P.Class: 1705000/019
Appraiser: THERESA
MS Acct: SWEARINGEN
133303

Situs: 620 WINDEMERE ST # 11 AUMSVILLE, OR 97325

Grantor:
ROBYN, STEVEN ARTHUR

Grantee:
SMITH, SUE MARIE

Deed: MS
Accts In Sale: 1
Sale Date: 4/18/2024
Sale Price: 148,195
Code: 00
Ratio: 80

Total Sale RMV:
Land:
OSD:
Imp:
Grand Total: 118820

Attempt	Date/Time	Reason
1 st		
2 nd		

Contact: _____ Phone/email: _____

- Was the property listed on the open market? Days: _____ MLS: _____ Y N
- Was property other than real estate included in the sale? Y N
Describe: _____ Est. \$: _____
- Did the seller pay closing costs or make other concessions? \$ _____ Y N
- Was the sale between related parties? (business or family) Y N
- Was this a distressed sale? E.g. foreclosure, short, court order, etc... Y N
- Condition at time of sale: | Poor | Fair | Avg. | Good | Exc. | Y N
Describe: _____

- Have any improvements been made since the time of sale? Y N
If yes, describe: _____

Comments:

4 sales by owner sqd in yard

Appraiser: _____ Date: _____