

lak 11.5.24

Summary Lead Appr: \_\_\_\_\_ Clerk: \_\_\_\_\_ Lead Clerk: \_\_\_\_\_ Appr: \_\_\_\_\_ Print Date: 9/24/2024

Acct ID: 133731 MTL: 083W23A002100P1 Date: 10/1/24 Appr: 02 Prop Class: 019 RMV Prop Class: 019

ts 11-13-24

Year: 2024 25-26

Situs: 2000 ROBINS LN SE # 51 SALEM, OR 97306 MaSaNh: 17 05 000 Unit: 133731

Last Date Appraised: 08/12/2015 Appraiser: THERESA SWEARINGEN Retag: Y N Tag info: Owner: WESSON, RUDY C Roll Type: MS  
Cycle Tag Sales Verification Other: \_\_\_\_\_ Inspection level: 1 2 3 4 LCB TTO INSP AV: 53500  
RMV Land: 0 RMV Imp: 90970 RMV Total: 90970 MAV: 53500 MSAV: 0 SAV: 0  
Comment: Uncoded accessory clean-up 5/1/23

update 24B+INV D/D

Notations No notation data available.

OSDs No OSD data available.

Land No land data available.

Improvements - Residence / Manufactured Structures

Bldg: 1 Code Area: 24010 Stat Class: 457 + Year Blt: 1997 Eff Year Blt: 1997 Sq.Ft: 1270 % Complete: 100  
Desc: MANUF STRUCT, CLASS 5, 26' THROUGH 28' WIDE DOUBLE Dimensions: 48x27 RMV: 90970  
Func Obsc: 100 Econ %: 100 Other %: 100 Exception: 0 Adjust: Adjust RMV: 0

Floors

| Type        | Class | Display Group | Floor Size | Beds | Baths | Yr Blt | Eff Yr Blt           | Inventory                          | Exception: Y N |
|-------------|-------|---------------|------------|------|-------|--------|----------------------|------------------------------------|----------------|
| First Floor | 5 +   | Finished      | 1270       | 3    | FB-2  | 1997   | <del>1997</del> 2000 | BATH - 2, KIT-, HVAC+, ROOF, SKIRT | N              |

Accessories

| Description                   | Class | Size SqFt | Eff Yr Blt           | RMV              | Quantity | Exception: Y N |
|-------------------------------|-------|-----------|----------------------|------------------|----------|----------------|
| DECK                          | 5     | 96        | <del>1997</del> 2000 | 845              | 0        | N              |
| MULTI-PURPOSE BUILDING        | 5     | 80        | 1997                 | <del>672</del> 0 | 0        | N              |
| ROOF EXTENSION OR PATIO COVER | 5     | 24        | <del>1997</del> 2000 | 278              | 0        | N              |
| ROOF EXTENSION OR PATIO COVER | 5     | 300       | <del>1997</del> 2000 | 3480             | 0        | N              |

Improvements - Accessory Buildings Dw 24 2000 D/D  
No improvement data available for all other stat class types.



with.



M133731 8-12-15

M133731

# BUILDING DIAGRAM AND OUTBUILDINGS

ACCT NO: M133731

MAP NO:

TAX LOT:

1296

24

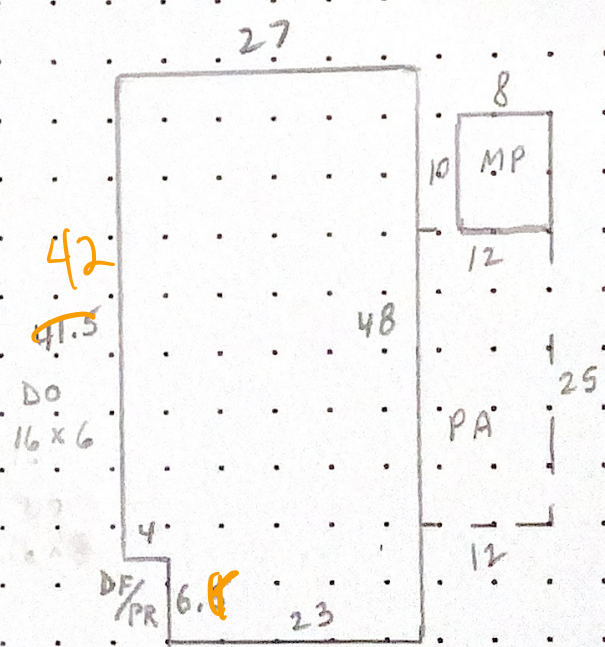

CALCULATIONS:  $(27 \times 48) - (4 \times 6) = 1272$  SCALE: 1" = 20' S.F.

| MEASUREMENT VERIFIED |      | YR BLT: 97 | ADDRESS: <u>OAK POINTE (51)</u> | SALES |      |  |
|----------------------|------|------------|---------------------------------|-------|------|--|
| DATE                 | BY   | REMARKS:   | BUILDER: <u>HBNW</u>            | Date  | Amt. |  |
| 4-15-97              | DT/4 |            |                                 |       |      |  |
| 9-4-08               | DT/4 |            | NV                              |       |      |  |
| 8-12-15              | DT/4 |            | NV.                             |       |      |  |

M133731 083W23A 02100 Appr #: DT4 Date 8-12-15 Prop Class 019 Prop Code 162757

Situs Address 2000 ROBINS LN SE, #51 Franchise Code 04 Year For: 2015-2016

Owner WITHERSPOON, BOBBY FRANK &

Notes: Inventory update Tags Cycle Sales Verification Other: \_\_\_\_\_ (5+16-)

RMV Imp: 29,090 RMV Total: 29,090 M50 Total: 29,090

Seg.Type MA      Seg. # 1.1      Method M04      Class 6D      Area 1270      Eff Area 1270      Length 48      Width 27  
 Make: HBNW      Model: HOMEBUILDER      Intfinish: DRYWL      Roof Cover COMP  
 Plumbing BATH2      Heat: AC      Fireplace:      Inter. Comp: DW;H&F      Bedrooms: 3  
 Year Built 1997      Eff. Year Built 1997      Cond. P F A G E  
 Adj Codes MSLCMD      Qty 5+      % Comp \_\_\_\_\_ Func \_\_\_\_\_ Econ \_\_\_\_\_      RMV 24,090  
 Lump Sum \_\_\_\_\_      Except Code/Year \_\_\_\_\_      Comments red house

**Accessory Improvements** class change = appr. judgement.

Seg.Type PA      MFD STRUCT      Seg. # 1.3      Method: R05      Class      Area 300      Eff Area 300  
 Length 25      Width 12      Foundation      Ex. Wall      Roof Cover METAL  
 Roof Style      Floor      Plumbing  
 Year Built 1997      Eff. Year Built: 1997      Cond. P F A G E      % Comp \_\_\_\_\_ Econ \_\_\_\_\_      RMV: 2,260  
 Lump Sum \_\_\_\_\_      Except Code/Year \_\_\_\_\_      Comments carport

Seg.Type DF      MFD STRUCT      Seg. # 1.4      Method: R05      Class      Area 96      Eff Area 96  
 Length 16      Width 6      Foundation      Ex. Wall      Roof Cover  
 Roof Style      Floor      Plumbing  
 Year Built 1997      Eff. Year Built: 1997      Cond. P F A G E      % Comp \_\_\_\_\_ Econ \_\_\_\_\_      RMV: 480  
 Lump Sum \_\_\_\_\_      Except Code/Year \_\_\_\_\_      Comments \_\_\_\_\_

Seg.Type DF      MFD STRUCT      Seg. # 1.5      Method: R05      Class      Area 128      Eff Area 128  
 Length 16      Width 8      Foundation      Ex. Wall      Roof Cover  
 Roof Style      Floor      Plumbing  
 Year Built 1997      Eff. Year Built: 1997      Cond. P F A G E      % Comp \_\_\_\_\_ Econ \_\_\_\_\_      RMV: 640  
 Lump Sum \_\_\_\_\_      Except Code/Year \_\_\_\_\_      Comments GDR

Seg.Type DF      MFD STRUCT      Seg. # 1.6      Method: R05      Class      Area 128      Eff Area 128  
 Length 16      Width 8      Foundation      Ex. Wall      Roof Cover  
 Roof Style      Floor      Plumbing  
 Year Built 1997      Eff. Year Built: 1997      Cond. P F A G E      % Comp \_\_\_\_\_ Econ \_\_\_\_\_      RMV: 640  
 Lump Sum \_\_\_\_\_      Except Code/Year \_\_\_\_\_      Comments GDR

Seg.Type PR      MFD STRUCT      Seg. # 1.7      Method: R05      Class      Area 24      Eff Area 24  
 Length 6      Width 4      Foundation      Ex. Wall      Roof Cover COMP  
 Roof Style      Floor      Plumbing  
 Year Built 1997      Eff. Year Built: 1997      Cond. P F A G E      % Comp \_\_\_\_\_ Econ \_\_\_\_\_      RMV: 290  
 Lump Sum \_\_\_\_\_      Except Code/Year \_\_\_\_\_      Comments factory porch

**Out Buildings and Skirting**

Seg.Type MHSK      MFD STRUCT      Seg. # 1.2      Method: M04      Class      Area 150      Eff Area 150  
 Length      Width      Foundation      Ex. Wall WOOD      Roof Cover  
 Roof Style      Floor      Plumbing  
 Heat      Int. Comp.      Elect.      Yr. Blt. 1997      Eff. Yr. Blt: 1997  
 Cond. P F A G E      Adj. Codes      % Comp \_\_\_\_\_ Func \_\_\_\_\_ Econ \_\_\_\_\_      RMV: 690  
 Lump Sum \_\_\_\_\_      Except Code/Year \_\_\_\_\_      Comments \_\_\_\_\_

Seg.Type MP      MULTI/MISC PUR      Seg. # 2.1      Method: F;N      Class 4      Area 80      Eff Area 80  
 Length 10      Width 8      Foundation      Ex. Wall      Roof Cover COMP  
 Roof Style      Floor DIRT      Plumbing  
 Heat      Int. Comp.      Elect.      Yr. Blt. 1997      Eff. Yr. Blt: 1997  
 Cond. P F A G E      Adj. Codes FLCM      % Comp \_\_\_\_\_ Func \_\_\_\_\_ Econ \_\_\_\_\_      RMV: 0  
 Lump Sum \_\_\_\_\_      Except Code/Year \_\_\_\_\_      Comments \_\_\_\_\_