

Summary Lead Appr: WW Clerk: Chris 1/12/24 Lead Clerk: _____ Appr: _____ Print Date: 7/31/2023

Acct ID: 352190 MTL: 061E170000101 Date: 9-7-23 Appr: LUKE Prop Class: 401 RMV Prop Class: 401
 Situs: 17088 DOUTHIT LN NE SILVERTON OR 97381 12-5-23 MaSaNh: 01 06 000 Unit: 63790 MMV 12/10/23 LUKE Year: 2023
 Last Date Appraised: 12/06/2022 Appraiser: CLINT LUKE Retag: 0 Tag info: 2024 - Tags/Permit (Outbuilding)
 Owner: BURKOFF, JOSEPH A & BURKOFF, YLENIA JULIA Roll Type: R
 Cycle: Tag Sales Verification Other: _____ Inspection level: 1 2 3 4 LCB TTO INSP AV: 422170
 RMV Land: 293810 RMV Imp: 694490 RMV Total: 988300 MAV: 422170 MSAV: 0 SAV: 0
 Comment: 23-24: L2 12.6.22 CL
 22-23: LEVEL 2 CL 1.10.22
ADD GB @ 50% ROTAG 1-1-24

Notations

No notation data available.

OSDs

Count	Code	Description	RMV	Code Area	Exception
1	MKTA	OSD - AVERAGE	45000	40500	0

Land

Site: 1 Code Area: 40500 Size: 2.00 Acres Use Code: 005 Zone: REST SAV Use: Exception: 0
 Class: 2BI Value Source: Rural Restrictive Description: TWO BENCH IRR RMV: 248810 Exception: Y N
 Adjustment(s): GSOIL, IRR Fire Patrol: Description:
 Comments: 19-20: DISQ FARM USE// 18-19: SV #94 DEL 2 GB
1.19 Mkt 2BISS
0.89 Mkt 2BDSS

Improvements - Residence / Manufactured Structures

Bldg: 1 Code Area: 40500 Stat Class: 152 Year Blt: 2018 Eff Year Blt: 2018 Sq.Ft: 3000 % Complete: 100
 Desc: Multi Story above grade Dimensions: RMV: 680360
 Func Obsc: 100 Econ %: 100 Other %: 100 Exception: 0 Adjust: Adjust RMV: 0

Floors

Type	Class	Display Group	Floor Size	Beds	Baths	Yr Blt	Eff Yr Blt	Inventory	Exception
First Floor	5	Finished	2552	3	FB-2/ HB-1	2018	2018	BATH - 2, BTH - 1, KIT-, BATH+, ROOF, HVAC+, FP	Y N
Attic	5	Finished	448	0	0	2018	2018		Y N
Garage Attached	5	Finished	651	0	0	2018	2018	ROOF	Y N

Accessories

Description	Class	Size SqFt	Eff Yr Blt	RMV	Quantity	Exception
YARD IMPROVEMENTS AVERAGE	5	0	2018	34104	1	Y N

Improvements - Accessory Buildings

Bldg: 2 Code Area: 40500 Stat Class: 341 Year Blt: 2019 Eff Year Blt: 2019 Sq.Ft: 308 % Complete: 100
 Desc: Multi Purpose Shed (MP) Dimensions: 22x14 RMV: 14130
 Func Obsc: 100 Econ %: 100 Other %: 100 Exception: 0 Adjust: Adjust RMV: 0

Floors

Type	Class	Display Group	Floor Size	Beds	Baths	Yr Blt	Eff Yr Blt	Inventory	Exception
Multi-Purpose Bldg	6	Finished	308	0	0	2019	2019	FAIR	Y N

Accessories

Description	Class	Size SqFt	Eff Yr Blt	RMV	Quantity
No accessory data available					

ACCOUNT # 352190 DATE: _____ RMV CLASS _____ PROP CLASS _____
 MTL _____ APPR _____ TAG Y N _____
 COMMENTS: _____

RESIDENCE / MANUFACTURED STRUCTURES

ACCESSORY IMPROVEMENTS / OUTBUILDINGS

STAT _____ QLTY + - FLOOR _____
 AREA _____ EFF AREA _____ BED _____
 ROOF + HVAC +
 BATH PKG: _____ BATH BATH + 1/2 BTH
 FIREPLACE: _____
 KITCHEN - +
 YR BLT _____ EFF YR _____ ECON _____
 % COMP _____ % GOOD _____ FUNC _____
 EXCEPT Y N LUMP SUM: _____
 MISC: _____
 YI CLASS _____ F G A E
 SKIRT - LIN FT _____
 COMMENT: _____

STAT _____ QLTY + - FLOOR _____
 AREA _____ EFF AREA _____ BED _____
 ROOF + HVAC +
 BATH PKG: _____ BATH BATH + 1/2 BTH
 FIREPLACE: _____
 KITCHEN - +
 YR BLT _____ EFF YR _____ ECON _____
 % COMP _____ % GOOD _____ FUNC _____
 EXCEPT Y N LUMP SUM: _____
 MISC: _____
 YI CLASS _____ F G A E
 SKIRT - LIN FT _____
 COMMENT: _____

STAT _____ QLTY + - FLOOR _____
 AREA _____ EFF AREA _____ BED _____
 ROOF + HVAC +
 BATH PKG: _____ BATH BATH + 1/2 BTH
 FIREPLACE: _____
 KITCHEN - +
 YR BLT _____ EFF YR _____ ECON _____
 % COMP _____ % GOOD _____ FUNC _____
 EXCEPT Y N LUMP SUM: _____
 MISC: _____
 YI CLASS _____ F G A E
 SKIRT - LIN FT _____
 COMMENT: _____

TYPE GB
 STAT / CLASS _____
 SIZE 43x58
2494
 FAIR
AVERAGE
 GOOD
 EXCELLENT
 BATH _____
 YR BLT 2023
 EFF YR _____
 % COMP 50
 EXCEPT 0 N
 MISC: _____
 COMMENT: _____

TYPE _____
 STAT / CLASS _____
 SIZE _____
 FAIR
 AVERAGE
 GOOD
 EXCELLENT
 BATH _____
 YR BLT _____
 EFF YR _____
 % COMP _____
 EXCEPT Y N
 MISC: _____
 COMMENT: _____

TYPE _____
 STAT / CLASS _____
 SIZE _____
 FAIR
 AVERAGE
 GOOD
 EXCELLENT
 BATH _____
 YR BLT _____
 EFF YR _____
 % COMP _____
 EXCEPT Y N
 MISC: _____
 COMMENT: _____

TYPE _____
 STAT / CLASS _____
 SIZE _____
 FAIR
 AVERAGE
 GOOD
 EXCELLENT
 BATH _____
 YR BLT _____
 EFF YR _____
 % COMP _____
 EXCEPT Y N
 MISC: _____
 COMMENT: _____

Percent Complete Form

Account # 352190

Additions

New Homes

		No Basement		Basement	
% Item	% Sum	% Item	% Sum	% Item	% Sum
3%		Plans/Survey	3%		3%
2%	0%	Excavation	2%	0%	4%
3%		Foundation	3%		10%
35%	45%	Framing	14%	20%	16%
8%	50%	Trusses	7%	30%	7%
7%	60%	Roofing	7%	35%	7%
7%	65%	Windows/Ext Doors	7%	45%	6%
5%	70%	Siding	5%	50%	5%
4%	75%	Plumbing Rough-In	4%		3%
3%		Electrical Rough-In	3%	55%	2%
2%	80%	Heating Rough-In	2%		1%
		Heating Unit	1%	60%	1%
3%		Insulation	3%		2%
5%	85%	Drywall (Finished)	5%	65%	4%
2%	90%	Paint Interior	2%	70%	2%
2%		Paint Exterior	2%		2%
		Cabinets	6%	75%	5%
2%		Electrical Fixtures	3%	80%	2%
2%	95%	Plumbing Fixtures	4%	85%	3%
3%		Floor Coverings & Countertops	7%	90%	6%
2%	100%	Interior Trim Carpentry	7%	95%	6%
		Porch/Entry/Stoop	2%	100%	2%
		Finish Grade	1%		1%

APPR _____ Date _____ YR For _____ % COMP _____
 APPR _____ Date _____ YR For _____ % COMP _____
 APPR _____ Date _____ YR For _____ % COMP _____
 APPR _____ Date _____ YR For _____ % COMP _____

Percent Complete Form

Account # _____

Gut & Remodels

Interior Trim Carpentry	7%	90%
Floor Coverings & Countertops	7%	85%
Plumbing Fixtures	4%	80%
Electrical Fixtures	3%	80%
Cabinets	6%	75%
Drywall (Finished)	5%	70%
Insulation	3%	65%

APPR _____ Date _____ YR For _____ % COMP _____
 APPR _____ Date _____ YR For _____ % COMP _____
 APPR _____ Date _____ YR For _____ % COMP _____
 APPR _____ Date _____ YR For _____ % COMP _____

Outbuilding Type: _____

	% Item	% Sum
Excavation/Foundation	10%	40%
Floor - Concrete/Wood	30%	
Walls - Framing	10%	65%
Walls - Covering/Siding	15%	
Roof - Framing/Trusses	15%	
Roof - Sheathing	5%	95%
Roof - Cover	10%	
Doors & Windows	5%	100%

APPR Anna Date 12-5-23 YR For 24-25 % COMP 50
 APPR _____ Date _____ YR For _____ % COMP _____
 APPR _____ Date _____ YR For _____ % COMP _____
 APPR _____ Date _____ YR For _____ % COMP _____

SKETCH/AREA TABLE ADDENDUM

SUBJECT INFO

File No.: R352190 Parcel No.: 061E17 00101
 Property Address: 17088 DOUTHIT LN NE
 City: SILVERTON County: MARION State: OR ZipCode: 97381
 Owner:
 Client: Client Address:
 Appraiser Name: Inspection Date:

SKETCH

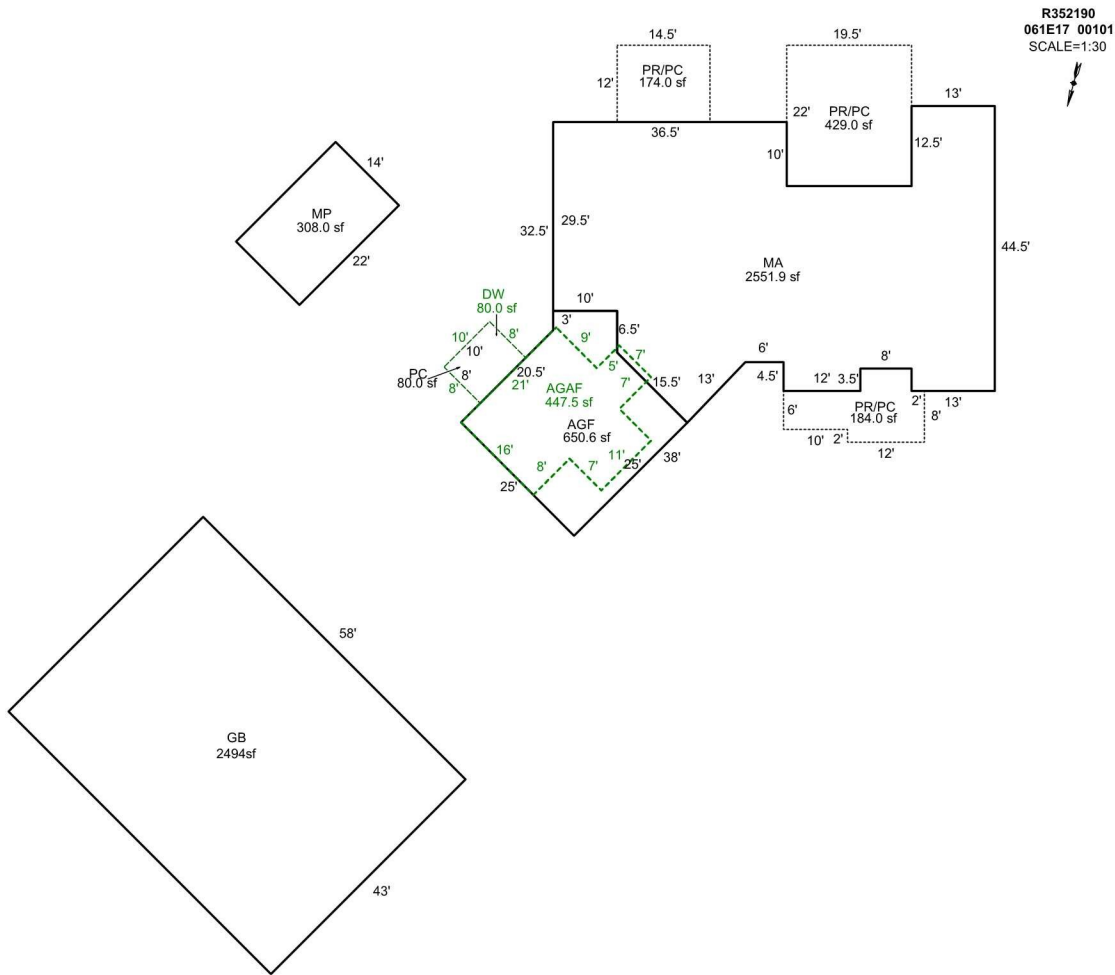

Sketch by Apex Sketch

AREA CALCULATIONS SUMMARY

Code	Description	Factor	Net Size	Perimeter	Net Totals
GBA1	MP	1.0	308.0	72.0	
	GB	1.0	2494.0	202.0	2802.0
GLA1	MA	1.0	2551.9	261.1	2551.9
GAR	AGF	1.0	650.6	105.4	
	AGAF	1.0	447.5	98.0	1098.1
YI1	PC	1.0	80.0	36.0	
	DW	1.0	80.0	36.0	160.0

COMMENT TABLE 1

DRAWN BY JRONDEMA 12/21/18
 UPDATED BY JRONDEMA 1/17/19
 UPD BY PH 03.20.20
 UPDATED BY CJURAN 09/28/2021 555-21-007584

COMMENT TABLE 2

12.10.19 SR #94

COMMENT TABLE 3

TAGS

Net LIVABLE	cnt	1	(rounded)	2,552
Net BUILDING	cnt	2	(rounded)	2,802



9/7/23



12/5/23