

Acct ID: 346002 MTL: 061E20C004100 Date: **9-4-23** Appr: **LUKE** Prop Class: 401 RMV Prop Class: 401
 Situs: 7262 ELMERS CT NE SILVERTON OR 97381 **12-5-23** MaSaNh: 01 06 008 Unit: 21185 Year: **2023**
 Last Date Appraised: 12/06/2022 Appraiser: CLINT LUKE Retag: **Y** N Tag info: 2024 - Tags/Permit (Addition)
 Owner: MORRIS, ANTHONY L & MORRIS, NICOLE M Roll Type: R
 Cycle: **Tag** Sales Verification Other: Inspection level: **1 2 3 4** LCB TTO INSP AV: 352760
 RMV Land: 261360 RMV Imp: 509840 RMV Total: 771200 MAV: 352760 MSAV: 0 SAV: 0
 Comment: 23-24: L3 12.6.2 CL LEVEL 2 7.24.20 SR94
ADD AGF @ 60 RETAG 1-1-24 FOR COMPLETION

Notations
 No notation data available.

OSDs

Count	Code	Description	RMV	Code Area	Exception
1	MKTA	OSD - AVERAGE	45000	40500	0

Land
 Site: 1 Code Area: 40500 Size: 2.00 Acres Use Code: 004 Zone: NREST SAV Use: Exception: 0
 Class: **6BD** Value Source: Rural at MKT Description: RMV: 216360 Exception: Y N
 Adjustment(s): Fire Patrol: SA004 Description: FIRE PATROL
 Comments: 20-21: PER #94 ADD OSD / 08-09: DISQ FARM USE / 400020 06-07: RECALC SETUP;#10 08-01-05

Improvements - Residence / Manufactured Structures
 Bldg: 1 Code Area: 40500 Stat Class: 141 + Year Blt: 2018 Eff Year Blt: 2019 Sq.Ft: 2284 % Complete: 100
 Desc: One Story Only Dimensions: RMV: 503630
 Func Obsc: 100 Econ %: 100 Other %: 100 Exception: 0 Adjust: Adjust RMV: 0

Floors

Type	Class	Display Group	Floor Size	Beds	Baths	Yr Blt	Eff Yr Blt	Inventory	Exception
First Floor	4 +	Finished	2284	3	FB-2	2018	2019	BATH - 2, KIT-, BATH+, ROOF, HVAC, FP	Y N
Garage Attached	4	Finished	552	0	0	2019	2019	ROOF	Y N

Accessories

Description	Class	Size SqFt	Eff Yr Blt	RMV	Quantity	Exception
YARD IMPROVEMENTS AVERAGE	4	0	2019	28067	1	Y N

Improvements - Accessory Buildings
 Bldg: 2 Code Area: 40500 Stat Class: 341 Year Blt: 2020 Eff Year Blt: 2020 Sq.Ft: 200 % Complete: 100
 Desc: Multi Purpose Shed (MP) Dimensions: 20x10 RMV: 5450
 Func Obsc: 100 Econ %: 100 Other %: 100 Exception: 0 Adjust: Adjust RMV: 0

Floors

Type	Class	Display Group	Floor Size	Beds	Baths	Yr Blt	Eff Yr Blt	Inventory	Exception
Multi-Purpose Bldg	5	Finished	200	0	0	2020	2020		Y N

Accessories

Description	Class	Size SqFt	Eff Yr Blt	RMV	Quantity	Exception
No accessory data available						

Bldg: 3 Code Area: 40500 Stat Class: 354 Year Blt: 2020 Eff Year Blt: 2020 Sq.Ft: 160 % Complete: 100
 Desc: Lean-to Light (LTL) Dimensions: RMV: 760
 Func Obsc: 100 Econ %: 100 Other %: 100 Exception: 0 Adjust: Adjust RMV: 0

Floors

Type	Class	Display Group	Floor Size	Beds	Baths	Yr Blt	Eff Yr Blt	Inventory	Exception
Lean-to Light Duty	5	Finished	160	0	0	2020	2020		Y N

Accessories

Description	Class	Size SqFt	Eff Yr Blt	RMV	Quantity	Exception
No accessory data available						

ACCOUNT # 346002 DATE: 12-5-23 RMV CLASS _____ PROP CLASS _____
 MTL _____ APPR WMC TAG Y N _____
 COMMENTS: _____

RESIDENCE / MANUFACTURED STRUCTURES

ACCESSORY IMPROVEMENTS / OUTBUILDINGS

STAT _____ QLTY + - FLOOR _____
 AREA _____ EFF AREA _____ BED _____
 ROOF + HVAC +
 BATH PKG: _____ BATH BATH + 1/2 BTH
 FIREPLACE: _____
 KITCHEN - +
 YR BLT _____ EFF YR _____ ECON _____
 % COMP _____ % GOOD _____ FUNC _____
 EXCEPT Y N LUMP SUM: _____
 MISC: _____
 YI CLASS _____ F G A E
 SKIRT - LIN FT _____
 COMMENT: _____

TYPE AGF 4
 STAT / CLASS _____
 SIZE 1520 sq
 FAIR
AVERAGE
 GOOD
 EXCELLENT
 BATH _____
 YR BLT _____
 EFF YR 2023
 % COMP 60
 EXCEPT Y N
 MISC: _____
 COMMENT: _____

TYPE _____
 STAT / CLASS _____
 SIZE _____
 FAIR
 AVERAGE
 GOOD
 EXCELLENT
 BATH _____
 YR BLT _____
 EFF YR _____
 % COMP _____
 EXCEPT Y N
 MISC: _____
 COMMENT: _____

STAT _____ QLTY + - FLOOR _____
 AREA _____ EFF AREA _____ BED _____
 ROOF + HVAC +
 BATH PKG: _____ BATH BATH + 1/2 BTH
 FIREPLACE: _____
 KITCHEN - +
 YR BLT _____ EFF YR _____ ECON _____
 % COMP _____ % GOOD _____ FUNC _____
 EXCEPT Y N LUMP SUM: _____
 MISC: _____
 YI CLASS _____ F G A E
 SKIRT - LIN FT _____
 COMMENT: _____

TYPE _____
 STAT / CLASS _____
 SIZE _____
 FAIR
 AVERAGE
 GOOD
 EXCELLENT
 BATH _____
 YR BLT _____
 EFF YR _____
 % COMP _____
 EXCEPT Y N
 MISC: _____
 COMMENT: _____

TYPE _____
 STAT / CLASS _____
 SIZE _____
 FAIR
 AVERAGE
 GOOD
 EXCELLENT
 BATH _____
 YR BLT _____
 EFF YR _____
 % COMP _____
 EXCEPT Y N
 MISC: _____
 COMMENT: _____

STAT _____ QLTY + - FLOOR _____
 AREA _____ EFF AREA _____ BED _____
 ROOF + HVAC +
 BATH PKG: _____ BATH BATH + 1/2 BTH
 FIREPLACE: _____
 KITCHEN - +
 YR BLT _____ EFF YR _____ ECON _____
 % COMP _____ % GOOD _____ FUNC _____
 EXCEPT Y N LUMP SUM: _____
 MISC: _____
 YI CLASS _____ F G A E
 SKIRT - LIN FT _____
 COMMENT: _____

TYPE _____
 STAT / CLASS _____
 SIZE _____
 FAIR
 AVERAGE
 GOOD
 EXCELLENT
 BATH _____
 YR BLT _____
 EFF YR _____
 % COMP _____
 EXCEPT Y N
 MISC: _____
 COMMENT: _____

TYPE _____
 STAT / CLASS _____
 SIZE _____
 FAIR
 AVERAGE
 GOOD
 EXCELLENT
 BATH _____
 YR BLT _____
 EFF YR _____
 % COMP _____
 EXCEPT Y N
 MISC: _____
 COMMENT: _____

Percent Complete Form

Account # 346002

Additions

New Homes

		No Basement		Basement	
% Item	% Sum	% Item	% Sum	% Item	% Sum
3%		Plans/Survey	3%		3%
2%	0%	Excavation	2%	0%	4%
3%		Foundation	3%		10%
35%	45%	Framing	14%	20%	16%
8%	50%	Trusses	7%	30%	7%
7%	60%	Roofing	7%	35%	7%
7%	65%	Windows/Ext Doors	7%	45%	6%
5%	70%	Siding	5%	50%	5%
4%	75%	Plumbing Rough-In	4%		3%
3%		Electrical Rough-In	3%	55%	2%
2%	80%	Heating Rough-In	2%		1%
		Heating Unit	1%	60%	1%
3%		Insulation	3%		2%
5%	85%	Drywall (Finished)	5%	65%	4%
2%	90%	Paint Interior	2%	70%	2%
2%		Paint Exterior	2%		2%
		Cabinets	6%	75%	5%
2%		Electrical Fixtures	3%	80%	2%
2%	95%	Plumbing Fixtures	4%	85%	3%
3%		Floor Coverings & Countertops	7%	90%	6%
2%	100%	Interior Trim Carpentry	7%	95%	6%
		Porch/Entry/Stoop	2%	100%	2%
		Finish Grade	1%		1%

APPR _____ Date _____ YR For _____ % COMP _____
 APPR _____ Date _____ YR For _____ % COMP _____
 APPR _____ Date _____ YR For _____ % COMP _____
 APPR _____ Date _____ YR For _____ % COMP _____

Percent Complete Form

Account # _____

Gut & Remodels

Interior Trim Carpentry	7%	90%
Floor Coverings & Countertops	7%	85%
Plumbing Fixtures	4%	80%
Electrical Fixtures	3%	80%
Cabinets	6%	75%
Drywall (Finished)	5%	70%
Insulation	3%	65%

APPR _____ Date _____ YR For _____ % COMP _____
 APPR _____ Date _____ YR For _____ % COMP _____
 APPR _____ Date _____ YR For _____ % COMP _____
 APPR _____ Date _____ YR For _____ % COMP _____

AGF

Outbuilding Type: _____

	% Item	% Sum
Excavation/Foundation	10%	40%
Floor - Concrete/Wood	30%	
Walls - Framing	10%	65%
Walls - Covering/Siding	15%	
Roof - Framing/Trusses	15%	
Roof - Sheathing	5%	95%
Roof - Cover	10%	
Doors & Windows	5%	100%

*12-5-23
EXT W/ROOF
SOME WINDOWS
ROOF
NO DOORS*

APPR 6000 Date 12-5-23 YR For 24-25 % COMP 60
 APPR _____ Date _____ YR For _____ % COMP _____
 APPR _____ Date _____ YR For _____ % COMP _____
 APPR _____ Date _____ YR For _____ % COMP _____

SKETCH/AREA TABLE ADDENDUM

SUBJECT INFO

File No.: 346002 Parcel No.: 061E20C 04100
 Property Address: 7262 ELMERS CT NE
 City: SILVERTON County: MARION State: OR ZipCode: 97381
 Owner:
 Client: Client Address:
 Appraiser Name: Inspection Date:

SKETCH

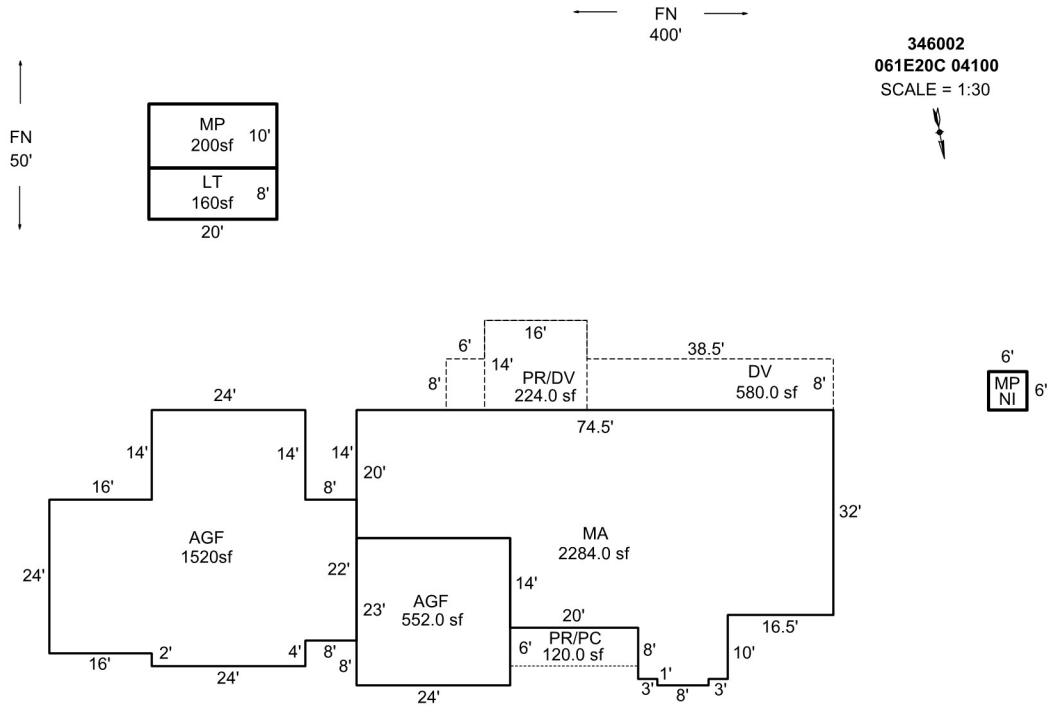

Sketch by Apex Sketch

AREA CALCULATIONS SUMMARY

COMMENT TABLE 1

Code	Description	Factor	Net Size	Perimeter	Net Totals
GBA1	MP	1.0	36.0	24.0	
	LT	1.0	160.0	56.0	
	MP	1.0	200.0	60.0	396.0
GLA1	MA	1.0	2284.0	235.0	2284.0
GAR	AGF	1.0	552.0	94.0	
	AGF	1.0	1520.0	176.0	2072.0
YI1	PR/DV	1.0	224.0	60.0	
	DV	1.0	580.0	149.0	804.0

DRAWN BY JRONDEMA 4/16/19
 UPD BY PH 10.09.19
 UPD BY PHU 11.13.20
 UPDATED BY CJURAN 555-22-002505

COMMENT TABLE 2

COMMENT TABLE 3

09.25.19 SR #94
 07.24.20 SR #94: TAGS

TAGS

Net LIVABLE cnt 1 (rounded) 2,284
 Net BUILDING cnt 3 (rounded) 396



9/14/23



9/14/23



9/14/23



9/14/23