

Acct ID: 330723 MTL: 072W28BC02700 Date: **11/7/23** Appr: **GRH** Prop Class: 401 RMV Prop Class: 401
 Situs: 5674 BASIL ST NE SALEM OR 97317 MaSaNh: 04 06 000 Unit: 55348 Year: 2023
 Last Date Appraised: 02/22/2021 Appraiser: GERARDO RAMIREZ HERNANDEZ Retag: **N** Tag info: 2024 - Tags/Permit (Expiring Adjudication)

Owner: MAKARENKO, ANASTASIYA Roll Type: R
 Cycle **Tag** Sales Verification Other: _____ Inspection level: 1 **2** 3 4 **0** **0** INSP AV: 333160
 RMV Land: 159280 RMV Imp: 365430 RMV Total: 524710 MAV: 333160 MSAV: 0 SAV: 0

Comment: LEVEL 4 2.22.21 PH-142
owner did not ask for reappraisal.

update inventory

close tag

INPUT GRH 11.27.23

RP/MS	Code	Description	WW
RP	ADJ	ADJUDICATION	

remove adjudication.

OSDs Amy 12-29-23

Count	Code	Description	RMV	Code Area	Exception
1	MKTA	OSD - AVERAGE	45000	92410	0

Land

Site: 1 Code Area: 92410 Size: 1.39 Acres Use Code: 004 Zone: NREST SAV Use: Exception: 0
 Class: Value Source: BoPTa/Magistrate Lowered Description: ~~2BI~~ RMV: 114280 Exception: Y N
 Adjustment(s): **CHG TO RUR @ MKT** Fire Patrol: Description:
 Comments: 18-19: PER #102 ADD OSD / 15-16: CYCLE WORK PER #29 NO CHG// 03-04: BASIL PASTURE SUBDIVISION MERGING INTO SURROUNDING AREA //05-06: RECALC SETUP; 36, 6/17/04.

Remove adjustment

Improvements - Residence / Manufactured Structures

Bldg: 1 Code Area: 92410 Stat Class: 151 Year Blt: 2017 Eff Year Blt: 2017 Sq.Ft: 2546 % Complete: 100
 Desc: One Story Only Dimensions: RMV: 356260
 Func Obsc: 100 Econ %: 100 Other %: 100 Exception: 0 Adjust: Adjust RMV: 0

I/O

Floors Remove adjustment

Type	Class	Display Group	Floor Size	Beds	Baths	Yr Blt	Eff Yr Blt	Inventory	Exception
First Floor	5	Finished	2546	3	FB-2	2017	2017	BATH - 2, KIT-, BATH+, HVAC+, FP, ROOF	Y N
Garage Attached	5	Finished	1120	0	0	2017	2017	ROOF	Y N

Accessories **It's 5 Good**

Description	Class	Size SqFt	Eff Yr Blt	RMV	Quantity	Exception
CONCRETE DRIVEWAY	5	1662	2017	5293	1	Y N
PATIO	5	352	2017	1897	1	Y N
PATIO	5	1211	2017	6527	1	Y N
ROOF EXTENSION OR PATIO COVER	5	136	2017	3865	1	N
ROOF EXTENSION OR PATIO COVER	5	266	2017	7560	1	Y N

Improvements - Accessory Buildings

Bldg: 2 Code Area: 92410 Stat Class: 341 Year Blt: 2017 Eff Year Blt: 2017 Sq.Ft: 192 % Complete: 100
 Desc: Multi Purpose Shed (MP) Dimensions: 16x12 RMV: 2720
 Func Obsc: 100 Econ %: 100 Other %: 100 Exception: 0 Adjust: Adjust RMV: 0

N/C

Floors Remove adjustment

Type	Class	Display Group	Floor Size	Beds	Baths	Yr Blt	Eff Yr Blt	Inventory	Exception
Multi-Purpose Bldg	5	Finished	192	0	0	2017	2017		Y N

Accessories

Description Class Size SqFt Eff Yr Blt RMV Quantity

No accessory data available

Bldg: 3 Code Area: 92410 Stat Class: 341 Year Blt: 2018 Eff Year Blt: 2018 Sq.Ft: 140 % Complete: 100
 Desc: Multi Purpose Shed (MP) Dimensions: 10x14 RMV: 6450
 Func Obsc: 100 Econ %: 100 Other %: 100 Exception: 0 Adjust: Adjust RMV: 0

N/C

Floors Remove adjustment?

Type	Class	Display Group	Floor Size	Beds	Baths	Yr Blt	Eff Yr Blt	Inventory	Exception
Multi-Purpose Bldg	5	Finished	140	0	0	2018	2018		Y N

Accessories

Description	Class	Size SqFt	Eff Yr Blt	RMV	Quantity	Exception: Y N
CONCRETE DRIVEWAY	5	1520	2018	6156	1	

SKETCH/AREA TABLE ADDENDUM

SUBJECT INFO

File No.: 330723 Parcel No.: 072W28BC02700
 Property Address: 5674 BASIL ST NE
 City: SALEM County: MARION State: OR ZipCode: 97317
 Owner:
 Client: Client Address:
 Appraiser Name: Inspection Date:

SKETCH

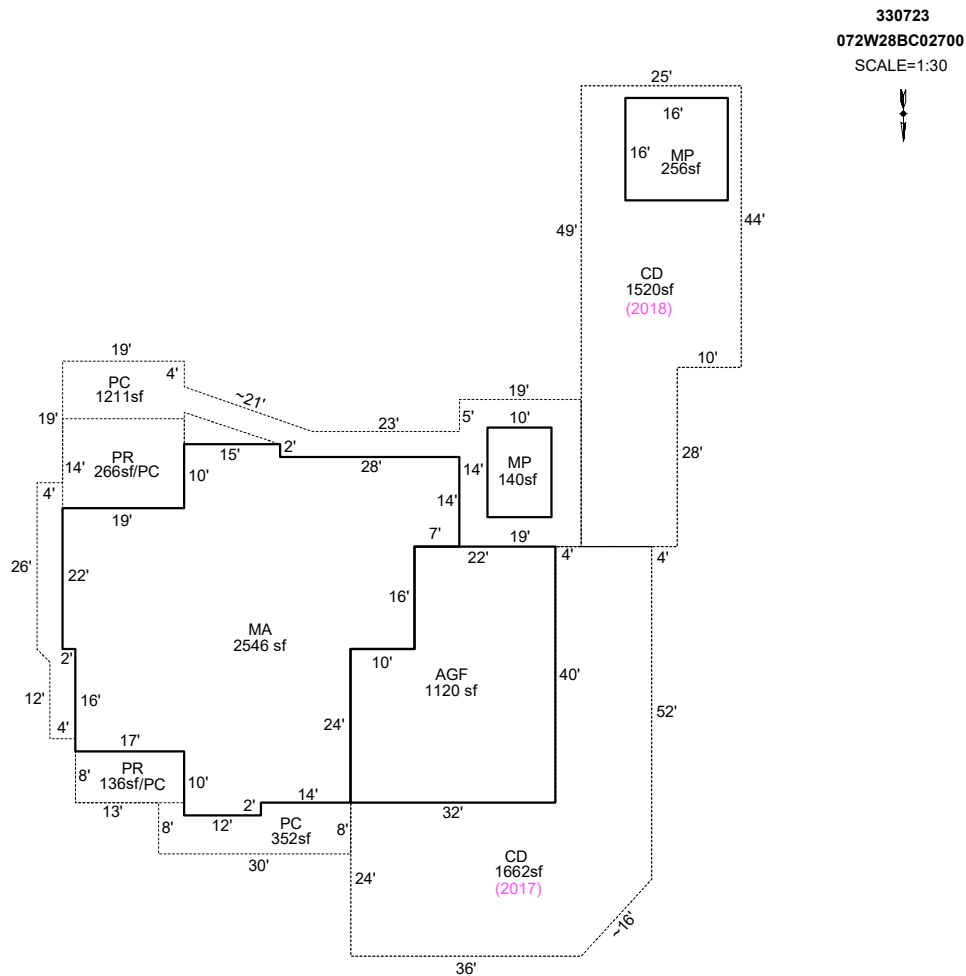

Sketch by Apex Sketch

AREA CALCULATIONS SUMMARY						COMMENT TABLE 1	
Code	Description	Factor	Net Size	Perimeter	Net Totals		
GBA1	MP	1.0	140.0	48.0		DRAWN BY JRONDEMA 11/29/17 UPDATED BY CJURAN 02/22/2021 UPDATED BY CJURAN 11/13/2023	
	MP	1.0	256.0	64.0	396.0		
GLA1	MA	1.0	2546.0	240.0	2546.0		
GAR	AGF	1.0	1120.0	144.0	1120.0		
P/P	CD	1.0	1520.0	194.0			
	PC	1.0	1210.5	332.8			
	PC	1.0	352.0	122.0			
	PR	1.0	266.0	66.0			
	PR	1.0	136.0	50.0			
	CD	1.0	1662.0	215.3	5146.5		
	Net LIVABLE	cnt	1 (rounded)		2,546	COMMENT TABLE 2 01/10/18 #102 02/22/2021 T42 PH GRH 11/07/2023	
	Net BUILDING	cnt	2 (rounded)		396		

SKETCH/AREA TABLE ADDENDUM

SUBJECT INFO

File No.: R330723 Parcel No.: 072W28BC02700
 Property Address: 5674 BASIL ST NE
 City: SALEM County: MARION State: OR ZipCode: 97317
 Owner:
 Client: Client Address:
 Appraiser Name: Inspection Date:

SKETCH

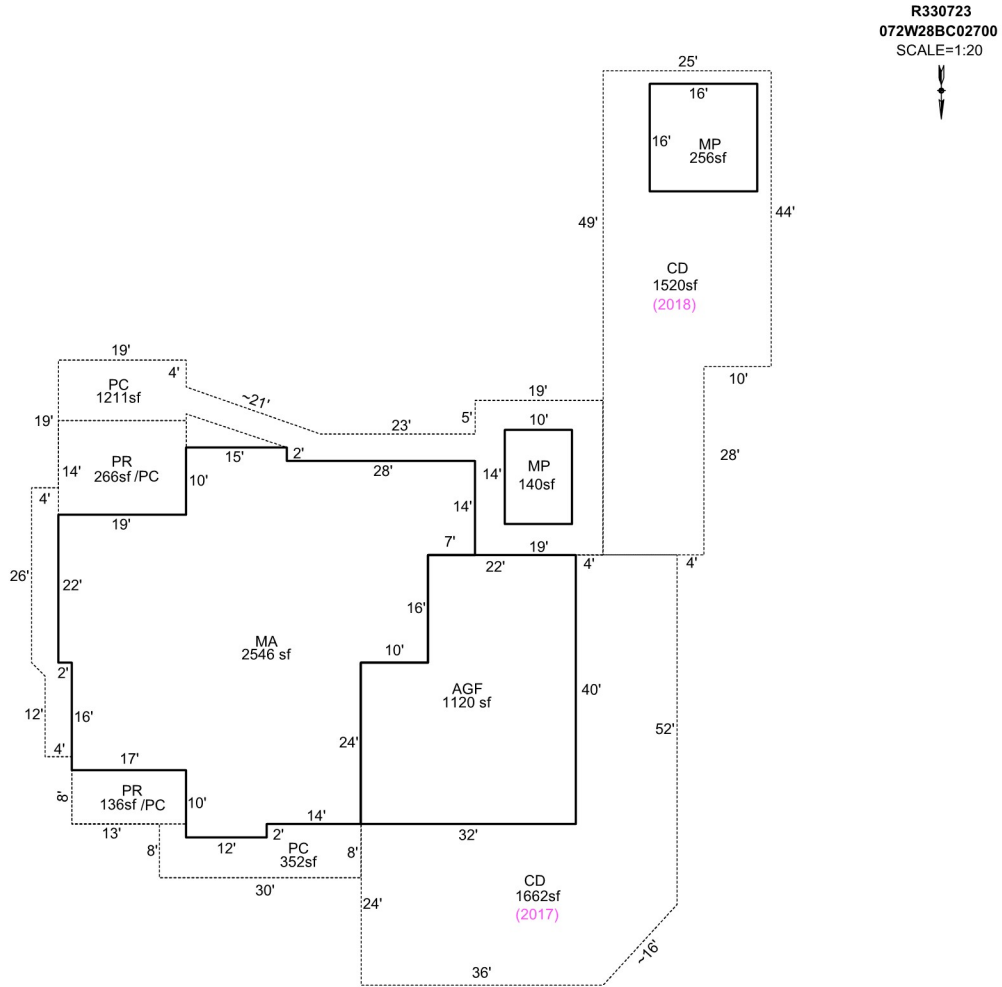

AREA CALCULATIONS SUMMARY

Code	Description	Factor	Net Size	Perimeter	Net Totals
GBA1	MP	1.0	140.0	48.0	
	MP	1.0	256.0	64.0	396.0
GLA1	MA	1.0	2546.0	240.0	2546.0
GAR	AGF	1.0	1120.0	144.0	1120.0
P/P	CD	1.0	1520.0	194.0	
	PC	1.0	1210.5	332.8	
	PC	1.0	352.0	122.0	
	PR	1.0	266.0	66.0	
	PR	1.0	136.0	50.0	
	CD	1.0	1662.0	215.3	5146.5
	Net LIVABLE	cnt	1 (rounded)		2,546
	Net BUILDING	cnt	2 (rounded)		396

COMMENT TABLE 1

DRAWN BY JRONDEMA 11/29/17
 UPDATED BY CJURAN 02/22/2021

COMMENT TABLE 2

01/10/18 #102
 02/22/2021 T42 PH

11/7/23 GRH

COMMENT TABLE 3

TAGS
 TAGS L4

TAGS L2