

Acct ID: 530031 MTL: 082W19A000900 Date: 1/10/24 Appr: MDL Prop Class: 401 RMV Prop Class: 401  
 Situs: 6132 COATES DR SE SALEM OR 97301 MaSaNh: 07 06 000 Unit: 26506 Year: 2024

Last Date Appraised: 04/02/2012 Appraiser: MATT LORD Retag: Y (N) Tag info: 2024 - Tags/Permit (Outbuilding)  
 Owner: COOPER, CASSIE RUTH & Roll Type: R  
 Cycle: (Tag) Sales Verification Other: \_\_\_\_\_ Inspection level: 1 2 3 4 LCB TTO INSP AV: 182570  
 RMV Land: 239450 RMV Imp: 179940 RMV Total: 419390 MAV: 182570 MSAV: 0 SAV: 0  
 Comment: 23-006590 18x20 metal carport ~~18x20~~

Notations 100% complete gated Pull TAB  
 No notation data available.

OSDs

| Count | Code | Description | RMV   | Code Area | Exception |
|-------|------|-------------|-------|-----------|-----------|
| 1     | MKTF | OSD - FAIR  | 35000 | 92590     | 0         |

Land Amy 4-5-24

Site: 1 Code Area: 92590 Size: 2.20 Acres Use Code: 004 Zone: NREST SAV Use: Exception: 0  
 Class: 6H Value Source: Rural at MKT Description: RMV: 204450 Exception: Y N  
 Adjustment(s): FSOIL Fire Patrol: Description:  
 Comments: 02-03: REAPPRAISAL

Improvements - Residence / Manufactured Structures

Bldg: 1 Code Area: 92590 Stat Class: 107 Year Blt: Eff Year Blt: Sq.Ft: 0 % Complete: 100  
 Desc: Yard Improvements Dimensions: RMV: 5020  
 Func Obsc: 100 Econ %: 100 Other %: 100 Exception: 0 Adjust: Adjust RMV: 0

Floors

| Type                    | Class | Display Group | Floor Size | Beds | Baths | Yr Blt | Eff Yr Blt | Inventory |
|-------------------------|-------|---------------|------------|------|-------|--------|------------|-----------|
| No floor data available |       |               |            |      |       |        |            |           |

Accessories

| Description               | Class | Size SqFt | Eff Yr Blt     | RMV  | Quantity |
|---------------------------|-------|-----------|----------------|------|----------|
| YARD IMPROVEMENTS AVERAGE | 3     | 1         | <u>or 2003</u> | 5022 | 1        |

Bldg: 3 Code Area: 92590 Stat Class: 131 Year Blt: 2003 Eff Year Blt: 2003 Sq.Ft: 1140 % Complete: 100  
 Desc: One Story Only Dimensions: RMV: 132770  
 Func Obsc: 100 Econ %: 100 Other %: 100 Exception: 0 Adjust: Adjust RMV: 0

Floors

| Type        | Class | Display Group | Floor Size | Beds | Baths | Yr Blt | Eff Yr Blt | Inventory                   |
|-------------|-------|---------------|------------|------|-------|--------|------------|-----------------------------|
| First Floor | 3     | Finished      | 1140       | 2    | FB-1  | 2003   | 2003       | HVAC+, ROOF, KIT+, BATH - 1 |

Accessories

| Description | Class | Size SqFt | Eff Yr Blt | RMV  | Quantity |
|-------------|-------|-----------|------------|------|----------|
| DECK        | 3     | 416       | 2003       | 8237 | 1        |

Bldg: 4 Code Area: 92590 Stat Class: 138 Year Blt: 2008 Eff Year Blt: 2008 Sq.Ft: 0 % Complete: 100  
 Desc: Res other improvements Dimensions: RMV: 40870  
 Func Obsc: 100 Econ %: 100 Other %: 100 Exception: 0 Adjust: Adjust RMV: 0

Floors

| Type            | Class | Display Group | Floor Size | Beds | Baths | Yr Blt | Eff Yr Blt | Inventory |
|-----------------|-------|---------------|------------|------|-------|--------|------------|-----------|
| Garage Detached | 3     | Finished      | 576        | 0    | 0     | 2008   | 2008       | ROOF      |

Accessories

| Description                 | Class | Size SqFt | Eff Yr Blt | RMV | Quantity |
|-----------------------------|-------|-----------|------------|-----|----------|
| No accessory data available |       |           |            |     |          |

Improvements - Accessory Buildings

Bldg: 2 Code Area: 92590 Stat Class: 341 Year Blt: 1960 Eff Year Blt: 1960 Sq.Ft: 160 % Complete: 100  
 Desc: Multi Purpose Shed (MP) Dimensions: 20x8 RMV: 870  
 Func Obsc: 100 Econ %: 100 Other %: 100 Exception: 0 Adjust: Adjust RMV: 0

Floors

| Type               | Class | Display Group | Floor Size | Beds | Baths | Yr Blt | Eff Yr Blt | Inventory |
|--------------------|-------|---------------|------------|------|-------|--------|------------|-----------|
| Multi-Purpose Bldg | 5     | Finished      | 160        | 0    | 0     | 1960   | 1960       | FAIR      |

**Accessories**

| Description                 | Class | Size SqFt | Eff Yr Blt | RMV | Quantity |
|-----------------------------|-------|-----------|------------|-----|----------|
| No accessory data available |       |           |            |     |          |

Bldg: 5    Code Area: 92590    Stat Class: 354    Year Blt: 2008    Eff Year Blt: 2008    Sq.Ft: 144    % Complete: 100  
Desc: Lean-to Light (LTL)    Dimensions: 6x24    RMV: 410  
Func Obsc: 100    Econ %: 100    Other %: 100    Exception: 0    Adjust:    Adjust RMV: 0

**Floors**

| Type               | Class | Display Group | Floor Size | Beds | Baths | Yr Blt | Eff Yr Blt | Inventory      |
|--------------------|-------|---------------|------------|------|-------|--------|------------|----------------|
| Lean-to Light Duty | 4     | Finished      | 144        | 0    | 0     | 2008   | 2008       | Exception: Y N |

**Accessories**

| Description                 | Class | Size SqFt | Eff Yr Blt | RMV | Quantity |
|-----------------------------|-------|-----------|------------|-----|----------|
| No accessory data available |       |           |            |     |          |

Carport (DC)  
Gable / Metal Roof  
10x20  
2023 Yr Blt  
AVB Roof

# SKETCH/AREA TABLE ADDENDUM

## SUBJECT INFO

File No.: 530031 Parcel No.: 082W19A 00900  
 Property Address: 6132 COATES DR SE  
 City: SALEM County: State: OR ZipCode: 97317  
 Owner:  
 Client: Client Address:  
 Appraiser Name: Inspection Date:

## SKETCH

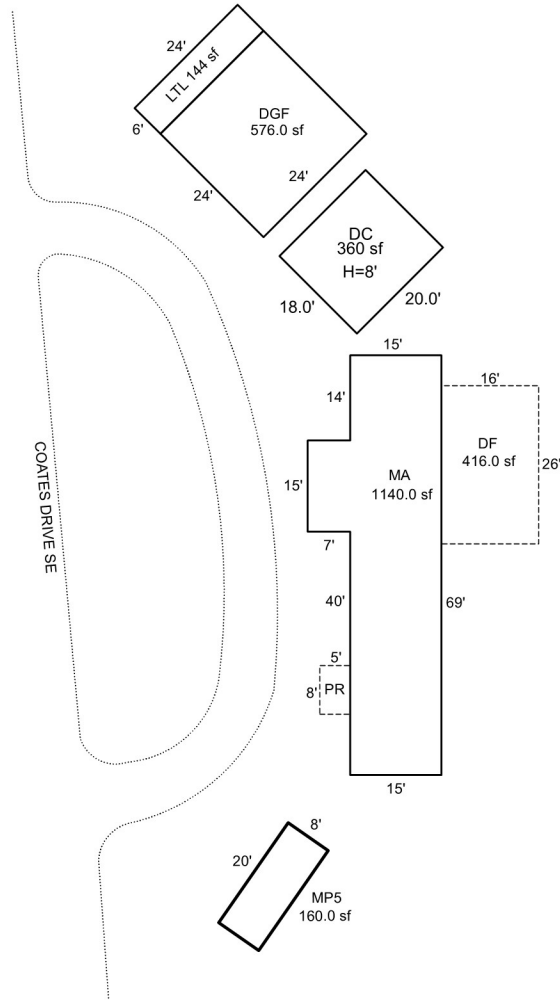

### AREA CALCULATIONS SUMMARY

| Code | Description | Factor | Net Size | Perimeter | Net Totals |
|------|-------------|--------|----------|-----------|------------|
| GBA1 | LTL         | 1.0    | 144.0    | 60.0      |            |
|      | MP5         | 1.0    | 160.0    | 56.0      |            |
|      | DC          | 1.0    | 360.0    | 76.0      | 664.0      |
| GLA1 | MA          | 1.0    | 1140.0   | 182.0     | 1140.0     |
| GAR  | DGF         | 1.0    | 576.0    | 96.0      | 576.0      |
| P/P  | DF          | 1.0    | 416.0    | 84.0      |            |
|      | PR          | 1.0    | 40.0     | 26.0      | 456.0      |

### COMMENT TABLE 1

APEX BY CE 12/5/08  
 UPDATED BY CJURAN 10/02/2023 23-006590 DC

### COMMENT TABLE 2

*L3 MDL 1/10/24*

### COMMENT TABLE 3

|              |     |   |           |       |
|--------------|-----|---|-----------|-------|
| Net LIVABLE  | cnt | 1 | (rounded) | 1,140 |
| Net BUILDING | cnt | 3 | (rounded) | 664   |









1/10/24