

Acct ID: 607418 MTL: 092E25D000800P2 Date: **1-4-24** Appr: **Genie** Prop Class: **450** RMV Prop Class: 450

Situs: 27760 NORTH SANTIAM HWY SE MILL CITY, OR 97360 MaSaNh: 01 06 000 Unit: 148054 Year: 2024

Last Date Appraised: Appraiser: Retag: **Y** N Tag info: 2024 - Tags/Permit (MS PLACEMENT)

Owner: **COBLE, GEORGE THOMAS** Roll Type: MS

Cycle **Tag** Sales Verification Other: Inspection level: 1 2 **3** 4 LCB TTO INSP AV: 0

RMV Land: 0 RMV Imp: 0 RMV Total: 0 MAV: 0 MSAV: 0 SAV: 0

Comment: **ADD MANUF RETAG FOR SKIRT**

Notations
No notation data available.

OSDs
No OSD data available.

Land
No land data available.

Improvements - Residence / Manufactured Structures

Bldg: 1 Code Area: 56440 Stat Class: 441 Year Blt: Eff Year Blt: Sq.Ft: 0 % Complete: 100
Desc: MANUF STRUCT, CLASS 4, 8'WIDE SINGLE Dimensions: RMV: 0
Func Obsc: 100 Econ %: 100 Other %: 100 Exception: 0 Adjust: Adjust RMV: 0

Floors
Type Class Display Group Floor Size Beds Baths Yr Blt Eff Yr Blt Inventory
No floor data available

Accessories
Description Class Size SqFt Eff Yr Blt RMV Quantity
No accessory data available

Improvements - Accessory Buildings
No improvement data available for all other stat class types.



1/4/24

SKETCH/AREA TABLE ADDENDUM

SUBJECT INFO

File No.: 607418	Parcel No.: 092E25D000800P2		
Property Address: 27760 NORTH SANTIAM HIGHWAY SE			
City: MILL CITY	County: MARION	State: OR	ZipCode: 97360
Owner:			
Client:		Client Address:	
Appraiser Name:		Inspection Date:	

SKETCH

607418
092E25D000800P2
SCALE = 1:40

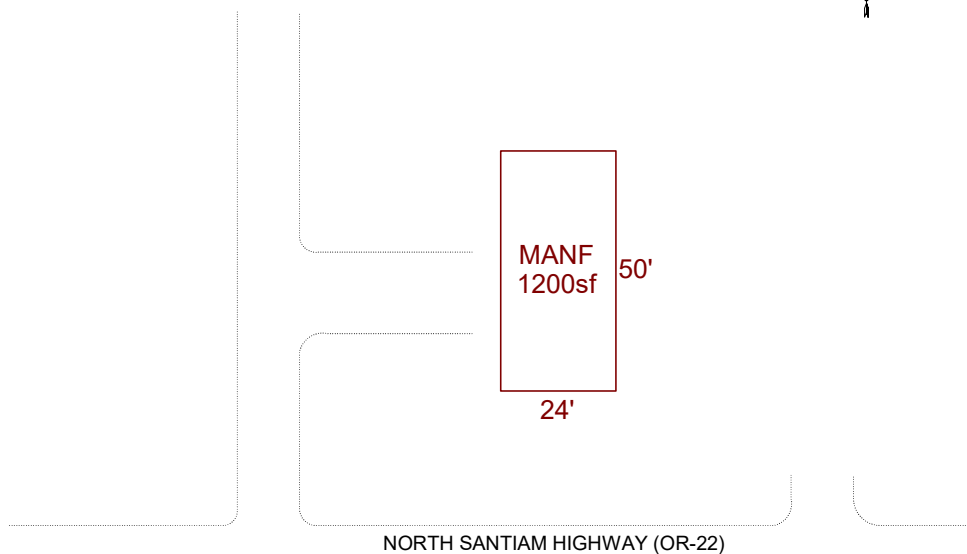

Sketch by Apex Sketch

AREA CALCULATIONS SUMMARY						COMMENT TABLE 1	
Code	Description	Factor	Net Size	Perimeter	Net Totals	APEX CREATED BY CJURAN 01/25/2024	
GLA	MANF	1.0	1200.0	148.0	1200.0		
						COMMENT TABLE 2	COMMENT TABLE 3
						CL 01/04/2024	TAGS L3
	Net LIVABLE	cnt	1	(rounded)	1,200		

ACCOUNT # 607418 DATE: 1-4-24 RMV CLASS _____ PROP CLASS 049
 MTL _____ APPR GENE TAG 0 N _____
 COMMENTS: _____ RETAG FOR SKIRT

RESIDENCE / MANUFACTURED STRUCTURES

ACCESSORY IMPROVEMENTS / OUTBUILDINGS

STAT 49 5 QLTY + - FLOOR MA
 AREA 1200 EFF AREA 1200 BED 3
 ROOF + HVAC +
 BATH PKG: 2 BATH BATH + 1/2 BTH
 FIREPLACE: _____
 KITCHEN - + NOV PRIC
 YR BLT 1997 EFF YR 1997 ECON _____
 % COMP 100 % GOOD _____ FUNC _____
 EXCEPT Y N LUMP SUM: _____
 MISC: _____
 YI CLASS _____ F G A E
 SKIRT - LIN FT _____
 COMMENT: MARLETTE

TYPE _____
 STAT / CLASS _____
 SIZE _____
 FAIR
 AVERAGE
 GOOD
 EXCELLENT
 BATH _____
 YR BLT _____
 EFF YR _____
 % COMP _____
 EXCEPT Y N
 MISC: _____
 COMMENT: _____

TYPE _____
 STAT / CLASS _____
 SIZE _____
 FAIR
 AVERAGE
 GOOD
 EXCELLENT
 BATH _____
 YR BLT _____
 EFF YR _____
 % COMP _____
 EXCEPT Y N
 MISC: _____
 COMMENT: _____

STAT _____ QLTY + - FLOOR _____
 AREA _____ EFF AREA _____ BED _____
 ROOF + HVAC +
 BATH PKG: _____ BATH BATH + 1/2 BTH
 FIREPLACE: _____
 KITCHEN - +
 YR BLT _____ EFF YR _____ ECON _____
 % COMP _____ % GOOD _____ FUNC _____
 EXCEPT Y N LUMP SUM: _____
 MISC: _____
 YI CLASS _____ F G A E
 SKIRT - LIN FT _____
 COMMENT: _____

TYPE _____
 STAT / CLASS _____
 SIZE _____
 FAIR
 AVERAGE
 GOOD
 EXCELLENT
 BATH _____
 YR BLT _____
 EFF YR _____
 % COMP _____
 EXCEPT Y N
 MISC: _____
 COMMENT: _____

TYPE _____
 STAT / CLASS _____
 SIZE _____
 FAIR
 AVERAGE
 GOOD
 EXCELLENT
 BATH _____
 YR BLT _____
 EFF YR _____
 % COMP _____
 EXCEPT Y N
 MISC: _____
 COMMENT: _____

STAT _____ QLTY + - FLOOR _____
 AREA _____ EFF AREA _____ BED _____
 ROOF + HVAC +
 BATH PKG: _____ BATH BATH + 1/2 BTH
 FIREPLACE: _____
 KITCHEN - +
 YR BLT _____ EFF YR _____ ECON _____
 % COMP _____ % GOOD _____ FUNC _____
 EXCEPT Y N LUMP SUM: _____
 MISC: _____
 YI CLASS _____ F G A E
 SKIRT - LIN FT _____
 COMMENT: _____

TYPE _____
 STAT / CLASS _____
 SIZE _____
 FAIR
 AVERAGE
 GOOD
 EXCELLENT
 BATH _____
 YR BLT _____
 EFF YR _____
 % COMP _____
 EXCEPT Y N
 MISC: _____
 COMMENT: _____

TYPE _____
 STAT / CLASS _____
 SIZE _____
 FAIR
 AVERAGE
 GOOD
 EXCELLENT
 BATH _____
 YR BLT _____
 EFF YR _____
 % COMP _____
 EXCEPT Y N
 MISC: _____
 COMMENT: _____