

606436
541285

INPUT 12-23
10-2023
6064

541285

Chris 3/22/24
Prop Class 049
RMV Class 049

ACCOUNT # _____ DATE: _____ RMV CLASS _____ PROP CLASS _____
MTL _____ APPR _____ TAG Y N _____
COMMENTS: _____

RESIDENCE / MANUFACTURED STRUCTURES

ACCESSORY IMPROVEMENTS / OUTBUILDINGS

STAT 5 QLTY + - FLOOR _____
 AREA 1620 EFF AREA 1620 BED 4
 ROOF + HVAC +
 BATH PKG: 2 BATH BATH + 1/2 BTH
 FIREPLACE: _____
 KITCHEN - + AVS
 YR BLT 2023 EFF YR 2023 ECON _____
 % COMP 100 % GOOD _____ FUNC _____
 EXCEPT Y N LUMP SUM: _____
 MISC: _____
 YI CLASS 0 F G A E
 SKIRT - WOOD LIN FT 174
 COMMENT: CLAYTON

STAT _____ QLTY + - FLOOR _____
 AREA _____ EFF AREA _____ BED _____
 ROOF + HVAC +
 BATH PKG: _____ BATH BATH + 1/2 BTH
 FIREPLACE: _____
 KITCHEN - +
 YR BLT _____ EFF YR _____ ECON _____
 % COMP _____ % GOOD _____ FUNC _____
 EXCEPT Y N LUMP SUM: _____
 MISC: _____
 YI CLASS _____ F G A E
 SKIRT - LIN FT _____
 COMMENT: _____

STAT _____ QLTY + - FLOOR _____
 AREA _____ EFF AREA _____ BED _____
 ROOF + HVAC +
 BATH PKG: _____ BATH BATH + 1/2 BTH
 FIREPLACE: _____
 KITCHEN - +
 YR BLT _____ EFF YR _____ ECON _____
 % COMP _____ % GOOD _____ FUNC _____
 EXCEPT Y N LUMP SUM: _____
 MISC: _____
 YI CLASS _____ F G A E
 SKIRT - LIN FT _____
 COMMENT: _____

TYPE _____
 STAT / CLASS _____
 SIZE _____
 FAIR _____
 AVERAGE _____
 GOOD _____
 EXCELLENT _____
 BATH _____
 YR BLT _____
 EFF YR _____
 % COMP _____
 EXCEPT Y N
 MISC: _____
 COMMENT: _____

TYPE _____
 STAT / CLASS _____
 SIZE _____
 FAIR _____
 AVERAGE _____
 GOOD _____
 EXCELLENT _____
 BATH _____
 YR BLT _____
 EFF YR _____
 % COMP _____
 EXCEPT Y N
 MISC: _____
 COMMENT: _____

TYPE _____
 STAT / CLASS _____
 SIZE _____
 FAIR _____
 AVERAGE _____
 GOOD _____
 EXCELLENT _____
 BATH _____
 YR BLT _____
 EFF YR _____
 % COMP _____
 EXCEPT Y N
 MISC: _____
 COMMENT: _____

TYPE HC
 STAT / CLASS 5
 SIZE BR40
 FAIR x2
 AVERAGE _____
 GOOD _____
 EXCELLENT _____
 BATH _____
 YR BLT 2015
 EFF YR _____
 % COMP 100
 EXCEPT Y N
 MISC: 10
 COMMENT: _____

TYPE _____
 STAT / CLASS _____
 SIZE _____
 FAIR _____
 AVERAGE _____
 GOOD _____
 EXCELLENT _____
 BATH _____
 YR BLT _____
 EFF YR _____
 % COMP _____
 EXCEPT Y N
 MISC: _____
 COMMENT: _____

TYPE _____
 STAT / CLASS _____
 SIZE _____
 FAIR _____
 AVERAGE _____
 GOOD _____
 EXCELLENT _____
 BATH _____
 YR BLT _____
 EFF YR _____
 % COMP _____
 EXCEPT Y N
 MISC: _____
 COMMENT: _____

SKETCH/AREA TABLE ADDENDUM

SUBJECT INFO

File No.: 541285 Parcel No.: 092E25D 00300
 Property Address: 27880 NORTH SANTIAM HY SE
 City: MILL CITY County: MARION State: OR ZipCode: 97360
 Owner:
 Client: Client Address:
 Appraiser Name: Inspection Date:

SKETCH

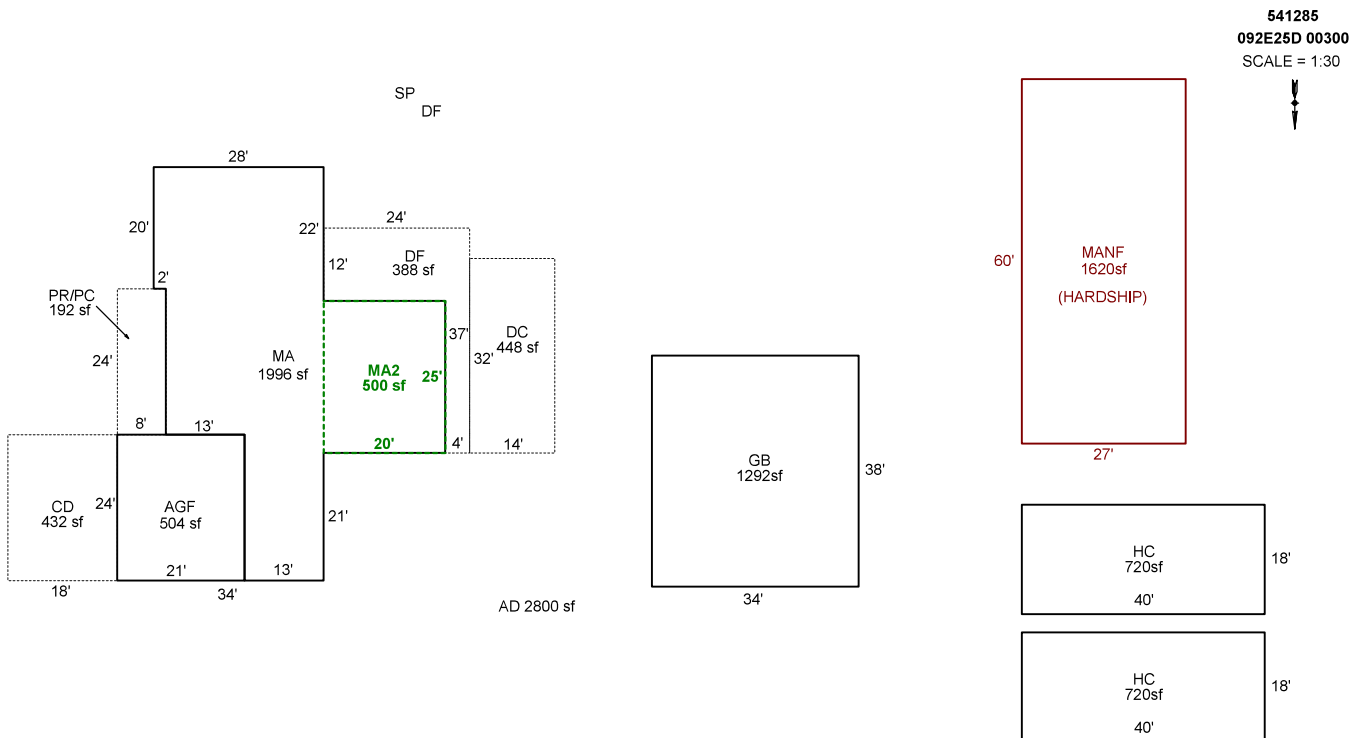

AREA CALCULATIONS SUMMARY

Code	Description	Factor	Net Size	Perimeter	Net Totals
GBA1	GB	1.0	1292.0	144.0	
	HC	1.0	720.0	116.0	
	HC	1.0	720.0	116.0	2732.0
GLA	MANF	1.0	1620.0	174.0	1620.0
GLA1	MA	1.0	1996.0	232.0	1996.0
GLA2	MA2	1.0	500.0	90.0	500.0
GAR	AGF	1.0	504.0	90.0	
	DC	1.0	448.0	92.0	952.0
P/P	CD	1.0	432.0	84.0	
	PR/PC	1.0	192.0	64.0	
	DF	1.0	388.0	122.0	1012.0
	Net LIVABLE	cnt	3 (rounded)		4,116
	Net BUILDING	cnt	3 (rounded)		2,732

COMMENT TABLE 1

DRAWN BY JRONDEMA 8/29/18
 UPDATED BY CJURAN 05/08/2023 555-23-000777
 UPDATED BY CJURAN 10/04/2023
 UPDATED BY CJURAN 12/04/2023

COMMENT TABLE 2

CL 10/02/2023

COMMENT TABLE 3

TAGS L3



Manuf Rear 10/2/23



Manuf Front 10/2/23