

Acct ID: 132307 MTL: 083W23A002200P1 Date: **10/3/24** Appr: **ZH** Prop Class: 019 RMV Prop Class: 019

Situs: 2120 ROBINS LN SE # 48 SALEM, OR 97306 MaSaNh: 17 05 004 Unit: 143129 Year: ~~2024~~

Last Date Appraised: 09/14/2015 Appraiser: THERESA SWEARINGEN Retag: Y N Tag info:

2025-26

Owner: LOWRANCE FAMILY TRUST

Roll Type: MS

Cycle Tag Sales Verification Other: _____ Inspection level: 1 **2** 3 4 LCB **ITO** INSP **No MLS #** AV: 107180

RMV Land: 0 RMV Imp: 155170 RMV Total: 155170 MAV: 107180 MSAV: 0 SAV: 0

Comment: TERRACE LAKE, SPACE #48, MS SERIAL # CE11136, X # X00218630, PERSONAL MS

UPDATE INVENTORY w/o EXCEPTION

Notations

No notation data available.

OSDs

No OSD data available.

Land

No land data available.

Improvements - Residence / Manufactured Structures

1994 = GOMAR

Bldg: 1 Code Area: 24010 Stat Class: 467 Year Blt: 1992 Eff Year Blt: ~~1992~~ Sq.Ft: 1413 % Complete: 100

Desc: MANUF STRUCT, CLASS 6, 26' THROUGH 28' WIDE DOUBLE

Dimensions: RMV: 155170

Func Obsc: 100 Econ %: 100 Other %: 100 Exception: 0 Adjust: Adjust RMV: 0

Floors

Type	Class	Display Group	Floor Size	Beds	Baths	Yr Blt	Eff Yr Blt	Inventory	Exception: Y N
First Floor	6	Finished	1413	2	FB-2	1992	1992	BATH - 2, KIT, HVAC+, ROOF+, SKRT+	<input checked="" type="radio"/>
Garage Attached		Unfinished	560	0	0	1992	1992	ROOF	<input checked="" type="radio"/>

Accessories

4(LAS)

1994

Description	Class	Size SqFt	Eff Yr Blt	RMV	Quantity	Exception: Y N
DECK	6	952	1992	5522	0	

Improvements - Accessory Buildings

No improvement data available for all other stat class types.

- CONFIRM EYB OF HOME & GAR.
- NEWER ROOF PRIOR TO LAST CYCLE (LOOKS GOOD)
- TALKED TO OWNER - REAR PR HAS BEEN ON SITE SINCE 2008 WHEN SHE MOVED IN.
- WELL MAINTAINED - EXT. PAINT LOOKS GOOD ALSO

Segment	PR
Class	
Dimensions/Size	168
Foundation	
Exterior Wall	
Interior Finish	
Roof Cover	ROOF
Roof Style	
Flooring	
Plumbing	
Heat	
Electric	
Misc.	
Year Built	2007
Eff. Year	2001
Condition	
% Complete	
Lump Sum	
Exception Code	E/D



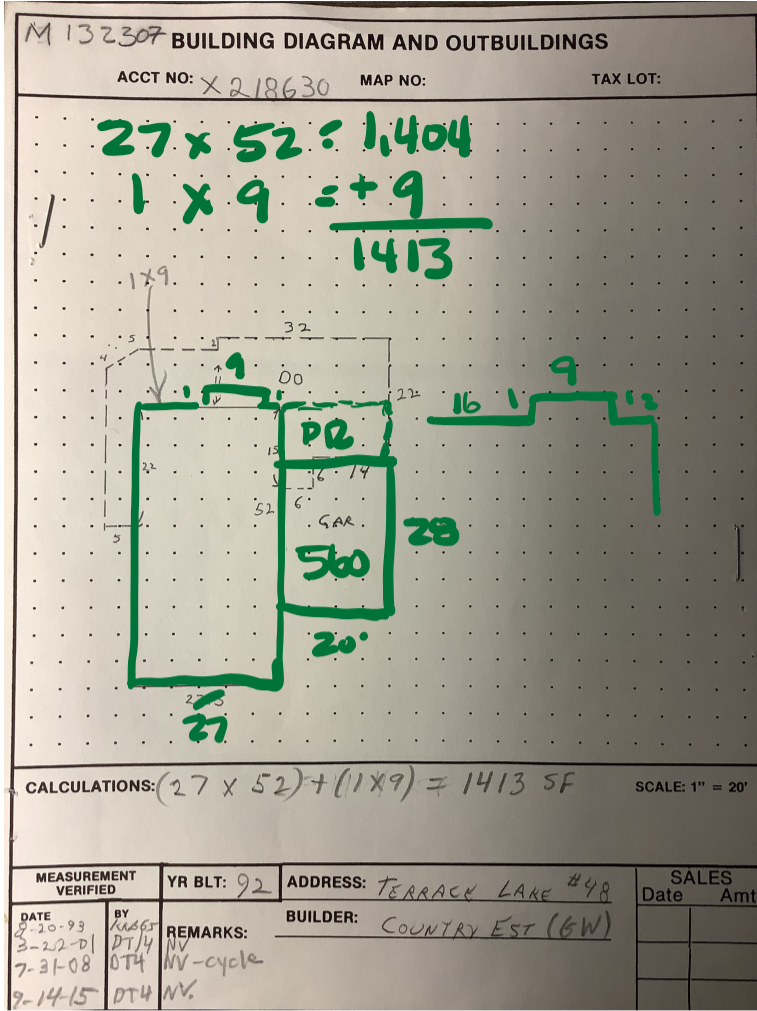

M132307 083W23A 02200 Appr #: DT4 Date 9-14-15 Prop Class 019 Prop Code T67 20
 Situs Address 2120 ROBINS LN SE, #48 Franchise Code 04 Year For: 2015-2016
 Owner LOWRANCE, JAMES V & 2016-17
 Notes: Inventory update 6/6+

RMV Imp: 70,270 RMV Total: 70,270 M50 Total: 70,270

Seg. Type	MA	Seg. #	1.1	Method	M04	Class	6D	Area	1404	Eff Area	1413	Length	27	Width	52		
Make:	GOLDENWEST		Model:	COUNTRY ESTATE		Intfinish:	DRYWL		Roof Cover:	ARCOMP		Bedrooms:	2				
Plumbing:	BATH2		Heat:	HP		Fireplace:			Inter. Comp:	RNG;DW;DSP;MICRO		Cond.:	P F A G E				
Year Built:	1992		Eff. Year Built:	1992		Adj Codes:	MSLCMD		Qty:	6		% Comp:	Func:		Econ:	RMV	39,970
Lump Sum:			Except Code/Year:			Comments:	Vinyl Siding										

Seg. Type	AGU	Seg. #	1.4	Method	R05	Class	3	Area	560	Eff Area	560	Length	28	Width	20		
Make:			Model:			Intfinish:			Roof Cover:	ARCOMP		Bedrooms:					
Plumbing:			Heat:			Fireplace:			Inter. Comp:			Cond.:	P F A G E				
Year Built:	1992		Eff. Year Built:	1992		Adj Codes:	RLCM3		Qty:			% Comp:	Func:		Econ:	RMV	22,660
Lump Sum:			Except Code/Year:			Comments:											

Accessory Improvements

Seg. Type	DF	MFD STRUCT	Seg. #	1.3	Method:	R05	Class	Area	952	Eff Area	952			
Length			Width			Foundation			Ex. Wall	Roof Cover				
Roof Style			Floor			Plumbing			Elect.	Yr. Blt. 1992				
Year Built:	1992		Eff. Year Built:	1992		Cond.:	P F A G E		% Comp:	Econ:		RMV:	6,040	
Lump Sum:			Except Code/Year:			Comments:								

Out Buildings and Skirting

Seg. Type	MHSK	MFD STRUCT	Seg. #	1.2	Method:	M04	Class	Area	158	Eff Area	158			
Length			Width			Foundation			Ex. Wall	BRICK				
Roof Style			Floor			Plumbing			Elect.	Yr. Blt. 1992				
Year Built:	1992		Eff. Year Built:	1992		Cond.:	P F A G E		% Comp:	Econ:		RMV:	1,600	
Lump Sum:			Except Code/Year:			Comments:								

