

Summary Lead Appr: \_\_\_\_\_ Clerk: **lak 11.4.24** Lead Clerk: \_\_\_\_\_ Appr: \_\_\_\_\_ Print Date: \_\_\_\_\_

Acct ID: 134031 MTL: 083W23A000600P1 Date: **10-1-24** Appr: **02** ts **11-4-24** 9/24/2024

Situs: 2155 ROBINS LN SE # 2 SALEM, OR 97306 MaSaNh: 17 05 000 Unit: 143915 Year: **2024** RMV Prop Class: 019

Last Date Appraised: 08/10/2015 Appraiser: THERESA SWEARINGEN Retag: Y N Tag info: \_\_\_\_\_

Owner: ARBUCKLE, KATHY M Roll Type: MS

Cycle Tag Sales Verification Other: \_\_\_\_\_ Inspection level: 1 2 **3** 4 LCB TTO INSP AV: 51870

RMV Land: 0 RMV Imp: 102290 RMV Total: 102290 MAV: 51870 MSAV: 0 SAV: 0

Comment: Uncoded accessory clean-up 5/1/23 AG

**2526**

**Notations**

No notation data available.

**update RMV D/O**

**OSDs**

No OSD data available.

**Land**

No land data available.

**Improvements - Residence / Manufactured Structures**

Bldg: 1 Code Area: 24010 Stat Class: 467 Year Blt: 1997 Eff Year Blt: 1997 Sq.Ft: 1337 % Complete: 100

Desc: MANUF STRUCT, CLASS 6, 26' THROUGH 28' WIDE DOUBLE Dimensions: RMV: 102290

Func Obsc: 100 Econ %: 100 Other %: 100 Exception: 0 Adjust: Adjust RMV: 0

**Floors**

Type	Class	Display Group	Floor Size	Beds	Baths	Yr Blt	Eff Yr Blt	Inventory	Exception: Y N
First Floor	6	Finished	1337	3	FB-2	1997	1997	BATH - 2, KIT-, HVAC, ROOF+, SKIRT	Y N

**Accessories**

Description	Class	Size SqFt	Eff Yr Blt	RMV	Quantity	Exception: Y N
DECK	6	120	1997	1056	0	Exception: Y N
MULTI-PURPOSE BUILDING	6	80	1997	<del>1268</del> <b>0</b>	0	Exception: Y N
ROOF EXTENSION OR PATIO COVER	6	324	1997	3758	0	Exception: Y N

**Improvements - Accessory Buildings**

No improvement data available for all other stat class types.



**Trim needs paint**



M134031 8-10-15

# BUILDING DIAGRAM AND OUTBUILDINGS

ACCT NO: M/34031 MAP NO:

TAX LOT:

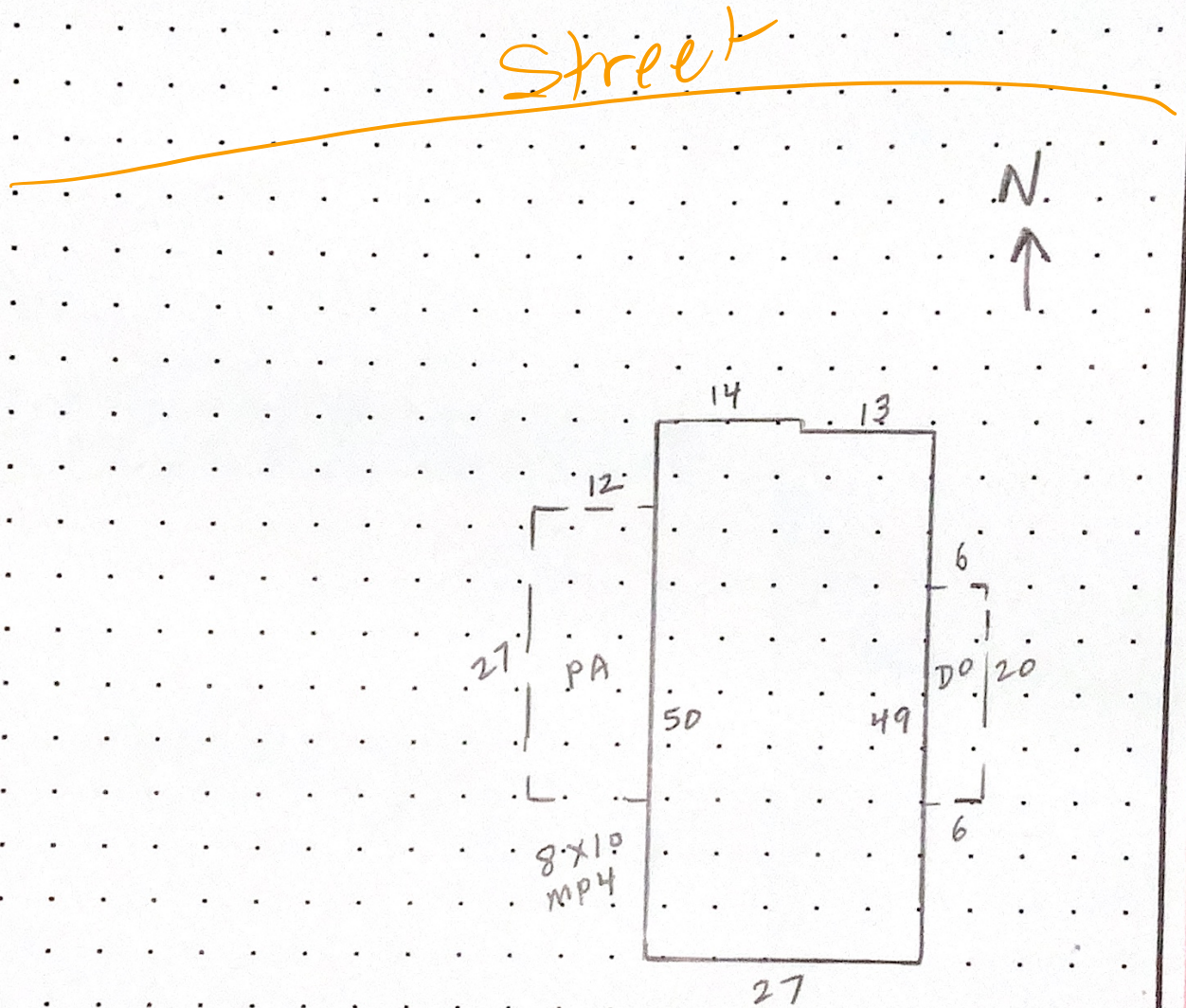

CALCULATIONS:  $(27 \times 50) - (1 \times 13) = 1337 \text{ SF.}$

SCALE: 1" = 20'

OAK HOLLOW - SP. 2

MEASUREMENT VERIFIED		YR BLT: <u>98</u>	ADDRESS: <u>2155 Robins Ln. S.E</u>	SALES			
DATE	BY	REMARKS:	BUILDER: <u>Silver crest Westwood</u>	Date	Amt.		
<u>9-10-98</u>	<u>DT/4</u>						
<u>8-10-15</u>	<u>DT4</u>			<u>NV. cycle</u>			

M134031 083W23A 00600 Appr #: DT4 Date 8-10-15 Prop Class 019 - purple trim - pic. Prop Code T67

Situs Address 2155 ROBINS LN SE, #2 Franchise Code 04 Year For: 2015-2016

Owner ARBUCKLE, KATHY M

22

Notes: Inventory update - appr judgement

RMV Imp: 29,130 RMV Total: 29,130 M50 Total: 29,130

Seg.Type MA Seg. # 1.1 Method M04 Class 6D Area 1337 Eff Area 1337 Length Width  
 Make: SILVERCREST Model: WESTWOOD Intfinish: TAPE/TEX Roof Cover COMP ACMP  
 Plumbing BATH2 Heat: FA Fireplace: Inter. Comp: DW;H&F Bedrooms: 3  
 Year Built 1997 Eff. Year Built 1997 Cond. P F A G E  
 Adj Codes MSLCMD;MSD OLTY Qty 6 % Comp \_\_\_ Func \_\_\_ Econ \_\_\_ RMV 25,380  
 Lump Sum \_\_\_ Except Code/Year \_\_\_ Comments \_\_\_

**Accessory Improvements**

Seg.Type PA MFD STRUCT Seg. # 1.3 Method: R05 Class Area 324 Eff Area 324  
 Length 27 Width 12 Foundation Ex. Wall Roof Cover METAL  
 Roof Style Floor Plumbing  
 Year Built 1998 Eff. Year Built: 1998 Cond. P F A G E % Comp \_\_\_ Econ \_\_\_ RMV: 2,440  
 Lump Sum \_\_\_ Except Code/Year \_\_\_ Comments \_\_\_

Seg.Type DF MFD STRUCT Seg. # 1.4 Method: R05 Class Area 120 Eff Area 120  
 Length 20 Width 6 Foundation Ex. Wall Roof Cover  
 Roof Style Floor Plumbing  
 Year Built 1998 Eff. Year Built: 1998 Cond. P F A G E % Comp \_\_\_ Econ \_\_\_ RMV: 600  
 Lump Sum \_\_\_ Except Code/Year \_\_\_ Comments \_\_\_

**Out Buildings and Skirting**

Seg.Type MHSK MFD STRUCT Seg. # 1.2 Method: M04 Class Area 154 Eff Area 154  
 Length Width Foundation Ex. Wall WOOD Roof Cover  
 Roof Style Floor Plumbing  
 Heat Int. Comp. Elect. Yr. Blt. 1997 Eff. Yr. Blt: 1997  
 Cond. P F A G E Adj. Codes % Comp \_\_\_ Func \_\_\_ Econ \_\_\_ RMV: 710  
 Lump Sum \_\_\_ Except Code/Year \_\_\_ Comments \_\_\_

Seg.Type MP MULTIPURPOSE B Seg. # 2.1 Method: F;F Class 4 Area 80 Eff Area 80  
 Length 10 Width 8 Foundation Ex. Wall Roof Cover COMP  
 Roof Style Floor DIRT Plumbing  
 Heat Int. Comp. Elect. Yr. Blt. 1998 Eff. Yr. Blt: 1998  
 Cond. P F A G E Adj. Codes FLCM % Comp \_\_\_ Func \_\_\_ Econ \_\_\_ RMV: 0  
 Lump Sum \_\_\_ Except Code/Year \_\_\_ Comments \_\_\_