

APEXED BY LK 8.14.24

lak 7.26.24

Summary Lead Appr: Clerk: Lead Clerk: Appr: ZH 8/7/24 Print Date: 6/10/2024

Acct ID: 132871 MTL: 062W17AD00200P1 Date: 6/14/24 Appr: ZH Prop Class: 019 RMV Prop Class: 019

Situs: 9195 PORTLAND RD NE # 22 SALEM, OR 97305 MaSaNh: 13 05 002 Unit: 143398 Year: 2024

Last Date Appraised: 08/24/2011 Appraiser: THERESA SWEARINGEN Retag: Y N Tag info:

Owner: COSTUMBRE,CRISTINA & COSTUMBRE,JOSE LUIS

Roll Type: MS

Tag Sales Verification Other: Inspection level: 1 2 3 4 LCB TTO INSP AV: 30960

RMV Land: 0 RMV Imp: 31990 RMV Total: 31990 MAV: 30960 MSAV: 0 SAV: 0

Comment: GREEN OAKS MOBILE PARK, SPACE #22, MS SERIAL # 09L28212, X # X00229873, Home ID 277906, PERSONAL MS

No  
MLS #

# UPDATE INVENTORY & EYB w/o EXCEPTION

Notations No notation data available.

OSDs No OSD data available.

Land No land data available.

## Improvements - Residence / Manufactured Structures

1996 = GOMAR

Bldg: 1 Code Area: 02410 Stat Class: 444 Year Blt: 1994 Eff Year Blt: 1994 Sq.Ft: 924 % Complete: 100  
Desc: MANUF STRUCT, CLASS 4, 14' WIDE SINGLE Dimensions: 66x14 RMV: 31990  
Func Obsc: 100 Econ %: 100 Other %: 100 Exception: 0 Adjust: Adjust RMV: 0

### Floors

Type	Class	Display Group	Floor Size	Beds	Baths	Yr Blt	Eff Yr Blt	Inventory	Exception
First Floor	4	Finished	924	2	FB-2	1994	1994	BATH - 2, KIT, ROOF, SKIRT	Y N

HVAC ROOF+

### Accessories

Description	Class	Size SqFt	Eff Yr Blt	RMV	Quantity	Exception
DECK - PATIO	4	460	1994	479	0	Exception: Y N
ROOF EXTENSION OR PATIO COVER	4	320	1994	1856	0	Exception: Y N

### Improvements - Accessory Buildings

No improvement data available for all other stat class types.

- CHECK HVAC
- ROOF ARCH. COMP.
- PATIO WAS WHAT PRIOR DECK WAS BUILT ON (MAY BE OLDER, BUT CANT CONFIRM)

- NEWER
- EXT. PAINT
- ROOF

Segment	GS	PC
Class		
Dimensions/Size	120	460
Foundation		
Exterior Wall		
Interior Finish		
Roof Cover	ROOF	
Roof Style		
Flooring		
Plumbing		
Heat		
Electric		
Misc.		
Year Built	2019	1994
Eff. Year	2019	
Condition		
% Complete		
Lump Sum		
Exception Code	NEW	I/O

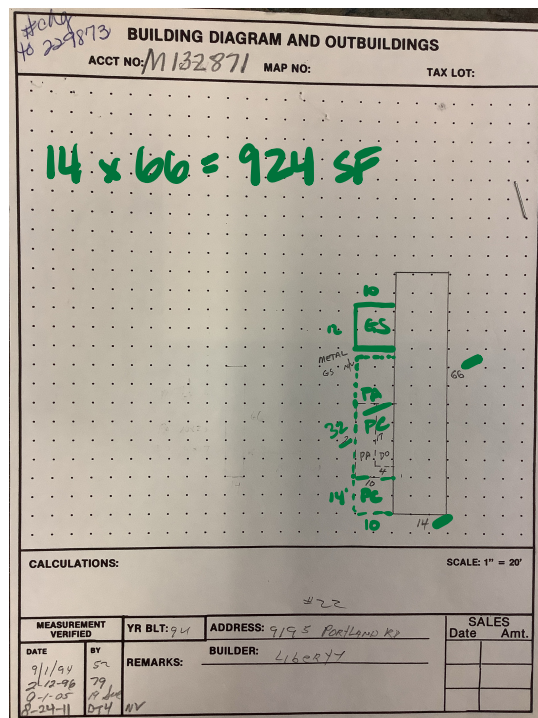

M132871	062W17AD00200	Appr # 0114	Date 8-24-11	Prop Class 019	Franchise Code 04	Year For: 2011-2012
Situs Address 9195 PORTLAND RD NE, #22						
Owner COSTUMBRE,CRISTINA &						
Tags Cycle Sales Verification Other: Inventory update						
RMV Imp: 14,270		RMV Total: 14,270		MSO Total: 14,270		
Seg.Type MA	Seg. # 1.1	Method M04	Class 445	Area 924	Eff Area 924	Length 66 Width 14
Make: LIBERTY	Model:	Intfinish: GYPSUM	Roof Cover COMP			
Plumbing BATH2	Heat FA	Fireplace	Inter. Comp: RNG;H&F	Bedrooms 2		
Year Built 1994	Eff. Year Built 1994	Cond. P F A G E				
Adj Codes MSLCMS	Qty 9	% Comp	Func	Econ	RMV 12,370	
Lump Sum	Except Code/Year	Comments				
<b>Accessory Improvements</b>						
Seg.Type PA	Seg. # 1.3	Method: R05	Class	Area 200	Eff Area 200	
Length 20	Width 10					
Year Built	Eff. Year Built: 1994	Cond. P F A G E	% Comp	Econ	RMV: 1,110	
Lump Sum	Except Code/Year	Comments				
Seg.Type DF	Seg. # 1.4	Method: R05	Class	Area 68	Eff Area 68	
Length 17	Width 4					
Year Built	Eff. Year Built: 1994	Cond. P F A G E	% Comp	Econ	RMV: 250	
Lump Sum	Except Code/Year	Comments				
<b>Out Buildings and Skirting</b>						
Seg.Type MHSK	Seg. # 1.2	Method: M04	Class	Area 160	Eff Area 160	
Length	Width	Foundation	Ex. Wall WOOD	Roof Cover		
Roof Style	Floor	Plumbing	Elect.	Yr. Blt. 1994	Eff. Yr. Blt: 1994	
Heat	Int. Comp.	% Comp	Func	Econ	RMV: 540	
Cond. P F A G E	Adj. Codes					
Lump Sum	Except Code/Year	Comments				







