

Acct ID: 125959 MTL: 061W34BA00400P1 Date: *5/1/24* Appr: *SA* Prop Class: 019 RMV Prop Class: 019

Situs: 1418 PINE ST NE # 4 SILVERTON, OR 97381 MaSaNh: 12 05 000 Unit: 125959 Year: 2024

Last Date Appraised: 07/18/2011 Appraiser: THERESA SWEARINGEN Retag: *0* N Tag info: *Add Remodel tag 1/25* ✓

Owner: COCHRAN,PATRICIA E & COCHRAN,JEM ELWELL Roll Type: MS

Cycle Tag Sales Verification Other: _____ Inspection level: 1 2 *3* 4 LCB TTO INSP AV: 21150

RMV Land: 0 RMV Imp: 23580 RMV Total: 23580 MAV: 21150 MSAV: 0 SAV: *0 X*

Comment: STARDUST VILLAGE, SPACE #4, MS SERIAL # 26KS44241777, X # X00108663, Home ID 185748, PERSONAL MS

update inventory.

Notations

No notation data available.

OSDs

No OSD data available.

Land

No land data available.

Improvements - Residence / Manufactured Structures

1965 DM

Bldg: 1 Code Area: 04020 Stat Class: 456 Year Blt: 1971 Eff Year Blt: *1971* Sq.Ft: 960 % Complete: 100

Desc: MANUF STRUCT, CLASS 5, 24' WIDE DOUBLE Dimensions: 40x24 RMV: 23580

Func Obsc: 100 Econ %: 100 Other %: 100 Exception: 0 Adjust: Adjust RMV: 0

Floors

Type	Class	Display Group	Floor Size	Beds	Baths	Yr Blt	Eff Yr Blt	Inventory	Exception: Y N
First Floor	5	Finished	960	2	FB-2	1971	<i>1971</i>	SKIRT, ROOF, HVAC+, KIT-, BATH - 2	Y N

Accessories

Description	Class	Size SqFt	Eff Yr Blt	RMV	Quantity	Exception: Y N
ENCLOSED PORCH	3	128	1971	768	0	Y N
ROOF EXTENSION OR PATIO COVER	5	448	1971	2598	0	Y N

Improvements - Accessory Buildings

No improvement data available for all other stat class types.



toilets, flooring LVP outside.

good rot needs paint over grown bushes

BUILDING DIAGRAM AND OUTBUILDINGS

ACCT NO: **M125959**

MAP NO:

TAX LOT:

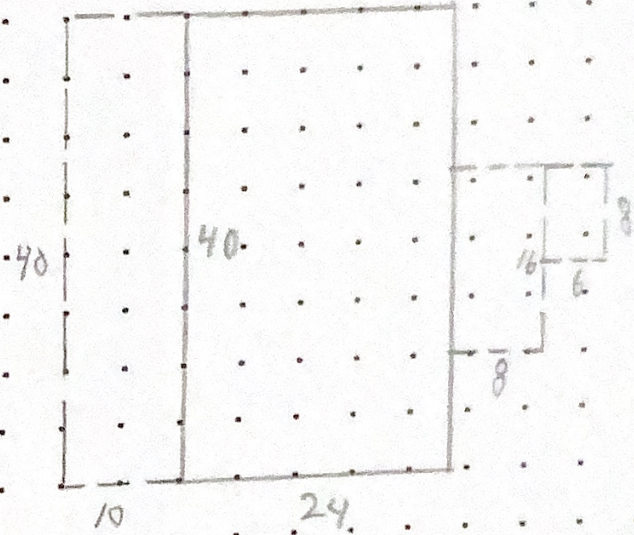

CALCULATIONS:

SCALE: 1" = 20'

MEASUREMENT VERIFIED

YR BLT: **71**

ADDRESS: **STAROUST #4**

SALES
Date Amt.

DATE
1-21-93
5-4-05
7-18-11

BY
LKB 65
20
DTY

REMARKS:
NV
NV.

BUILDER: **STATLER (GUERDON)**

Date	Amt.