

Acct ID: 334673 MTL: 063W130001900P1 Date: **6/14/24** Appr: **GRH** Prop Class: 049 RMV Prop Class: 049

Situs: 3210 BROOKLAKE RD NE SALEM, OR 97303 MaSaNh: 04 06 000 Unit: 334673 Year: 2024

Last Date Appraised: 04/20/2020 Appraiser: GERARDO RAMIREZ HERNANDEZ Retag: Y N Tag info:

Owner: SODBUSTER FARMS INC & WEATHERS, DOUGLAS J Roll Type: MS

Cycle Tag Sales Verification Other: \_\_\_\_\_ Inspection level: 1 2 3 4 LCB TTO INSP AV: 102000

RMV Land: 0 RMV Imp: 116960 RMV Total: 116960 MAV: 102000 MSAV: 0 SAV: 0

Comment: MFD STRUCT SERIAL # 2T910539NABC, X # X00258285 ON REAL ACCT 063W13 01900, PERSONAL MS

**Notations**

*No change*

INPUT GRH 07.22.24

RP/MS	Code	Description
MS	ZONED	FARM EFU ZONED

**OSDs**

No OSD data available.

**Land**

No land data available.

**Improvements - Residence / Manufactured Structures**

Bldg: 1 Code Area: 01410 Stat Class: 457 Year Blt: 2000 Eff Year Blt: 2000 Sq.Ft: 2387 % Complete: 100  
 Desc: MANUF STRUCT, CLASS 5, 26' THROUGH 28' WIDE DOUBLE Dimensions: RMV: 116960  
 Func Obsc: 100 Econ %: 100 Other %: 100 Exception: 0 Adjust: Adjust RMV: 0

*w/c*

**Floors**

Type	Class	Display Group	Floor Size	Beds	Baths	Yr Blt	Eff Yr Blt	Inventory	Exception: Y N
First Floor	5	Finished	2387	3	FB-3	2000	2000	BATH - 3, FP - 1, KIT+, HVAC+, ROOF, SKRT+	Y N

**Accessories**

Description	Class	Size SqFt	Eff Yr Blt	RMV	Quantity	Exception: Y N
DECK	5	260	2000	2803	0	Y N
DECK	5	815	2000	7987	0	Y N
ROOF EXTENSION OR PATIO COVER	5	260	2000	3695	0	Y N

**Improvements - Accessory Buildings**

No improvement data available for all other stat class types.



MH



REAR MH

# SKETCH/AREA TABLE ADDENDUM

Parcel No 063W13 01900

File No R19505

SUBJECT	Property Address 3210 BROOKLAKE RD NE		
	City SALEM	State OR	Zip 97303
	Owner		
	Client		
	Appraiser Name		

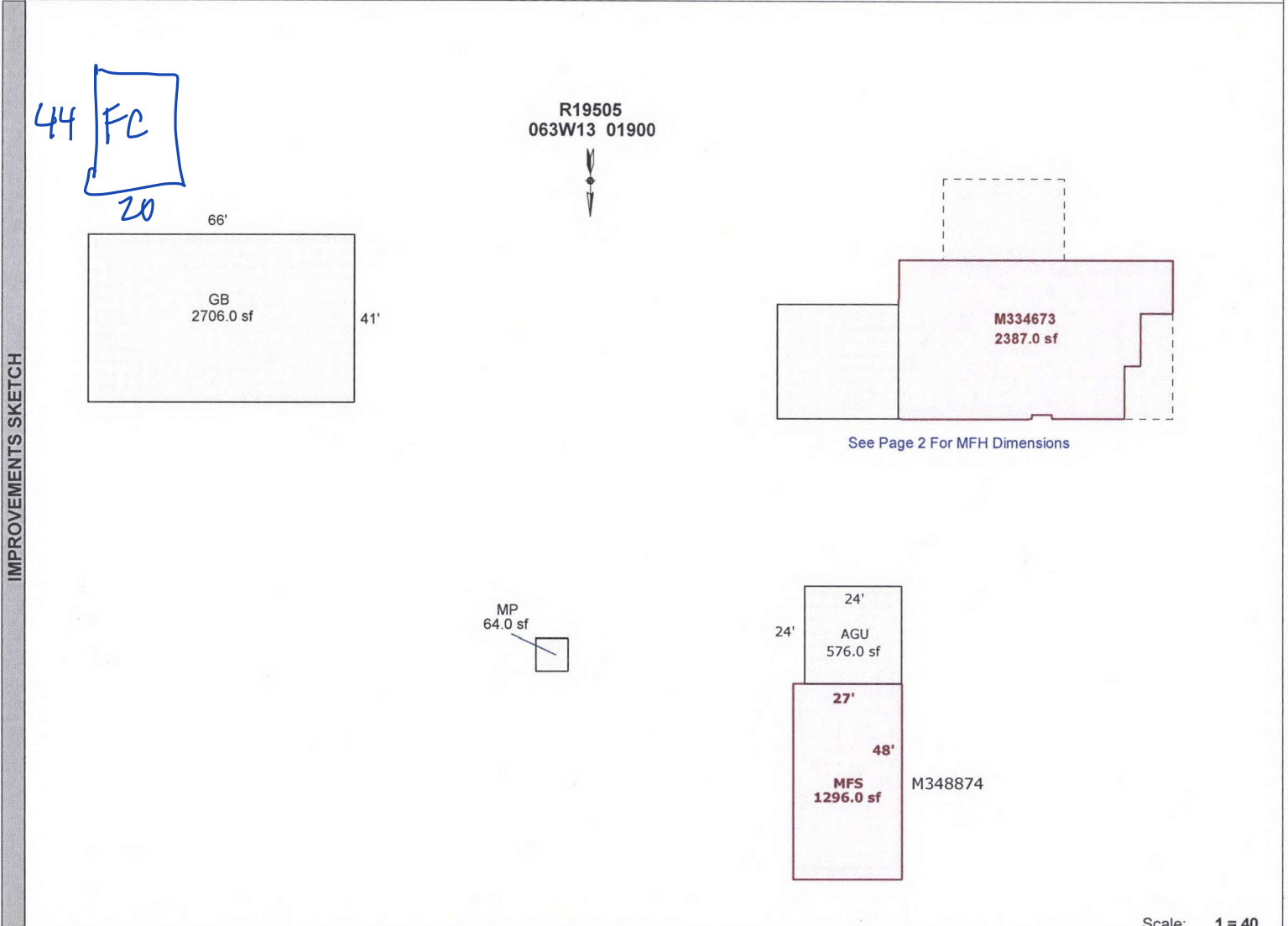

Scale: 1 = 40

AREA CALCULATIONS	AREA CALCULATIONS SUMMARY						Comment Table 1		
	Code	Description	Factor	Net Size	Perimeter	Net Totals	APEX BY CE 9/22/10 Updated to remove old MFS and add new MFS/AGU 1/		
	GLA1	MFS	1.00	1296.0	150.0	1296.0			
	GBA1	MP	1.00	64.0	32.0				
		GB	1.00	2706.0	214.0	2770.0			
GAR	AGU	1.00	576.0	96.0	576.0				
P/P	PR/DW	1.00	260.0	76.0					
	DW	1.00	600.0	100.0	860.0	Comment Table 2    Comment Table 3			
OTH	M334673	1.00	2387.0	216.0	2387.0	GRH 6/14/24 Cycle L2			
					Net LIVABLE Area	(rounded w/ factors)	1296		
					Net BUILDING Area	(rounded w/ factors)	2770		