

Acct ID: 538957 MTL: 071E27D001000 Date: **8/8/24** Appr: **GRH/WW** Prop Class: 921 RMV Prop Class: 451
 Situs: 365 LOAR RD SE SILVERTON OR 97381 MaSaNh: 03 06 000 Unit: 26932 Year: 2024

Last Date Appraised: 02/22/2028 Appraiser: MATTHEW HAMILTON Retag: **Y** Tag info: _____
 Owner: SILVER FALLS SCHOOL DIST 4J Roll Type: R
 Cycle Tag Sales Verification Other: _____ Inspection level: **0** 1 2 3 4 LCB TTO INSP AV: 0
 RMV Land: 247490 RMV Imp: 3565230 RMV Total: 3812720 MAV: 0 MSAV: 0 SAV: 0
 Comment: _____

Notations
 No notation data available.

OSDs
 No OSD data available.

Land
 Site: 1 Code Area: 04480 Size: 2.51 Acres Use Code: 005 Zone: REST SAV Use: _____ Exception: 0
 Class: Value Source: Rural Restrictive Description: _____ RMV: 247490 Exception: Y N
 Adjustment(s): _____ Fire Patrol: _____ Description: _____
 Comments: . 05-06: RECALC SETUP: APPR RR 17; 05-12-04.

Improvements - Residence / Manufactured Structures
 Bldg: 3 Code Area: 04480 Stat Class: **1321** Year Blt: **FC** Eff Year Blt: _____ Sq.Ft: 0 % Complete: 100
 Desc: Residential Other Improvements Dimensions: _____ RMV: 8480
 Func Obsc: 100 Econ %: 100 Other %: 100 Exception: 0 Adjust: _____ Adjust RMV: 0

Floors
 Type Class Display Group Floor Size Beds Baths Yr Blt Eff Yr Blt Inventory **chg to FC**
 No floor data available

Accessories
 Description **FC** Class Size SqFt Eff Yr Blt RMV Quantity
 GARDEN GREENHOUSE 1 600 0 6953 1 Exception: Y N

Bldg: 4 Code Area: 04480 Stat Class: **1360** Year Blt: _____ Eff Year Blt: _____ Sq.Ft: 0 % Complete: 100
 Desc: Residential Other Improvements **music library** Dimensions: _____ RMV: 529080
 Func Obsc: 100 Econ %: 100 Other %: 100 Exception: 0 Adjust: _____ Adjust RMV: 0

Floors
 Type Class Display Group Floor Size Beds Baths Yr Blt Eff Yr Blt Inventory **Height: 12 Ft**
 No floor data available **class D low**

Accessories
 Description Class Size SqFt Eff Yr Blt RMV Quantity
 MISCELLANEOUS 0 3708 0 433670 1 Exception: Y N

Improvements - Accessory Buildings
 Bldg: 1 Code Area: 04480 Stat Class: **358** Year Blt: _____ Eff Year Blt: _____ Sq.Ft: 7660 % Complete: 100
 Desc: Utility Building (UB) **Gym** Dimensions: _____ RMV: 751290
 Func Obsc: 100 Econ %: 100 Other %: 100 Exception: 0 Adjust: _____ Adjust RMV: 0

Floors
 Type Class Display Group Floor Size Beds Baths Yr Blt Eff Yr Blt Inventory **Height - 24 Ft**
 Utility Building 4 Finished 7660 0 0 0 0 Exception: Y N

Accessories
 Description Class Size SqFt Eff Yr Blt RMV Quantity
 No accessory data available

Bldg: 2 Code Area: 04480 Stat Class: 820 Year Blt: _____ Eff Year Blt: _____ Sq.Ft: 10 % Complete: 100
 Desc: OTHER SCHOOLS Dimensions: _____ RMV: 1434190
 Func Obsc: 100 Econ %: 100 Other %: 100 Exception: 0 Adjust: _____ Adjust RMV: 0

Floors
 Type Class Display Group Floor Size Beds Baths Yr Blt Eff Yr Blt Inventory
 No floor data available

Accessories

| Description | Class | Size SqFt | Eff Yr Blt | RMV | Quantity |
|--|-------|-----------|-------------------------|-------------------------|-----------------|
| No accessory data available | | | | | |
| Bldg: 5 Code Area: 04480 Stat Class: 352 | | | Year Blt: Eff Year Blt: | Sq.Ft: 2880 | % Complete: 100 |
| Desc: Utility Building (UB) | | | Exception: 0 | Dimensions: RMV: 407660 | |
| Func Obsc: 100 Econ %: 100 Other %: 100 | | | Adjust: | Adjust RMV: 0 | |

35b - classroom

Height: 13 Ft

Floors

| Type | Class | Display Group | Floor Size | Beds | Baths | Yr Blt | Eff Yr Blt | Inventory | Exception: Y N |
|------------------|-------|---------------|------------|------|-------|--------|------------|-----------|----------------|
| Utility Building | 4 | Finished | 2880 | 0 | 0 | 0 | 0 | | |

Accessories

| Description | Class | Size SqFt | Eff Yr Blt | RMV | Quantity |
|--|-------|-----------|-------------------------|-------------------------|-----------------|
| No accessory data available | | | | | |
| Bldg: 6 Code Area: 04480 Stat Class: 352 | | | Year Blt: Eff Year Blt: | Sq.Ft: 2924 | % Complete: 100 |
| Desc: Utility Building (UB) | | | Exception: 0 | Dimensions: RMV: 434530 | |
| Func Obsc: 100 Econ %: 100 Other %: 100 | | | Adjust: | Adjust RMV: 0 | |

35b classroom

Height: 13 Ft

Floors

| Type | Class | Display Group | Floor Size | Beds | Baths | Yr Blt | Eff Yr Blt | Inventory | Exception: Y N |
|------------------|-------|---------------|------------|------|-------|--------|------------|-----------|----------------|
| Utility Building | 4 | Finished | 2924 | 0 | 0 | 0 | 0 | | |

Accessories

| Description | Class | Size SqFt | Eff Yr Blt | RMV | Quantity |
|-----------------------------|-------|-----------|------------|-----|----------|
| No accessory data available | | | | | |



R38957
071E 27D 01000
SCALE=1:60

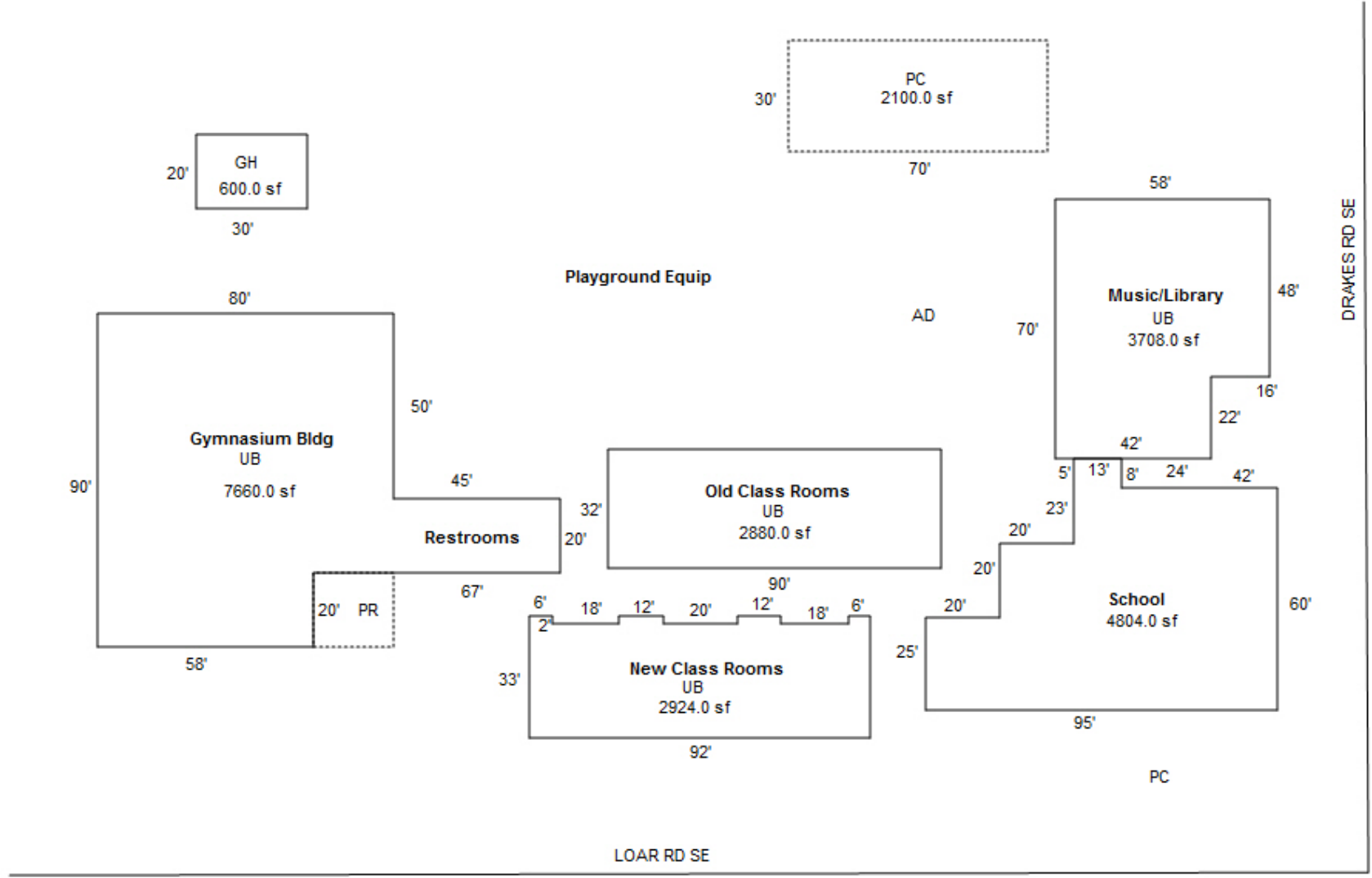
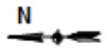

Commercial Property Appraisal

Marion County

SCHOOL OFFICE

Stat Class 820 - OTHER SCHOOLS

Account ID 538957

Notes 24-25: CYCLE PER GRH/WW//20 12-13: CYCLE WORK BY #31 , MAY HAVE 2ND FLOOR

Total Sq Ft 4,804

MA-SA-NH 03-06-000

Component - OTHER SCHOOLS

Stat Class 820 - OTHER SCHOOLS

Notes

Cost Approach

ZIP Code 97381

Data Collected 8/28/2024

Local Multiplier (Default)

Reporting Date 1/2024

Cost Data Set 1/2024

Architect's Fees (Default)

Eff. Age Adjustment n/a

Section - OTHER SCHOOLS

Type Building

Size 4,804 sq ft

Shape Rectangular

of Stories 1

Occupancy

| Code | Description | % | Quality | Class | Height (ft) |
|------|----------------------------|-----|---------|---------------------------------------|-------------|
| 365 | Elementary School (Entire) | 100 | 3.0 | D Wood or Steel Framed Exterior Walls | 12.0 |

Components

| Code | Description | Quantity | Unit Cost | Total Cost New | Less Depreciation | Total Cost Depreciated |
|---------|------------------------|----------|-----------|----------------|-------------------|------------------------|
| 1 | Base Cost | 4,804 | \$215.32 | \$1,034,397 | \$382,727 | \$651,670 |
| 6601014 | Concrete Sidewalk | 1,000 | \$8.38 | \$8,380 | \$0 | \$8,380 |
| 3 | Default Heating | 4,804 | \$29.65 | \$142,439 | \$52,702 | \$89,737 |
| 764 | Fire Alarm System | 4,804 | \$3.25 | \$15,613 | \$5,777 | \$9,836 |
| 6403017 | Paving, Asphalt | 6,020 | \$5.98 | \$36,000 | \$13,320 | \$22,680 |
| 681 | Sprinklers | 4,804 | \$9.11 | \$43,764 | \$16,193 | \$27,571 |
| 896 | Stud Walls-Wood Siding | 4,804 | \$28.20 | \$135,473 | \$50,125 | \$85,348 |
| | | | | \$1,416,066 | \$520,844 | \$895,222 |

Additions

| Type | Description | Units | Cost | Depr | LCM | Trend | Base Date |
|-----------|-------------|-------|--------------|------|--------------------------|--------------------------|-----------|
| Base Cost | EP&O | | \$141,606.00 | | <input type="checkbox"/> | <input type="checkbox"/> | |

Depreciation

Marshall & Swift Tables Eff. Age 20 yrs

Additional Functional 0.0 %

External 0.0 %

Reconciliation Base Value \$984,434 Calculation Type Marshall & Swift

| Land | Structures | Mach/Equip | Personal Prop | Total | Improvements (S + M/E - P) | |
|------|------------|------------|---------------|-------|----------------------------|-----------|
| \$0 | + | \$984,434 | + | - | = \$984,434 | \$984,434 |

Commercial Property Appraisal

Marion County

GYM

Stat Class 820 - OTHER SCHOOLS

Account ID 538957

Notes 24-25: CYCLE PER GRH/WW//2012-13: CYCLE WORK BY #31- BREAKING OUT IMPS AND ASSIGNING INDIVIDUAL VALUES// 00-01;UPDATED EXEMPT VALUE

Total Sq Ft 7,660

MA-SA-NH 03-06-000

Component - GYM

Stat Class 820 - OTHER SCHOOLS

Notes

Cost Approach

ZIP Code 97381

Data Collected 8/8/2024

Local Multiplier (Default)

Reporting Date 1/2024

Cost Data Set 1/2024

Architect's Fees (Default)

Eff. Age Adjustment n/a

Section - GYM

Type Building

Size 7,660 sq ft

Perimeter 430 ft

of Stories 1

Occupancy

| Code | Description | % | Quality | Class | Height (ft) |
|------|--------------------|-----|---------|---------------------------------------|-------------|
| 358 | Gymnasium (School) | 100 | 2.0 | D Wood or Steel Framed Exterior Walls | 24.0 |

Components

| Code | Description | Quantity | Unit Cost | Total Cost New | Less Depreciation | Total Cost Depreciated |
|------|------------------------|----------|-----------|----------------|-------------------|------------------------|
| 1 | Base Cost | 7,660 | \$146.35 | \$1,121,041 | \$224,208 | \$896,833 |
| 3 | Default Heating | 7,660 | \$20.84 | \$159,634 | \$31,927 | \$127,707 |
| 764 | Fire Alarm System | 7,660 | \$2.78 | \$21,295 | \$4,259 | \$17,036 |
| 681 | Sprinklers | 7,660 | \$6.40 | \$49,024 | \$9,805 | \$39,219 |
| 896 | Stud Walls-Wood Siding | 7,660 | \$27.55 | \$211,033 | \$42,207 | \$168,826 |
| | | | | \$1,562,027 | \$312,406 | \$1,249,621 |

Additions

| Type | Description | Units | Cost | Depr | LCM | Trend | Base Date |
|-----------|-------------|-------|--------------|------|--------------------------|--------------------------|-----------|
| Base Cost | EP&O (10%) | | \$156,203.00 | | <input type="checkbox"/> | <input type="checkbox"/> | |

Depreciation

Marshall & Swift Tables Eff. Age 10 yrs

Additional Functional 0.0 %

External 0.0 %

Reconciliation Base Value \$1,374,583

Calculation Type Marshall & Swift

| Land | Structures | Mach/Equip | Personal Prop | Total | Improvements (S + M/E - P) |
|------|------------|-------------|---------------|-------|----------------------------|
| \$0 | + | \$1,374,583 | + | - | = \$1,374,583 |
| | | | | | \$1,374,583 |

Commercial Property Appraisal

Marion County

CLASSROOM

Stat Class 820 - OTHER SCHOOLS

Account ID 538957

Notes 24-25: CYCLE PER GRH/WW

Total Sq Ft 2,880

MA-SA-NH 03-06-000

Component - CLASSROOM

Stat Class 820 - OTHER SCHOOLS

Notes

Cost Approach

ZIP Code 97381

Data Collected 8/8/2024

Local Multiplier (Default)

Reporting Date 1/2024

Cost Data Set 1/2024

Architect's Fees (Default)

Eff. Age Adjustment n/a

Section - CLASSROOM

Type Building

Size 2,880 sq ft

Perimeter 244 ft

of Stories 1

Occupancy

| Code | Description | % | Quality | Class | Height (ft) |
|------|-------------|-----|---------|---------------------------------------|-------------|
| 356 | Classroom | 100 | 2.0 | D Wood or Steel Framed Exterior Walls | 13.0 |

Components

| Code | Description | Quantity | Unit Cost | Total Cost | | Total Cost Depreciated |
|------|------------------------|----------|-----------|------------|-------------------|------------------------|
| | | | | New | Less Depreciation | |
| 1 | Base Cost | 2,880 | \$153.49 | \$442,051 | \$198,923 | \$243,128 |
| 3 | Default Heating | 2,880 | \$18.65 | \$53,712 | \$24,170 | \$29,542 |
| 764 | Fire Alarm System | 2,880 | \$2.78 | \$8,006 | \$3,603 | \$4,403 |
| 681 | Sprinklers | 2,880 | \$7.80 | \$22,464 | \$10,109 | \$12,355 |
| 896 | Stud Walls-Wood Siding | 2,880 | \$25.48 | \$73,382 | \$33,022 | \$40,360 |
| | | | | \$599,615 | \$269,827 | \$329,788 |

Additions

| Type | Description | Units | Cost | Depr | LCM | Trend | Base Date |
|-----------|-------------|-------|-------------|------|--------------------------|--------------------------|-----------|
| Base Cost | EP&O (10%) | | \$59,962.00 | | <input type="checkbox"/> | <input type="checkbox"/> | |

Depreciation

Marshall & Swift Tables Eff. Age 20 yrs
 Additional Functional 0.0 %
 External 0.0 %

Reconciliation **Base Value** \$362,767 Calculation Type Marshall & Swift

| Land | Structures | Mach/Equip | Personal Prop | Total | Improvements (S + M/E - P) |
|------|-------------|------------|---------------|-------------|-------------------------------|
| \$0 | + \$362,767 | + | - | = \$362,767 | \$362,767 |

Commercial Property Appraisal

Marion County

CLASSROOM

Stat Class 820 - OTHER SCHOOLS

Account ID 538957

Notes 24-25: CYCLE PER GRH/WW

Total Sq Ft 2,924

MA-SA-NH 03-06-000

Component - CLASSROOM

Stat Class 820 - OTHER SCHOOLS

Notes

Cost Approach

ZIP Code 97381

Data Collected 8/8/2024

Local Multiplier (Default)

Reporting Date 1/2024

Cost Data Set 1/2024

Architect's Fees (Default)

Eff. Age Adjustment n/a

Section - CLASSROOM

Type Building

Size 2,924 sq ft

Perimeter 250 ft

of Stories 1

Occupancy

| Code | Description | % | Quality | Class | Height (ft) |
|------|-------------|-----|---------|---------------------------------------|-------------|
| 356 | Classroom | 100 | 2.0 | D Wood or Steel Framed Exterior Walls | 13.0 |

Components

| Code | Description | Quantity | Unit Cost | Total Cost | | Total Cost Depreciated |
|------|------------------------|----------|-----------|------------|-------------------|------------------------|
| | | | | New | Less Depreciation | |
| 1 | Base Cost | 2,924 | \$153.73 | \$449,507 | \$202,278 | \$247,229 |
| 3 | Default Heating | 2,924 | \$18.67 | \$54,591 | \$24,566 | \$30,025 |
| 764 | Fire Alarm System | 2,924 | \$2.78 | \$8,129 | \$3,658 | \$4,471 |
| 681 | Sprinklers | 2,924 | \$7.80 | \$22,807 | \$10,263 | \$12,544 |
| 896 | Stud Walls-Wood Siding | 2,924 | \$25.53 | \$74,650 | \$33,593 | \$41,057 |
| | | | | \$609,684 | \$274,358 | \$335,326 |

Additions

| Type | Description | Units | Cost | Depr | LCM | Trend | Base Date |
|-----------|-------------|-------|-------------|------|--------------------------|--------------------------|-----------|
| Base Cost | EP&O (10%) | | \$60,968.00 | | <input type="checkbox"/> | <input type="checkbox"/> | |

Depreciation

Marshall & Swift Tables Eff. Age 20 yrs

Additional Functional 0.0 %

External 0.0 %

Reconciliation Base Value \$368,858 Calculation Type Marshall & Swift

| Land | Structures | Mach/Equip | Personal Prop | Total | Improvements (S + M/E - P) | |
|------|------------|------------|---------------|-------|----------------------------|-----------|
| \$0 | + | \$368,858 | + | - | = \$368,858 | \$368,858 |

Commercial Property Appraisal

Marion County

MUSIC/LIBRARY

Stat Class 820 - OTHER SCHOOLS

Account ID 538957

Notes 24-25: CYCLE PER GRH/WW//2012-3: ADD FOR MUSIC LIBRARY

Total Sq Ft 3,708

MA-SA-NH 03-06-000

Component - MUSIC/LIBRARY

Stat Class 820 - OTHER SCHOOLS

Notes

Cost Approach

ZIP Code 97381

Data Collected 8/8/2024

Local Multiplier (Default)

Reporting Date 1/2024

Cost Data Set 1/2024

Architect's Fees (Default)

Eff. Age Adjustment n/a

Section - MUSIC/LIBRARY

Type Building

Size 3,708 sq ft

Perimeter 256 ft

of Stories 1

Occupancy

| Code | Description | % | Quality | Class | Height (ft) |
|------|-----------------------|-----|---------|---------------------------------------|-------------|
| 360 | Library, Media Center | 100 | 1.0 | D Wood or Steel Framed Exterior Walls | 12.0 |

Components

| Code | Description | Quantity | Unit Cost | Total Cost | | Total Cost Depreciated |
|------|------------------------|----------|-----------|------------|-------------------|------------------------|
| | | | | New | Less Depreciation | |
| 1 | Base Cost | 3,708 | \$107.89 | \$400,056 | \$64,009 | \$336,047 |
| 3 | Default Heating | 3,708 | \$13.88 | \$51,467 | \$8,235 | \$43,232 |
| 764 | Fire Alarm System | 3,708 | \$2.37 | \$8,788 | \$1,406 | \$7,382 |
| 681 | Sprinklers | 3,708 | \$5.65 | \$20,950 | \$3,352 | \$17,598 |
| 896 | Stud Walls-Wood Siding | 3,708 | \$21.25 | \$78,795 | \$12,607 | \$66,188 |
| | | | | \$560,056 | \$89,609 | \$470,447 |

Additions

| Type | Description | Units | Cost | Depr | LCM | Trend | Base Date |
|-----------|-------------|-------|-------------|------|--------------------------|--------------------------|-----------|
| Base Cost | EP&O (10%) | | \$56,005.00 | | <input type="checkbox"/> | <input type="checkbox"/> | |

Depreciation

| | |
|-------------------------|-----------------|
| Marshall & Swift Tables | Eff. Age 10 yrs |
| Additional Functional | 0.0 % |
| External | 0.0 % |

Reconciliation Base Value \$517,491 Calculation Type Marshall & Swift

| Land | Structures | Mach/Equip | Personal Prop | Total | Improvements (S + M/E - P) |
|------|------------|------------|---------------|-------|----------------------------|
| \$0 | + | \$517,491 | + | = | \$517,491 |
| | | | - | | \$517,491 |