

Acct ID: 556123 MTL: 062W04D001100 Date: **7.2.24** Appr: **JSS** Prop Class: 551 RMV Prop Class: 551
 Situs: 6137 WACONDA RD NE SALEM OR 97305 MaSaNh: 02 06 000 Unit: 102500 Year: 2024

Last Date Appraised: 04/16/2020 Appraiser: JORDAN SCHULTZ Retag: Y **N** Tag info:

Owner: DIAZ, GUILLERMO & DIAZ, GILBERTO & Roll Type: R

Cycle Tag Sales Verification Other: _____ Inspection level: 1 **2** **3** 4 LCB TTO INSP AV: 195960

RMV Land: 146780 RMV Imp: 271390 RMV Total: 418170 MAV: 145980 MSAV: 49980 SAV: 106270

Comment:

Notations

Upl Inv Input, JSS, 7.2.24

No notation data available.

OSDs

Count	Code	Description	RMV	Code Area	Exception
1	SAA	SA OSD - AVERAGE	45000	01600	0

Land

Site: 1 Code Area: 01600 Size: 1.00 Acres Use Code: 005 Zone: REST SAV Use: 011 Exception: 0
 Class: Value Source: Farm Homesite Description: RMV: 101780 Exception: Y N
 Adjustment(s): Fire Patrol: Description:
 Comments: Liability year - 2009 / 00100030

Improvements - Residence / Manufactured Structures

Bldg: 1 Code Area: 01600 Stat Class: 142 - Year Blt: 1971 Eff Year Blt: 1984 Sq.Ft: 2340 % Complete: 100
 Desc: Multi Story above grade Dimensions: RMV: 271390
 Func Obsc: 100 Econ %: 100 Other %: 100 Exception: 0 Adjust: Adjust RMV: 0

Floors

Type	Class	Display Group	Floor Size	Beds	Baths	Yr Blt	Eff Yr Blt	Inventory	Exception
First Floor	4 -	Finished	1340 1338	0	FB-1/ HB-1	1971	1984	KIT+, ROOF, FP - 1, HVAC, BTH - 1	Exception: Y N
Second Floor	4 -	Finished	1000	4	FB-2	1971	1984	HVAC, BATH - 2	Exception: Y N
Garage Attached	4	Finished	420 441	0		1971	1984	ROOF	Exception: Y N

Accessories

YI4F

Description	Class	Size SqFt	Eff Yr Blt	RMV	Quantity	Exception
CONCRETE DRIVEWAY	4	840	1971	2020	1	Exception: Y N
PATIO	4	80	1971	326	1	Exception: Y N
PATIO	4	112	1971	456	1	Exception: Y N
PATIO	4	280	1971	1140	1	Exception: Y N
ROOF EXTENSION OR PATIO COVER	4	112	1971	2404	1	Exception: Y N

Improvements - Accessory Buildings

No improvement data available for all other stat class types.

R56123
062W04D 01100
N

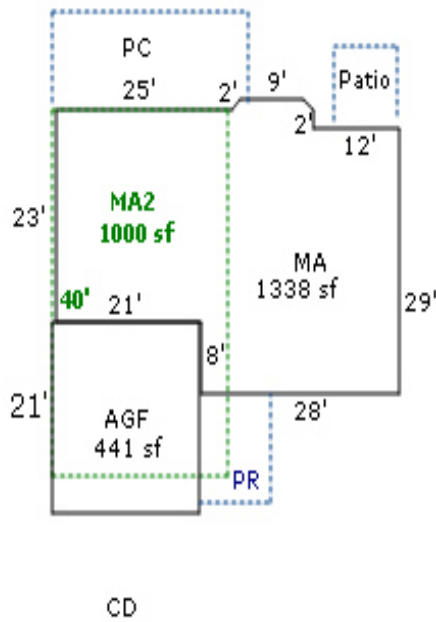
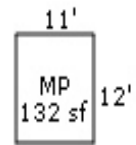

Waconda Rd

SSS 7.2.24 Eyde L3